

Map Referred to in the Nottinghamshire County Council (A614 / A6097 Junction Improvement Scheme) Compulsory Purchase Order 2022

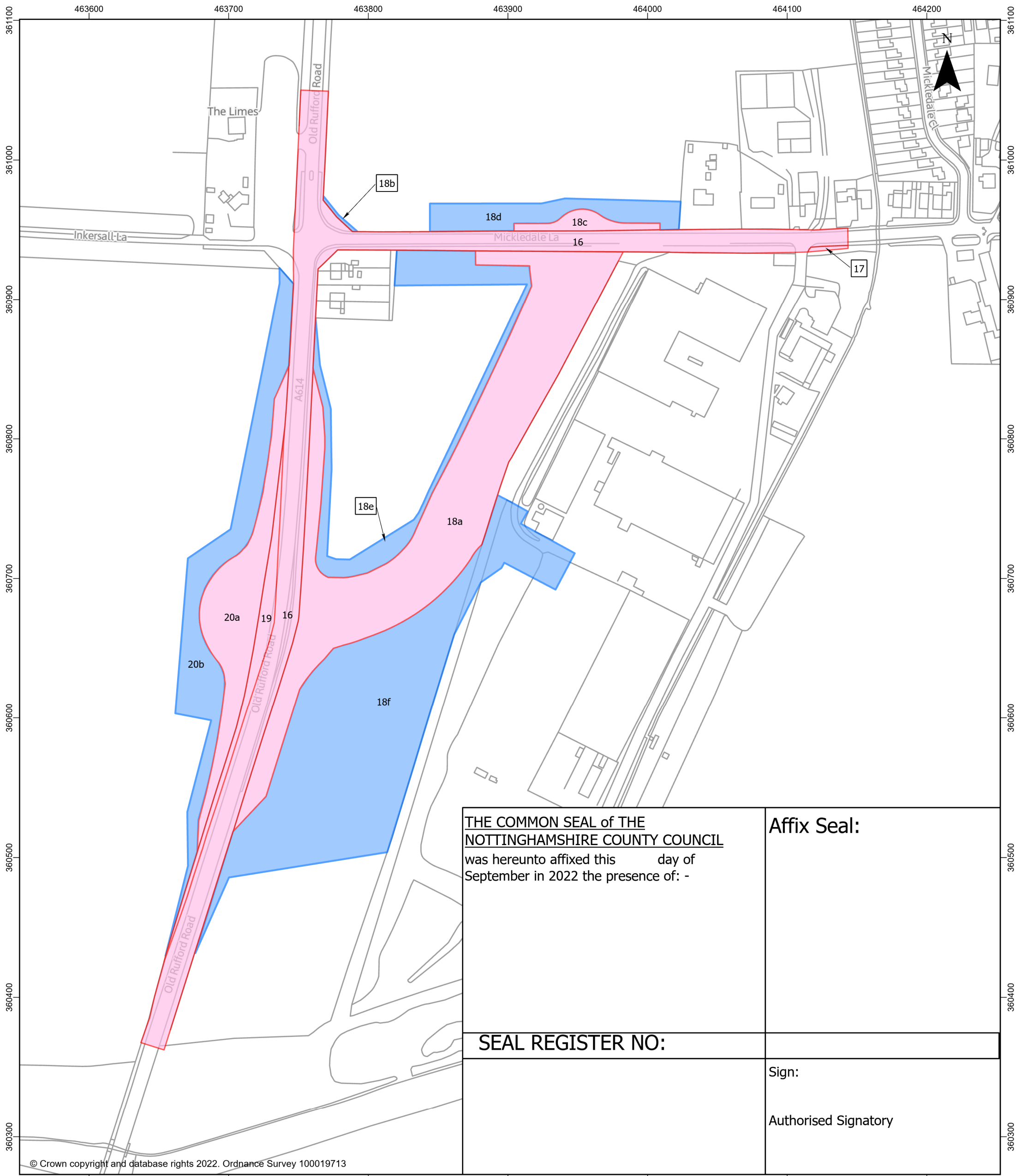

<p>THE COMMON SEAL of THE NOTTINGHAMSHIRE COUNTY COUNCIL</p> <p>was hereunto affixed this day of September in 2022 the presence of: -</p>	<p>Affix Seal:</p>
<p>SEAL REGISTER NO:</p>	
	<p>Sign:</p> <p>Authorised Signatory</p>

© Crown copyright and database rights 2022. Ordnance Survey 100019713

Client	Nottinghamshire County Council
Project	A614 / A6097 Junction Improvement Scheme
Project Number	533826
Title Plan	Compulsory Purchase Order Mickledale

LEGEND

- Land to be acquired
- Rights to be acquired

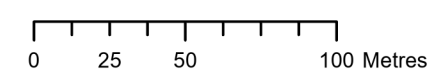

<p>BK Bruton Knowles</p> <p>Produced by: Unit 2, Suite 2A, East Bridgford Business Park, Kneeton Road, East Bridgford, Nottinghamshire, NG13 8PJ</p>	Delivered to:	Nottinghamshire County Council Trent Bridge House Fox Road Nottingham NG2 6BJ
	MAP CENTRE: 463901E 360687N	
SCALE:	1:2,500	PAPER SIZE: A3
DRAWN:	HH	CHECKED: MB
VERSION:	1	DATE: 26/09/2022