

NOTES:

1. All dimensions are in millimetres unless otherwise stated.
2. Hoop should be attached to gate prior to excavation to mark out appropriate digging. This also allows for check of how the structure will link into existing fencing or limitations.
3. Top of gate frame, gate and hoop to be level and vertical. On land subject to a slope some levelling of the ground may be needed around the structure prior to erection.
4. Post holes to be 150mm wide, and top of cross member to be 100mm below ground. Where location may be used for lambing, base cross piece to be 175mm below ground level.
5. Gate to be set in concrete. If stock is in field, or public use expected shortly after installation, rapid set concrete to be used. Hoop support legs to be also set in concrete.
6. Where stock is only one side of fence, hoop to be placed on non-stock side where conditions allow. This may not be possible on some roadside locations.
7. Hoop must not cause any impediment to other legitimate users of the land.
8. Once erected, gate should be adjusted and checked for self-closing. Gate catch should also be free moving.
9. Gate hinge bolts to be made tamper proof.
10. Ensure post caps are in place.
11. Gates shall be obtained by the Contractor from:-
Centrewire Ltd,
Brookhouse Industrial Estate,
Cheadle,
Stoke - on - Trent,
Staffordshire,
ST10 1SR
www.centrewire.com
sales@centrewire.com
or similar approved gates equal or exceeding the quality of 'Centrewire' gates.

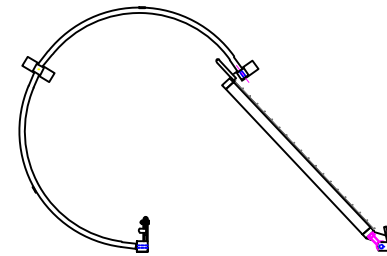

GATE OPENING

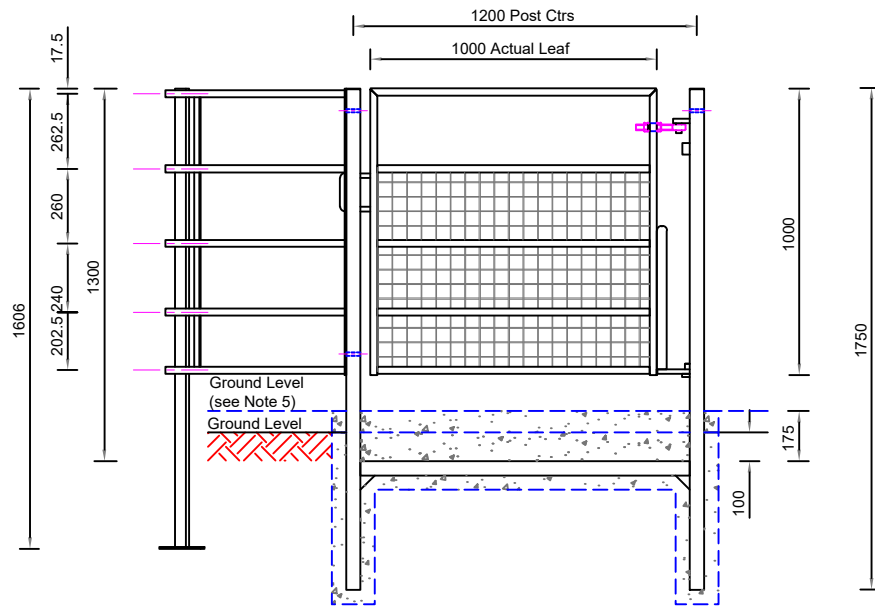
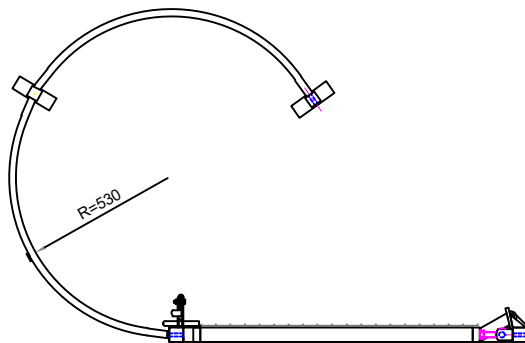

GATE CLOSED

Rev.	Description	Drawn	Ch'kd	Auth	Date

via in partnership with **Nottinghamshire County Council**

www.viaem.co.uk Tel 0115 804 2100
Bilsthorpe Depot, Bilsthorpe Business Park, Bilsthorpe,
Nottinghamshire, NG22 8ST

Project	Highway Construction Details			Project	Drawn	Date
Status	Project No.	Rights of Way			JLS	18/08/2020
Drawing Title	'Woodstock' Kissing Gate			JD	Date	16/02/2021
Drawing No.	SD/FP/12A			JP	Traced	JLS
				Rev.	Scale	N.T.S @A4
				0		