

PLAN

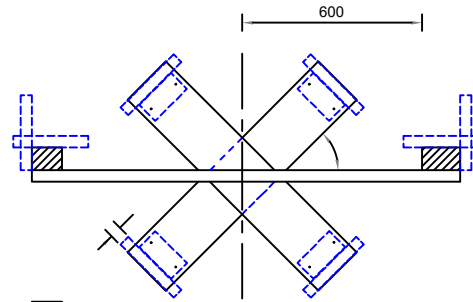

ELEVATION

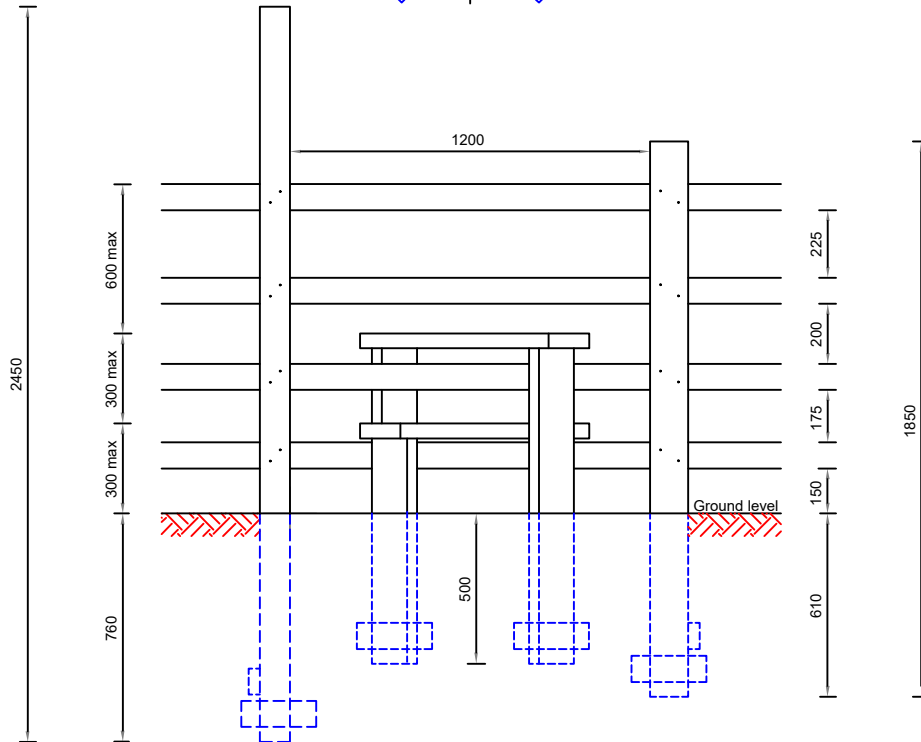

DESCRIPTION	DIMENSIONS	NO
HAND HOLD POST	100 x 100 x 2450	1
POST	127 x 76 x 1850	1
RAILS		4
STEPS	50 x 180 x 900	2
LOW STEP SUPPORTS	75 x 150 x 890	2
HIGH STEP SUPPORTS	75 x 150 x 1165	2

NOTES:

1. All dimensions are in millimetres unless otherwise stated.
2. Where construction of a stile has been specified, in all cases the rails should be extended into adjacent hedges or continued either side of the stile to fill gaps and make the structure stock-proof. Hand hold post to be weather cut and steps should be skew nailed to supports.
3. Where existing structures require to be made stable, posts should be excavated to a depth of approximately 300mm and blocks of rubble should be added as wedges, the soil returned and compacted. Loose timber should be nailed down and the structure made stock-proof, if necessary, by addition of timber rails.
4. Where a foot stool is specified to be constructed in a fence or stile, the dimensions and height above ground should be the same as that given in the drawing.
5. Where a stile is specified to be constructed in a barbed wire fence or wire fence, two additional posts should be used as strainer posts, to be placed at least 500mm from stile posts.
6. Attach 2 x 250 long off-cut rail pieces to the bottom of the post using four 100mm nails, to anchor it. Post to be secured with rubble and soil compacted, unless otherwise specified.

Rev.	Description	Drawn	Ch'kd	Auth	Date



in partnership with



www.viaem.co.uk Tel 0115 804 2100

Bilsthorpe Depot, Bilsthorpe Business Park, Bilsthorpe, Nottinghamshire, NG22 8ST

Highway Construction Details

Rights of Way

Double Step Stile

SD/FP/02

Project	Status	Project No.	Project	Drawn	Date	Project	Drawn	Date
				HR	18/08/2020			
				JD	16/02/2021			
				JP	HR			
				0	N.T.S @ A4			