

GRILLE ELEVATION

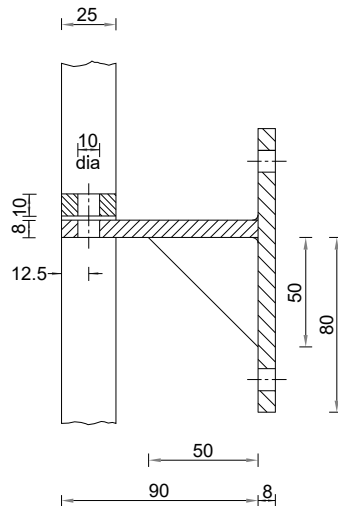

SECTION B - B

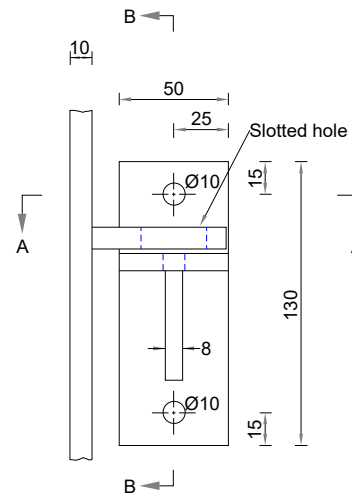

SECTION A - A

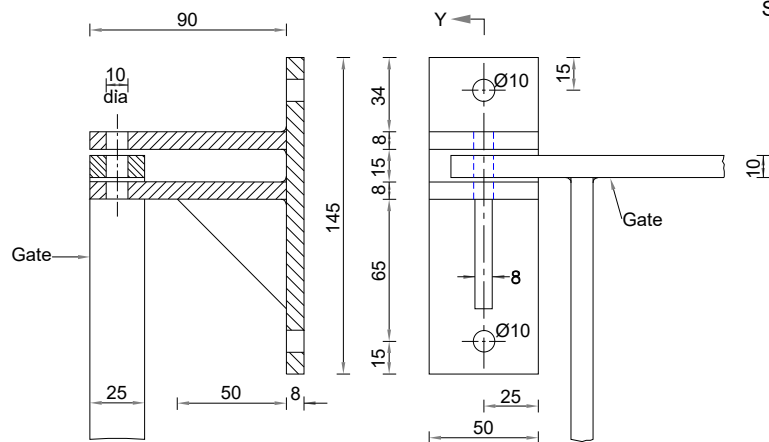

SECTION X - X

HINGE DETAIL

LOCKING PLATE DETAIL

NOTES:

1. All dimensions are in millimetres unless otherwise stated.
2. All steelwork to be galvanised in accordance with BS EN ISO 1461:2009 Part 1 at 0.628kg zinc per sq m.
3. 6mm continuous fillet welds at all connections
4. 3 no 8mm diameter stainless steel bolts to be used at hinges and locking plate and held with 'nylock' type hexagonal nuts.
5. Grille to be fixed to headwall using 6 no. M8 expanding loose bolt, zinc plated (rawlbolt type).
6. Grille is to be fixed centrally over pipe.
7. The grille shown can be used for pipes diameter of 450mm to 650mm. For larger pipes the grille size can be increased with additional 16mm diameter vertical bars as per table below:-

PIPE DIA mm	GRILLE SIZE mm	NUMBER OF VERTICAL BARS
450 - 675	758 x 758	4
750 - 825	908 x 908	5
900 - 975	1058 x 1058	6
1050 - 1125	1208 x 1208	7

Rev.	Description	Drawn	Ch'kd	Auth	Date

 in partnership with

www.viaem.co.uk Tel 0115 804 2100
 Bilsthorpe Depot, Bilsthorpe Business Park, Bilsthorpe,
 Nottinghamshire, NG22 8ST

Project		Highway Cnstruction Details			Project	Drawn	Date
Status	Project No.	DRAINAGE			Drawn	JLS	12/06/2020
Drawing Title		Detail of Headwall Grille			Ch'kd	JD	29/06/20
Drawing No.		SD/5/30			Auth	JJP	Traced JLS
					Rev.	0	Scale N.T.S @A4