

Elevation of barrier panel

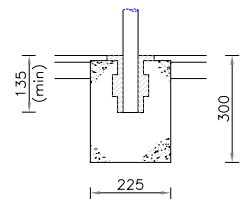

Alternative socket post foundation

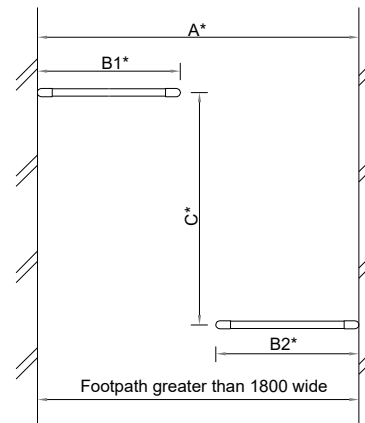
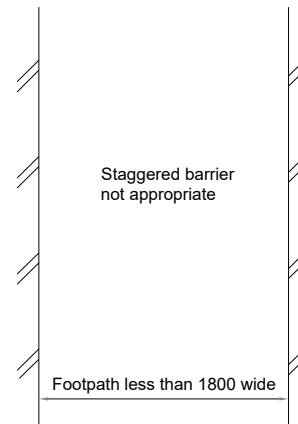

NOTES:

1. All dimensions are in millimetres unless otherwise stated.
2. Barrier to be constructed using 'kee-klamp' tubes and fittings or similar approved system with construction and materials as follows:-
 - a) Post and rails to be galvanised steel tubing, 42mm diameter to BS EN 10255 and coated to BS EN ISO 1461.
 - b) Junction between rails and posts to be a malleable iron casting to BS EN 1562 and capable of achieving a rigid joint by means of a recessed zinc plated set screw at each tube/ fitting interface.
3. When stated in the contract or when requested by the engineer, the alternative socketed foundations to be provided, comprising of a cast in ground socket capable of securing the upright posts by a set screw fixing.
4. The top rail to be painted using "Morgan's" or similar galvanised metal primer plus top coat of white "hammerite" using second coat where required within 3 hours. Paint to be applied in accordance with manufactures recommendations.
5. Dimensions marked * to be stated in the contract or on the table below:-

Dimension	Width (mm)
A	
B1	
B2	
C	
Socket foundations	Yes/ No

As a guide, the above dimensions can be calculated as follows:-
 $B1 = B2 = (A - 1100)$
 $C = 0.75 \times A$

Rev.	Description	Drawn	Ch'kd	Auth	Date



in partnership with



www.viaem.co.uk Tel 0115 804 2100

Bilsthorpe Depot, Bilsthorpe Business Park, Bilsthorpe, Nottinghamshire, NG22 8ST

Project		Highway Construction Details			Project	Drawn	Date
Status	Project No.	Kerbs, Footways And Pavings			JLS	JLS	18/06/2020
Drawing Title		Staggered Barriers on Footpaths			Ch'kd	JD	31/07/20
Drawing No.		SD/11/27			Auth	JP	Traced JLS
					Rev.	0	Scale N.T.S @A4