

PLAN FOLIO

THE NOTTINGHAMSHIRE COUNTY COUNCIL (B684 TO A612 LINK ROAD) A6211 GEDLING ACCESS ROAD (SIDE ROADS) ORDER 2018

Route of new classified road



New highway

(Stipple hatching)

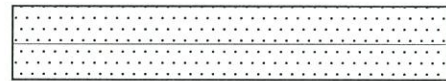

Highway to be improved, diverted,
raised, lowered and otherwise altered

(Cross hatching)



Highway to be stopped up

(Zebra hatching)



Private means of access to be
stopped up

(Solid black band)



New private means of access

(Diagonal hatching)



New highway boundary

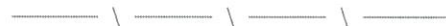

CONTENTS:

KEY PLAN, SITE PLAN (1 -6)

These site plans show the routes of new highways, sites of improvement, stopping up and new accesses but not the widths or construction details.

KEY PLAN SCALE: 1:10,000 @A3

SITE PLAN: 1:2500 @A3

THE COMMON SEAL of THE
NOTTINGHAMSHIRE COUNTY
COUNCIL

was hereunto affixed this *25th* day of
October 2018 in the presence of: -

Steve Deamer

SEAL REGISTER NO: *45095*

Affix Seal:

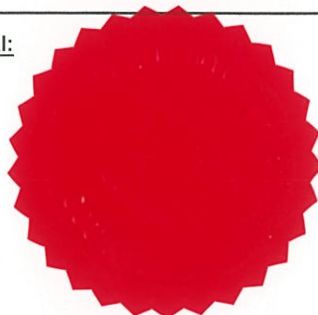

Sign:

Authorised Signatory



**Nottinghamshire
County Council**

©Nottinghamshire County Council

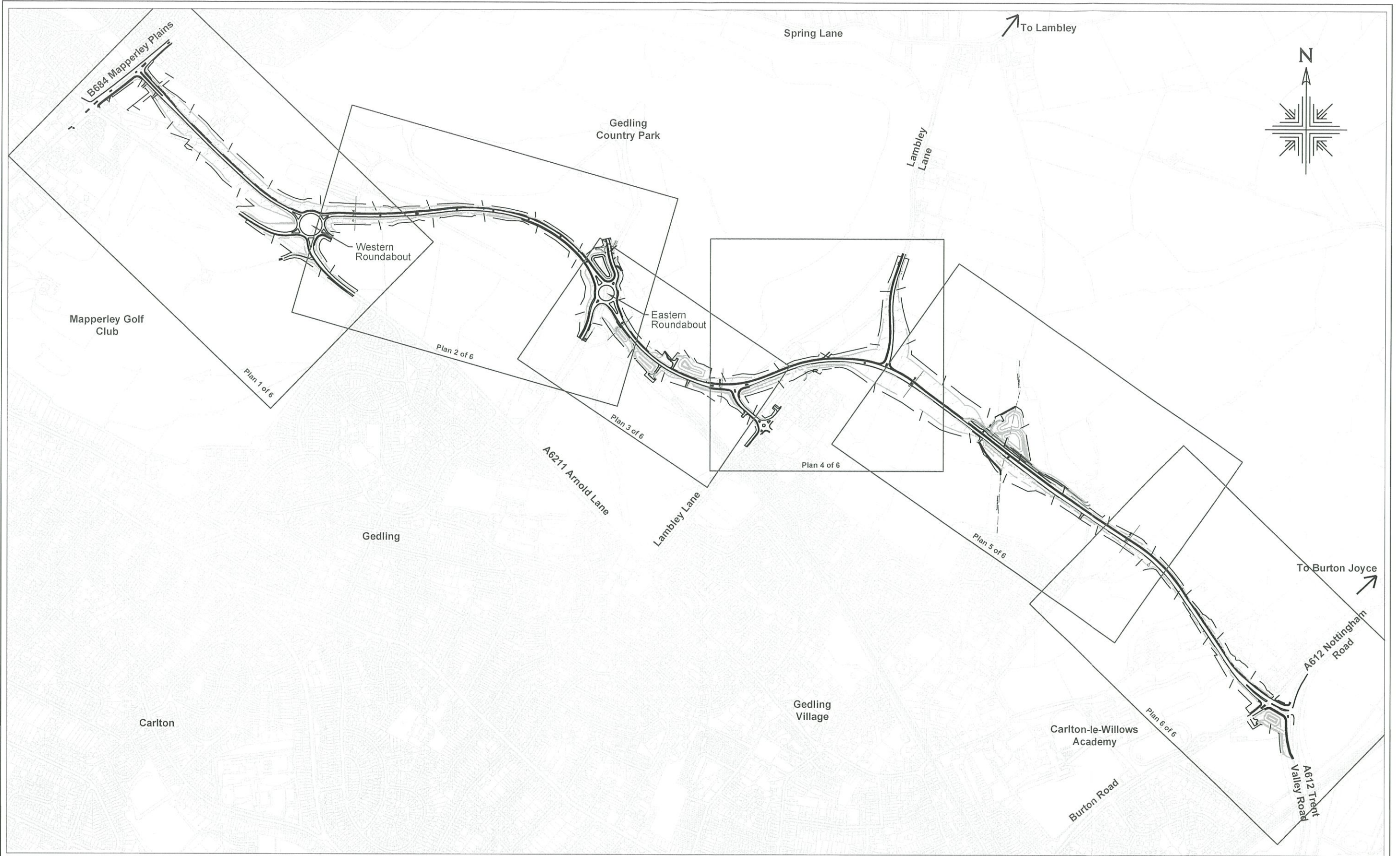

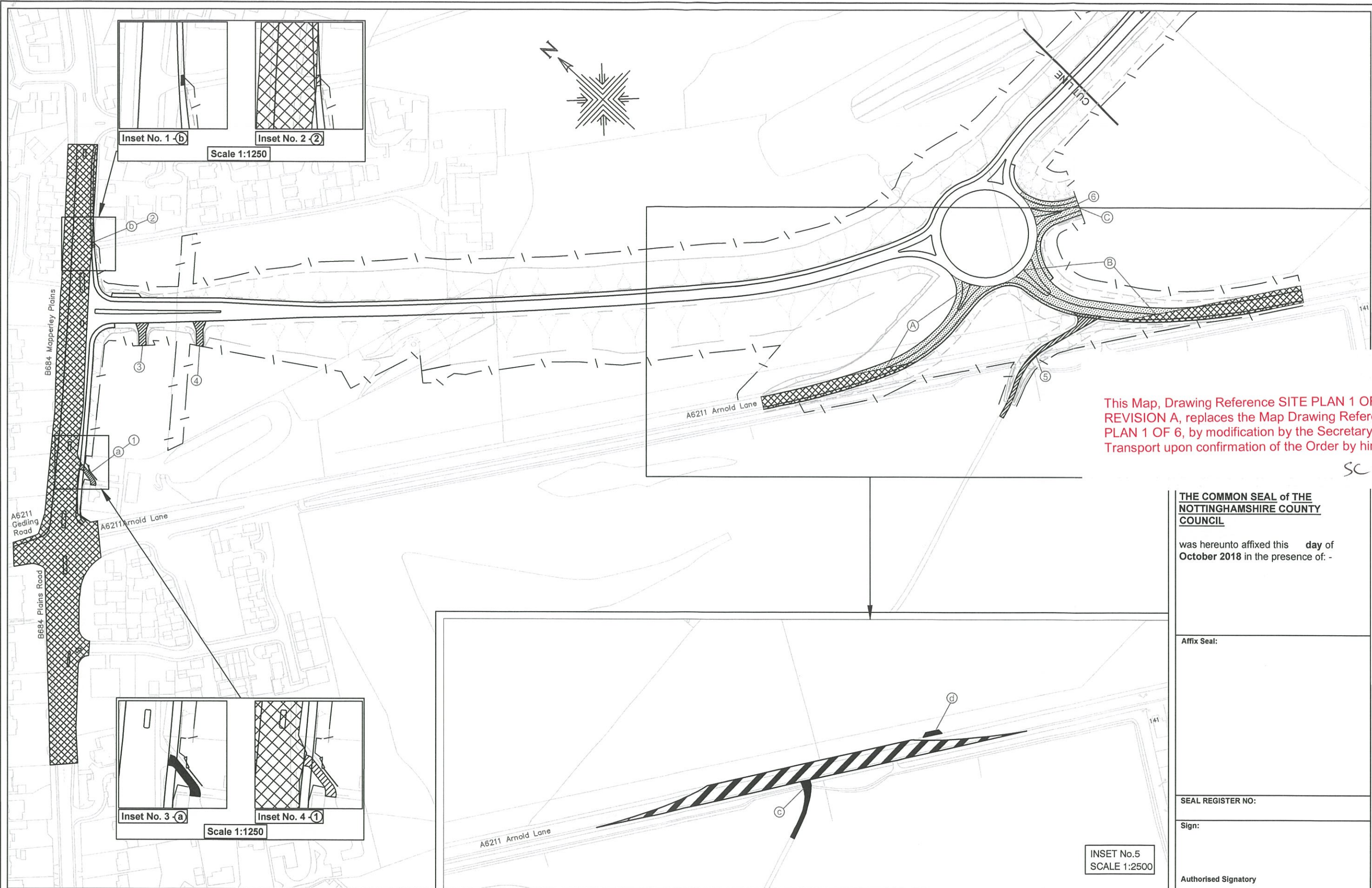

This Map, Drawing Reference SITE PLAN 1 OF 6 REVISION A, replaces the Map Drawing Reference SITE PLAN 1 OF 6, by modification by the Secretary of State for Transport upon confirmation of the Order by him.

SC

THE COMMON SEAL of THE NOTTINGHAMSHIRE COUNTY COUNCIL

was hereunto affixed this day of
October 2018 in the presence of: -

Affix Seal:

SEAL REGISTER NO:

Sign:

Authorised Signatory

INSET No.5
 SCALE 1:2500



This map is based upon Ordnance Survey material with the permission of Ordnance Survey on behalf of the Controller of Her Majesty's Stationary Office, © Crown copyright. Unauthorised reproduction infringes Crown copyright and may lead to prosecution or civil proceedings.
 Nottinghamshire County Council, License Number: 100019713, 2018

THE NOTTINGHAMSHIRE COUNTY COUNCIL
(B684 TO A612 LINK ROAD) A6211 GEDLING ACCESS ROAD
(SIDE ROADS) ORDER 2018

DRAWING REFERENCE:
 SITE PLAN 1 OF 6
 REVISION A

MAPPERLEY PLAINS, PLAINS ROAD, ARNOLD LANE
 AND MAPPERLEY GOLF COURSE ACCESS
 ALTERATIONS
 SCALE 1:2500 @ A3

©Nottinghamshire County Council

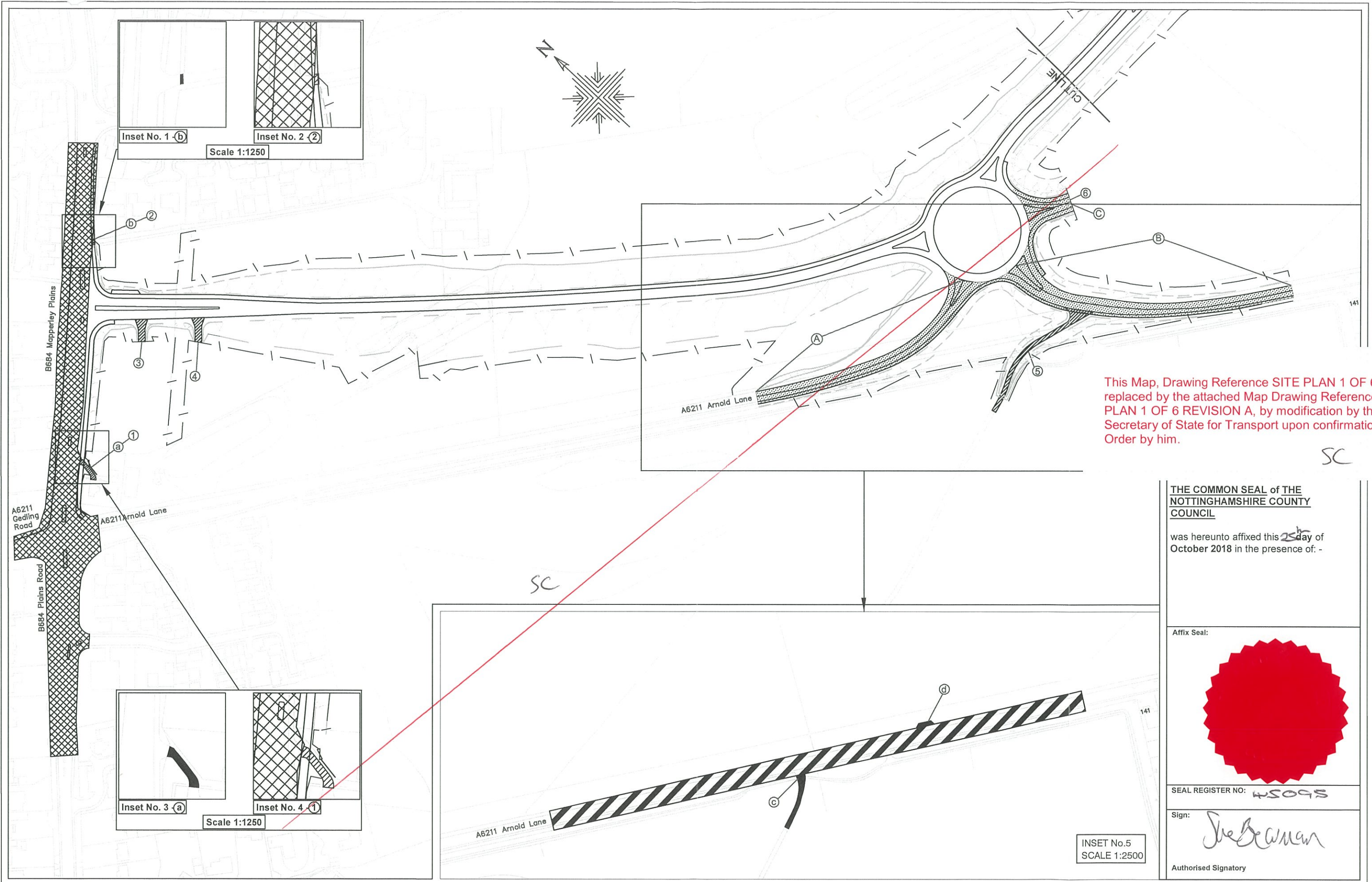

This Map, Drawing Reference SITE PLAN 1 OF 6, is replaced by the attached Map Drawing Reference SITE PLAN 1 OF 6 REVISION A, by modification by the Secretary of State for Transport upon confirmation of the Order by him.

SC

THE COMMON SEAL of THE NOTTINGHAMSHIRE COUNTY COUNCIL

was hereunto affixed this 25th day of October 2018 in the presence of: -

Affix Seal:



SEAL REGISTER NO: 45095

Sign: *Joe Beaman*

Authorised Signatory

INSET No.5
SCALE 1:2500

Nottinghamshire County Council

This map is based upon Ordnance Survey material with the permission of Ordnance Survey on behalf of the Controller of Her Majesty's Stationary Office, © Crown copyright. Unauthorised reproduction infringes Crown copyright and may lead to prosecution or civil proceedings. Nottinghamshire County Council, License Number: 100019713, 2018

THE NOTTINGHAMSHIRE COUNTY COUNCIL
(B684 TO A612 LINK ROAD) A6211 GEDLING ACCESS ROAD
(SIDE ROADS) ORDER 2018

DRAWING REFERENCE:
SITE PLAN 1 OF 6

MAPPERLEY PLAINS, PLAINS ROAD, ARNOLD LANE AND MAPPERLEY GOLF COURSE ACCESS ALTERATIONS
SCALE 1:2500 @ A3

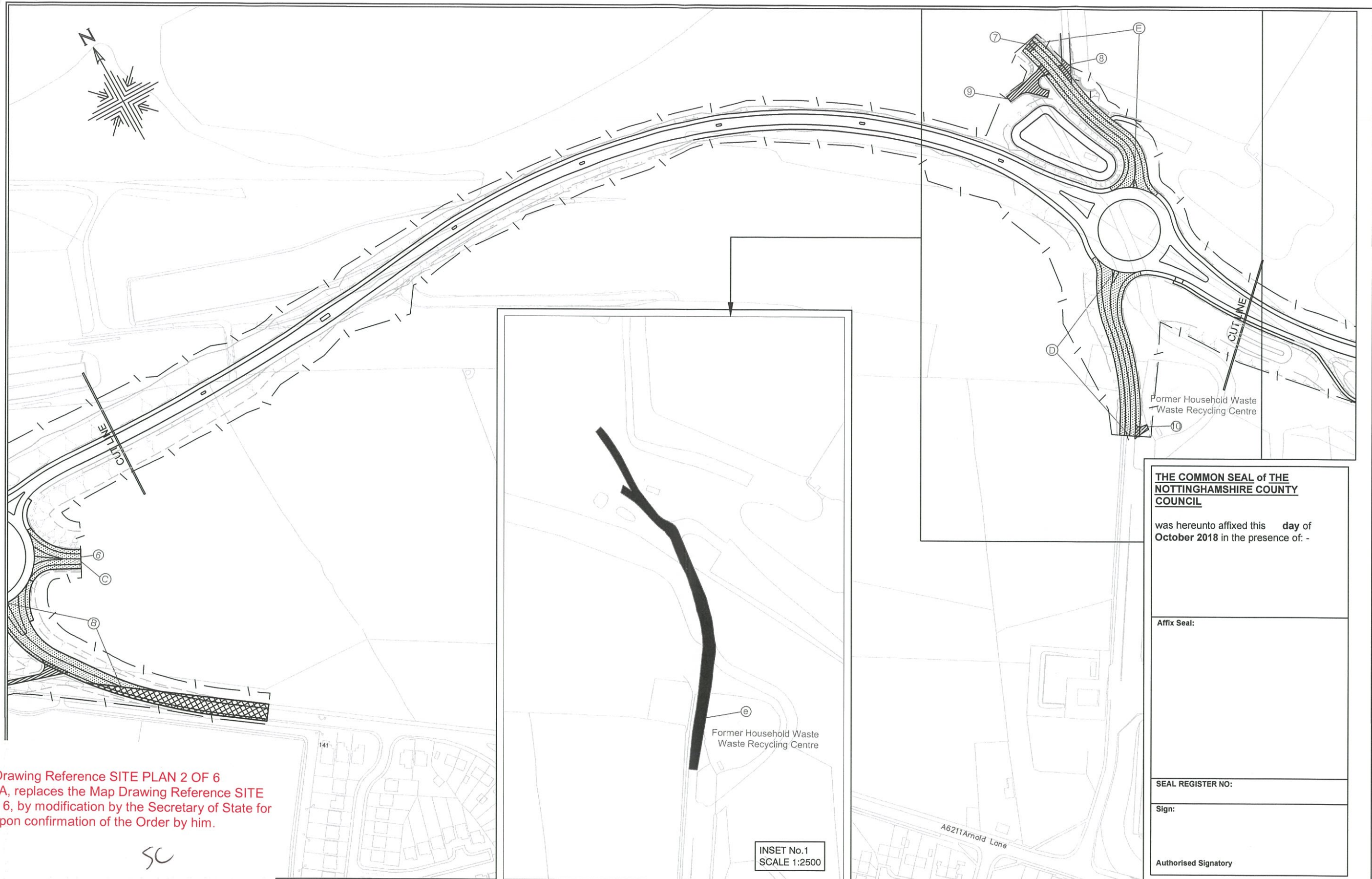

This Map, Drawing Reference SITE PLAN 2 OF 6 REVISION A, replaces the Map Drawing Reference SITE PLAN 2 OF 6, by modification by the Secretary of State for Transport upon confirmation of the Order by him.

SC

THE COMMON SEAL of THE NOTTINGHAMSHIRE COUNTY COUNCIL

was hereunto affixed this day of October 2018 in the presence of: -

Affix Seal:

SEAL REGISTER NO:

Sign:

Authorised Signatory



This map is based upon Ordnance Survey material with the permission of Ordnance Survey on behalf of the Controller of Her Majesty's Stationary Office, © Crown copyright. Unauthorised reproduction infringes Crown copyright and may lead to prosecution or civil proceedings. Nottinghamshire County Council, License Number: 100019713, 2018

THE NOTTINGHAMSHIRE COUNTY COUNCIL
(B684 TO A612 LINK ROAD) A6211 GEDLING ACCESS ROAD
(SIDE ROADS) ORDER 2018

DRAWING REFERENCE:
 SITE PLAN 2 OF 6
 REVISION A

WESTERN ROUNDABOUT TO EASTERN ROUNDABOUT
 SCALE 1:2500 @ A3

©Nottinghamshire County Council

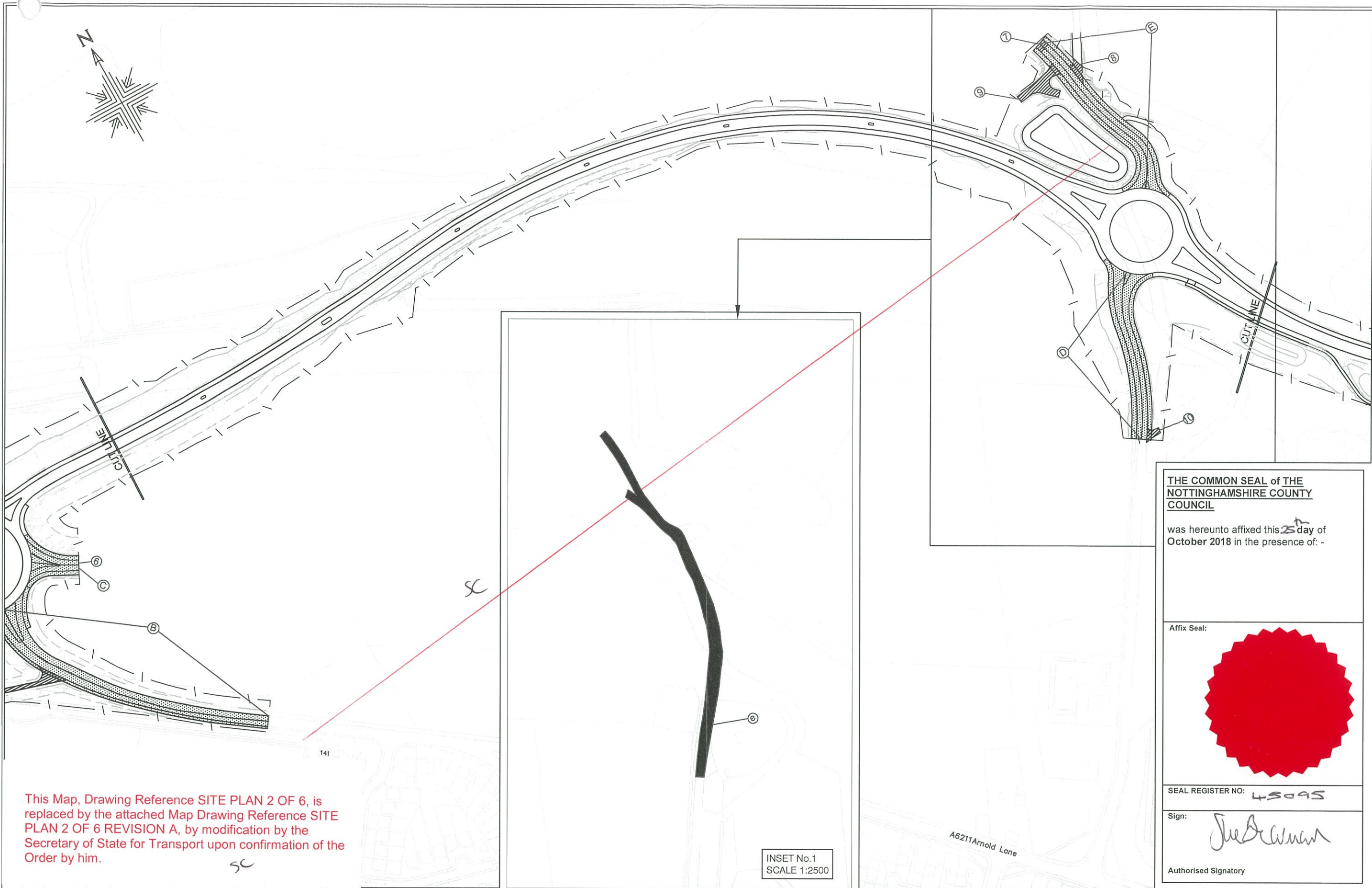

This Map, Drawing Reference SITE PLAN 2 OF 6, is replaced by the attached Map Drawing Reference SITE PLAN 2 OF 6 REVISION A, by modification by the Secretary of State for Transport upon confirmation of the Order by him.

SC

SC

INSET No.1
SCALE 1:2500

A6211 Arnold Lane

THE COMMON SEAL of THE NOTTINGHAMSHIRE COUNTY COUNCIL

was hereunto affixed this 25 day of October 2018 in the presence of: -

Affix Seal:



SEAL REGISTER NO: 43095

Sign: *Justin...*

Authorised Signatory

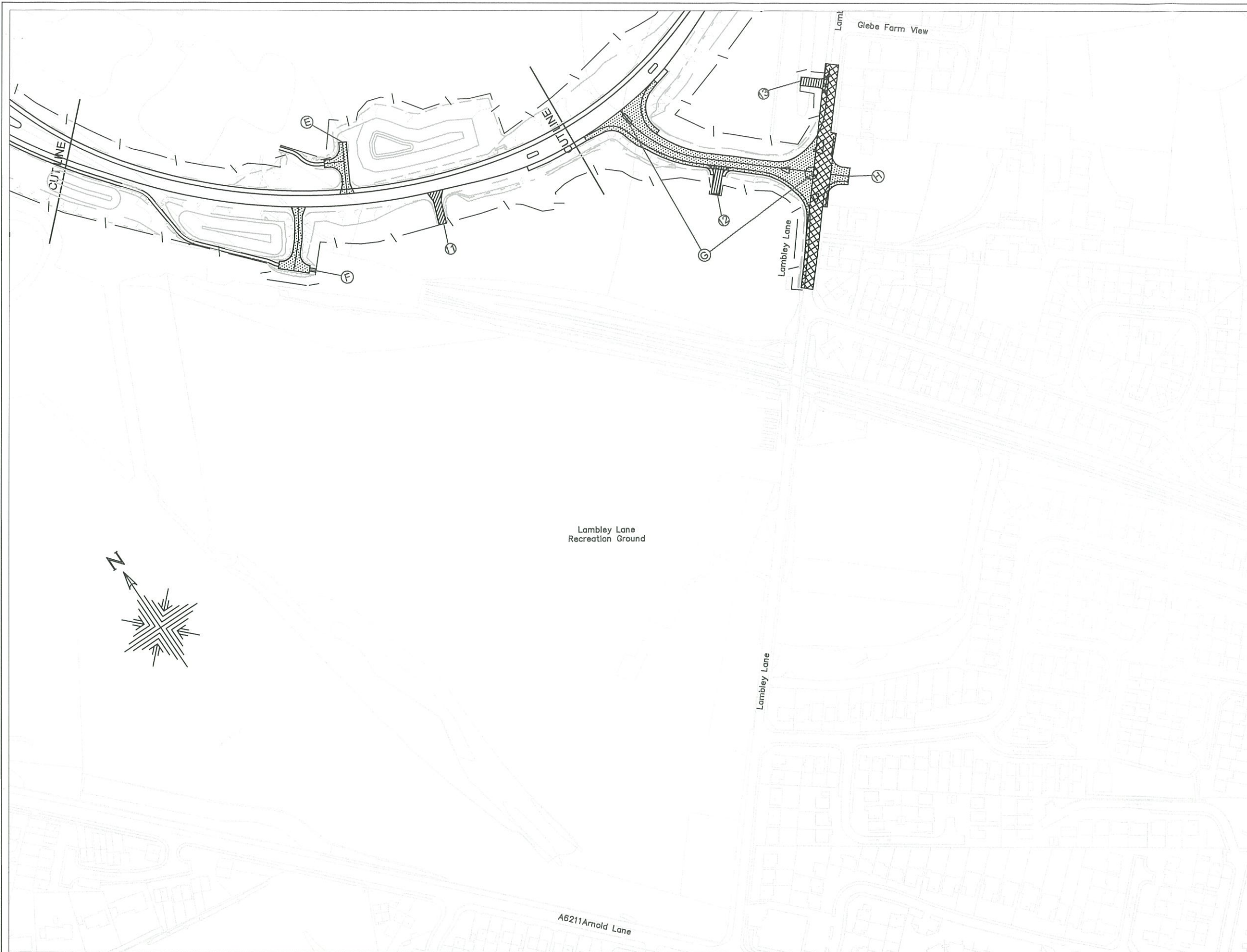

THE COMMON SEAL of THE NOTTINGHAMSHIRE COUNTY COUNCIL

was hereunto affixed this 2 day of October 2018 in the presence of: -

Affix Seal:



SEAL REGISTER NO: 45095

Sign: *Joe Beaman*

Authorised Signatory

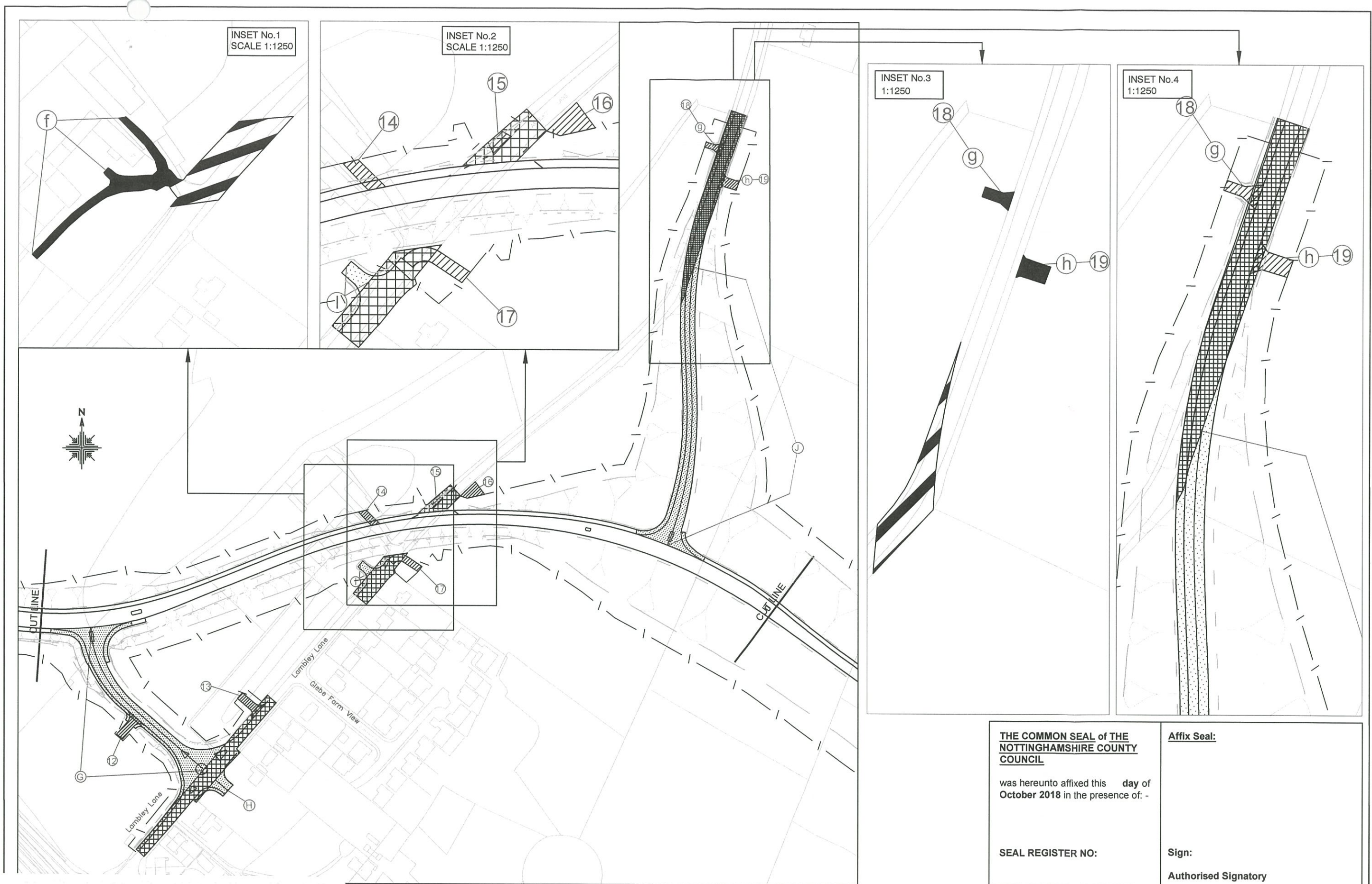

<p>THE COMMON SEAL of THE NOTTINGHAMSHIRE COUNTY COUNCIL</p> <p>was hereunto affixed this day of October 2018 in the presence of: -</p> <p>SEAL REGISTER NO:</p>	<p>Affix Seal:</p> <p>Sign:</p> <p>Authorised Signatory</p>
---	--

This Map, Drawing Reference **SITE PLAN 4 OF 6 REVISION B**, replaces the Map Drawing Reference **SITE PLAN 4 OF 6**, by modification by the Secretary of State for Transport upon confirmation of the Order by him.

Ordnance Survey material with the permission of Ordnance Survey on Her Majesty's Stationary Office, © Crown copyright. It infringes Crown copyright and may lead to prosecution or civil proceedings. Council, License Number: 100019713, 2018

THE NOTTINGHAMSHIRE COUNTY COUNCIL
(B684 TO A612 LINK ROAD) A6211 GEDLING ACCESS ROAD
(SIDE ROADS) ORDER 2018

DRAWING REFERENCE:
 SITE PLAN 4 OF 6
 REVISION B

LAMBLEY LANE ALTERATIONS
 SCALE 1:2500 @ A3

SC

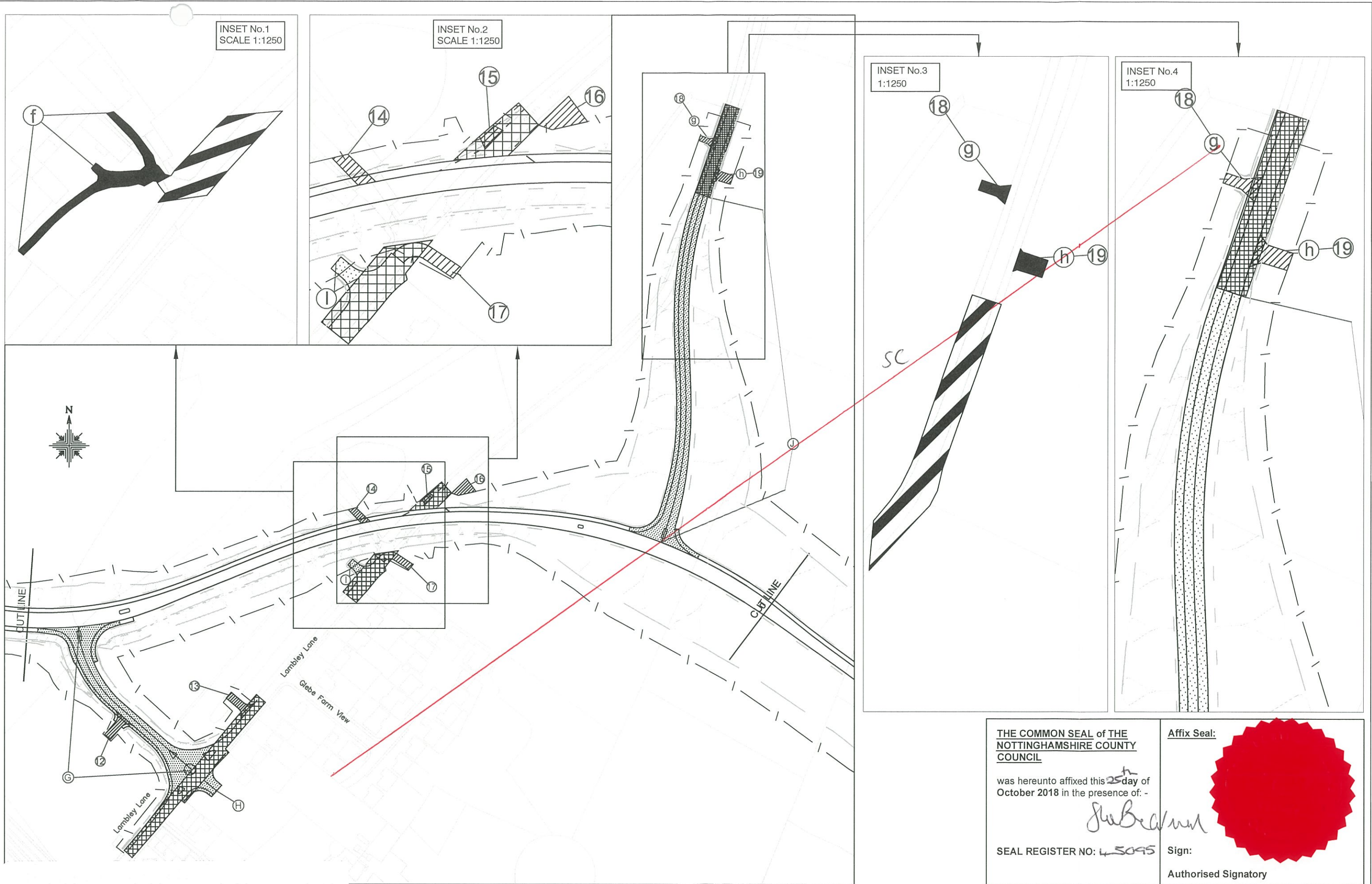

This Map, Drawing Reference SITE PLAN 4 OF 6, is replaced by the attached Map Drawing Reference SITE PLAN 4 OF 6 REVISION B, by modification by the Secretary of State for Transport upon confirmation of the Order by him.

SC

ance Survey material with the permission of Ordnance Survey on Majesty's Stationary Office, © Crown copyright. rings Crown copyright and may lead to prosecution or civil

cil, License Number: 100019713, 2018

THE NOTTINGHAMSHIRE COUNTY COUNCIL
 (B684 TO A612 LINK ROAD) A6211 GEDLING ACCESS ROAD
 (SIDE ROADS) ORDER 2018

DRAWING REFERENCE:
 SITE PLAN 4 OF 6

LAMBLEY LANE ALTERATIONS
 SCALE 1:2500 @ A3

THE COMMON SEAL of THE
 NOTTINGHAMSHIRE COUNTY
 COUNCIL

was hereunto affixed this 25th day of
 October 2018 in the presence of: -

John Bealman

SEAL REGISTER NO: 45095

Affix Seal:

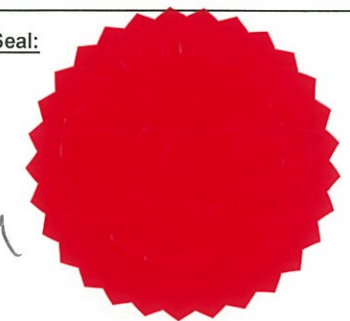

Sign:

Authorised Signatory

INSET NO.2
SCALE 1:1250

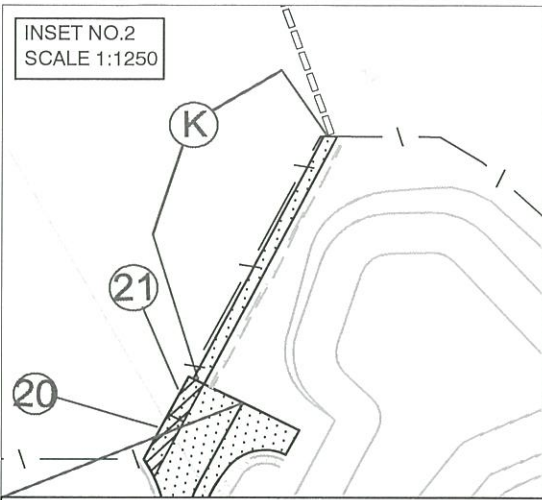

INSET NO.1
SCALE 1:1250

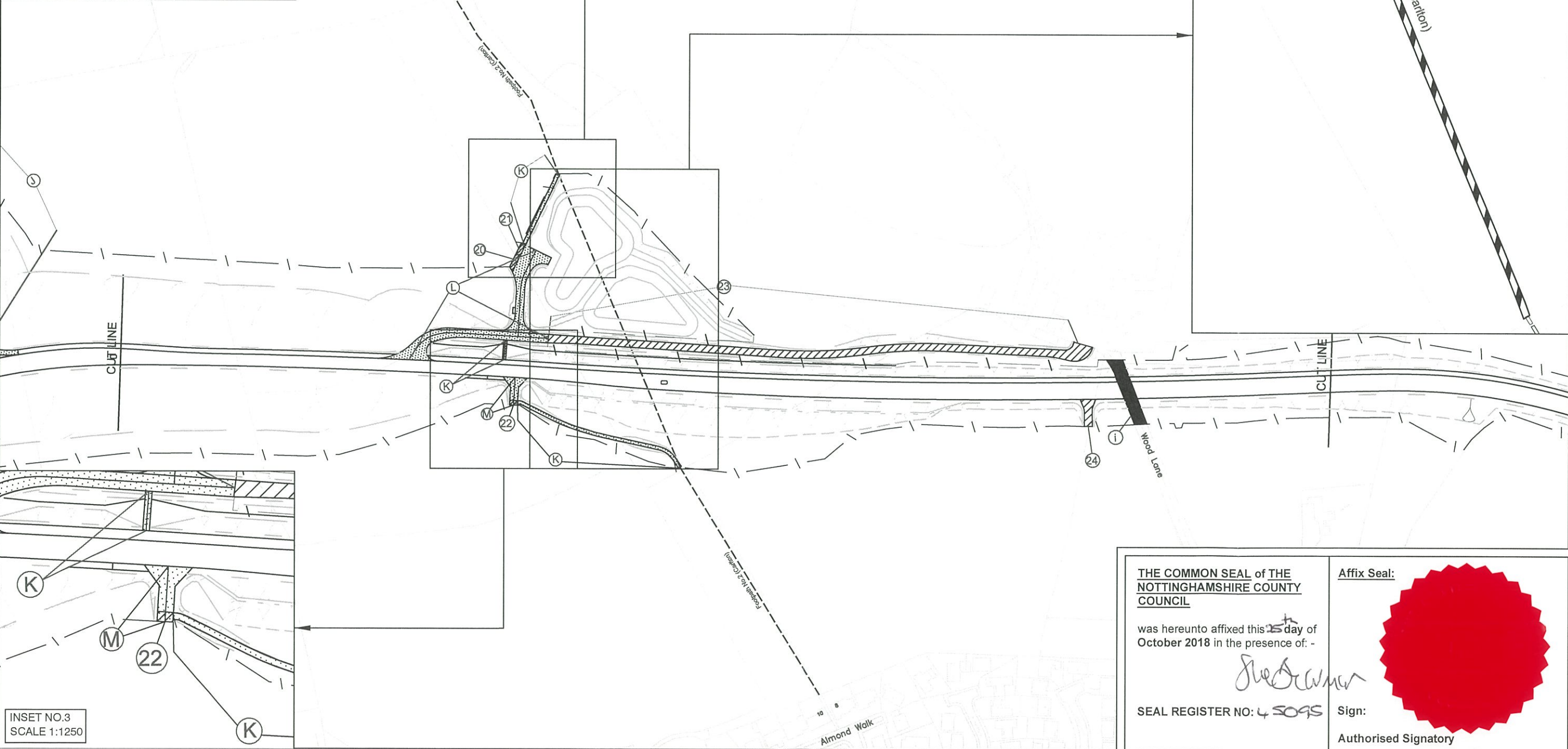
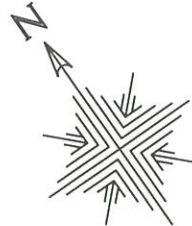
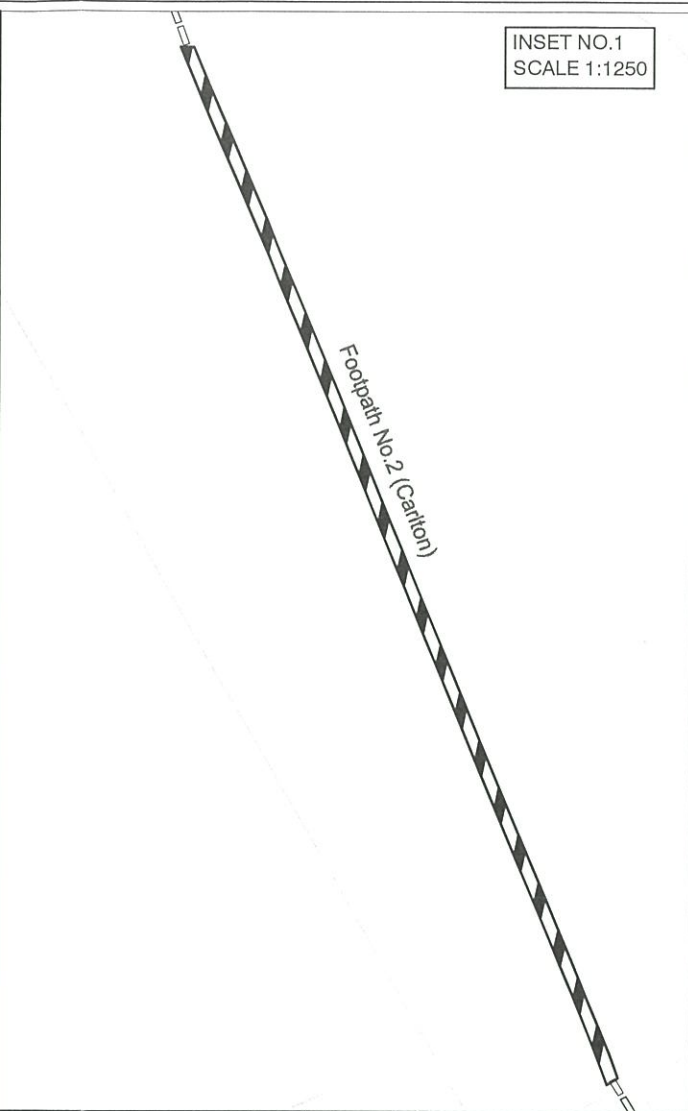

INSET NO.3
SCALE 1:1250

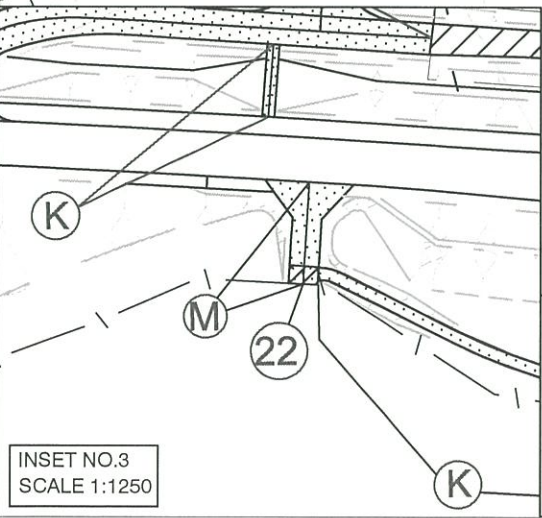

<p>THE COMMON SEAL of THE NOTTINGHAMSHIRE COUNTY COUNCIL</p> <p>was hereunto affixed this ¹⁵ day of October 2018 in the presence of: -</p> <p><i>Steve Deamer</i></p> <p>SEAL REGISTER NO: 4 5095</p>	<p>Affix Seal:</p>  <p>Sign:</p> <p>Authorised Signatory</p>
---	---



THE COMMON SEAL of THE NOTTINGHAMSHIRE COUNTY COUNCIL

was hereunto affixed this day of **October 2018** in the presence of: -

Affix Seal:

SEAL REGISTER NO:

Sign:

Authorised Signatory

This Map, Drawing Reference **SITE PLAN 6 OF 6 REVISION B**, replaces the Map Drawing Reference **SITE PLAN 6 OF 6**, by modification by the Secretary of State for Transport upon confirmation of the Order by him.

SC

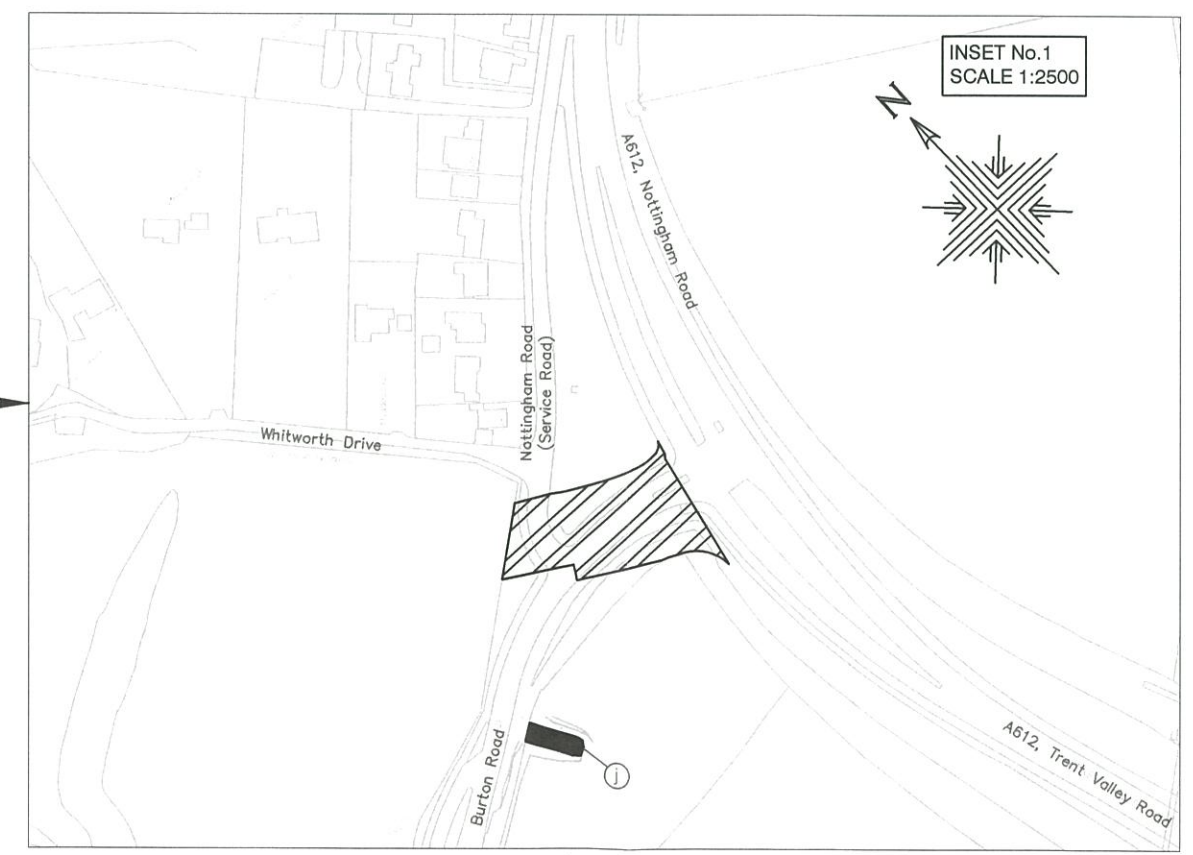

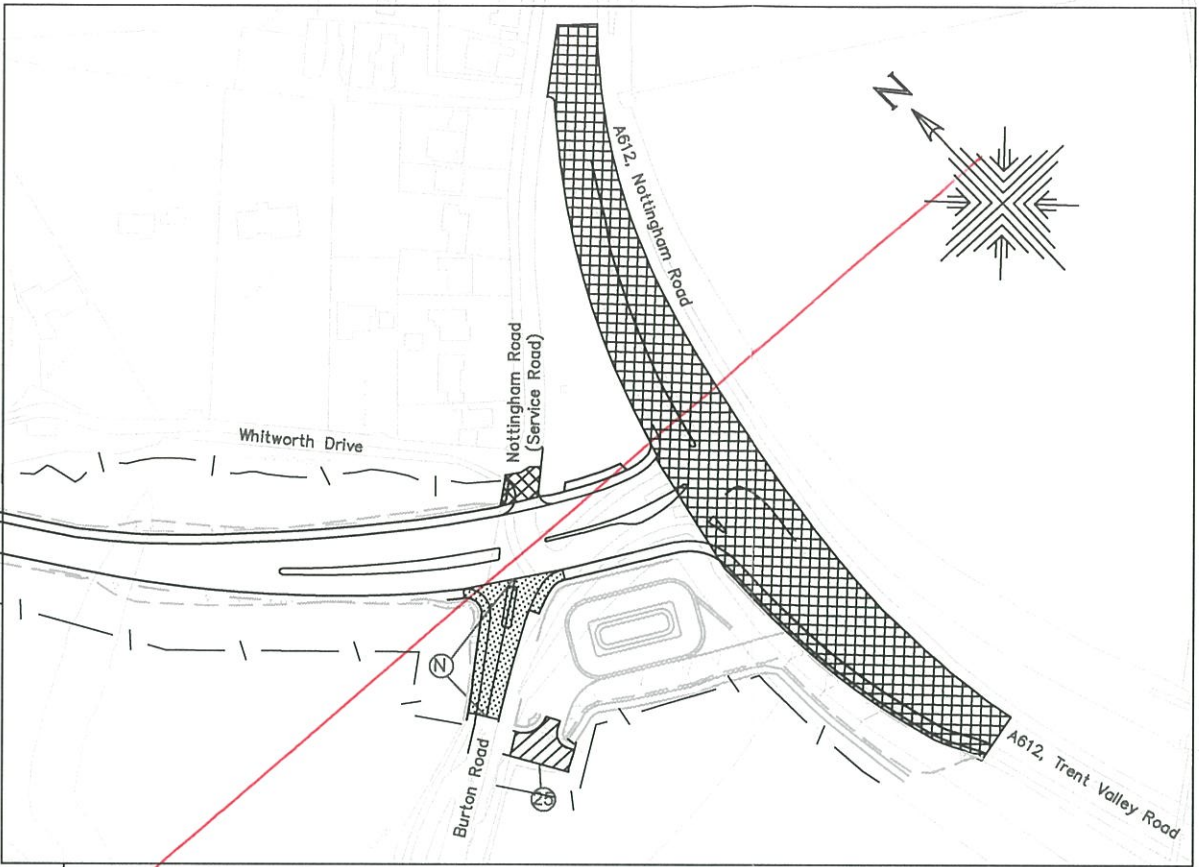

THE COMMON SEAL of THE NOTTINGHAMSHIRE COUNTY COUNCIL

was hereunto affixed this 25th day of October 2018 in the presence of: -



SEAL REGISTER NO: 45095

Sign: *[Signature]*

Authorised Signatory

This Map, Drawing Reference SITE PLAN 6 OF 6, is replaced by the attached Map Drawing Reference SITE PLAN 6 OF 6 REVISION B, by modification by the Secretary of State for Transport upon confirmation of the Order by him.

