

Map referred to in The Nottinghamshire County Council (Gedling Access Road) Compulsory Purchase Order 2018

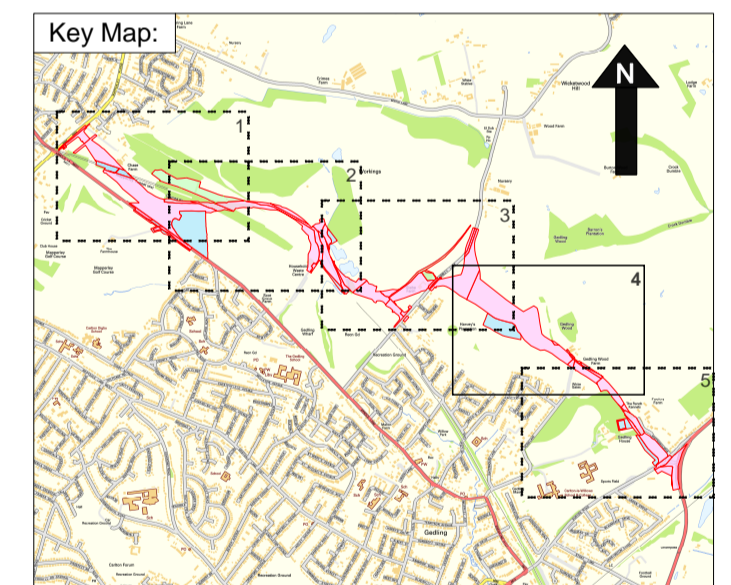
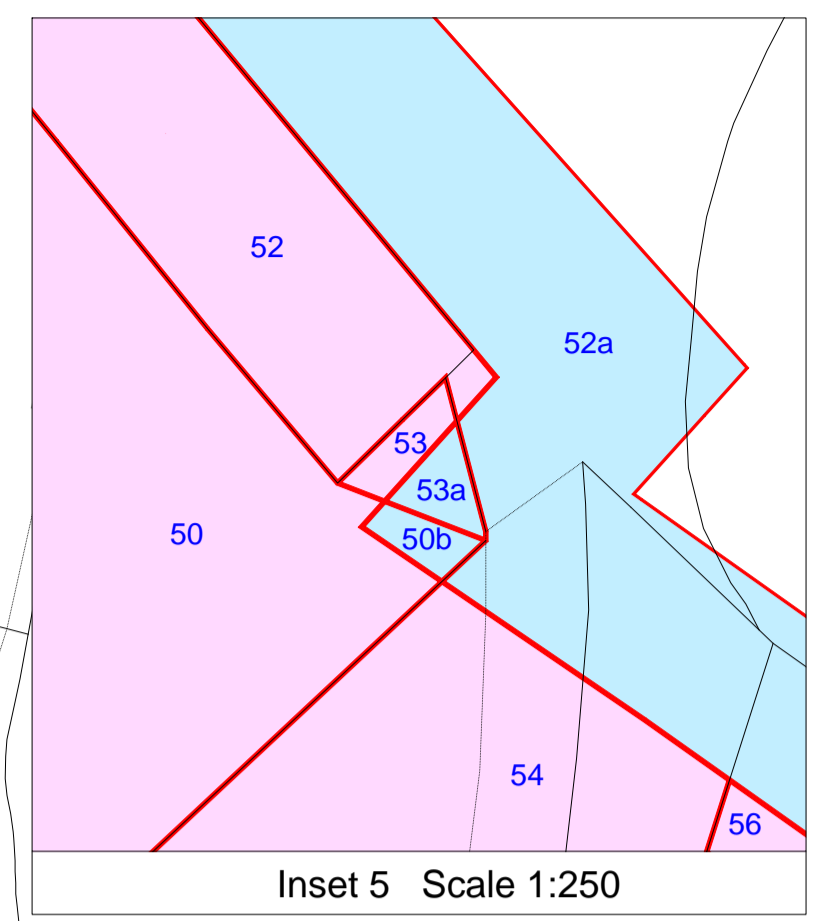
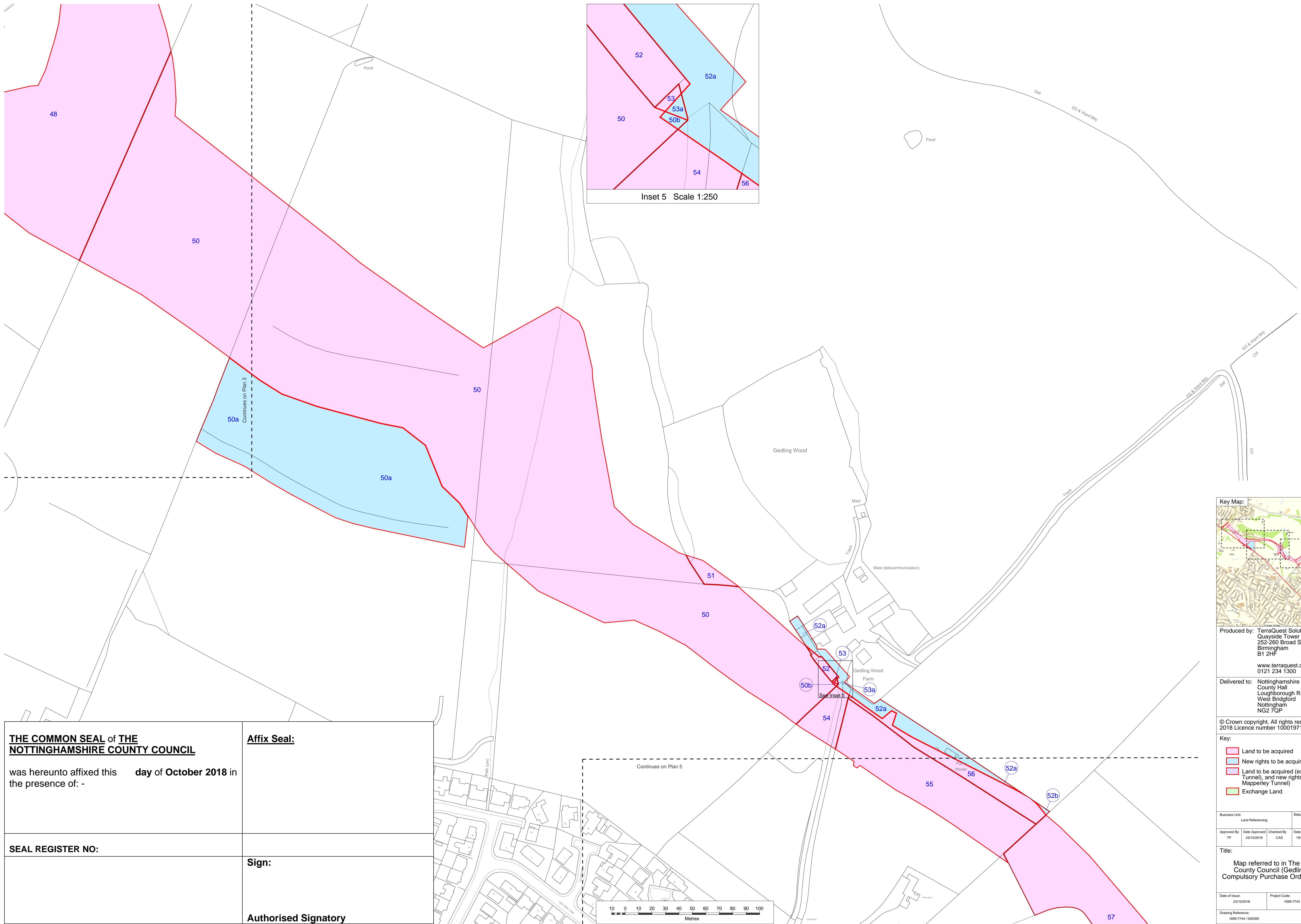
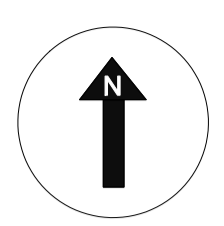

Produced by: TerraQuest Solutions Limited
 Quayside Tower
 252-260 Broad Street
 Birmingham
 B1 2HF

www.terraquest.co.uk
 0121 234 1300

Delivered to: Nottinghamshire County Council
 County Hall
 Loughborough Road
 West Bridgford
 Nottingham
 NG2 7QP

© Crown copyright. All rights reserved.
 2018 Licence number 100019713

Key:

- Land to be acquired
- New rights to be acquired
- Land to be acquired (except Mapperley Tunnel), and new rights to be acquired (over Mapperley Tunnel)
- Exchange Land

Business Unit:	Land Referencing	Status:	Final
Approved By:	Date Approved:	Checked By:	Date Checked:
TP	23/10/2018	CAS	19/10/2018
Drawn By:	PMAC	Date Drawn:	19/10/2018

Title:
 Map referred to in The Nottinghamshire County Council (Gedling Access Road) Compulsory Purchase Order 2018 - Plan 4 of 5

Date of Issue:	Project Code:	Scale:
23/10/2018	1699-7744	1:1,250 @ A1
Drawing Reference:	Version:	
1699-7744 / 000355	6.0	

<p>THE COMMON SEAL of THE NOTTINGHAMSHIRE COUNTY COUNCIL</p> <p>was hereunto affixed this day of October 2018 in the presence of: -</p>	<p>Affix Seal:</p>
<p>SEAL REGISTER NO:</p>	<p>Sign:</p>
<p>_____</p>	<p>_____</p> <p>Authorised Signatory</p>

