



**WOODLAND
TRUST**

Nottinghamshire County Council
Planning & Economic Development
Trent Bridge House
Fox Road
West Bridgford
Nottinghamshire
NG2 6BJ

The Woodland Trust
Kempton Way
Grantham
Lincolnshire
NG31 6LL

Telephone
01476 581111
Facsimile
01476 590808
Website
woodlandtrust.org.uk

4 June 2013

Dear Sir/Madam

HIGHWAYS ACT 1980 - SECTION 31 (6)

Further to previous lodgements sent to your Council, please find enclosed the Statutory Declaration as required under the Highways Act 1980 - Section 31 (6) for the property detailed below.

Wood Name	Location	Grid Reference	WT Wood Ref.
Newstead Priory Wood	Ravenshead	SK541552	00774







I would be grateful if you could kindly acknowledge acceptance of the declaration to ensure our records are updated correctly.

I confirm that I have no objection to corresponding with you via email if this is helpful to you.

Yours faithfully

Averil Harold (Mrs)
Legal Officer
☎ 08452 935 601
✉ averilharold@woodlandtrust.org.uk

Statutory Declaration Legend

-  Woodland Trust Boundary
-  Footpath
-  Bridleway
-  Byway Open to All Traffic
-  Restricted Byway
-  Other legal route

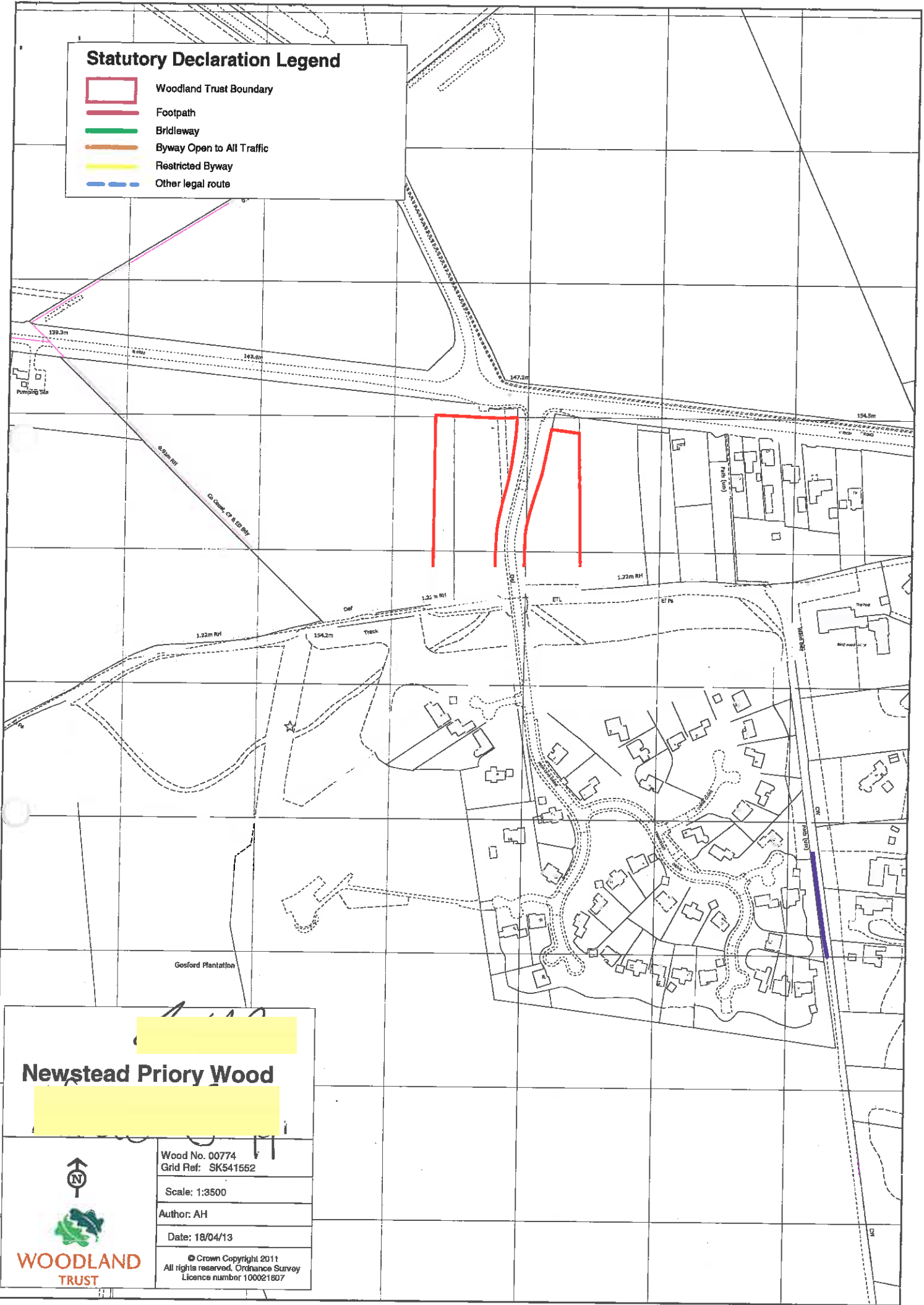

Newstead Priory Wood

Wood No. 00774
Grid Ref: SK541552

Scale: 1:3500

Author: AH

Date: 18/04/13

© Crown Copyright 2011
All rights reserved. Ordnance Survey
Licence number 100021607



WOODLAND TRUST

STATUTORY DECLARATION

HIGHWAYS ACT 1980 SECTION 31 (6)

I AVERIL HAROLD DO SOLEMNLY AND SINCERELY DECLARE as follows:

1. The Woodland Trust, a company limited by guarantee and registered charity no. 294344, is and has been since **11 April 1996** the owner of the land known as Newstead Priory Wood, Ravenshead more particularly delineated on the plan accompanying this declaration and thereon edged red.
2. On the 9 July 2003 the Woodland Trust deposited with Nottinghamshire County Council, being the appropriate Council, a statutory declaration stating that no additional ways [other than those marked in the appropriate colour on the plan accompanying this declaration] had been dedicated as footpaths since the deposit of the statement 12 February 1997.
3. No additional ways have been dedicated over the land edged red on the plan accompanying this declaration since the statutory declaration referred to in 2 above [other than those footpaths marked in the appropriate colour on the plan accompanying this declaration] and at the present time the Woodland Trust has no intention of dedicating any more public rights of way over its property.

AND I MAKE this solemn declaration on the *30th* day of *May*, 2013 conscientiously believing it to be true and by virtue of the Statutory Declarations Act 1835.

Declared at: The Woodland Trust, Kempton Way, Grantham, Lincolnshire, NG31 6LL

.....
Averil Harold (Mrs)

Legal Officer authorised to sign on behalf of the Woodland Trust

Before me, Nicola Briggs, Solicitor, of Messrs Hellewell Pasley & Brewer 66/68
Daisy Hill Dewsbury West Yorkshire WF13 1LS

This matter is being dealt with by:

Tim Hart

Reference: H/TH/1477M/0692L

T 0115 977 4395

E tim.hart@nottscc.gov.uk

W www.nottinghamshire.gov.uk

12 June 2013



**Nottinghamshire
County Council**

Mrs A. Harold
Legal Officer
The Woodland Trust
Kempton Way
Grantham
Lincs
NG31 6LL

Dear Mrs Harold

**NOTTINGHAMSHIRE COUNTY COUNCIL
DEPOSIT OF STATEMENT AND PLAN AND STATUTORY DECLARATION - SECTION 31(6) OF
THE HIGHWAYS ACT 1980**

PARISH: RAVENSHEAD

NAME OF LANDOWNER: THE WOODLAND TRUST

NAME OF PROPERTY: NEWSTEAD PRIORY WOOD

I wish to acknowledge the receipt of your ~~deposited Statement and Plan and~~ Statutory Declaration on 4 June 2013.

The information contained in the Declaration will be held by this Authority as validation for the contents of the Statement and Plan. It will be necessary for you or your successors to renew the Statutory Declaration every ten years, commencing from the date of the initial Statutory Declaration.

Any changes to your land holding or to the rights of way information in your initial Statement and Plan should be notified to the Rights of Way section, and should also be identified within a new Statutory Declaration covering a modified Statement and Plan.

Yours sincerely

Tim Hart
Senior Definitive Map Officer

EPE.TH/AA19
Dr T Hart
(0115) 977 4395
(0115) 977 2414
tim.hart@nottscc.gov.uk
31 July 2003

Miss Sarah Priestman
The Woodland Trust
Autumn Park
Dysart Road
Grantham
Lincs
NG31 6LL

1st Class

Dear Sir/Madam

**NOTTINGHAMSHIRE COUNTY COUNCIL
DEPOSIT OF STATEMENT AND PLAN AND STATUTORY DECLARATION -
SECTION 31(6) OF THE HIGHWAYS ACT 1980
PARISH: RAVENSHEAD
NAME OF LANDOWNER: THE WOODLAND TRUST
NAME OF PROPERTY: NEWSTEAD PRIORY WOOD**

I wish to acknowledge the receipt of your ~~deposited Statement and Plan and~~ Statutory Declaration on 21 July 2003.

The information contained in the Declaration will be held by this Authority as validation for the contents of the Statement and Plan. It will be necessary for you or your successors to renew the Statutory Declaration every ten years, commencing from the date of the initial Statutory Declaration.

Any changes to your land holding or to the rights of way information in your initial Statement and Plan should be notified to the Rights of Way section, and should also be identified within a new Statutory Declaration covering a modified Statement and Plan.

Yours faithfully

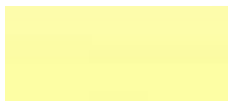

Tim Hart
Senior Definitive Map Officer



WOODLAND
TRUST

014721

→ TIM HART

PT?

HIGHWAY MANAGEMENT
Received
21 JUL 2003
Rights of Way?
62100
Note C.C.

The Woodland Trust
Autumn Park
Dysart Road
Grantham
Lincolnshire
NG31 6LL
Telephone
01476 581111
Facsimile
01476 590808
Website
www.woodland-trust.org.uk

Planning & Economic Development
Nottinghamshire County Council
Trent Bridge House
Fox Road
West Bridgford
Nottinghamshire
NG2 6BJ

Our Ref:SJP/sjp/00774

17 July 2003

Dear Sir

HIGHWAYS ACT 1980 - SECTION 31 (6)
Newstead Priory Wood, Ravenshead, Nottinghamshire
Grid Reference: SK541552

Further to a statutory declaration lodged on 21 October 1997 by my predecessor Laura Judson please find enclosed the Statutory Declaration as required under the Highways Act 1980 - Section 31 (6) for the property detailed above.

I would be grateful if you could kindly acknowledge acceptance of this declaration.

Yours faithfully

[Redacted Signature]
Miss Sarah Priestman
Trainee Land Agent

STATUTORY DECLARATION

HIGHWAYS ACT 1980 SECTION 31 (6)

I SARAH PRIESTMAN DO SOLEMNLY AND SINCERELY DECLARE as follows:

1. The Woodland Trust, a company limited by guarantee and registered charity no. 294344, is and has been since 11 April 1996 the owner of the land known as Newstead Priory Wood, Ravenshead, Nottinghamshire more particularly delineated on the plan accompanying this declaration and thereon edged red.
2. On the 12 of February 1997 the Woodland Trust deposited with Nottinghamshire County Council, being the appropriate Council, a statement accompanied by a plan delineating our property by red edging which stated that the ways coloured purple on the said plan and on the plan accompanying this declaration had been dedicated as footpaths and no other ways had been dedicated as highways over our property.
3. On the 21 day of October 1997 my predecessor in title Laura Judson deposited with Nottinghamshire County Council, being the appropriate Council, a statutory declaration dated 21 October 1997 stating that no additional ways other than those marked in the appropriate colour on the plan accompanying this declaration had been dedicated as footpaths since the deposit of the statement referred to in 2 above.
4. No additional ways have been dedicated over the land edged red on the plan accompanying this declaration since the date of the statutory declaration referred to in 3 above other than those footpaths marked in the appropriate colour on the plan accompanying this declaration and at the present time the Woodland Trust has no intention of dedicating any more public rights of way over its property.

AND I MAKE this solemn declaration on the day of 2003
conscientiously believing it to be true and by virtue of the Statutory Declarations Act
1835.



Declared at: The Woodland Trust, Autumn Park, Dysart Road, Grantham, Lincolnshire,
NG31 6LL

.....
Sarah Priestman
Trainee Land Agent authorised to sign on behalf of the Woodland Trust

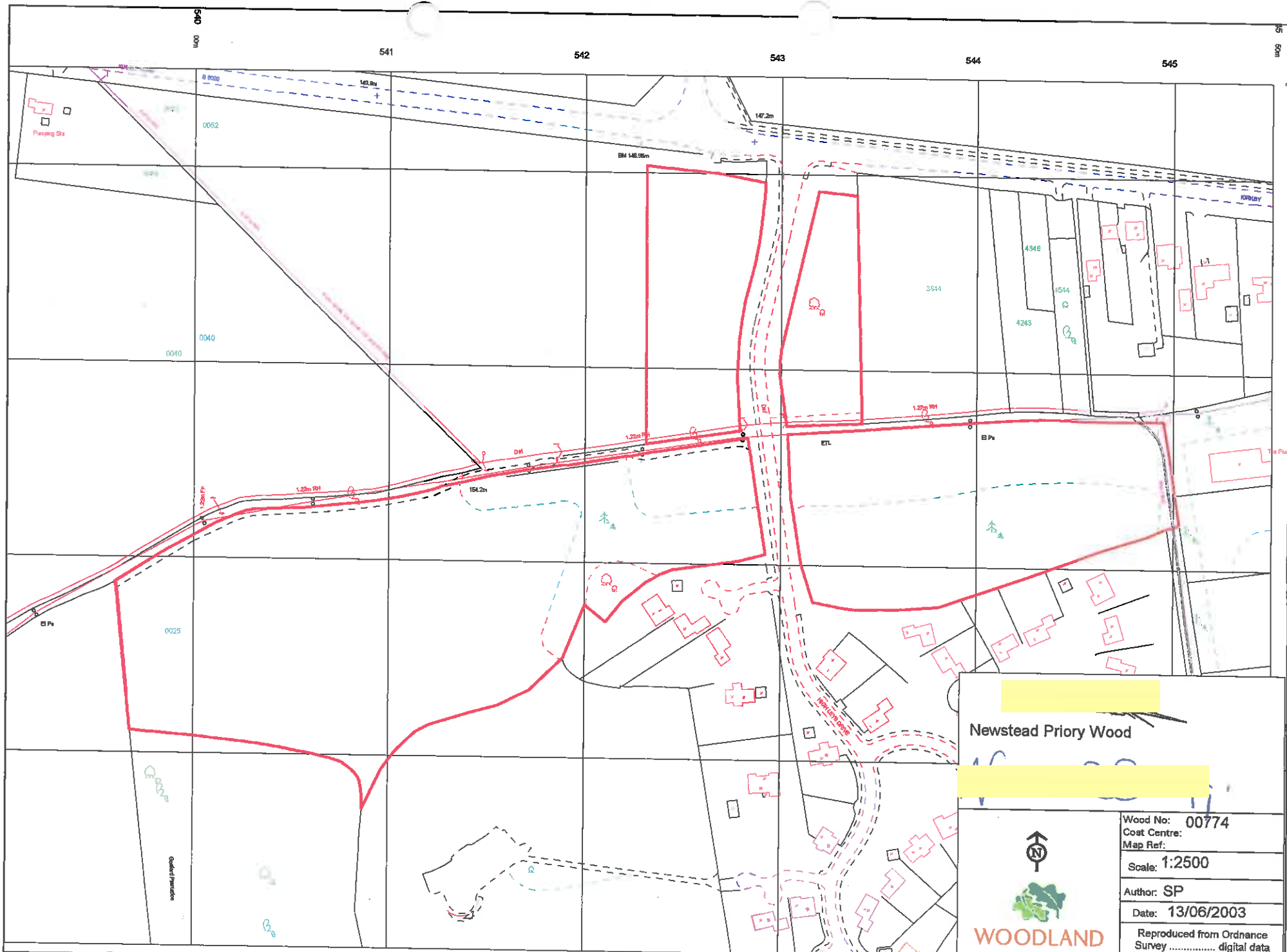
Before me, Nicola Briggs, Solicitor, of Jordans Solicitors, Dewsbury, West Yorkshire
.....



Newstead Priory Wood

  WOODLAND TRUST	Wood No: 00774 Coat Centre: Map Ref: Scale: 1:2500 Author: SP Date: 13/06/2003 Reproduced from Ordnance Survey digital data © Crown Copyright. AL559385
---	--

59

LHJ/IW/774
PTC.RC/AA15/RC/138
Robin Carr
(0115) 977 4198
(0115) 977 2414
19 February 1997

The Woodland Trust
Autumn Park
Dysart Road
Grantham
Lincolnshire
NG31 6LL

FAO Laura Judson

Dear Sirs

**HIGHWAYS ACT 1980, SECTION 31(6)
LAND AT NEWSTEAD HOSPITAL, RAVENSHEAD, NOTTINGHAMSHIRE**

I refer to your letter dated 12 February 1997 regarding the above matter and acknowledge receipt of the formal notice.

In the notice, attached to the above letter, you have referred to a public highway shown by a "dotted red" line on the plan when, in fact, the path is shown by a solid red line. In view of this minor anomaly, I must advise that the route shown by a solid red line on your plan is recorded on the Definitive Map of Public Footpath, Newstead No 1. I have attached a copy of this letter to your notice to clarify the situation, rather than requiring the deposition of an amended plan or notice.

I trust that the above is to your satisfaction and look forward to receiving the required Statutory Declarations in due course.

Yours faithfully

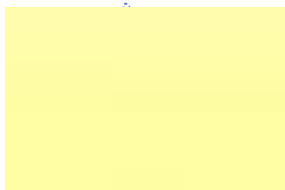

for Group Manager (Countryside)

Patrons:

The Lord Barber of Tewkesbury; Dr J. Morton Boyd, C.B.E., F.R.S.E.;
Dame Sylvia Crowe, D.B.E.; Sir James Stormonth Darling, C.B.E., M.C.;
The Right Honourable Lord Denning; P. F. Garthwaite Esq., O.B.E.;
R. Hammond Innes Esq., C.B.E.; The Earl of Lichfield;
Dame Moura Lympny, D.B.E.; E. M. Nicholson Esq., C.B., C.V.O.

Founder and President

K. Watkins, O.B.E.

Council of Management:

T. H. White, F.R.I.C.S. (Chairman);
C. F. Wright, M.Sc. A.R.I.C.S., A.L.I.; R. H. Trafford M.A.;
T. W. Wright, B.Sc. (For.), Ph.D.; D. H. Marks, M.I.P.A.;
A. P. Golding, F.C.A., A.T.I.I.; D. V. Gaulter, C.B.E., M.A., B.L.
M. F. Barton, LL.B., P. Oliver F.C.A.

RC/138

21764

the
woodland
trust



Chief Executive: John D. James, O.B.E.

Public Rights of Way Unit
Nottinghamshire County Council
Bassetlaw Area Office
Bolham Lane
Retford
DN22 6SU

The Woodland Trust
Autumn Park, Dysart Road,
Grantham, Lincolnshire NG31 6LL
Telephone: (01476) 581111
Fax: (01476) 590808

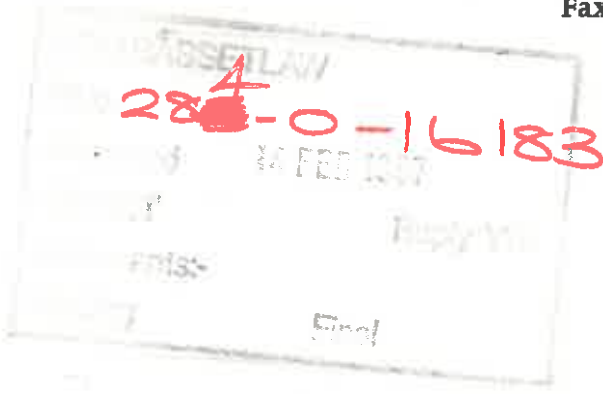

Our Ref LHJ/lhj/774

12 February 1997

Dear Sir

Highways Act 1980 - Section 31(6)
Newstead Hospital, Ravenshead, Nottinghamshire

I enclose a notice as required by the above Act declaring ways known to be public highways on the above property. It is the Trust's aim to confirm its intention not to dedicate any further highways over its property by depositing a Statutory Declaration to this effect within six years from today and to repeat this process thereafter.

I would welcome any comments which you wish to make on this letter and enclosures.

Please acknowledge receipt of the formal notice.

Yours faithfully



Laura Judson
Legal Administrator

Encs



Patrons:

The Lord Barber of Tewkesbury; Dr J. Morton Boyd, C.B.E., F.R.S.E.;
Dame Sylvia Crowe, D.B.E.; Sir James Stormonth Darling, C.B.E., M.C.;
The Right Honourable Lord Denning; P. F. Garthwaite Esq., O.B.E.;
R. Hammond Innes Esq., C.B.E.; The Earl of Lichfield;

Dame Moura Lympany, D.B.E.; E. M. Nicholson Esq., C.B., C.V.O.

Founder and President

K. Watkins, O.B.E.

Council of Management:

T. H. White, F.R.I.C.S. (Chairman);

C. P. Wright, M.Sc. A.R.I.C.S., A.L.I.; R. H. Trafford M.A.;

T. W. Wright, B.Sc. (For.), Ph.D.; D. H. Marks, M.I.P.A.;

A. P. Golding, F.C.A., A.T.L.I.; D. V. Gaulter, C.B.E., M.A., B.L.

M. F. Barton, LL.B., P. Oliver F.C.A.



Chief Executive: John D. James, O.B.E.

Public Rights of Way Unit
Nottinghamshire County Council
Bassetlaw Area Office
Bolham Lane
Retford
DN22 6SU

The Woodland Trust
Autumn Park, Dysart Road,
Grantham, Lincolnshire NG31 6LL
Telephone: (01476) 581111
Fax: (01476) 590808

Our Ref LHM/lhj/774

12 February 1997

Dear Sir

The Woodland Trust, a company limited by guarantee and registered charity no: 294344, of Autumn Park, Dysart Road, Grantham, Lincolnshire, freehold owners of the property known as Newstead Hospital, Ravenshead, Nottinghamshire which is shown on the attached plan, hereby gives notice in accordance with the Section 31(6) of the Highway Act 1980 that there are ways shown dotted red on the plan attached as being owned by the Woodland Trust which have been dedicated as public highways. It is the Woodland Trust's intention not to dedicate any further ways in the future.

Yours faithfully

Laura Judson

Legal Administrator authorised to sign on behalf of the Woodland Trust

Enc

NEWSTEAD HOSPITAL

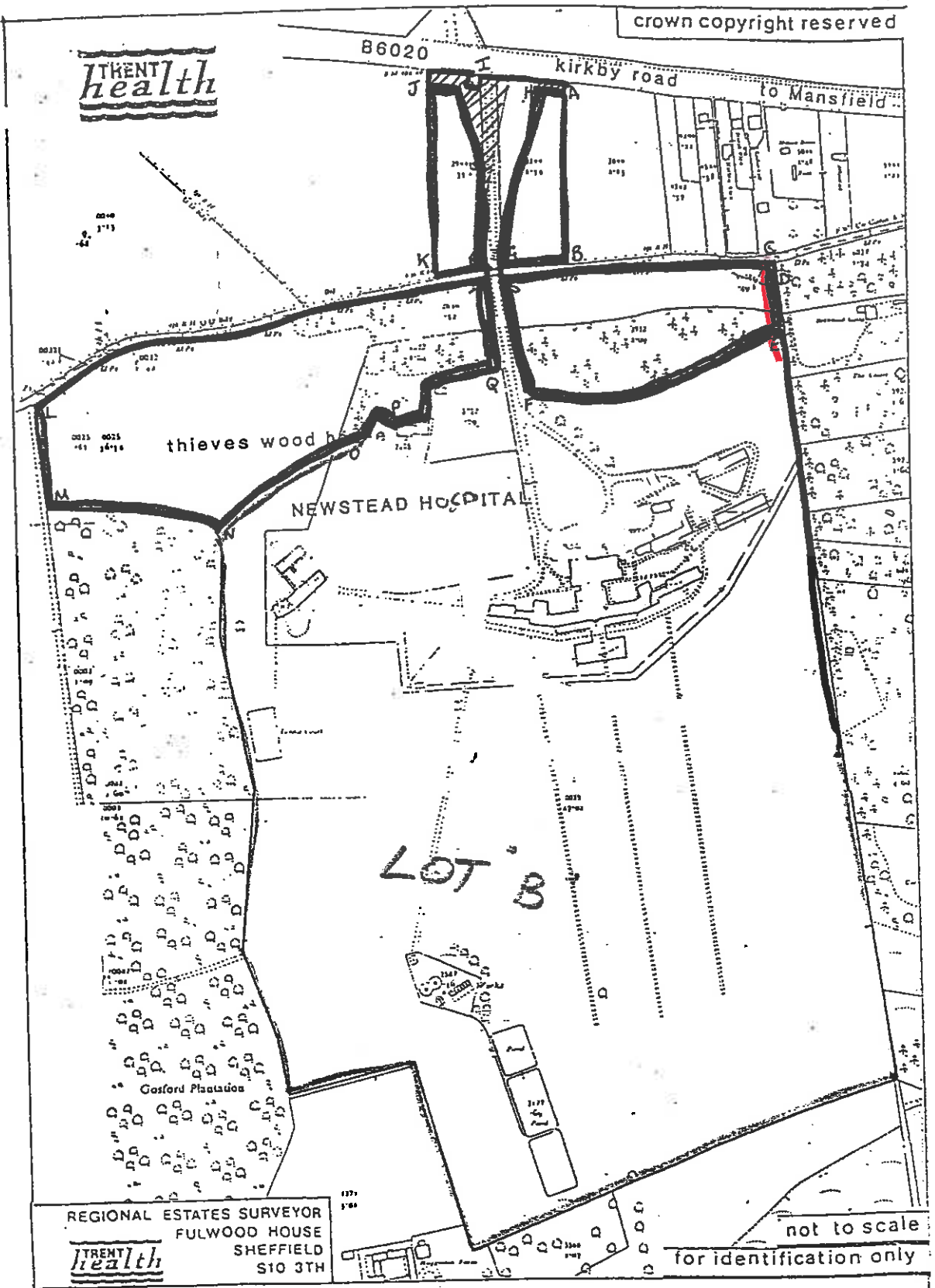

NEWSTEAD

Copy of.
Contract map