

10. 'Appropriate authority' means (a) in relation to a map or statement deposited or declaration lodged under section 31(6) of that Act, an appropriate council (as defined in section 31(7) of the Highways Act 1980); and (b) in relation to a statement and map deposited under section 15A(1) of the 2006 Act, a commons registration authority (defined in section 4 of the Commons Act 2006 and section 2 of the Commons Registration Act 1965). In practice, the appropriate council and commons registration authority will usually be the same body.

**PART A: Information relating to the applicant and land to which the application relates
(all applicants must complete this Part)**

1. Name of appropriate authority to which the application is addressed:

Nottinghamshire County Council

2. Name and full address (including postcode) of applicant:

Dr Dilip and Mrs Liane Malkan

Copper Beeches, Nether Langwith, Mansfield, Nottinghamshire, NG20 9JQ

3. Status of applicant (tick relevant box or boxes):

I am

(a) the owner of the land(s) described in paragraph 4.

(b) making this application and the statements/declarations it contains on behalf of [insert name of owner] who is the owner of the land(s) described in paragraph 4 and in my capacity as [insert details].

4. Insert description of the land(s) to which the application relates (including full address and postcode):

Copper Beeches
Nether Langwith
Mansfield.
Notts.
NG20 9JQ

5. Ordnance Survey six-figure grid reference(s) of a point within the area of land(s) to which the application relates (if known):

6. This deposit comprises the following statement(s) and/or declarations (*delete Parts B, C, or D where not applicable*):

PART B: Statement under section 31(6) of the Highways Act 1980

We the owner of the land described in paragraph 4 of Part A of this form and shown red on the map accompanying this statement.

No ways over the land shown red on the accompanying map have been dedicated as highways.
(*delete wording in square brackets as appropriate and/or insert information as required*)

PART C: Declaration under section 31(6) of the Highways Act 1980

1. We are the owner of the land described in paragraph 4 of Part A of this form and shown red on the map [accompanying this declaration/lodged with Nottinghamshire Council on 28th November 2017
(delete wording in square brackets as appropriate and/or insert information as required)

2. On the 21 day of November 2001 I deposited with Nottinghamshire Council, being the appropriate council, a statement accompanied by a map showing my property red which stated that:

No ways had been dedicated as highways over my property.

[3. On the 18th day of March 2008 I deposited with Nottinghamshire Council, being the appropriate council, a declaration dated 18th March 2008 stating that no additional ways had been dedicated since the deposit of the statement referred to in paragraph 2 above.

4. No additional ways have been dedicated over the land red on the map [accompanying this declaration/referenced in paragraph 1 above] since the statement dated *21st November 2001* referred to in paragraph 2 above [since the date 18th March 2008 of the declaration referred to in paragraph 3 above] and at the present time I have no intention of dedicating any more public rights of way over the property.

~~**PART D: Statement under section 15A(1) of the Commons Act 2006**~~

~~I am the owner of the land described in paragraph 4 of Part A of this form and shown red on the map [accompanying this statement/deposited with Nottinghamshire Council on 28th November 2017~~

~~I wish to bring to an end any period during which persons may have indulged as of right in lawful sports and pastimes on the whole or any part of the land shown red on the [accompanying map above].
(delete wording in square brackets as appropriate and/or insert information as required)~~

PART E: Additional information relevant to the application
(insert any additional information relevant to the application)

PART F: Statement of Truth
(all applicants must complete this Part)

WARNING: If you dishonestly enter information or make a statement that you know is, or might be, untrue or misleading, and intend by doing so to make a gain for yourself or another person, or to cause loss or the risk of loss to another person, you may commit the offence of fraud under section 1 of the Fraud Act 2006, the maximum penalty for which is 10 years' imprisonment or an unlimited fine, or both.

I BELIEVE THAT THE FACTS AND MATTERS CONTAINED IN THIS FORM ARE TRUE

Signature (of the person making the statement of truth):

Print full name:
Mrs Liane Malkan

Dr Dilip Malkan

Date: 28/11/17

You should keep a copy of the completed form

Data Protection Act 1998 - Fair Processing Notice

The purpose of this Fair Processing Notice is to inform you of the use that will be made of your personal data, as required by the Data Protection Act 1998.

The appropriate authority (see explanation of definition in above guidance notes) in England is the data controller in respect of any personal data that you provide when you complete this form.

The information that you provide will be used by the appropriate authority in its duties to process applications to deposit statements, maps and declarations under section 31(6) the Highways Act 1980 and statements under section 15A(1) of the Commons Act 2006. The information you provide will also be used by the appropriate authority in its duty to update the registers in which details of such deposits are recorded under the Dedicated Highways (Registers under Section 31A of the Highways Act 1980) (England) Regulations 2007 and the Commons (Registration of Town or Village Greens) and Dedicated Highways (Landowner Statements and Declarations) (England) Regulations 2013.

The appropriate authority is required by the legislation above to maintain a register which holds information provided in this form, which can be inspected online or in person by members of the public on request. It may also be required to release information, including personal data and commercial information, on request under the Environmental Information Regulations 2004 or the Freedom of Information Act 2000. However, the appropriate authority will not permit any unwarranted breach of confidentiality nor will they act in contravention of their obligations under the Data Protection Act 1998.

**Copper Beeches
Nether Langwith
Nottinghamshire**



Scale 1:10000

Produced by: David Squires

Date: 07/03/2008

This map is reproduced from Ordnance Survey materials with the permission of Ordnance Survey on behalf of the Controller of Her Majesty's Stationery Office. Crown copyright. Unauthorised reproduction infringes Crown Copyright and may lead to prosecution or civil proceedings. (Nottinghamshire County Council) (10019713), 2008



NOT DEFINITIVE

Queries about path alignment should be made to the Definitive Map Team on 0115 9773700.

Public Right of Way:

- Footpath
- Bridleway
- Byway Open to All Traffic
- RUPP
- Road Used as Public Path
- RB
- Restricted Byway

NETHER LANGWITH CP

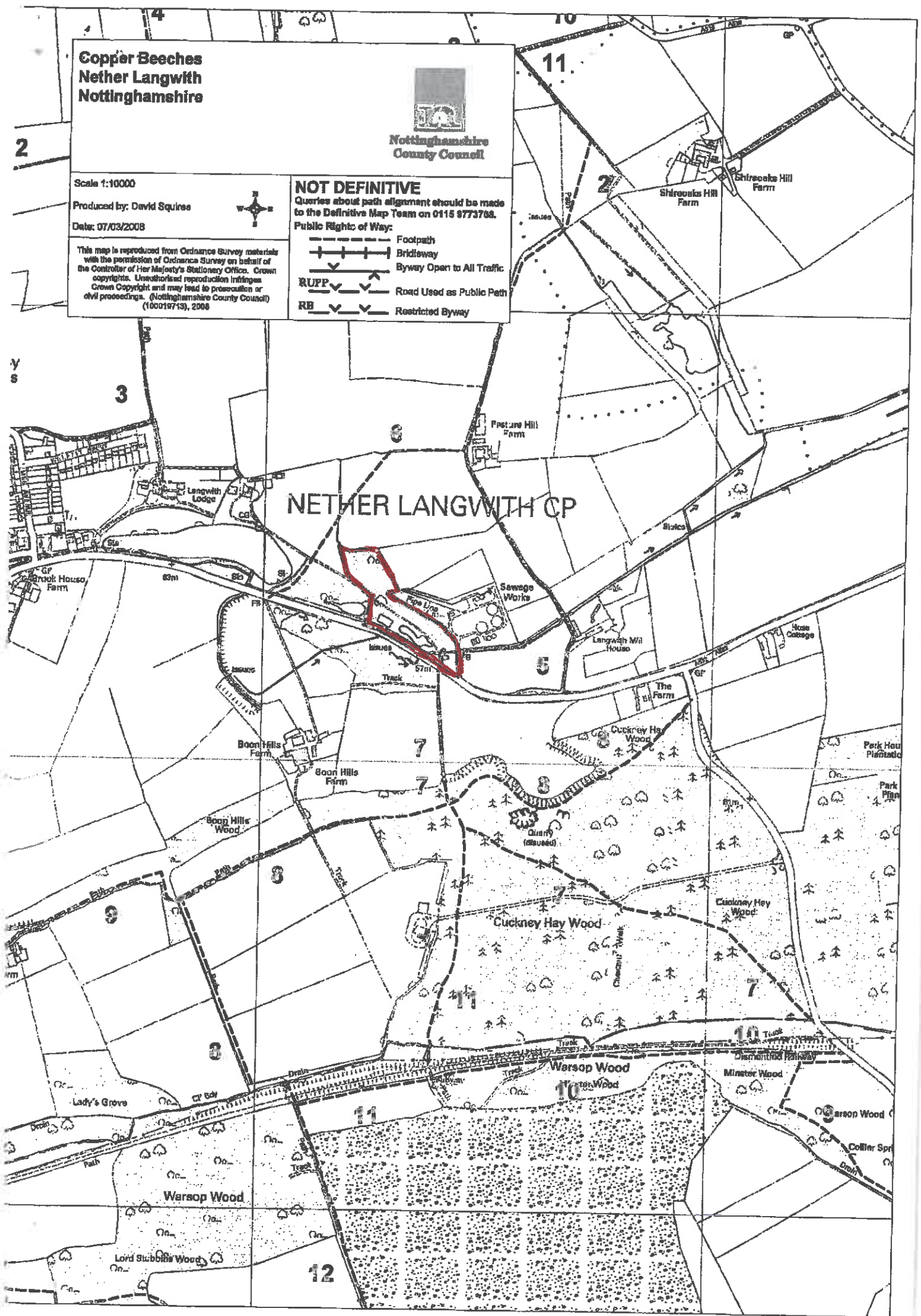





NOTTINGHAMSHIRE COUNTY COUNCIL
STATUTORY DECLARATION
SECTION 31 (6) OF THE HIGHWAYS ACT 1980

RECEIVED 406
N
19 MAR 2008
COMMUNITIES DEPT.

I LIANE MALKAN [Full Name] DO SOLEMNLY AND SINCERELY DECLARE as follows:

1. I am and have been since 21.11.2001 [day, month, year] the owner of the land known as COPPER BEECHES MAIN ROAD NETHER LANGWITH [farm name, field no. etc] more particularly delineated on the plan accompanying this declaration and thereon edged red.

2. On the 15th day of MARCH 2008 [month][year] I LIANE MALKAN [full name] deposited with Nottinghamshire County Council, being the appropriate Council, a statement accompanied by a plan delineating my property by red edging which stated that ~~*[the ways shown coloured orange/  on the said plan and on the plan accompanying this declaration are definitive or dedicated BYWAYS OPEN TO ALL TRAFFIC (B.O.A.T.s)]~~ ~~*[the ways shown coloured blue/  on the said plan and on the plan accompanying this declaration are definitive or dedicated RESTRICTED BYWAYS]~~ ~~*[the ways shown by brown dashes/  on the said plan and on the plan accompanying this declaration are definitive ROADS USED AS PUBLIC PATHS (R.U.P.P.s)]~~ ~~*[the ways shown coloured green/  on the said plan and on the plan accompanying this declaration are definitive or dedicated as BRIDLEWAYS]~~ ~~*[the ways shown coloured purple/  on the said plan and on the plan accompanying this declaration are definitive or dedicated FOOTPATHS]~~
*[There are no definitive or dedicated Rights of Way over my property.]

3. With reference to 2 above, I LIANE MALKAN [full name] confirm that there are no additional public ways over the land edged red on the Plan and in the Statement dated 15.03.2008 [day, month, year] (other than those definitive routes and dedicated routes marked on the Plan accompanying this Declaration).

* Delete as appropriate.

AND I MAKE this solemn declaration of the 15th day of March 2008 [month, year] conscientiously believing it to be true and by virtue of the Statutory Declarations Act 1835.

.....
[Signature of landowner]

Declared at [address]

Marstfield in the County of Nottinghamshire





Before me

BRYAN & ARMSTRONG
THE OLD MEETING HOUSE
STOCKWELL GATE
MANSFIELD NG18 1LG
TELE: 01623 626039 FAX: 01623 635077

[Commissioner of Oaths or a Justice of the Peace or Solicitor]

NOTTINGHAMSHIRE COUNTY COUNCIL
DEPOSIT OF STATEMENT AND PLAN
SECTION 31 (6) OF THE HIGHWAYS ACT 1980

RECEIVED
19 MAR 2008
COMMUNITIES DEPT.

1. I am and have been since 21.11.2001 [day, month, year] the owner within the meaning of the above section, of the land known as COPPER BEECHES, NETHER LANGWITH [farm name, field no. etc] more particularly delineated on the attached plan accompanying this statement and thereon edged red.
2. The aforementioned land lies in the Parishes/ Communities of NETHER LANGWITH and
- ~~3. The ways coloured orange/ shown with a  line on the said plan appear on the Definitive Map as BYWAYS OPEN TO ALL TRAFFIC (B.O.A.T.s). *~~
- ~~4. The ways coloured by orange dashes on the said plan have been dedicated as BYWAYS OPEN TO ALL TRAFFIC (B.O.A.T.s). *~~
- ~~5. The ways shown coloured blue/  on the said plan have been dedicated as RESTRICTED BYWAYS. *~~
- ~~6. The ways shown coloured by blue dashes on the said plan have been dedicated as RESTRICTED BYWAYS. *~~
- ~~7. The ways shown coloured by brown dashes/  on the said plan appear on the Definitive Map as ROADS USED AS PUBLIC PATHS (R.U.P.P.s). *~~
- ~~8. The ways shown coloured green/  on the said plan appear on the Definitive Map as BRIDLEWAYS. *~~
- ~~9. The ways shown coloured by green dashes on the said plan have been dedicated as BRIDLEWAYS. *~~
- ~~10. The shown ways coloured purple/  on the said plan appear on the Definitive Map as FOOTPATHS. *~~
- ~~11. The ways coloured by purple dashes on the said plan have been dedicated as FOOTPATHS. *~~
12. No other ways over the land have been dedicated as highways.
13. The deposit shall comprise this statement and accompanying plan.

*Delete as appropriate

Signed (landowner) 

Name (of landowner) LIANE MALKAN

Address COPPER BEECHES, MAIN ROAD
NETHER LANGWITH
MANSFIELD
NOTTINGHAMSHIRE NG20 9JQ

Date 18/03/2008

Signed (Witness) S. Harrison

Name (of witness) SUSAN HARRISON
BRYAN & ARMSTRONG

Address THE OLD MEETING HOUSE
STOCKWELL GATE
MANSFIELD NG18 1LG
TELE: 01623 626039 FAX: 01623 635077

Occupation SOLICITOR

NOTTINGHAMSHIRE COUNTY COUNCIL

DEPOSIT OF STATEMENT AND PLAN

SECTION 31 (6) OF THE HIGHWAYS ACT 1980

To

1. I am and have been since 21.11.2001 the owner within the meaning of the
[day, month, year]
above section of the land known as COPPER BEECHES more particularly delineated
[Name of Farm, etc]
on the attached plan accompanying this statement and thereon edged red.

2. The aforementioned land lies in the Parishes/Communities of [NETHER LANGWORTH]
and [MANSFIELD].

* ~~3. The ways coloured orange on the said plan appear on the Definitive Map as BYWAYS
OPEN TO ALL TRAFFIC (B.O.A.T.s).~~

* ~~4. The ways coloured by orange dashes on the said plan have been dedicated as
BYWAYS OPEN TO ALL TRAFFIC (B.O.A.T.s).~~

* ~~5. The ways coloured by brown dashes on the said plan appear on the Definitive Map as
ROADS USED AS PUBLIC PATHS (R.U.P.P.s).~~

* ~~6. The ways coloured green on the said plan appear on the Definitive Map as
BRIDLEWAYS.~~

* ~~7. The ways coloured by green dashes on the said plan have been dedicated as
BRIDLEWAYS.~~

* ~~8. The ways coloured purple on the said plan appear on the Definitive Map as
FOOTPATHS.~~

* ~~9. The ways coloured by purple dashes on the said plan have been dedicated as
FOOTPATHS.~~

* 10. No other ways over the land have been dedicated as highways.

* 11. The deposit shall comprise this statement and accompanying plan.

* Delete as applicable,

Signed (landowner)

Name (or landowner)

LIANE MALIKAN

Address

COPPER BEECHES, NETHER LANGWORTH
MANSFIELD NOTTS NG20 9JQ

Date

11/4/02

Signed (Witness)

Name (of witness)

SUSAN HARRISON

Address

BRYAN & ARMSTRONG
THE OLD MEETING HOUSE
STOCKWELL GATE
MANSFIELD NG18 1LG

Occupation

TELE: 01623 626039 FAX: 01623 635077
SOLICITOR

effects from and
 on in respect of an
 as aforesaid
 (actionable) the
 and to benefit and
 be case of restric-
 each of covenant
 erty in respect of
 the purchase and
 rfrom the stipu-
 will not interfere
 v from the pond
 said plan and the
 the flow of water
 ther be the
 be done any act
 nuisance to the
 an objection
 the plan and
 any plan
 the plan and
 the plan and
 the plan and
 the plan and
 the plan and
 the plan and
 the plan and
 the plan and

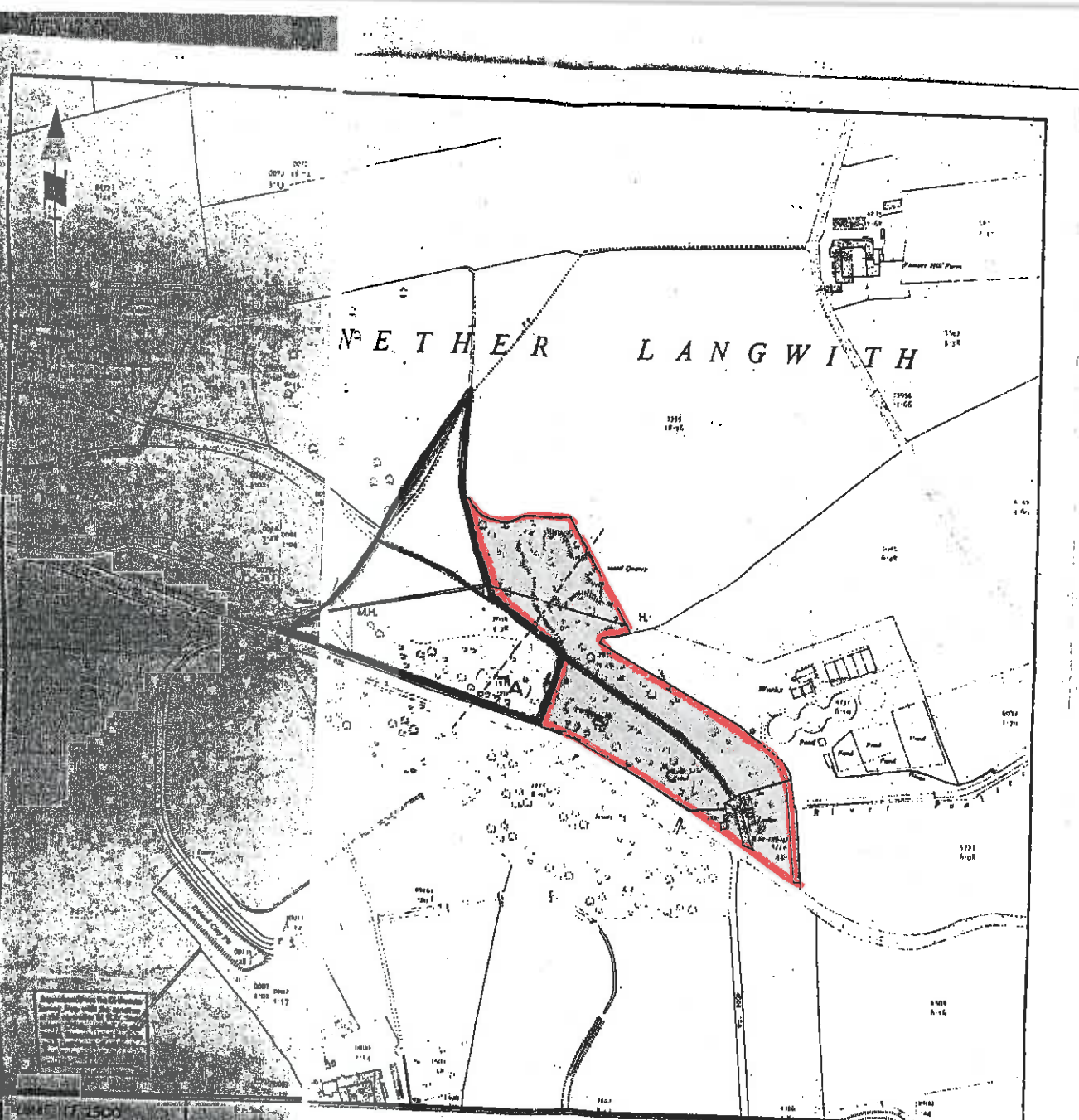

LAND AT NETHER LANGWITH.

COAL INDUSTRY
 ESTATES LTD.

ESTATES DEPT. BCLSOVER,
 Nr. CHESTERFIELD.
 E. 484

This is the plan referred to in the Statutory Declaration of Liana Malkan dated 18.03.08. S. 10(1)(a)

Copper Beeches Nether Langwith Nottinghamshire



Nottinghamshire
County Council

Scale 1:10000

Produced by: David Squires

Date: 07/03/2008



NOT DEFINITIVE

Queries about path alignment should be made to the Definitive Map Team on 0115 9773708.

Public Rights of Way:

- Footpath
- Bridleway
- Byway Open to All Traffic
- RUPP
- RB

This map is reproduced from Ordnance Survey materials with the permission of Ordnance Survey on behalf of the Controller of Her Majesty's Stationery Office. Crown Copyrights. Unauthorised reproduction infringes Crown Copyright and may lead to prosecution or civil proceedings. (Nottinghamshire County Council) (100019713), 2008

2

11

2

3

6

NETHER LANGWITH CP

5

7

8

9

8

7

11

10

8

11

10

9

12

41 305
31021

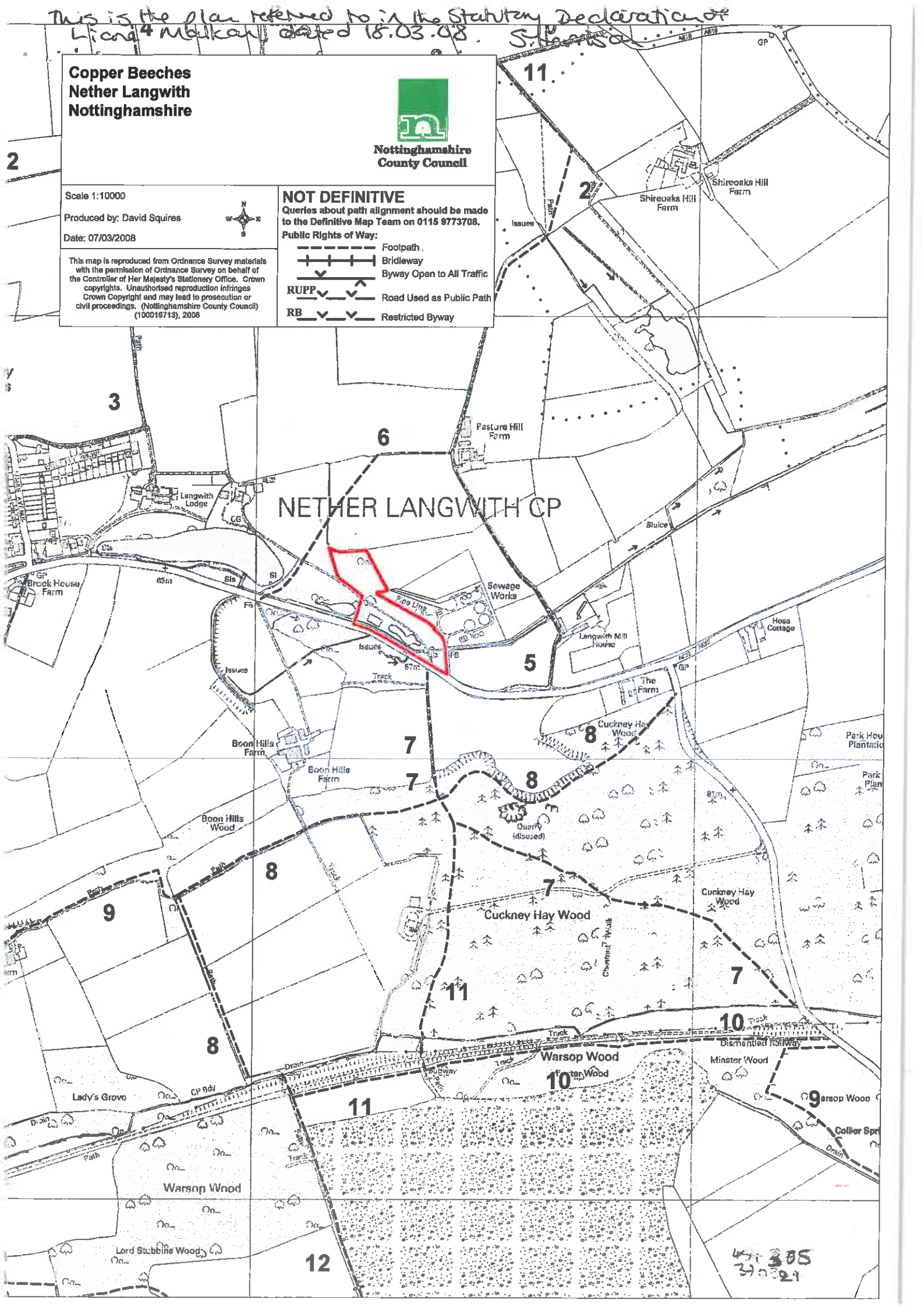

Mrs L T Malkan
Copper Beeches
Cuckney Road
Nether Langwith
Nr Mansfield
Notts
NG20 9QJ

Mr Tim Hart Senior Definitive Map Officer
Nottinghamshire County Council
Trent Bridge House
Fox Road
West Bridgeford
Nottingham
NG2 6BJ

7th March 2008

Dear Mr Hart

Re: **Section 31 (6) of THE HIGHWAYS ACT 1980**

Further to my telephone conversation with one of your colleagues today, please find enclosed a plan of my property and the previous Statutory Declaration for Copper Beeches dated 15th April 2002.

I look forward to receiving the relevant documentation to renew the section 31 (6) of the Highways Act 1980.

Many thanks

Yours sincerely



Mrs L T Malkan

✓ Enc 3

Your Ref
 Our Ref
 Please ask for
 Tel
 Fax
 Date

EPE.TH/AA5
 Mr T Hart
 (0115) 977 4395
 (0115) 977 2414
 15 April 2002

 Nottinghamshire County Council
 Environment
 Director Peter Webster
 Trent Bridge House, Fox Road,
 West Bridgford, Nottingham NG2 6BJ
 Website www.nottscc.gov.uk/environment

Mrs Liane Malkan
 Copper Beeches
 Nether Langwith
 Mansfield
 Notts
 NG20 9JQ



*Re Apply before
 12th
 April 08*

1ST Class

Dear Mrs Malkan

**NOTTINGHAMSHIRE COUNTY COUNCIL
 DEPOSIT OF STATEMENT AND PLAN AND STATUTORY DECLARATION -
 SECTION 31(6) OF THE HIGHWAYS ACT 1980
 PARISH: NETHER LANGWITH
 NAME OF LANDOWNER: LIANE MALKAN
 NAME OF PROPERTY: COPPER BEECHES**

I wish to acknowledge the receipt of your deposited Statement and Plan and Statutory Declaration on 12 April 2002.

The information contained in the Declaration will be held by this Authority as validation for the contents of the Statement and Plan. It will be necessary for you or your successors to renew the Statutory Declaration every six years, commencing from the date of the initial Statutory Declaration.

Any changes to your land holding or to the rights of way information in your initial Statement and Plan should be notified to the Rights of Way section, and should also be identified within a new Statutory Declaration covering a modified Statement and Plan.

Yours sincerely

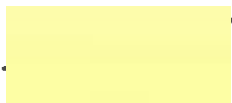

Tim Hart
 Senior Definitive Map Officer

Deputy Director - Jas Hundal

Assistant Directors: John Barber (Design Consultancy) Brian Duff (Contracting)
 Brian Royal (Environmental Planning) David Webb (Transportation)

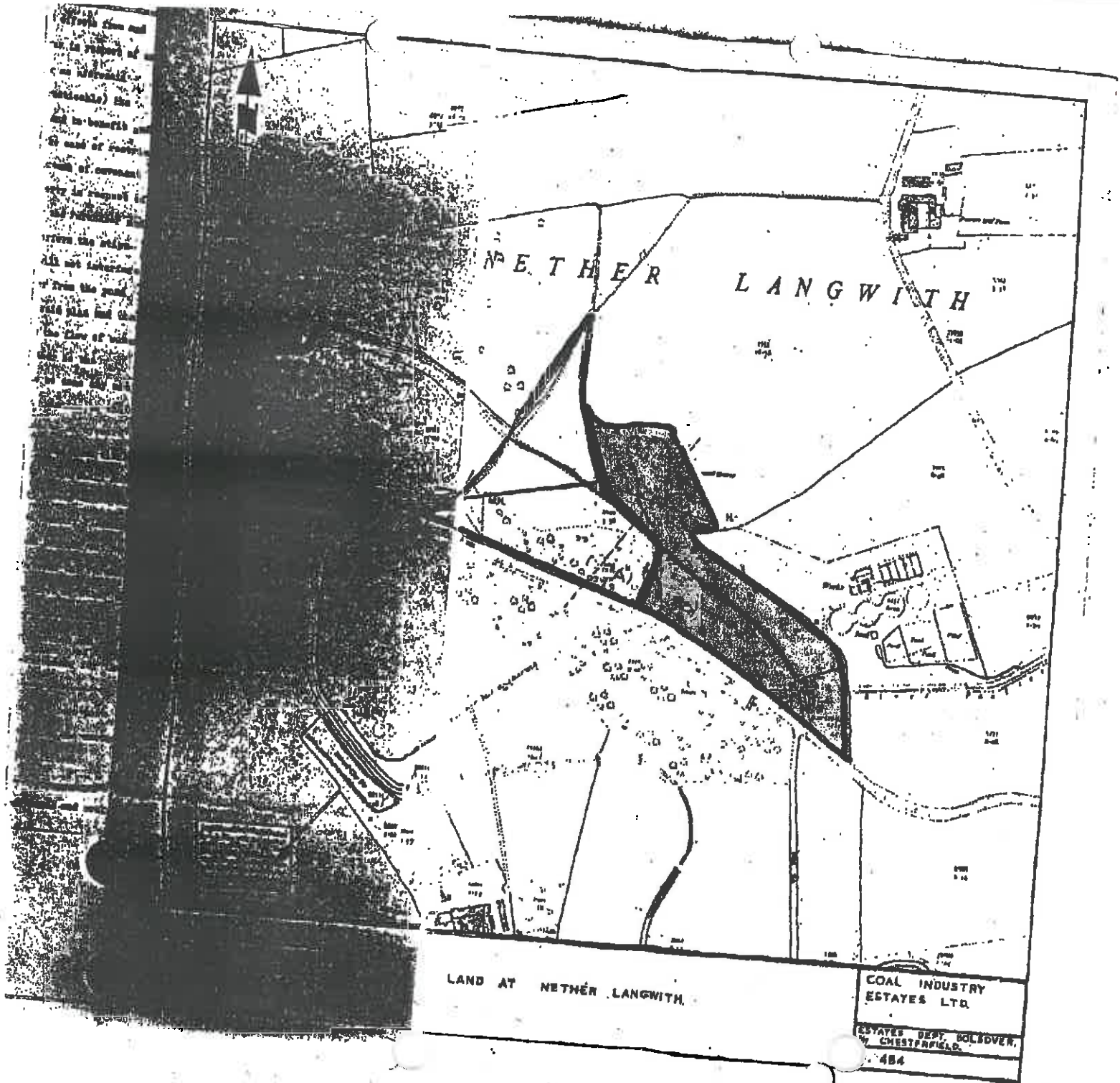

effects then and
 in respect of
 (as if it were
 (notwithstanding) the
 and to benefit and
 in case of death
 of any person
 any in respect of
 all interests in
 the same shall
 be not interested
 from the date
 of this plan and the
 the flow of water
 in the
 in the

NETHER LANGWITH

LAND AT NETHER LANGWITH.

COAL INDUSTRY
 ESTATES LTD.

ESTATES DEPT. SOLIDVER,
 CHESTERFIELD.

484

NOTTINGHAMSHIRE COUNTY COUNCIL

STATUTORY DECLARATION

SECTION 31 (6) OF THE HIGHWAYS ACT 1980

I LIANE MALKAN DO SOLEMNLY AND SINCERELY DECLARE as follows:
[Full Name]

1. I am and have been since 21.11.2001 the owner of the land known as COPPER BEECHES, NETHER LANGWITH
MANSFIELD NG11 5TS [day, month, year] [name of farm, etc]
more particularly delineated on the plan accompanying this declaration and thereon edged red.
 2. On the 11th day of APRIL 2002 LIANE MALKAN deposited with Nottinghamshire
[Month][Year] [Full Name]
County Council, being the appropriate Council, a statement accompanied by a plan delineating my
property by red edging which stated that [~~the ways coloured orange on the said plan and on the plan
accompanying this declaration are definitive or dedicated BYWAYS OPEN TO ALL TRAFFIC (B.O.A.T.'s)~~]
[~~the ways indicated by brown dashes on the said plan and on the plan accompanying this declaration are
definitive ROADS USED AS PUBLIC PATHS (R.U.P.'s)~~] [the ways coloured green on the said plan and
on the plan
accompanying this declaration are definitive or dedicated as BRIDLEWAYS] [the ways coloured purple
on the said plan and on the plan accompanying this declaration are definitive or dedicated FOOTPATHS]
[There were no definitive or dedication Rights of Way over my property.]
 3. There are no additional ways over the land edged red on the plan accompanying this declaration since
the statement dated 11.4.2002 referred to in 2 above, [other than those definitive routes coloured
_____ [day, month, year]
yellow and those dedicated routes coloured by yellow dashes and marked
* (byway) * (bridleway) * (footpath) on the plan accompanying this declaration].
- * Delete as appropriate.

AND I MAKE this solemn declaration on the 11th day of APRIL 2002 conscientiously believing it to be true
and by virtue of the Statutory Declarations Act 1835.
[Month, Year]

Declared at [address] Mansfield in
the County of
Nottinghamshire

[Redacted signature area] (owner)

Before me S. Harrison
BRYAN & ARMSTRONG
THE OLD MEETING HOUSE
STOCKWELL GATE
[Commissioner of the Highways or Justice of the Peace or Solicitor]
TELE: 01623 626039 FAX: 01623 635077

effects from and
in respect of
an approval
(including the
and to benefit and
to each of parties
each of covenant
only in respect of
the benefit of the
within the covenants
shall not interfere
of from the pool
and plan and the
The floor of water
shall be the same
to be done any and
measures to the

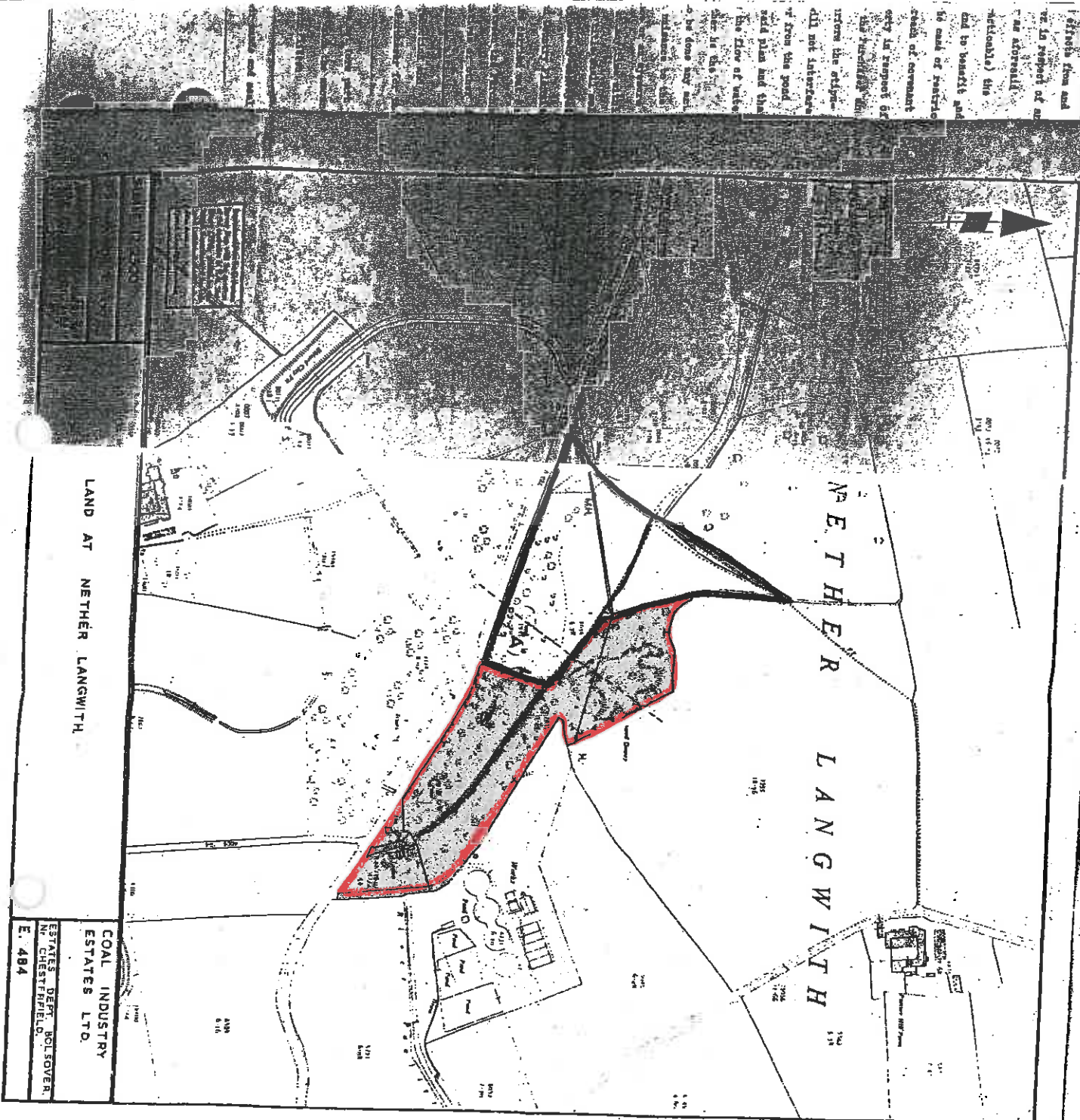

LAND AT NETHER LANGWIRTH

COAL INDUSTRY
ESTATES LTD.
ESTATES DEPT. BOLSOVER
N. CHESTERFIELD.
E. 484

This is the plan referred to at paragraph one of
the Statutory Declaration of Liene Markon dated
11.11.2002



Solicitor

BRYAN & ARMSTRONG
THE OLD MEETING HOUSE
STOCKWELL GATE
MANSFIELD NG18 1LG
TELE: 01623 626039 FAX: 01623 625077

-
EPE.TH/AA5
Mr T Hart
(0115) 977 4395
(0115) 977 2414
15 April 2002

Mrs Liane Malkan
Copper Beeches
Nether Langwith
Mansfield
Notts
NG20 9JQ

1ST Class

Dear Mrs Malkan

**NOTTINGHAMSHIRE COUNTY COUNCIL
DEPOSIT OF STATEMENT AND PLAN AND STATUTORY DECLARATION -
SECTION 31(6) OF THE HIGHWAYS ACT 1980
PARISH: NETHER LANGWITH
NAME OF LANDOWNER: LIANE MALKAN
NAME OF PROPERTY: COPPER BEECHES**

I wish to acknowledge the receipt of your deposited Statement and Plan and Statutory Declaration on 12 April 2002.

The information contained in the Declaration will be held by this Authority as validation for the contents of the Statement and Plan. It will be necessary for you or your successors to renew the Statutory Declaration every six years, commencing from the date of the initial Statutory Declaration.

Any changes to your land holding or to the rights of way information in your initial Statement and Plan should be notified to the Rights of Way section, and should also be identified within a new Statutory Declaration covering a modified Statement and Plan.

Yours sincerely



Tim Hart
Senior Definitive Map Officer

PSP.EB/RH28
Eddie Brennan
(0115) 977 4709
(0115) 977 2414
eddie.brennan@nottscc.gov.uk
28 March 2008

Mrs L T Malkan
Copper Beeches
Cuckney Road
Nether Langwith
Mansfield
Nottingham NG20 9QJ

Dear Mrs Malkan

SECTION 31(6) OF THE HIGHWAYS ACT 1980 – STATUTORY DECLARATION

Thank you for your letter dated 7 March 2008 in respect of the above.

As requested, I am enclosing a pro-forma for making a new Statutory Declaration.
Please note that it is now only necessary to renew such Declarations every 10 years.

Yours sincerely

Eddie Brennan
Definitive Map Officer

Enc.