

MD6

**STATUTORY DECLARATION
SEC 31(6) HIGHWAYS ACT 1980**

I, Peter David Rushmer FRICS FAAV, for and on behalf of the SECRETARY OF STATE FOR DEFENCE and acting under the authority conferred upon me by the said Secretary of State DO SOLEMNLY AND SINCERELY DECLARE THAT:

1. The land known as East Retford TA Centre in the County of Nottinghamshire and as shown edged in red colour on the map attached hereto is vested in the said Secretary of State for Defence.

2. There are no routes over the land shown on the map which are dedicated as highways.

3. I make this statement for the purposes of Section 31(6) of the Highways Act 1980 AND I MAKE this solemn declaration conscientiously believing the same to be true and by virtue of the Statutory Declarations Act 1835.

DECLARATION MADE AT
Oxford Street Nottingham
this twenty eighth day of
November 1995
Before me
[Redacted]
A practising Solicitor
or Commissioner for Oaths

.....
Signature
for and on behalf of
The Secretary of State for Defence

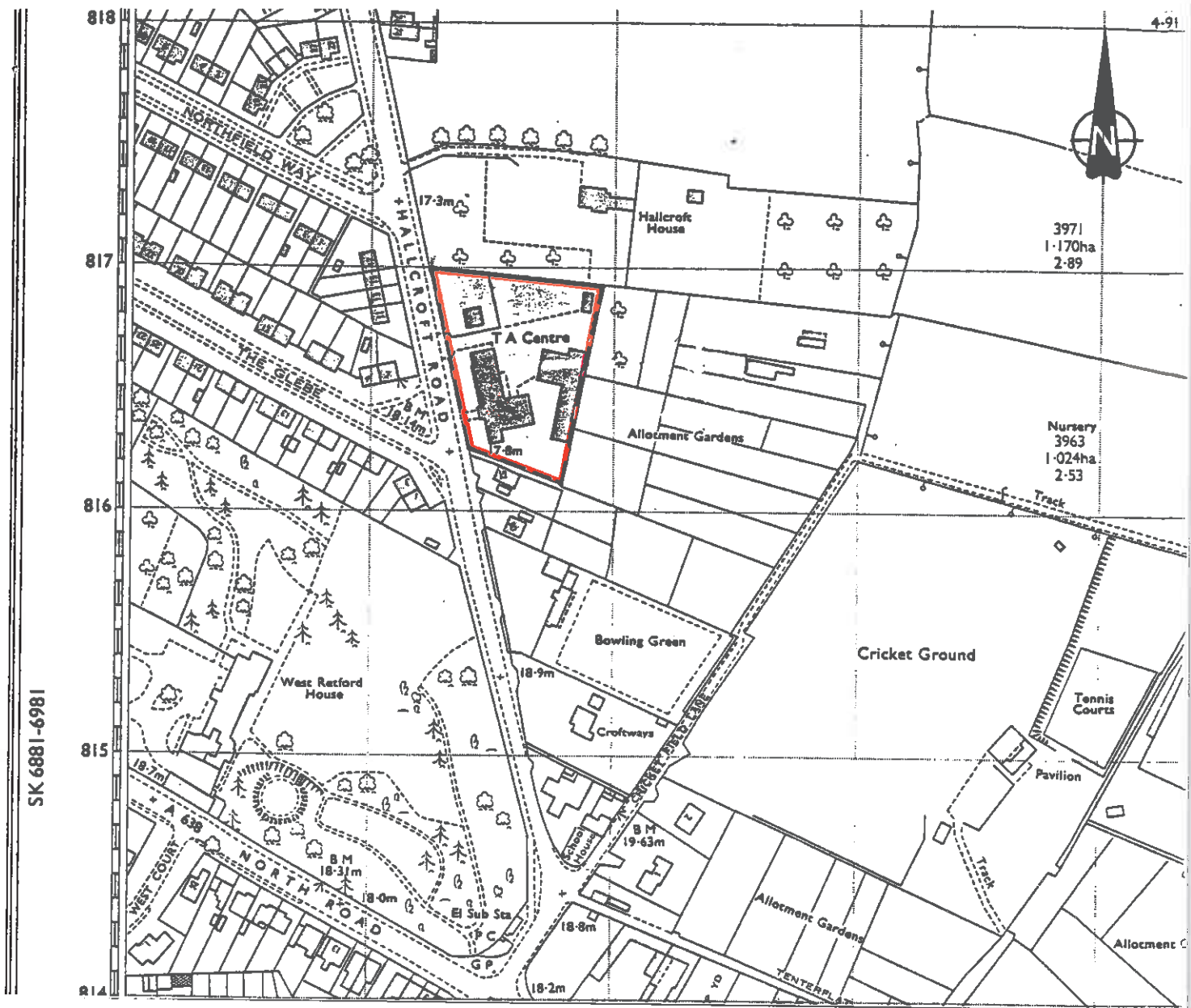

HIGHWAYS ACT 1980, SECTION 31 (6)

MINISTRY OF DEFENCE FREEHOLD ESTATE

Extent of Public Rights recognised by Secretary of State for Defence

LEGEND

- MOD Boundary —
- Footpaths
- Bridleways
- Roads used as public footpaths
- Byways open to all traffic
- Public roads other than byways

EAST RETFORD TA, NOTTINGHAMSHIRE

Scale 1 : 1250

Compiled from OS
National Grid Sheet:
SK 7081

**IMPORTANT: THIS PLAN MUST
NOT BE COPIED OR REPRODUCED
WITHOUT PRIOR WRITTEN CONSENT
FROM THE OFFICE OF ORIGIN**

Reproduced from the Ordnance Survey plan
with the permission of the Controller of H. M.
Stationary Office. Crown Copyright Reserved.
GD 03148G

Produced by:
DLS (East), Nottingham, Spur E, Block 5, Government Buildings
Chalfont Drive, Nottingham NG8 3RP

NOTE: PLAN TO BE READ IN CONJUNCTION WITH STATUTORY DECLARATION DATED 28.11.95.

PLAN ... of ...

**MINISTRY OF DEFENCE ESTABLISHMENTS ROADS AND PATHS USED BY THE PUBLIC
PROCEDURE UNDER SECTION 31(6) HIGHWAYS ACT 1980**

We, the Nottinghamshire County Council hereby confirm receipt of the prescribed Statutory Declaration and attached plans dated 28 November 1995 in respect of Ministry of Defence Property at East Retford TA Centre as submitted by the Defence Lands Service, Block 5, Government Buildings, Chalfont Drive, Nottingham, for and on behalf of the said Ministry of Defence.

Signed on behalf of the County Council

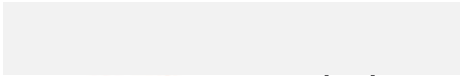
 *Rights of way Officer*

Dated *15/12/95*

Note This Form to be completed and returned to the Deputy Defence Land Agent confirming official receipt of the above mentioned documents.

Y58717

Director of Technical Services
Nottinghamshire County Council
County Hall
West Bridgeford
NOTTINGHAM



Department of the Environment
Property Services Agency
Senior Estate Surveyor Leeds (South)
Liverpool Victoria House
8 Otley Road
LEEDS
LS6 2AN

Tel: Leeds 782111 Ext 252

Our Ref: LDS/168/STH

Date: 17 January 1978

Dear Sir

43

SECTION 34 - THE HIGHWAYS ACT 1959

1. In accordance with the Provisions of Sub-Section 34(6) of the Highways Act 1959, I am directed to deposit with you the enclosed plan numbered 17 of the Ministry of Defence Establishment within your area, and more particularly known as TAVRA CENTRE, EAST RETTFORD, over which the Secretary of State for Defence states no ways have been dedicated as highways.

Yours faithfully

C G H YOUNG
Senior Estate Surveyor for and on behalf
of the Secretary of State for Defence

ENC

cc
Bassetlaw District Council

LEGEND

- MOD Boundary ———
- Public Footpath - - - - -
- Public Bridleway - | - | -
- Public Road — ^ — ^ —

Public Rights of Way over MOD Land

Establishment EAST RETFORD TAYRA CENTRE
County NOTTINGHAMSHIRE
Plan No. 17
Scale 1:10,560
Date

CROWN COPYRIGHT
Reproduced by permission of the
Director General Ordnance Survey

