

This matter is being dealt with by:
Eddie Brennan
Your Reference: PB/JW/7478
My Reference: EB/130325/Mossopbowser
T 0115 977 4709
E eddie.brennan@nottscc.gov.uk
W nottinghamshire.gov.uk

Mossop & Bowser Solicitors
Abbots Manor
10 Spalding Road
Holbeach
Lincolnshire PE12 7LP

25 March 2013

Dear Sir

**NOTTINGHAMSHIRE COUNTY COUNCIL: DEPOSIT OF STATEMENT PLAN AND
STATUTORY DECLARATION - SECTION 31(6) HIGHWAYS ACT 1980
PARISHES: MISSON, EVERTON, MISTERTON, GRINGLEY ON THE HILL
NAME OF LANDOWNER: LOVEDEN ESTATES
NAME OF PROPERTY: VARIOUS**

I wish to acknowledge the receipt, on the 18 March 2013, the various Statutory Declarations listed below;

1. Old Bombing Ground and Washland, Misson
2. Woodland at Green Lane, Everton
3. Gibdyke Farm, Misson
4. Norwood House, Misson
5. Parts of Bullhassocks and Charity Farm Westwoodside, Misson
6. Land to the south of the River Idle at Everton, Misterton and Gringley
7. Land lying to the south of the River Idle, Everton (Statement and Statutory Declaration)

The information contained in the Declarations will be held by this Authority as validation for the contents of the statements and plans. It will be necessary for you or your successors to renew the Statutory Declarations every ten years.

Any changes to your land holdings or the rights of way information in your initial Statements and Plans should be notified to the Countryside Access Section, and should also be identified with new Statutory Declarations covering modified Statements and Plans.

Yours sincerely

Eddie Brennan
Definitive Map Officer
Nottinghamshire County Council

Misson

Our ref: PB/JW/7478
Your ref:
Date: 13 March, 2013

MOSSOP & BOWSER SOLICITORS

Abbots Manor, 10 Spalding Road,
Holbeach, Lincs. PE12 7LP
DX 29522 Holbeach

Eddie Brown
The Rights of Way Officer
Nottinghamshire County Council
DX 723420
WEST BRIDGFORD 2

Telephone: (01406) 422651 (Switchboard)
(01406) 421202 (Direct Line)
Fax: (01406) 425177
E-Mail: pbrown@mossops.co.uk
Website: www.mossops.co.uk

Trout Bridge House

RECEIVED
18 MAR 2013
BY:

Dear Sir

Loveden Estates Limited (formerly Loveden Holdings Limited)
Section 31(6) Highways Act 1980

We refer to six deposits and supporting Statutory Declarations relating to the following parcels of land:

1. Old Bombing Ground and Washland Misson Nottinghamshire.
2. Woodland at Green Lane Everton Nottinghamshire.
3. Gibdyke Farm Misson Nottinghamshire (the earlier Declaration has been amended in order to refer to the restricted by-way on the Plan NDSB2).
4. Norwood House Misson Nottinghamshire.
5. Parts of Bullhassocks & Charity Farm Westwoodside Nottinghamshire.
6. Land to the south of the River Idle at Everton Misteron and Gringley Nottinghamshire.

As the 10 year period covered by the original Statutory Declarations will soon expire please find enclosed six new Statutory Declarations each dated 4 March 2013.

We shall be grateful if you will acknowledge safe receipt.

Yours faithfully,

[Redacted Signature]

LEGAL SERVICES
CHIEF EXECUTIVE'S DEPARTMENT

15 MAR 2013



And at Long Sutton (01406) 363212
Authorised and Regulated by the Solicitors Regulation Authority
SRA Number 52592
ESTABLISHED IN 1826

Partners: G.J.Wakefield B.A. R.M.Hill M.A. (Oxon) J.P.Veasey LL.B, B.Sc. Consultant: P.F.S.Brown LL.B, TEP

SERVICE OF DOCUMENTS NOT ACCEPTED BY EMAIL OR FAX

STATUTORY DECLARATION HIGHWAYS ACT 1980 S.31(6)

I NIGEL DENIS SPENCE BROWN of The Old Rectory Fulbeck Grantham Lincolnshire NG32 3JS **DO SOLEMNLY AND SINCERELY DECLARE** as follows:

1. Loveden Estates Ltd (CRN: 894965) (formerly Loveden Holdings Ltd) is and has been since 18 July 1994 the owner of the land known as Bullhassocks & Charity Farm Westwoodside North Lincolnshire (a small part of which is in Nottinghamshire) more particularly delineated on the plan accompanying this declaration and thereon edged red.
2. On 22 January 2004 Loveden Estates Ltd deposited with Nottinghamshire County Council, being the appropriate council, a statement accompanied by a plan delineating its property by red edging which stated that no ways over the land had been dedicated as highways
3. On or about 29 January 2004 I deposited with Nottinghamshire County Council, a statutory declaration dated 29 January 2004 stating that no additional ways had been dedicated since the deposit of the statement referred to in 2 above.
4. No additional ways have been dedicated over the land edged red on the plan accompanying this declaration since the date of the statutory declaration referred to in 3 above and at the present time Loveden Estates Ltd has no intention of dedicating any more public rights of way over its property.

AND I MAKE this solemn declaration conscientiously believing it to be true and by virtue of the Statutory Declarations Act 1835.

Declared at
this
2013

J Paul Woolley
Holbeck Lincolnshire
4th day of *March*

Before me,

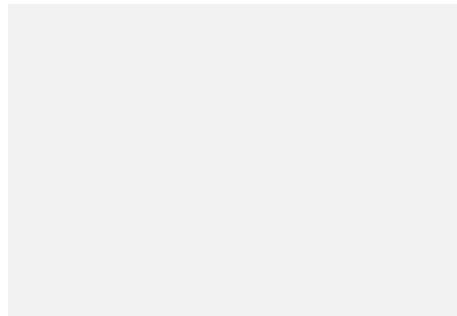
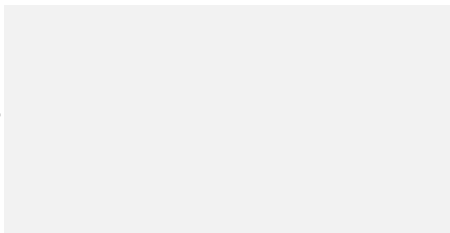

.....
Solicitor/~~Commissioner for Oaths~~

J. C. Woolley
Solicitor

H.M. LAND REGISTRY

TITLE NUMBER

HS 238522

ORDNANCE SURVEY
PLAN REFERENCE

SE 70 SW & SK 79 NW

SECTION

Scale
1/10000

COUNTY

HUMBERSIDE

DISTRICT NORTH LINCOLNSHIRE

This is the plan referred to in the
Statutory Declaration of Nigel Denis
Spence Brown declared before me this

4th day of *MAY*
2013

Solicitor **C Woolley**
Solicitor

WROOT CP

Drains

2

1

3

Cherly Farm

Bull Hassocks

4

NOTTINGHAMSHIRE

BASSETLAW DISTRICT



Our ref: PB/JW/19952
Your ref:
Date: 19 March, 2004

MOSSOP & BOWSER

SOLICITORS

Abbots Manor, 10 Spalding Road,
Holbeach, Lincs. PE12 7LP
DX 29522 Holbeach

The Rights of Way Officer
Nottinghamshire County Council
Trent Bridge House
Fox Road
West Bridgford
Nottingham
NG2 6BJ

Telephone: (01406) 422651 (Switchboard)
(01406) 421202 (Direct Line)
Fax: (01406) 425177
E-Mail: pbrown@mossops.co.uk
Website: www.mossops.co.uk

Dear Sir

Bullhassocks & Charity Farms Misson Nottinghamshire

We are enclosing deposit of Statement and Plan dated 22 January 2004 and Statutory Declaration dated 29 January 2004.

The enclosed deposit represents the position as our client believes it based on its knowledge of the property and searches made at the time of purchase.

We shall be grateful if you will acknowledge safe receipt.

Yours faithfully,

[Redacted Signature]

DEPOSIT OF STATEMENT AND PLAN
SECTION 31(6) OF THE HIGHWAYS ACT 1980

To: Nottinghamshire County Council

1. Loveden Holdings Limited is and has been since 18 July 1994 the owner within the meaning of the above section of the land known as Bullhassocks and Charity Farms Westwoodside North Lincolnshire is more particularly delineated on the plan accompanying this statement and thereon edged red.
2. The aforementioned land lies in the Parish of Misson
3. No ways over the land have been dedicated as highways.
4. Public Bridleway 149 lies outside the ownership of Loveden Holdings Limited
5. The deposit shall comprise this statement and accompanying plan.

Signed: (landowner)
for and on behalf of Loveden Holdings Ltd

Name: (of landowner) Loveden Holdings Ltd

Address Brook House
42 Manor Street
Ruskington
Sleaford Lincs
NG34 9EP

Date: 22 January 2004

Signed (witness)

Name (of witness)

Address

Occupation

PFSBROWN
Hothoush PE12 7LP
farmer

I NIGEL DENIS SPENCE BROWN of Brook House 42 Manor Street Ruskington Lincolnshire NG34 9EP do solemnly and sincerely declare as follows:

1. Loveden Holdings Ltd is and has been since 18 July 1994 the owner of the land known as Bullhassocks and Charity Farms Westwoodside North Lincolnshire and is more particularly delineated on the plan marked "NDSB1" accompanying this declaration and thereon edged red

2

On the 22 day of January 2004 Loveden Holdings Ltd deposited with Nottinghamshire County Council being the appropriate Council a statement accompanied by a plan delineating its property by red edging which stated that no ways had been dedicated as highways over the Property.

3. No ways have been dedicated over the land edged red on the plan accompanying this declaration since the date of the statement referred to in 2. above.

AND I make this solemn declaration conscientiously believing the same to be true and by virtue of the Statutory Declarations Act 1835

Declared at Spalding Road
Holbeach Lincolnshire
this 29th day of
January 2004

Before me,

.....
Solicitor

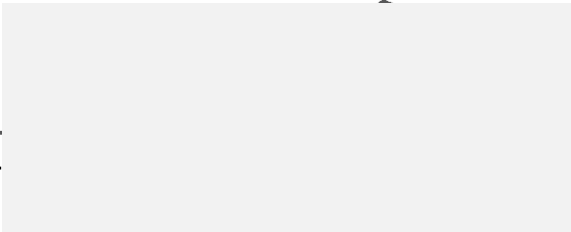

H.M. LAND REGISTRY		TITLE NUMBER 11622	
ORDNANCE SURVEY PLAN REFERENCE	SE 70 SW & SK 79 NW	SECTION	Scale 1/10000
COUNTY	HUMBERSIDE	DISTRICT NORTH LINCOLNSHIRE © Crown Copyright	

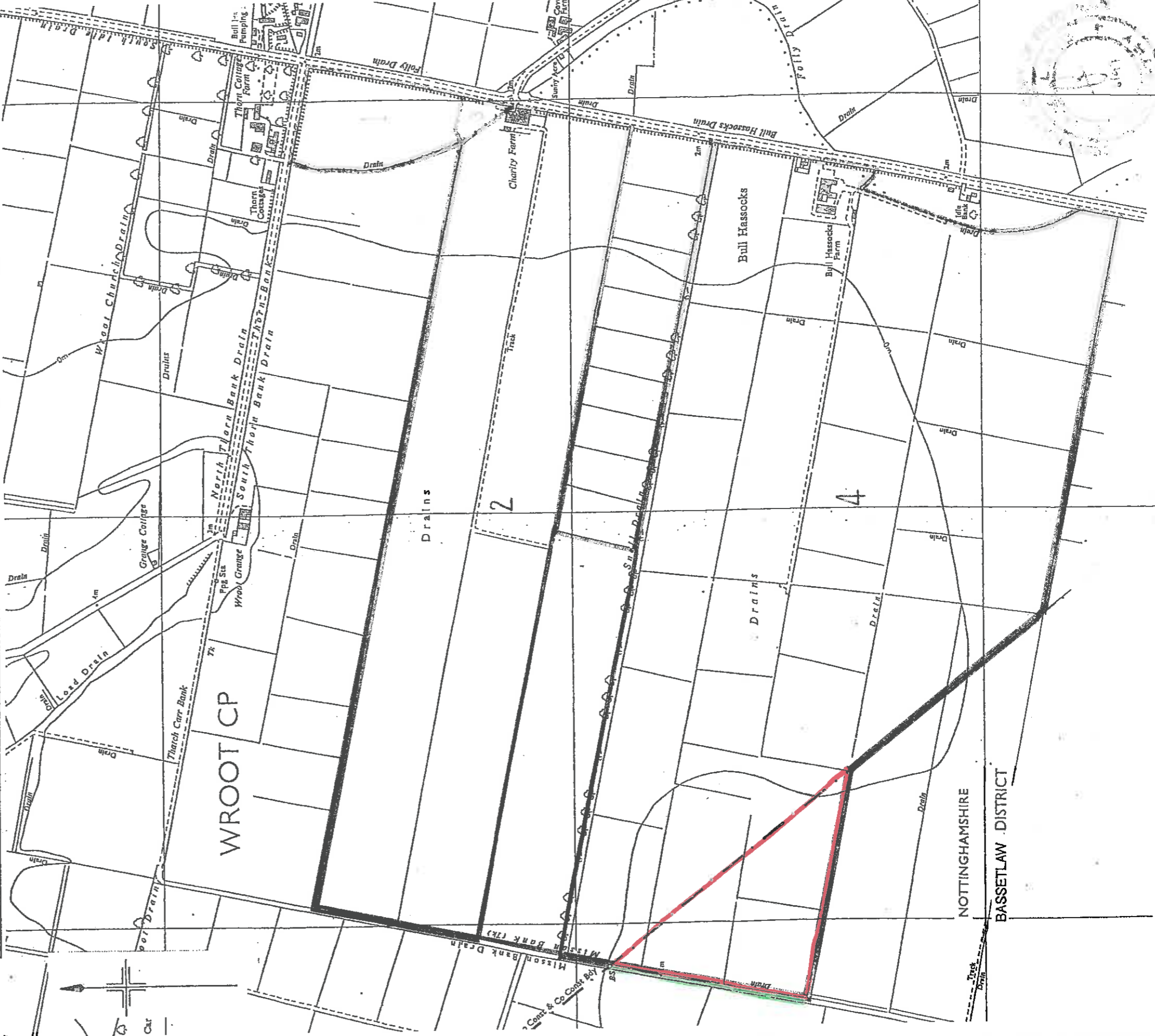

... river widening and repair thereof by the Vendor
 aforesaid and the cost of repairing and maintaining the said watermain and ...
 shall be borne by the Vendor and the Purchasers and his and their respective
 in title in equal shares

This is the exhibit marked "NDSB1" referred
 to in the Statutory Declaration of Nigel Denis Spence Brown
 declared before me this
 day of 29 January 2024

.....
 Solicitor

