

EPE.TH/JM2
Mr T Hart
(0115) 977 4395
(0115) 977 2414
17 April 2002

Mrs J Morley
Newfields Farm
Owthorpe
Nottingham
NG12 3GF

1st Class

Dear Mrs Morley

**NOTTINGHAMSHIRE COUNTY COUNCIL
DEPOSIT OF STATEMENT AND PLAN AND STATUTORY DECLARATION -
SECTION 31(6) OF THE HIGHWAYS ACT 1980
PARISH: MANSFIELD
NAME OF LANDOWNER: JUDITH ANN MORLEY AND PAULINE STEPHANIE
CHRISTINE DUNTHORNE
NAME OF PROPERTY: HIGH OAKHAM FARM**

I wish to acknowledge the receipt of your deposited Statement and Plan and Statutory Declaration on 15 April 2002.

The information contained in the Declaration will be held by this Authority as validation for the contents of the Statement and Plan. It will be necessary for you or your successors to renew the Statutory Declaration every six years, commencing from the date of the initial Statutory Declaration.

Any changes to your land holding or to the rights of way information in your initial Statement and Plan should be notified to the Rights of Way section, and should also be identified within a new Statutory Declaration covering a modified Statement and Plan.

Yours sincerely



Tim Hart
Senior Definitive Map Officer

NOTTINGHAMSHIRE COUNTY COUNCIL

DEPOSIT OF STATEMENT AND PLAN

SECTION 31 (6) OF THE HIGHWAYS ACT 1980

To

1. ~~has~~ ^{we are} and have been since November 1989 the owner within the meaning of the above section of the land known as HIGH OAKHAM FARM more particularly delineated on the attached plan accompanying this statement and thereon edged red.
2. The aforementioned land lies in the Parishes/Communities of MANFIELD and NOTTS.
3. ~~The ways coloured orange on the said plan appear on the Definitive Map as BYWAYS OPEN TO ALL TRAFFIC (B.O.A.T.s).~~
4. ~~The ways coloured by orange dashes on the said plan have been dedicated as BYWAYS OPEN TO ALL TRAFFIC (B.O.A.T.s).~~
5. ~~The ways coloured by brown dashes on the said plan appear on the Definitive Map as ROADS USED AS PUBLIC PATHS (R.U.P.s).~~
6. ~~The ways coloured green on the said plan appear on the Definitive Map as BRIDLEWAYS.~~
7. ~~The ways coloured by green dashes on the said plan have been dedicated as BRIDLEWAYS.~~
8. ~~The ways coloured purple on the said plan appear on the Definitive Map as FOOTPATHS.~~
9. ~~The ways coloured by purple dashes on the said plan have been dedicated as FOOTPATHS.~~
10. No other ways over the land have been dedicated as highways.
11. The deposit shall comprise this statement and accompanying plan.

Delete as applicable.

Signed (landowner)

Name (or landowner)

Address

Date

Signed (Witness)

Name (of witness)

Address

Occupation

PTC.TH/ME/2185M
3 June 1986

[Redacted]
[Redacted]
SUDITH ANN MORLEY
NEWFIELDS FARM
DUNTHORPE NOTTINGHAM
NG12 3 GA
12/4/2002
[Redacted]
PAULINE
STEPHANIE
CHRISTINE
DUNTHORPE
ELM TREE HOUSE
CHURCH ROAD
BOUGHTON NEWARK
NG22 9 5X
PETER JAMES WARD
23 HIGH STREET
EDWINGTON
NOTTS NG21 9 QP
SOLICITOR



TITLE NUMBER
NT356730

NOTTINGHAMSHIRE : MANSFIELD



ORDNANCE SURVEY MAP REFERENCE:

SK52985W

SCALE 1:2500

CROWN COPYRIGHT. Produced by HR/LR. Further reproduction in whole or in part is prohibited without the prior written permission of Ordnance Survey. Licence Number 00 27379.

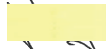
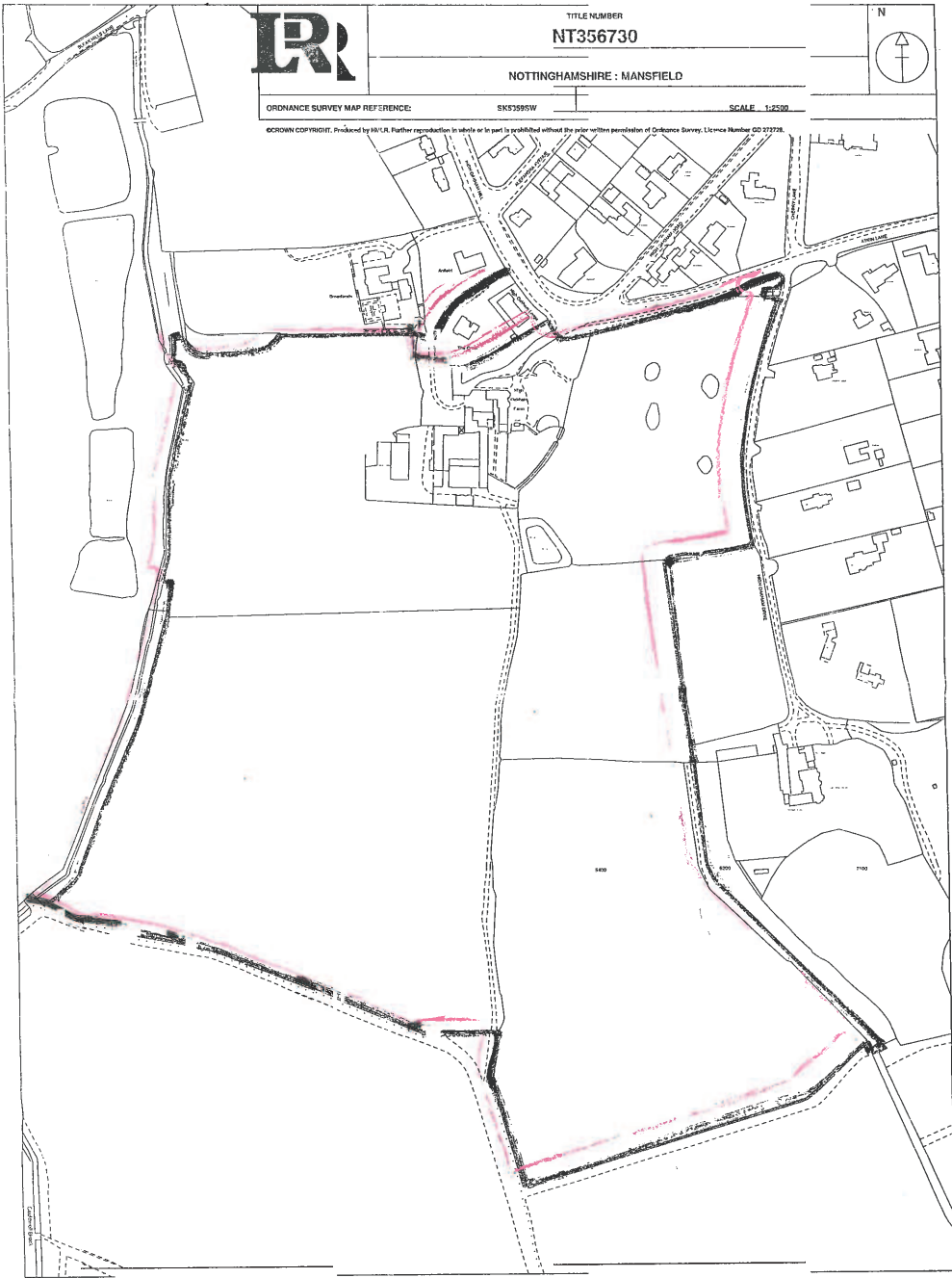

RSC Dunton



NOTTINGHAMSHIRE COUNTY COUNCIL

STATUTORY DECLARATION

SECTION 31 (6) OF THE HIGHWAYS ACT 1980

STEPHANIE CHRISTINE

PAULINE S.C. DUNTHORNE AND

AND JUDITH MORLEY DO SOLEMNLY AND SINCERELY DECLARE as follows:

[Full Name]

1. I am and have been since November 1989 the owner of the land known as HIGH OAKHAM GARDEN more particularly delineated on the plan accompanying this declaration and thereon edged red. [day, month, year] [name of farm, etc]
2. On the 12th day of April 2002 I deposited with Nottinghamshire County Council, being the appropriate Council, a statement accompanied by a plan delineating my property by red edging which stated that the ways coloured orange on the said plan and on the plan accompanying this declaration are definitive or dedicated BYWAYS OPEN TO ALL TRAFFIC (B.O.A.T.s) [the ways indicated by brown dashes on the said plan and on the plan accompanying this declaration are definitive ROADS USED AS PUBLIC PATHS (R.U.P.P.s)] the ways coloured green on the said plan and on the plan accompanying this declaration are definitive or dedicated as BRIDLEWAYS the ways coloured purple on the said plan and on the plan accompanying this declaration are definitive or dedicated FOOTPATHS [There were no definitive or dedication Rights of Way over my property.]
3. There are no additional ways over the land edged red on the plan accompanying this declaration since the statement dated 12th April 2002 referred to in 2 above, [other than these definitive routes coloured yellow and these dedicated routes coloured by yellow dashes and marked * (byway) (bridleway) (footpath) on the plan accompanying this declaration].
Delete as appropriate.

AND I MAKE this solemn declaration on the 12th day of April 2002 conscientiously believing it to be true and by virtue of the Statutory Declarations Act 1835. [Month, Year]

Declared at [address] 23, HIGH STREET
LOWIN STONE IN THE
COUNTY OF NOTTINGHAM

R. [Signature]

(signature of landowner)

Before me

[Commissioner of Oaths or Justice of the Peace or Solicitor]

This is the plan referred to in the
of PAULINE EDWARDS CHRISTINE DUNN
JUDITH ANN MORLEY dated the 12th April 2002



TITLE NUMBER
NT356730

Commission for
Oaths



NOTTINGHAMSHIRE : MANSFIELD

ORDNANCE SURVEY MAP REFERENCE:

SK9799SW

SCALE 1:2500

CROWN COPYRIGHT. Produced by I.R.S. Further reproduction in whole or in part is prohibited without the prior written permission of Ordnance Survey, Licence Number GD 277728.

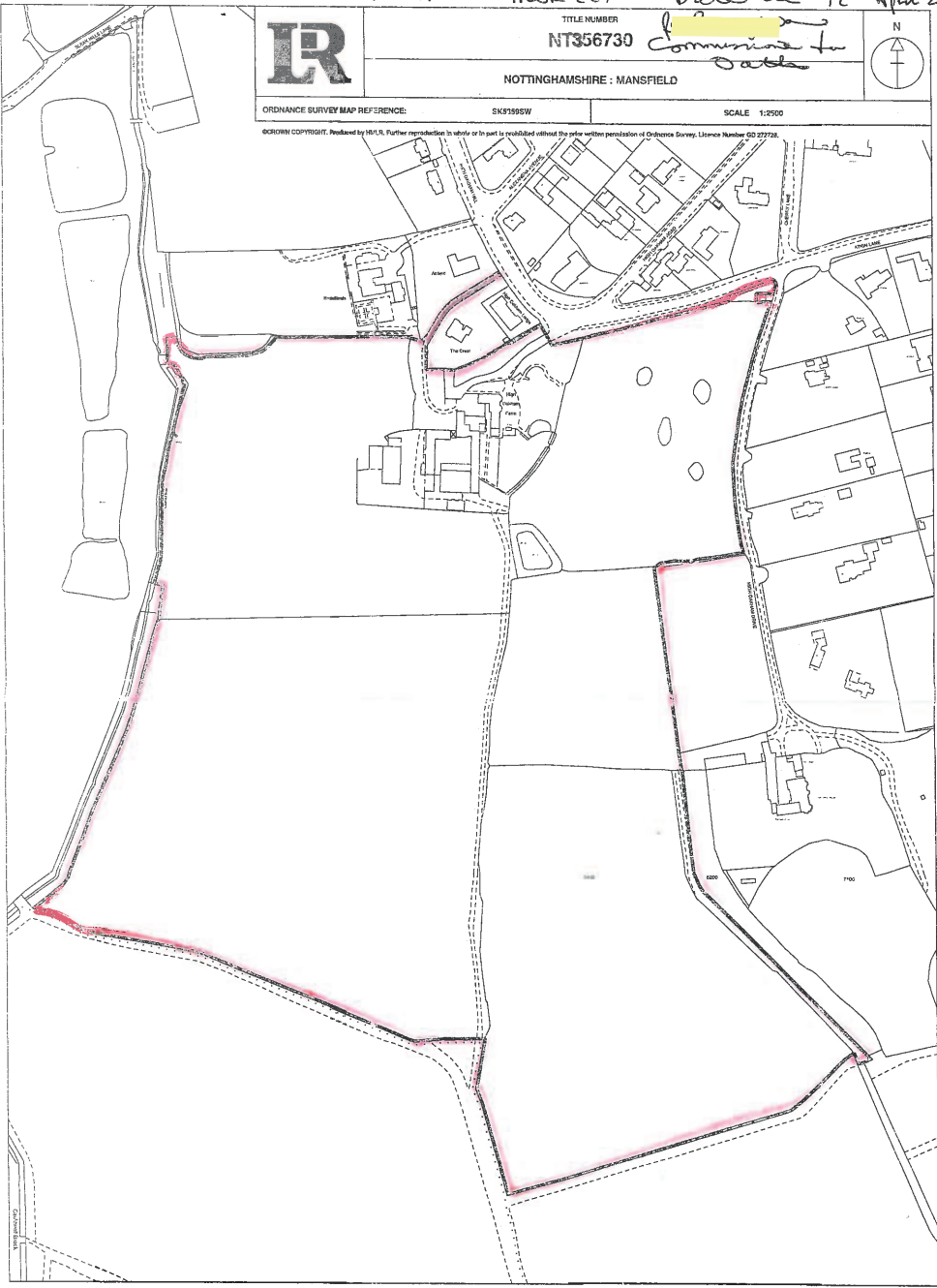

[Redacted signature]

