

241  
-  
PSP.EB/RH2  
Eddie Brennan  
(0115) 977 4709  
(0115) 977 2414  
eddie.brennan@nottsc.gov.uk  
15 January 2007

Mr J Hardman  
Trentfield Farm  
Church Laneham  
Nr Retford  
Nottinghamshire  
DN22 0NJ      sk 817 776

Dear Mr Hardman

**DEPOSIT OF STATEMENT AND PLAN AND STATUTORY DECLARATION –  
SECTION 31(6) OF THE HIGHWAYS ACT 1980**

Thank you for the deposited Statement and Plan you recently submitted dated 1 January 2007.

The County Council believes that public bridleway rights exist over Trentfield Lane and also that restricted byway rights exist over the area shown outlined in blue on your plan. Please confirm whether or not you accept these rights to exist over the land in question.

I understand that the area outlined in blue is in the ownership of Laneham Parish Council. I would therefore be grateful if you could also confirm whether or not you are the owner of this land parcel.

Any changes to your land holding or to the rights of way information in your Statement and Plan should be notified to the Countryside Access Section, and should also be identified within a new Statutory Declaration covering a modified Statement and Plan.

Yours sincerely

Eddie Brennan  
Definitive Map Officer

*No reply*

# . Trentfield Farm .

1 January 2007

Mr E Brennan  
Nottinghamshire County Council  
Trent Bridge House Fox Road  
West Bridgford  
Nottinghamshire

Dear Mr Brennan

Please find enclosed an up to date statement and plan relating to Trentfield Farm, Church Laneham.

Could you please confirm its validity and receipt.

I look forward to hearing from you. Many thanks in anticipation of your actions.

Yours sincerely



J M Hardman

**DEPOSIT OF STATEMENT AND PLAN  
SECTION 31(6) OF THE HIGHWAYS ACT 1980**

TO: NOTTINGHAMSHIRE COUNTY COUNCIL

1. I am and have been since 23 June 1998 the owner within the meaning of the above section of the land known as Trentfield Farm, Church Laneham, Nr Retford, Nottinghamshire, more particularly delineated on the plan accompanying this statement and thereon edged red.
2. The aforesaid land lies in the parish of Laneham and Church Laneham.
3. The ways on the said plan have been dedicated as footpaths.
4. No ways over the land have been dedicated as highways.
5. No ways over the land have been dedicated as bridleways.
6. The aforementioned plan has a parcel of land referred to as Field number 7136 delineated in Blue. The above statements 2,3,4 and 5 apply to this deposit also.
7. The deposit shall comprise this statement and accompanying plan, and supersedes any previous deposit lodged.

Signature

[Redacted Signature]

Dated

1 JANUARY 2007

Name: John Michael Hardman

Trentfield Farm, Church Laneham, Retford, Notts.

Witness

[Redacted Witness Name]

Name

Richard Hyppa

Address: 27 Clasketgate Harrogate

Occupation Director

Option 1  
Site-centred

813

814

815

816

817

818

377607m  
776

775

774

773

172



6251

7152

7748

Trentfield Farm

6645

7.8m

BM 7.28m

Caravan Site

7136

BM 8.29m

Meadow House

Mean High Water

Co Coast Bay

Sluice

Sluice

Mean High Water

River Trent

7331

7728

5928

8.3m

5519

Frogs Leap

The Walkkilns

Jetty

8.0m

Track

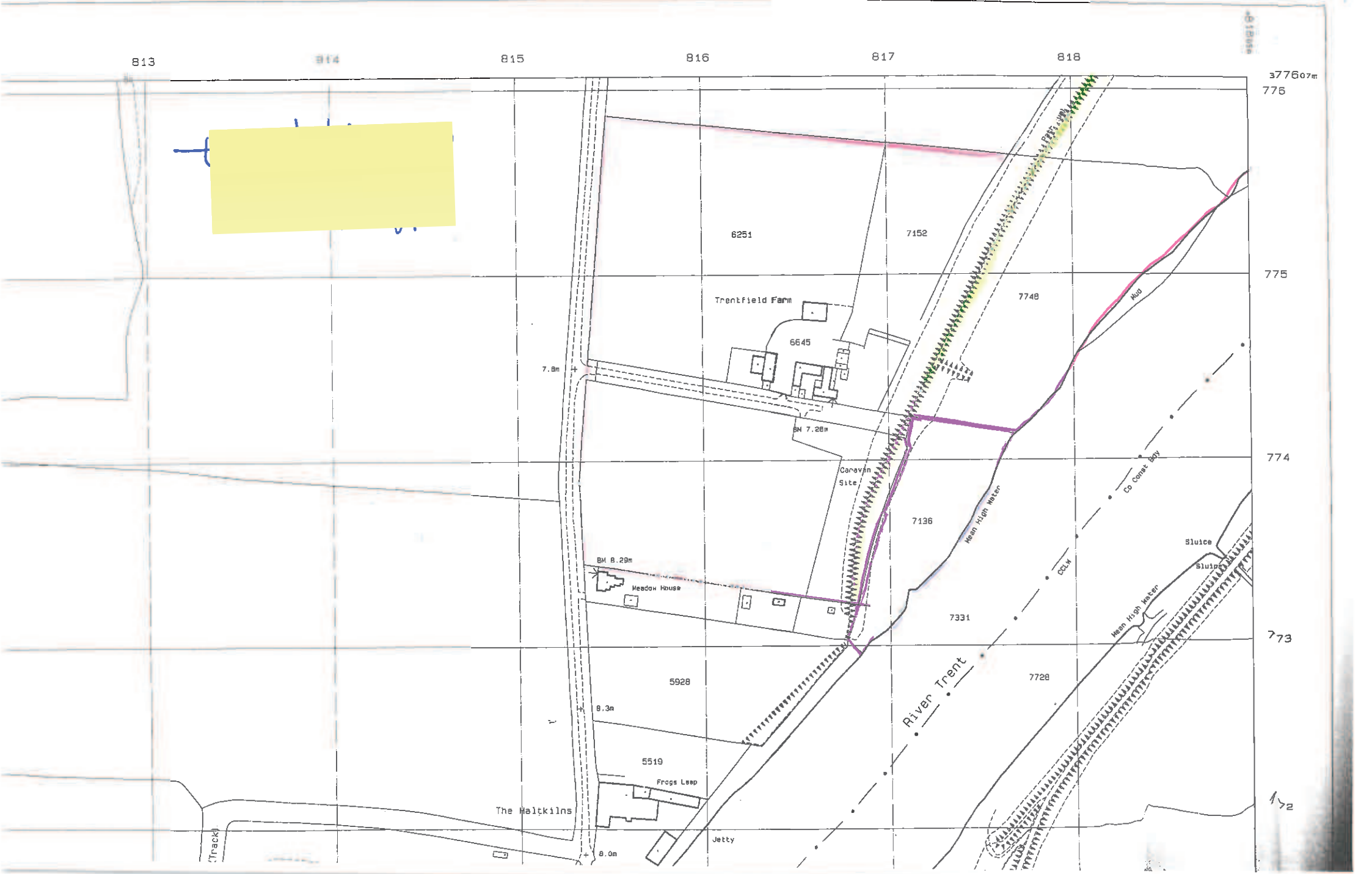

-  
EPE.TH/AA4  
Mr T Hart  
(0115) 977 4395  
(0115) 977 2414  
18 November 2002

J Hardman  
Trentfield Farm  
Church Laneham  
Retford  
Notts  
DN22 0NJ

Dear Sir/Madam

**NOTTINGHAMSHIRE COUNTY COUNCIL  
DEPOSIT OF STATEMENT AND PLAN AND STATUTORY DECLARATION -  
SECTION 31(6) OF THE HIGHWAYS ACT 1980  
PARISH: LANEHAM  
NAME OF LANDOWNER: J HARDMAN  
NAME OF PROPERTY: TRENTFIELD FARM**

I wish to acknowledge the receipt of your deposited Statement and Plan and Statutory Declaration on 15 October 2002.

The information contained in the Declaration will be held by this Authority as validation for the contents of the Statement and Plan. It will be necessary for you or your successors to renew the Statutory Declaration every ten years, commencing from the date of the initial Statutory Declaration.

Any changes to your land holding or to the rights of way information in your initial Statement and Plan should be notified to the Rights of Way section, and should also be identified within a new Statutory Declaration covering a modified Statement and Plan.

Yours faithfully

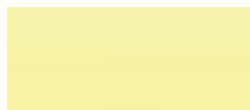

Tim Hart  
Senior Definitive Map Officer

**DEPOSIT OF STATEMENT AND PLAN**  
**SECTION 31(6) OF THE HIGHWAYS ACT 1980**

To: Nottinghamshire County Council. Environment

1. I am, and have been since 23 June 1998 the owner within the meaning of the above section of land known as Trentfield Farm, Church Laneham, Retford, Nottinghamshire, more particularly delineated on the plan accompanying this statement and thereon edged red.

2) The aforementioned land lies in the Parish/ Community of Laneham

3) The ways coloured yellow on the said plan have been dedicated as footpaths.

4) No ways over the land have been dedicated as highways.

5) No ways over the land have been dedicated as bridleways or byways

6) The deposit shall comprise this statement and accompanying plan.

7) The deposit supersedes all previous statements and plans.

Signed  ..... (Landowner)

Date: 1<sup>st</sup> August 2002.

Address: Trentfield Farm, Church Laneham, Retford, Nottinghamshire. DN22 0NJ

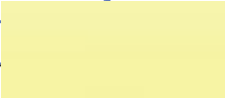
Witness Signature....  .....

Name P. AKERS.

Address 87 IMPERIAL ROAD. SEESTON. NOTTS

Occupation ORGANISER

H.M. LAND REGISTRY

TITLE NUMBER

NT 331719

ORDNANCE SURVEY  
PLAN REFERENCE

SK 8177

SECTION

Scale  
1/2500

COUNTY NOTTINGHAMSHIRE DISTRICT BASSETLAW

© Crown copyright 1988

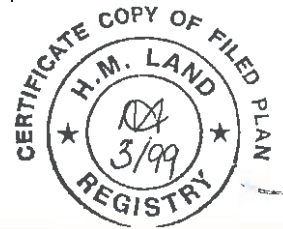
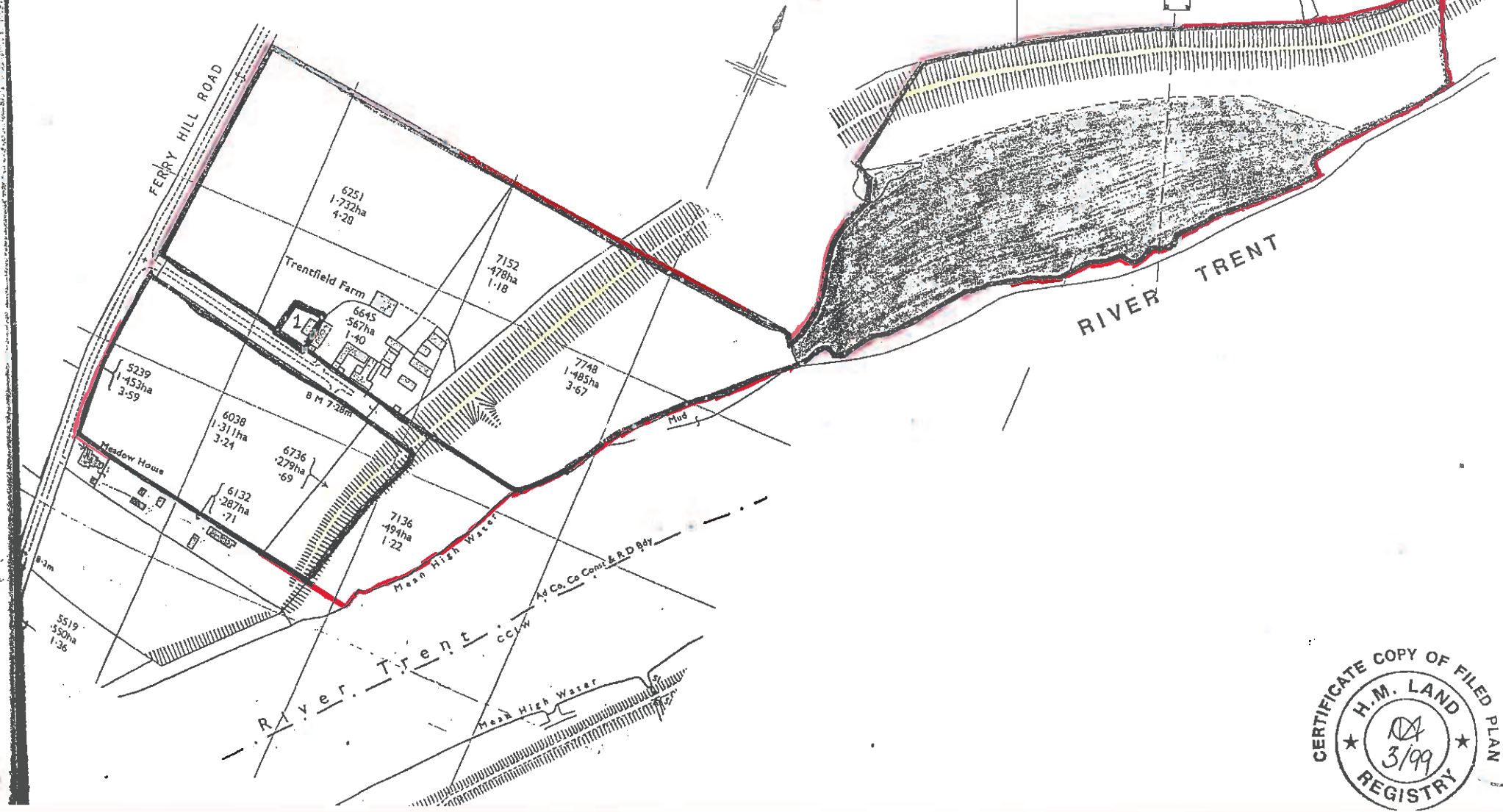

-  
EPE.TH/AA5  
Tim Hart  
(0115) 977 4395  
(0115) 977 2414  
28 September 1998

Mr J Hardman  
Trentfield Farm  
Church Laneham  
Nr Retford  
Notts

Dear Mr Hardman

**NOTTINGHAMSHIRE COUNTY COUNCIL  
DEPOSIT OF STATEMENT AND PLAN AND STATUTORY DECLARATION -  
SECTION 31(6) OF THE HIGHWAYS ACT 1980  
PARISH: LANEHAM  
NAME OF LANDOWNER: JOHN MICHAEL HARDMAN  
NAME OF PROPERTY: TRENTFIELD FARM**

I wish to acknowledge the receipt of your deposited Statement and Plan and Statutory Declaration on 2 and 9 September 1998 respectively.

The information contained in the Declaration will be held by this Authority as validation for the contents of the Statement and Plan. It will be necessary for you or your successors to renew the Statutory Declaration every six years, commencing from the date of the initial Statutory Declaration.

Any changes to your land holding or to the rights of way information in your initial Statement and Plan should be notified to the Rights of Way section, and should also be identified within a new Statutory Declaration covering a modified Statement and Plan.

Yours sincerely

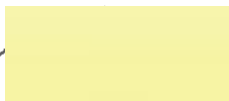
A yellow rectangular box redacting the signature of the Rights of Way Review & Modifications Officer.

Rights of Way Review & Modifications Officer



**STATUTORY DECLARATION  
SECTION 31(6) OF THE HIGHWAYS ACT 1980**

**I JOHN MICHAEL HARDMAN DO SOLEMNLY AND SINCERELY DECLARE as follows:**

1) I am and have been since the 23rd June 1998 the owner of the land known as Trentfield Farm more particularly delineated on the plan accompanying this declaration and thereon edged red.

2) On the 28th day of August 1998 I John Michael Hardman deposited with the Nottinghamshire County Council, being the appropriate Council, a statement accompanied by a plan delineating my property by red edging which stated that the ways coloured yellow on the said plan and on the plan accompanying this declaration had been dedicated as footpaths, no ways had been dedicated as highways over my property, also no ways had been dedicated as bridle ways over my property.

3) No additional ways have been dedicated over the land edged in red on the plan accompanying this declaration since the statement dated 28th August referred to in 2 above.

**AND I MAKE** this solemn declaration on the 4 day of September in the year 1998 conscientiously believing it to be true and by virtue of the Statutory Declarations Act 1835.

**Declared at:** *Cannon Square Retford Nottingham*  
**Jones and Company**  
**Cannon Square**  
**Retford**  
**Nottinghamshire**

**Signed:** 

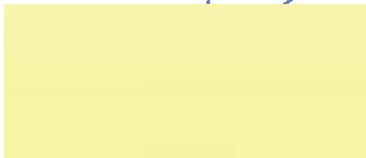
*JD*  

**Before me:**   
*A. MATHIAS HARDFIELD*

**Dated:** *6 September 1998*

**Occupation:** *Solicitor*



Reproduced from the 1:10000 Ordnance Survey Map with the permission of the Controller of Her Majesty's Stationary Office. Crown Copyright Reserved. The Map Shop, Upton upon Severn, Worcestershire

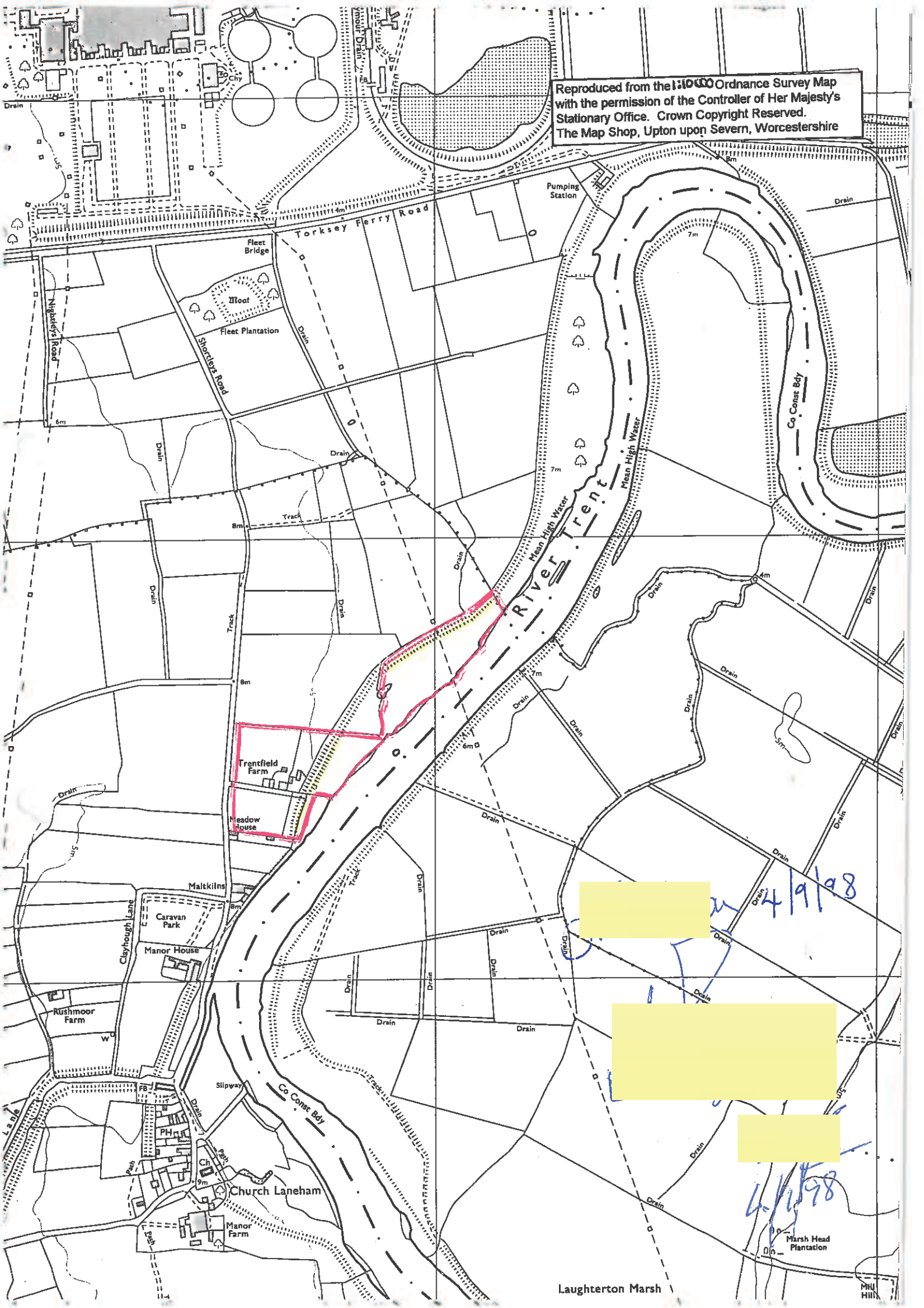

Laughterton Marsh

**DEPOSIT OF STATEMENT AND PLAN**  
**SECTION 31 (6) OF THE HIGHWAYS ACT 1980**

To Nottinghamshire County Council

1. I am and have been since 23 June 1998 the owner within the meaning of the above section of the land know as Trentfield Farm, Church Laneham, Nr Retford, Nottinghamshire, more particularly delineated on the plan accompanying this statement and thereon edged red.
2. The aforementioned land lies in the Parish/ Community of Laneham
3. The ways coloured yellow on the said plan have been dedicated as footpaths.
4. No ways over the land have been dedicated as highways.
5. No ways over the land have been dedicated as bridleways.
6. The deposit shall comprise this statement and accompanying plan.

Signed:  .....(Landowner) 27/8/98

Name: John Michael Hardman

Address: Trentfield Farm, Church Laneham, Nr Retford, Nottinghamshire.

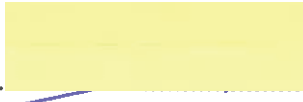
Witness Signature:  .....

Name: NICOL A. MARTIN

Address: TITE OLD SCHOOL, RYNTAM-ON-TRENT,  
NEWARK, NOTTS.

Occupation: RETAILER



Reproduced from the 1:10000 Ordnance Survey Map with the permission of the Controller of Her Majesty's Stationary Office. Crown Copyright Reserved. The Map Shop, Upton upon Severn, Worcestershire

