



**FORM CA17: NOTICE OF LANDOWNER DEPOSITS UNDER SECTION 31(6) OF  
THE HIGHWAYS ACT 1980 AND SECTION 15A(1) OF THE COMMONS ACT 2006**

Nottinghamshire County Council

An application to deposit a map and statement and lodge a declaration under section 31(6) of the Highways Act 1980 has been made in relation to the land (or lands) described below and shown edged in red on the accompanying map.

**PLEASE NOTE:**

This deposit may affect rights over the land described below. Deposits made under section 31(6) of the Highways Act 1980 may prevent deemed dedication of public rights of way over such land under section 31(1) of that Act. For further information, please see guidance at; [www.gov.uk](http://www.gov.uk).

**Description of the land(s):**

**Land at Common Lane and Whyburn Lane, Hucknall, in a location known as Beacon Hill**

**Name of the Parish in which the land(s) is situated: Hucknall**

**The deposit was submitted by W. Scholter (Director) Aldergate Estates Ltd.**

The authority maintains a register of maps, statements and declarations deposited under section 31A of the Highways Act 1980 and section 15B of the Commons Act 2006. This register can be accessed online at; [www.nottinghamshire.gov.uk](http://www.nottinghamshire.gov.uk) or can be inspected free of charge by appointment at the Countryside Access Team, Trent Bridge House, Fox Road, West Bridgford, Nottingham. Telephone 0115 9774915 (Office opening hours: Mon. to Fri. 9:00am to 4:30pm).

Signed on behalf of Nottinghamshire County Council

  
City Wood Group Manager, Environment and Highways

**Date: 1<sup>st</sup> July 2016**

## SCHEDULE 1

Regulation 2(2)(a)

## Application Form

## Form CA16

**Application Form for deposits under section 31(6) of the Highways Act 1980 and section 15A(1) of the Commons Act 2006****Please read the following guidance carefully before completing this form**

1. *Guidance relating to completion of this form is available from <https://www.gov.uk/town-and-village-greens-how-to-register>. Please refer to these separate notes when completing this form.*
2. *Parts A and F must be completed in all cases.*
3. *The form must be signed and dated by, or by a duly authorised representative of, every owner of land to which the application relates who is an individual, and by the secretary or some other duly authorised officer of every owner of land to which the application relates which is a body corporate or an unincorporated association.*
4. *In the case of land in joint ownership all the joint owners must complete paragraphs 2 and 3 of Part A and complete and sign the application in Part F, unless a duly authorised representative completes and signs the form on behalf of all of the owners of the land. Paragraph 3 should be completed in full to clearly explain the capacity of each applicant e.g. trustee, landowner's managing agent, executor.*
5. *'Owner' is defined in section 61(3) of the Commons Act 2006 and section 31(7) of the Highways Act 1980 and means, broadly, a legal owner of the freehold interest in the land.*
6. *Where the application relates to more than one parcel of land, a description of each parcel should be included in Paragraph 4 of Part A and the remainder of the form should be completed to clearly identify which statement and/or declaration relates to which parcel of land. This may require the insertion of additional wording. See separate notes for further guidance. Multiple parcels of land should be clearly identified by coloured edging on any accompanying map.*
7. *Where a statement or declaration requires reference to colouring shown on an accompanying map or previously lodged map, the colouring must be clearly specified and must match that shown on the relevant map. For example, if a footpath is specified in a Part C declaration as shown coloured brown, the accompanying map or previously deposited map referred to must reflect that colouring.*
8. *An application must be accompanied by an ordnance map, or (in respect of declarations under Part C or statements under Part D of this form) refer to a map previously deposited in accordance with the Commons (Registration of Town or Village Greens) and Dedicated Highways (Landowner Statements and Declaration) (England) Regulations 2013 or (if deposited before 1st October 2013) in accordance with section 31(6) of the Highways Act 1980. Any accompanying map must be an ordnance map at a scale of not less than 1:10,560 showing the boundary of the land to which the application relates in coloured edging.*
9. *An application must be accompanied by the requisite fee – please ask the appropriate authority for details.*

10. 'Appropriate authority' means (a) in relation to a map or statement deposited or declaration lodged under section 31(6) of that Act, an appropriate council (as defined in section 31(7) of the Highways Act 1980); and (b) in relation to a statement and map deposited under section 15A(1) of the 2006 Act, a commons registration authority (defined in section 4 of the Commons Act 2006 and section 2 of the Commons Registration Act 1965). In practice, the appropriate council and commons registration authority will usually be the same body.

**PART A: Information relating to the applicant and land to which the application relates**  
*(all applicants must complete this Part)*

1. Name of appropriate authority to which the application is addressed:

Countryside Access Team  
Nottinghamshire County Council  
Floor 8 Trent Bridge House  
West Bridgford  
Nottingham

2. Name and full address (including postcode) of applicant:

Aldergate Estates Limited (CRN 2732343)  
46 High Street  
Arnold  
Nottingham  
NG5 7DZ

3. Status of applicant (tick relevant box or boxes):

I am

- (a)  the owner of the land(s) described in paragraph 4.  
(b)  making this application and the statements/declarations it contains on behalf of [insert name of owner] who is the owner of the land(s) described in paragraph 4 and in my capacity as [insert details].

4. Insert description of the land(s) to which the application relates (including full address and postcode):

The land to which this application relates comprises a number of parcels of land as shown edged in red on the plan attached. It lies at Common Lane and Whyburn Lane Hucknall Nottingham in a location known as Beacon Hill.

One of the nearby Post Codes is believed to be NG15 6QG.

5. Ordnance Survey six-figure grid reference(s) of a point within the area of land(s) to which the application relates (if known):

SK515 490

6. This deposit comprises the following statement(s) and/or declarations:

**PART B: Statement under section 31(6) of the Highways Act 1980**

I am a Director of Aldergate Estates, the owner of the land described in paragraph 4 of Part A of this form and shown edged red on the map accompanying this statement, and am authorised to submit this statement.

1. Ways shown marked blue on the accompanying map are public bridleways.
2. No other ways over the land shown edged red on the accompanying map have been dedicated as highways.
3. There are no other routes of public access over the land shown edged red on the accompanying map.

**PART E: Additional information relevant to the application**  
*(insert any additional information relevant to the application)*

The land forms part of the land referred to in previous Statements & Declarations submitted on behalf of the previous owner (JD Houldsworth Trust).

**PART F: Statement of Truth**  
*(all applicants must complete this Part)*

**WARNING:** If you dishonestly enter information or make a statement that you know is, or might be, untrue or misleading, and intend by doing so to make a gain for yourself or another person, or to cause loss or the risk of loss to another person, you may commit the offence of fraud under section 1 of the Fraud Act 2006, the maximum penalty for which is 10 years' imprisonment or an unlimited fine, or both.

**I BELIEVE THAT THE FACTS AND MATTERS CONTAINED IN THIS FORM ARE TRUE**

Signature (of the person making the statement of truth):

Print full name: Wayne William Scholter F.R.I.C.S  
Director - For & on behalf of Aldergate Estates Limited

Date: 16th June 2016

You should keep a copy of the completed form

**Data Protection Act 1998 - Fair Processing Notice**

The purpose of this Fair Processing Notice is to inform you of the use that will be made of your personal data, as required by the Data Protection Act 1998.

The appropriate authority (see explanation of definition in above guidance notes) in England is the data controller in respect of any personal data that you provide when you complete this form.

The information that you provide will be used by the appropriate authority in its duties to process applications to deposit statements, maps and declarations under section 31(6) the Highways Act 1980 and statements under section 15A(1) of the Commons Act 2006. The information you provide will also be used by the appropriate authority in its duty to update the registers in which details of such deposits are recorded under the Dedicated Highways (Registers under Section 31A of the Highways Act 1980) (England) Regulations 2007 and the Commons (Registration of Town or Village Greens) and Dedicated Highways (Landowner Statements and Declarations) (England) Regulations 2013.

The appropriate authority is required by the legislation above to maintain a register which holds information provided in this form, which can be inspected online or in person by members of the public on request. It may also be required to release information, including personal data and commercial information, on request under the Environmental Information Regulations 2004 or the Freedom of Information Act 2000. However, the appropriate authority will not permit any unwarranted breach of confidentiality nor will they act in contravention of their obligations under the Data Protection Act 1998.



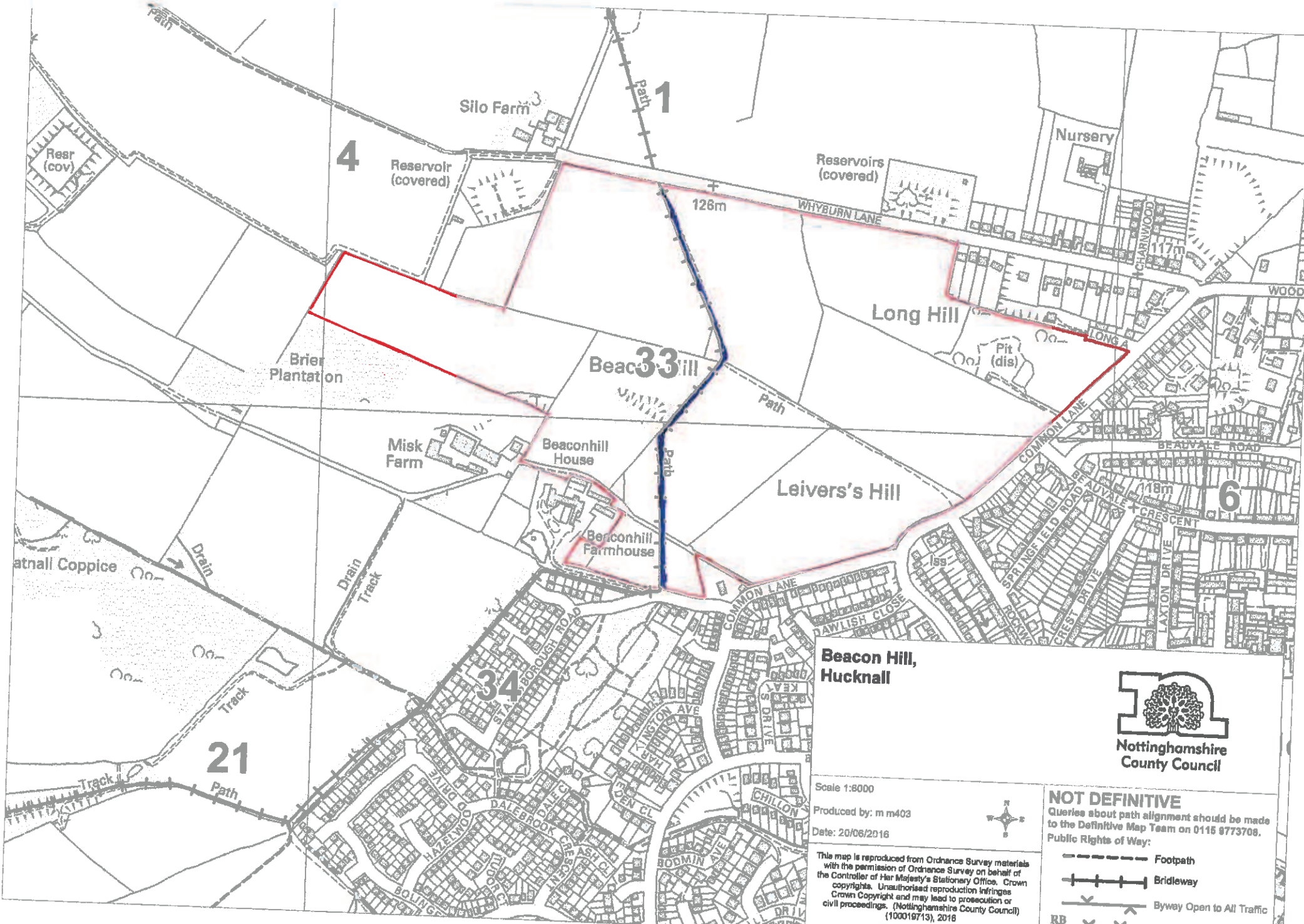

**Beacon Hill,  
Hucknall**



**Nottinghamshire  
County Council**

Scale 1:8000

Produced by: m m403

Date: 20/06/2016



**NOT DEFINITIVE**

Queries about path alignment should be made to the Definitive Map Team on 0115 9773708.  
Public Rights of Way:

- Footpath
- Bridleway
- Byway Open to All Traffic
- Restricted Byway

This map is reproduced from Ordnance Survey materials with the permission of Ordnance Survey on behalf of the Controller of Her Majesty's Stationery Office. Crown Copyright. Unauthorised reproduction infringes Crown Copyright and may lead to prosecution or civil proceedings. (Nottinghamshire County Council) (100019713), 2016

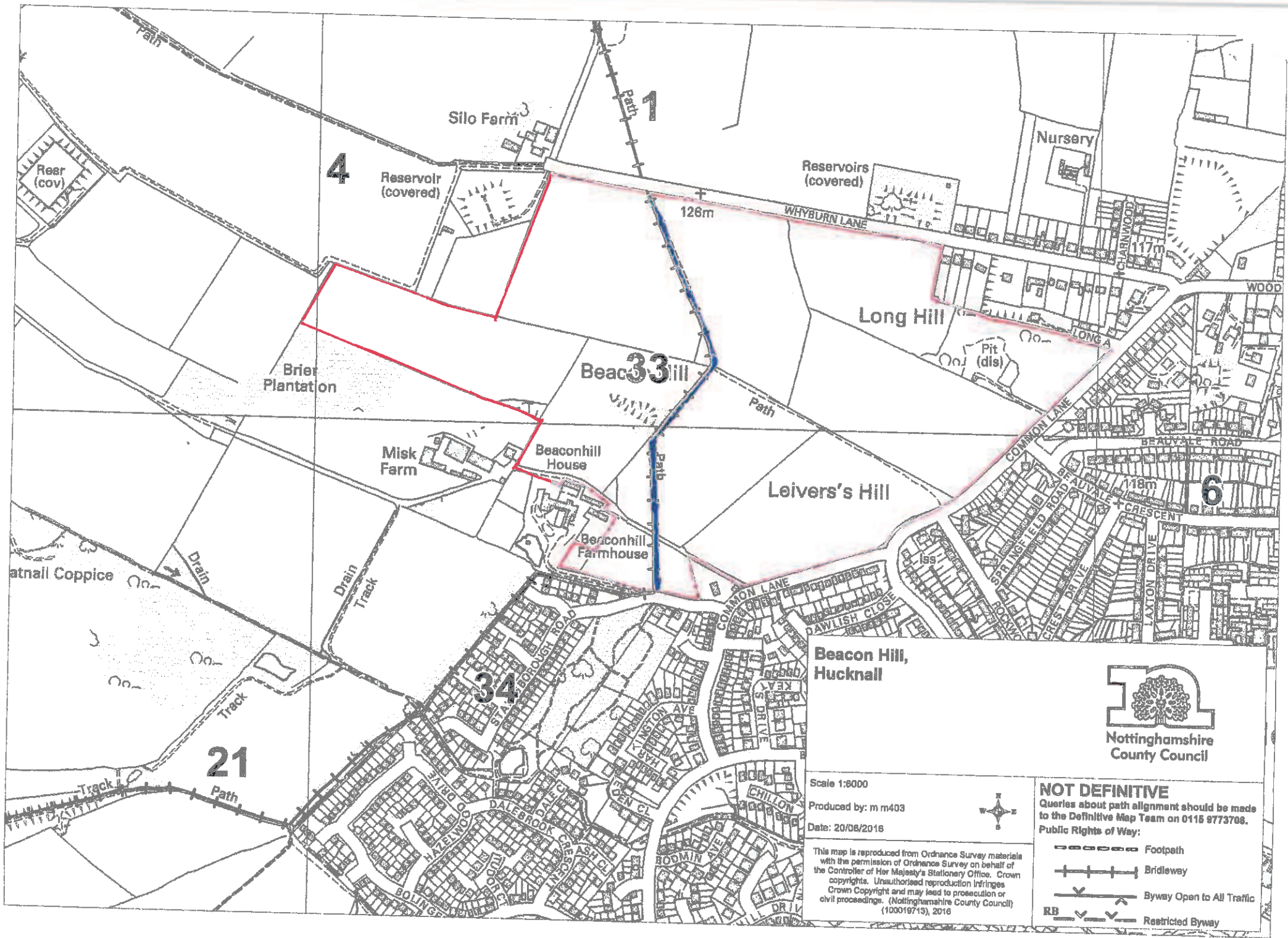

**Beacon Hill,  
Hucknail**



**Nottinghamshire  
County Council**

Scale 1:8000  
Produced by: m403  
Date: 20/06/2016



**NOT DEFINITIVE**  
Queries about path alignment should be made  
to the Definitive Map Team on 0115 9773708.  
Public Rights of Way:

- Footpath
- Bridleway
- Byway Open to All Traffic
- Restricted Byway

This map is reproduced from Ordnance Survey materials with the permission of Ordnance Survey on behalf of the Controller of Her Majesty's Stationary Office. Crown copyright. Unauthorised reproduction infringes Crown Copyright and may lead to prosecution or civil proceedings. (Nottinghamshire County Council) (100019713), 2016

## SCHEDULE 1

Regulation 2(2)(a)

## Application Form

## Form CA16

**Application Form for deposits under section 31(6) of the Highways Act 1980 and section 15A(1) of the Commons Act 2006****Please read the following guidance carefully before completing this form**

1. *Guidance relating to completion of this form is available from <https://www.gov.uk/town-and-village-greens-how-to-register>. Please refer to these separate notes when completing this form.*
2. *Parts A and F must be completed in all cases.*
3. *The form must be signed and dated by, or by a duly authorised representative of, every owner of land to which the application relates who is an individual, and by the secretary or some other duly authorised officer of every owner of land to which the application relates which is a body corporate or an unincorporated association.*
4. *In the case of land in joint ownership all the joint owners must complete paragraphs 2 and 3 of Part A and complete and sign the application in Part F, unless a duly authorised representative completes and signs the form on behalf of all of the owners of the land. Paragraph 3 should be completed in full to clearly explain the capacity of each applicant e.g. trustee, landowner's managing agent, executor.*
5. *'Owner' is defined in section 61(3) of the Commons Act 2006 and section 31(7) of the Highways Act 1980 and means, broadly, a legal owner of the freehold interest in the land.*
6. *Where the application relates to more than one parcel of land, a description of each parcel should be included in Paragraph 4 of Part A and the remainder of the form should be completed to clearly identify which statement and/or declaration relates to which parcel of land. This may require the insertion of additional wording. See separate notes for further guidance. Multiple parcels of land should be clearly identified by coloured edging on any accompanying map.*
7. *Where a statement or declaration requires reference to colouring shown on an accompanying map or previously lodged map, the colouring must be clearly specified and must match that shown on the relevant map. For example, if a footpath is specified in a Part C declaration as shown coloured brown, the accompanying map or previously deposited map referred to must reflect that colouring.*
8. *An application must be accompanied by an ordnance map, or (in respect of declarations under Part C or statements under Part D of this form) refer to a map previously deposited in accordance with the Commons (Registration of Town or Village Greens) and Dedicated Highways (Landowner Statements and Declaration) (England) Regulations 2013 or (if deposited before 1st October 2013) in accordance with section 31(6) of the Highways Act 1980. Any accompanying map must be an ordnance map at a scale of not less than 1:10,560 showing the boundary of the land to which the application relates in coloured edging.*
9. *An application must be accompanied by the requisite fee – please ask the appropriate authority for details.*



10. 'Appropriate authority' means (a) in relation to a map or statement deposited or declaration lodged under section 31(6) of that Act, an appropriate council (as defined in section 31(7) of the Highways Act 1980); and (b) in relation to a statement and map deposited under section 15A(1) of the 2006 Act, a commons registration authority (defined in section 4 of the Commons Act 2006 and section 2 of the Commons Registration Act 1965). In practice, the appropriate council and commons registration authority will usually be the same body.

**PART A: Information relating to the applicant and land to which the application relates**  
*(all applicants must complete this Part)*

1. Name of appropriate authority to which the application is addressed:

Countryside Access Team  
Nottinghamshire County Council  
Floor 8 Trent Bridge House  
West Bridgford  
Nottingham

2. Name and full address (including postcode) of applicant:

Aldergate Estates Limited (CRN 2732343)  
46 High Street  
Arnold  
Nottingham  
NG5 7DZ

3. Status of applicant (tick relevant box or boxes):

I am

(a)  the owner of the land(s) described in paragraph 4.

(b)  making this application and the statements/declarations it contains on behalf of [insert name of owner] who is the owner of the land(s) described in paragraph 4 and in my capacity as [insert details].

4. Insert description of the land(s) to which the application relates (including full address and postcode):

The land to which this application relates comprises a number of parcels of land as shown edged in red on the plan attached. It lies at Common Lane and Whyburn Lane Hucknall Nottingham in a location known as Beacon Hill.

One of the nearby Post Codes is believed to be NG15 6QG.

5. Ordnance Survey six-figure grid reference(s) of a point within the area of land(s) to which the application relates (if known):

SK515 490

6. This deposit comprises the following statement(s) and/or declarations (delete Parts B, C, or D where not applicable):

**PART B: Statement under section 31(6) of the Highways Act 1980**

[I am/[insert name of owner] is] the owner of the land described in paragraph 4 of Part A of this form and shown [insert colouring] on the map accompanying this statement.

*(delete wording in square brackets as appropriate and/or insert information as required)*

[Ways shown [insert colouring] on the accompanying map are byways open to all traffic.]

[Ways shown [insert colouring] on the accompanying map are restricted byways.]

[Ways shown [insert colouring] on the accompanying map are public bridleways.]

[Ways shown [insert colouring] on the accompanying map are public footpaths.]



**PART C: Declaration under section 31(6) of the Highways Act 1980**

1. I am the owner of the land described in paragraph 4 of Part A of this form and shown edged in red on the map lodged with Nottinghamshire County Council on 14th June 2016.

2. On the 14<sup>th</sup> day of June 2016 I deposited with Nottinghamshire County Council, being the appropriate council, a statement accompanied by a map showing my property edged in red on the map attached to it which stated that:  
the ways shown in blue on that map and on the map accompanying this declaration had been dedicated as bridleways.  
no other ways had been dedicated as highways over my property.

3. On the [insert day] day of [insert month, year] [I/my/[insert name of owner's] predecessor in title [insert name]] deposited with [insert name] Council, being the appropriate council, a declaration dated [insert day, month, year], stating that no additional ways [other than those marked in the appropriate colour on the map accompanying that declaration] had been dedicated as [byways open to all traffic] [restricted byways] [bridleways] [footpaths] since the deposit of the statement referred to in paragraph 2 above.]  
*(delete if not applicable and delete wording in square brackets as appropriate and/or insert information as required)*

4. No additional ways have been dedicated over the land edged in red on the map since the statement dated 14<sup>th</sup> June 2016 referred to in paragraph 2 above and at the present time I have no intention of dedicating any more public rights of way over my property.

**PART D: Statement under section 15A(1) of the Commons Act 2006**

[I am/[insert name of owner] is] the owner of the land described in paragraph 4 of Part A of this form and shown [insert colouring] on the map [accompanying this statement/deposited with [insert name] Council on [insert day, month, year]].

[I/[insert name of owner]] [wish/wishes] to bring to an end any period during which persons may have indulged as of right in lawful sports and pastimes on the whole or any part of the land shown [insert colouring] on the [accompanying map/map referenced above].  
*(delete wording in square brackets as appropriate and/or insert information as required)*

**PART E: Additional information relevant to the application**  
*(insert any additional information relevant to the application)*

**PART F: Statement of Truth**  
*(all applicants must complete this Part)*

**WARNING:** If you dishonestly enter information or make a statement that you know is, or might be, untrue or misleading, and intend by doing so to make a gain for yourself or another person, or to cause loss or the risk of loss to another person, you may commit the offence of fraud under section 1 of the Fraud Act 2006, the maximum penalty for which is 10 years' imprisonment or an unlimited fine, or both.

**I BELIEVE THAT THE FACTS AND MATTERS CONTAINED IN THIS FORM ARE TRUE**

Signature (of the person making the statement of truth):

Print full name: **WAYNE WILLIAM SUTTON** (Director - for and on behalf of Adregulor Gates Ltd.)

Date: **21st June 2016**

You should keep a copy of the completed form

**Data Protection Act 1998 - Fair Processing Notice**

The purpose of this Fair Processing Notice is to inform you of the use that will be made of your personal data, as required by the Data Protection Act 1998.

The appropriate authority (see explanation of definition in above guidance notes) in England is the data controller in respect of any personal data that you provide when you complete this form.

The information that you provide will be used by the appropriate authority in its duties to process applications to deposit statements, maps and declarations under section 31(6) the Highways Act 1980 and statements under section 15A(1) of the Commons Act 2006. The information you provide will also be used by the appropriate authority in its duty to update the registers in which details of such deposits are recorded under the Dedicated Highways (Registers under Section 31A of the Highways Act 1980) (England) Regulations 2007 and the Commons (Registration of Town or Village Greens) and Dedicated Highways (Landowner Statements and Declarations) (England) Regulations 2013.

The appropriate authority is required by the legislation above to maintain a register which holds information provided in this form, which can be inspected online or in person by members of the public on request. It may also be required to release information, including personal data and commercial information, on request under the Environmental Information Regulations 2004 or the Freedom of Information Act 2000. However, the appropriate authority will not permit any unwarranted breach of confidentiality nor will they act in contravention of their obligations under the Data Protection Act 1998.

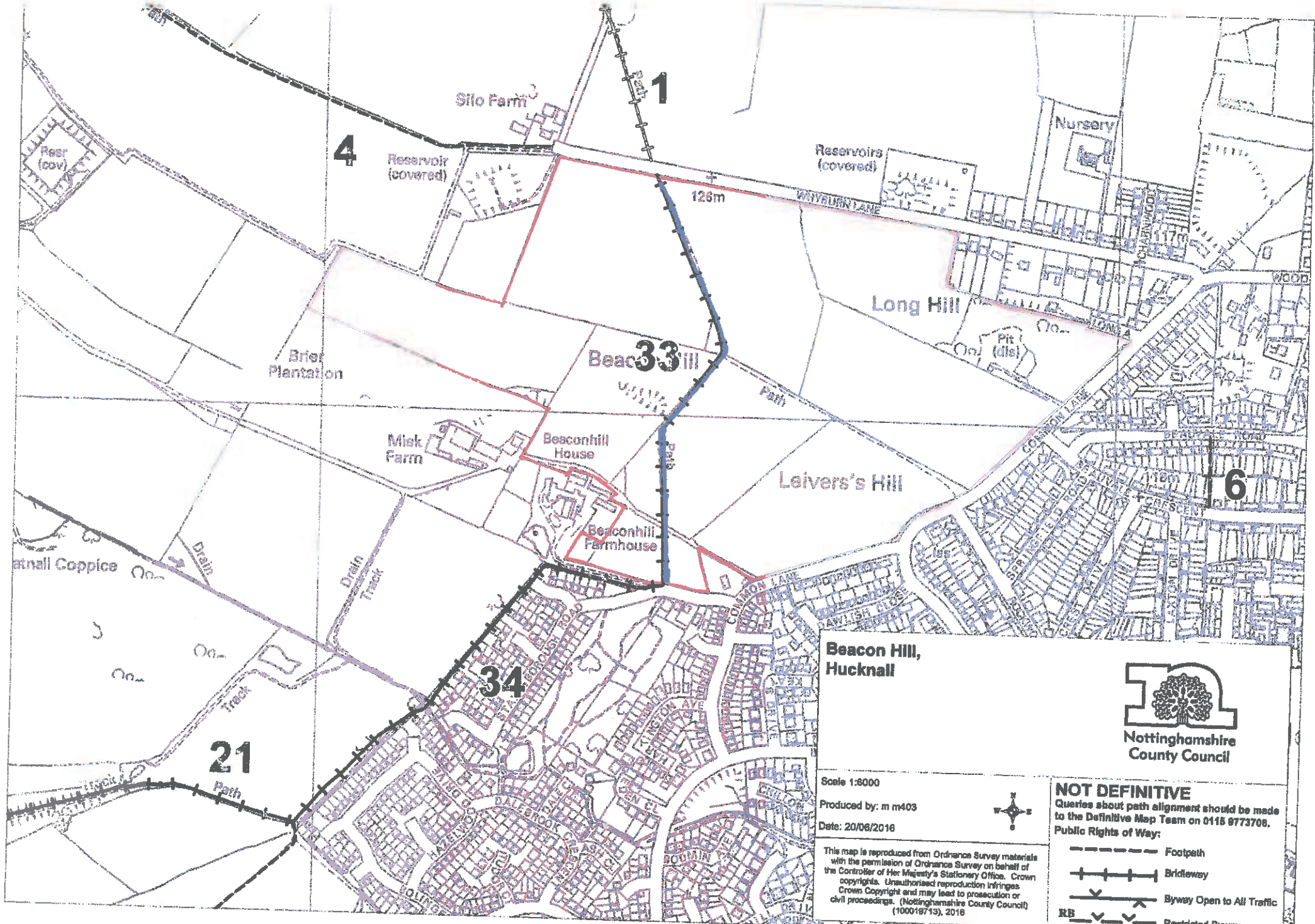

**Beacon Hill,  
Hucknall**



Scale 1:8000

Produced by: m m403

Date: 20/06/2016



This map is reproduced from Ordnance Survey materials with the permission of Ordnance Survey on behalf of the Controller of Her Majesty's Stationery Office. Crown copyrights. Unauthorised reproduction infringes Crown Copyright and may lead to prosecution or civil proceedings. (Nottinghamshire County Council) (100018/13), 2016

**NOT DEFINITIVE**  
 Queries about path alignment should be made to the Definitive Map Team on 0118 9773706.  
 Public Rights of Way:

- Footpath
- + + + + + Bridleway
- ^ ^ ^ ^ ^ Byway Open to All Traffic
- RB ^ ^ ^ ^ ^ Restricted Byway