

-
EPE.TH/AA16/1477M
Tim Hart
(0115) 977 4395
(0115) 977 2414
02 December 1998

Mr G Field
7 High Street
Hucknall
NOTTINGHAM
NG15 7HJ

1st Class

Dear Mr Field

**NOTTINGHAMSHIRE COUNTY COUNCIL
DEPOSIT OF STATEMENT AND PLAN AND STATUTORY DECLARATION -
SECTION 31(6) OF THE HIGHWAYS ACT 1980**

**PARISH: HUCKNALL
NAME OF LANDOWNER: GRAHAM PAUL FIELD AND
CHRISTOPHER CHAMBERS
NAME OF PROPERTY: THE MANAGERS HOUSE, CHURCH LANE
LINBY COLLIERY, LINBY**

I wish to acknowledge the receipt of your deposited Statement and Plan and Statutory Declaration on 27 November 1998.

The information contained in the Declaration will be held by this Authority as validation for the contents of the Statement and Plan. It will be necessary for you or your successors to renew the Statutory Declaration every six years, commencing from the date of the initial Statutory Declaration.

Any changes to your land holding or to the rights of way information in your initial Statement and Plan should be notified to the Rights of Way section, and should also be identified within a new Statutory Declaration covering a modified Statement and Plan.

Yours sincerely

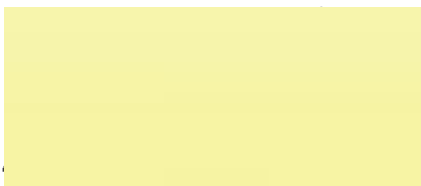

Rights of Way Review & Modifications Officer

7 High Street,
Hucknall,
Nottingham.
NG15 7HJ.
tel: 0115 9680809

26th November, 1998

For the attention of Tim Hart

Rights of Way Review & Modifications Officer,
Nottinghamshire County Council,
Environment,
Trent Bridge House,
Fox Road,
West Bridgford,
Nottingham. NG2 6BJ.

Dear Mr. Hart,

Land at Linby, Nottingham

Further to my letter of the 24th November I now enclose Statutory Declaration
duly sworn and Deposit of Statement and Plan duly signed.

I look forward to receiving the Agreement as soon as possible.

Yours sincerely,

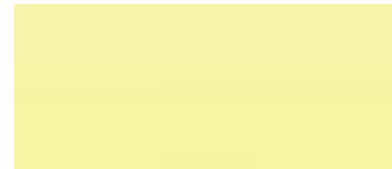

Graham P. Field.

pp



NOTTINGHAMSHIRE COUNTY COUNCIL

DEPOSIT OF STATEMENT AND PLAN

SECTION 31 (6) OF THE HIGHWAYS ACT 1980

1 WE ARE and have been since 19th April 1996 the owners within the meaning of the above section of the land known as The Managers House, Church Lane, Linby Colliery, Linby, Nottingham more particularly delineated on the attached plan accompanying this statement and thereon edged red

2 THE aforementioned land lies in the Parish of Hucknall

3 THE ways coloured by purple dashes on the said plan have been dedicated as FOOTPATHS

4 NO other ways over the land have been dedicated as highways

5 THE deposit shall comprise this statement and accompanying plan

SIGNED

SIGNED

CHRISTOPHER CHAMBERS

GRAHAM PAUL FIELD

Address 14 Main Street,
Linby, Nottingham

Address 7 High Street,
Hucknall, Nottingham

Date 25th November 1998

Date 25th November 1998.

Signed (witness)

Signed (witness)

name

Name

A. NEWMAN

A. NEWMAN

Address

Address

98 NABBS LANE
HUCKNALL, NOTTM.

Hucknall, Nottn.

Occupation

Occupation

Secretary.

Secretary.

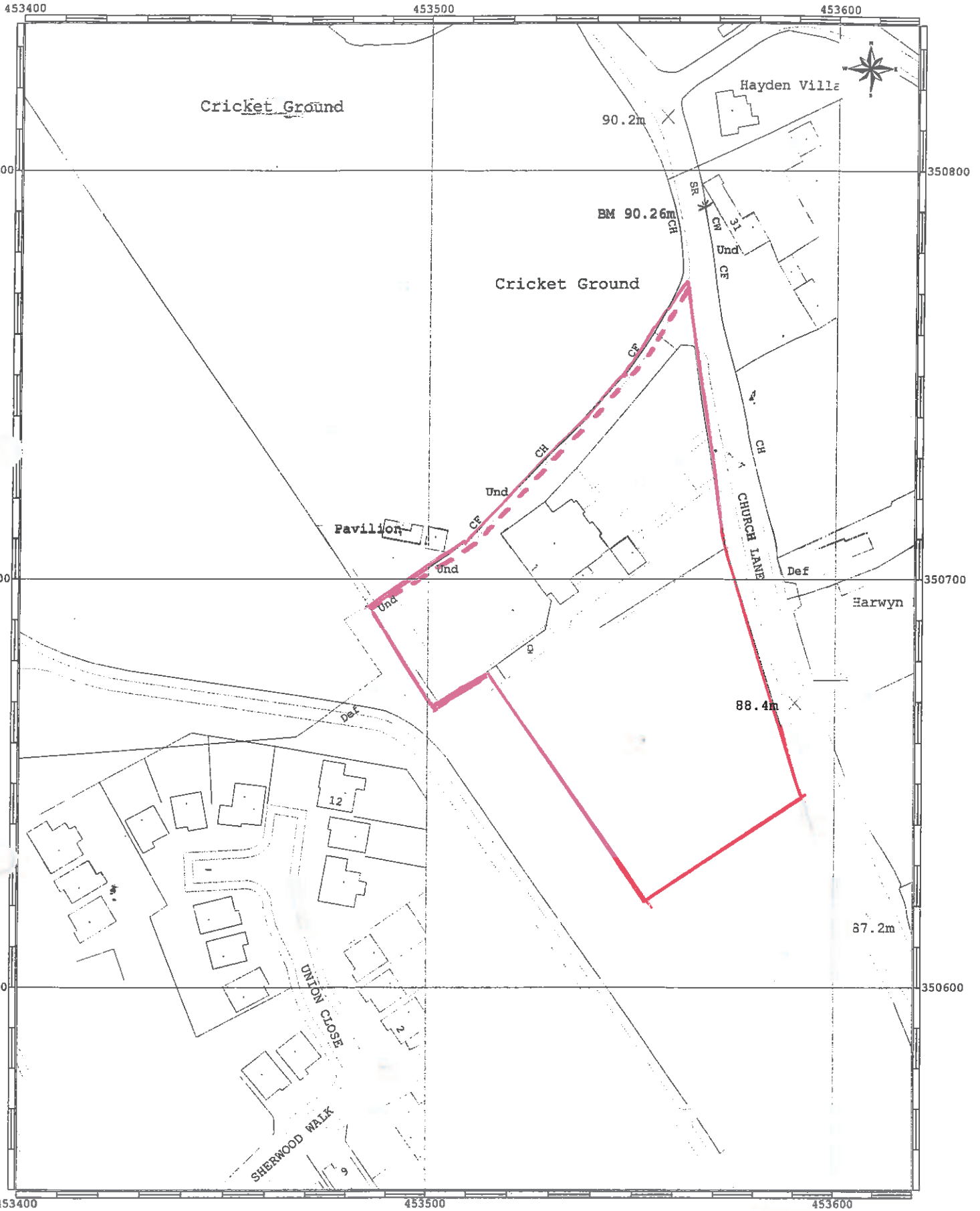

BASED UPON THE ORDNANCE SURVEY
 MAP WITH THE SANCTION OF THE
 CONTROLLER OF H.M. STATIONERY OFFICE.
 CROWN COPYRIGHT RESERVED
 LICENCE No. LA076791



Scale 1:1250

Date 17/09/98

Nottinghamshire
 County Council

NOTTINGHAMSHIRE COUNTY COUNCIL

STATUTORY DECLARATION

SECTION 31 (6) OF THE HIGHWAYS ACT 1980

WE Christopher Chambers and Graham Paul Field **DO SOLEMNLY AND SINCERELY DECLARE** as follows:

1 WE ARE and have been since 19th April 1996 the owners of the land known as The Managers House, Church Lane, Linby Colliery, Linby, Nottingham more particularly delineated on the plan accompanying this declaration and thereon edged red

2 ON the 25th day of November, 1998 Christopher Chambers and Graham Paul Field deposited with Nottinghamshire County Council, being the appropriate Council, a statement accompanied by a plan delineating our property by red edging which stated that the ways coloured purple on the said plan and on the plan accompanying this declaration are definitive or dedicated FOOTPATHS

3 WITH reference to 2 above Christopher Chambers and Graham Paul Field confirm that there are no additional public ways over the land edged red on the Plan and in the Statement dated

AND WE MAKE this solemn declaration of the 25th day of November 1998 conscientiously believing it to be true and by virtue of the Statutory Declarations Act 1835

Declared at

35A Watnall Road,
Hucknall,
Nottingham.

Signature

Signature

Before me

(SJ. Leveson)

~~Commissioner of Oaths/Justice of the Peace/Solicitor~~

ROBERT BARBER & SONS
SOLICITORS
35A WATNALL ROAD
HUCKNALL, NOTTS
NG15 7LD

This is the plan referred to in the Declaration declared before me

the 25th day of November 1998

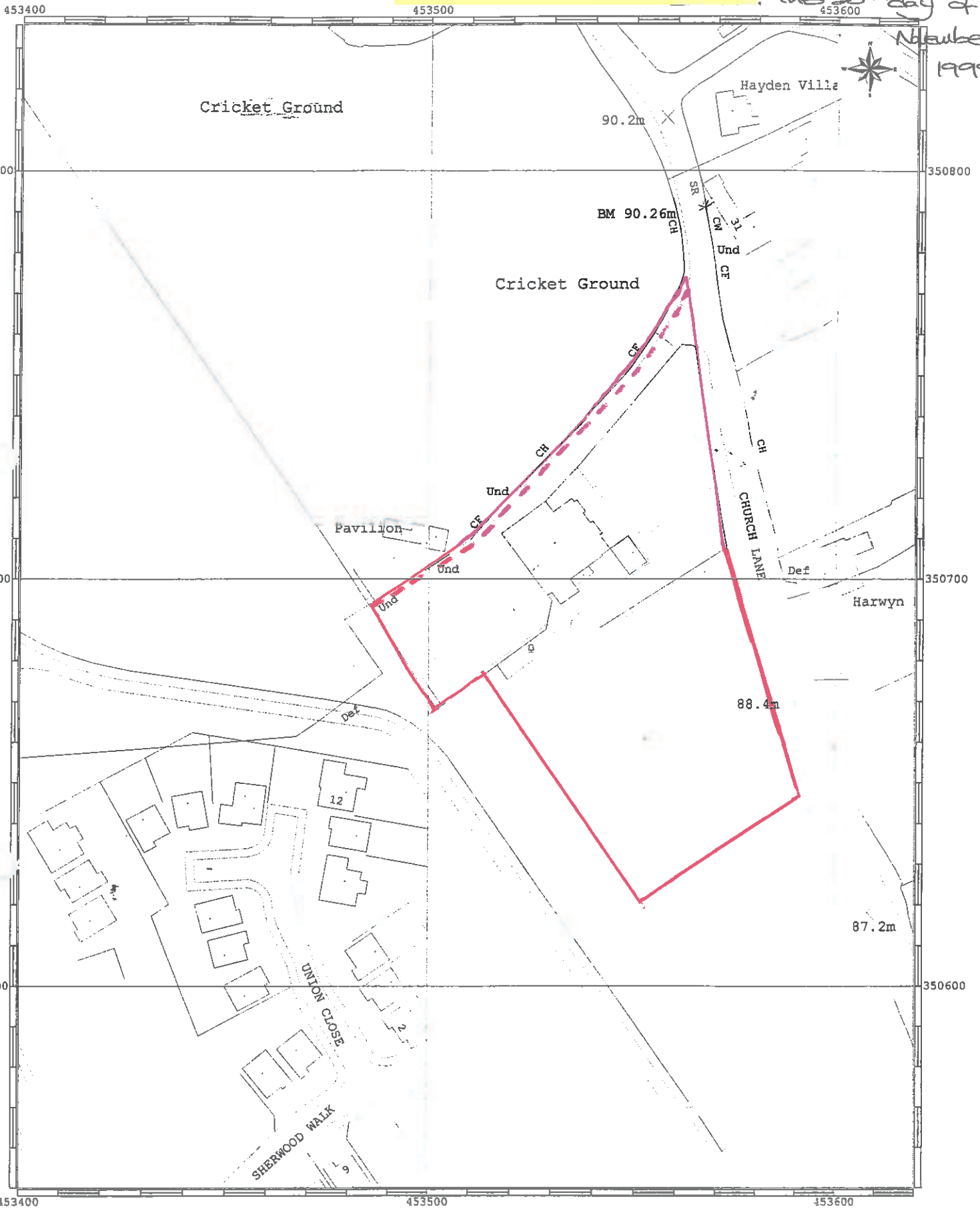

BASED UPON THE ORDNANCE SURVEY MAP WITH THE SANCTION OF THE CONTROLLER OF H.M. STATIONERY OFFICE. CROWN COPYRIGHT RESERVED LICENCE No. LA076791



Scale 1:1250

Date 17/09/98

Nottinghamshire County Council