

This matter is being dealt with by:  
**Eddie Brennan**  
Reference: EB/310208/Westerman  
T 0115 977 4709  
E eddie.brennan@nottscc.gov.uk  
W nottinghamshire.gov.uk

Mr Nigel Glenister  
W. Westerman Ltd  
158 Bye-Pass Road  
Chilwell  
Nottinghamshire  
NG9 5HQ

8 March 2012

Dear Sir

**NOTTINGHAMSHIRE COUNTY COUNCIL: DEPOSIT OF STATEMENT PLAN AND  
STATUTORY DECLARATION - SECTION 31(6) HIGHWAYS ACT 1980  
NAME OF LANDOWNER: W WESTERMAN LTD  
NAME OF PROPERTY: VARIOUS LOCATIONS IN NOTTINGHAMSHIRE (10 NO.)**

Thank you for your letter dated 19 November 2012.

I wish to acknowledge the receipt of 10 Statutory Declarations on the 22 November 2012.

The information contained in the Declarations **will** be held by this Authority as validation for the contents of the respective Statement and Plan.

Any changes to your land holding or the rights of way information in your initial Statement and Plan should be notified to the Countryside Access Section, and should also be identified **with** a new Statutory Declaration covering a modified Statement and Plan.

Yours faithfully,

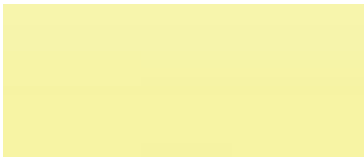

Definitive Map Officer  
Nottinghamshire County Council

Head Office  
158 Bye Pass Road, Chilwell,  
Nottinghamshire NG9 5HQ

Telephone: 0115 925 5100 Fax: 0115 943 0833

www.westermanhomes.co.uk

email: general@westermanhomes.co.uk

  
**WESTERMAN**  
Quality homes since 1933

Nottinghamshire County Council  
Trent Bridge House  
Fox Road  
West Bridgeford  
Nottingham  
NG2 6BJ

NG

19th November 2012

22-11-2012

Dear Sir/Madam

**Re: Deposit of Statutory Declarations**

Please find enclosed ten Statutory Declarations in accordance with Section 31(6) of the Highway Act 1990. Each declaration is in support of deposits previously lodged with the Council.

The Statutory Declarations enclosed refer to Land known as the following;

- Whyburn Farm, Hucknall
- Land at Nottingham Road, Hucknall
- Bourne Avenue, Selston
- Fields Farm, Stapleford
- Land to the West of Low Wood Road, Nuthall
- Sutton Middle Lane, Kirkby in Ashfield
- Land off Pinfold Lane, Kinoulton
- Land at Firs Farm, Manfield
- Land at Baulk Lane, Stapleford
- Land off Pinxton Lane, Kirkby in Ashfield

Yours faithfully



Property Executive

Westerman Homes is the marketing name covering:

W. Westerman Ltd.  
(Founded in 1933 by W. Westerman)  
Registered in England  
Reg. No. 406312 V.A.T. No. 927 1280 29

Registered Office: 158 Bye Pass Road, Chilwell, Nottingham NG9 5HQ

  
N4BC

  
HBF  
HOME BUILDERS FEDERATION

**STATUTORY DECLARATION**

**SECTION 31(6) OF THE HIGHWAYS ACT 1980**

I **ROBERT BRIAN WESTERMAN**, Director of W Westerman Ltd, 158 Bye Pass Rd, Chilwell, Nottingham NG9 5HQ, DO SOLEMNLY AND SINCERELY DECLARE as follows:

1. W Westerman Ltd is and has been since April 1962 the owner of the property known as Land off Nottingham Road Hucknall more particularly delineated on the map accompanying this declaration and thereon edged red.
2. On the 1st day of June 2012 I deposited with Nottinghamshire County Council, being the appropriate Council, a statement accompanied by a map delineating the company's property by red edging ("the property") which stated that no ways had been dedicated as highways over the property a true copy of which is marked RBW3 and exhibited hereto.
3. No additional ways have been dedicated over the property since the statement dated 1st June 2012 referred to in (2) above and at the present time neither I nor W Westerman Ltd nor any person on their behalf have any intention of dedicating any public rights of way over the property.

AND I MAKE this solemn declaration on the 14<sup>th</sup> day of NOVEMBER 2012 conscientiously believing it to be true and by virtue of the Statutory Declarations Act 1835.

Declared by the above named:

Signed .....  ..... (Director)  
For and on behalf of W Westerman Ltd

Before me

Signed .....  ..... (Solicitor)

**RICHARD J. CLIFF**  
Solicitor  
Long Eaton

**STATUTORY DECLARATION**

**OF ROBERT BRIAN WESTERMAN**

---

**EXHIBIT RBW3**

---

**This is the exhibit marked RBW3 referred to in the Statutory**

**Declaration of Robert Brian Westerman declared on**

14<sup>th</sup> NOVEMBER, 2012

**Before me**

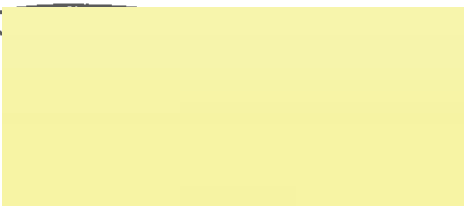

**Solicitor**

**DEPOSIT OF STATEMENT & MAP  
SECTION 31(6) HIGHWAYS ACT 1980**

To Nottingham County Council

1. We W Westerman Ltd are the owners within the meaning of the above Section of the Highways Act 1980 of the Land known as Land off Nottingham Road, Hucknall more particularly delineated on the map accompanying this statement and thereon edged red.
2. The aforementioned land lies in the Parish of Buiwell.
3. Ways colour green on the said map are public bridle ways
4. No other ways have been dedicated as highways.
5. The deposit shall comprise of this statement and accompanying map.

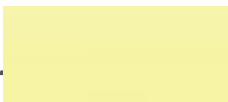
Signed .....  ..... (Director)

For and on behalf of      W Westerman Ltd  
   158 Bye Pass Road  
   Chilwell  
   Nottingham  
   NG9 5HQ

Dated ..... 1<sup>st</sup> June ..... 2012

# Public rights of way in Nottin

Brdl



Map centre: 454262, 346992 10019713 (2012)

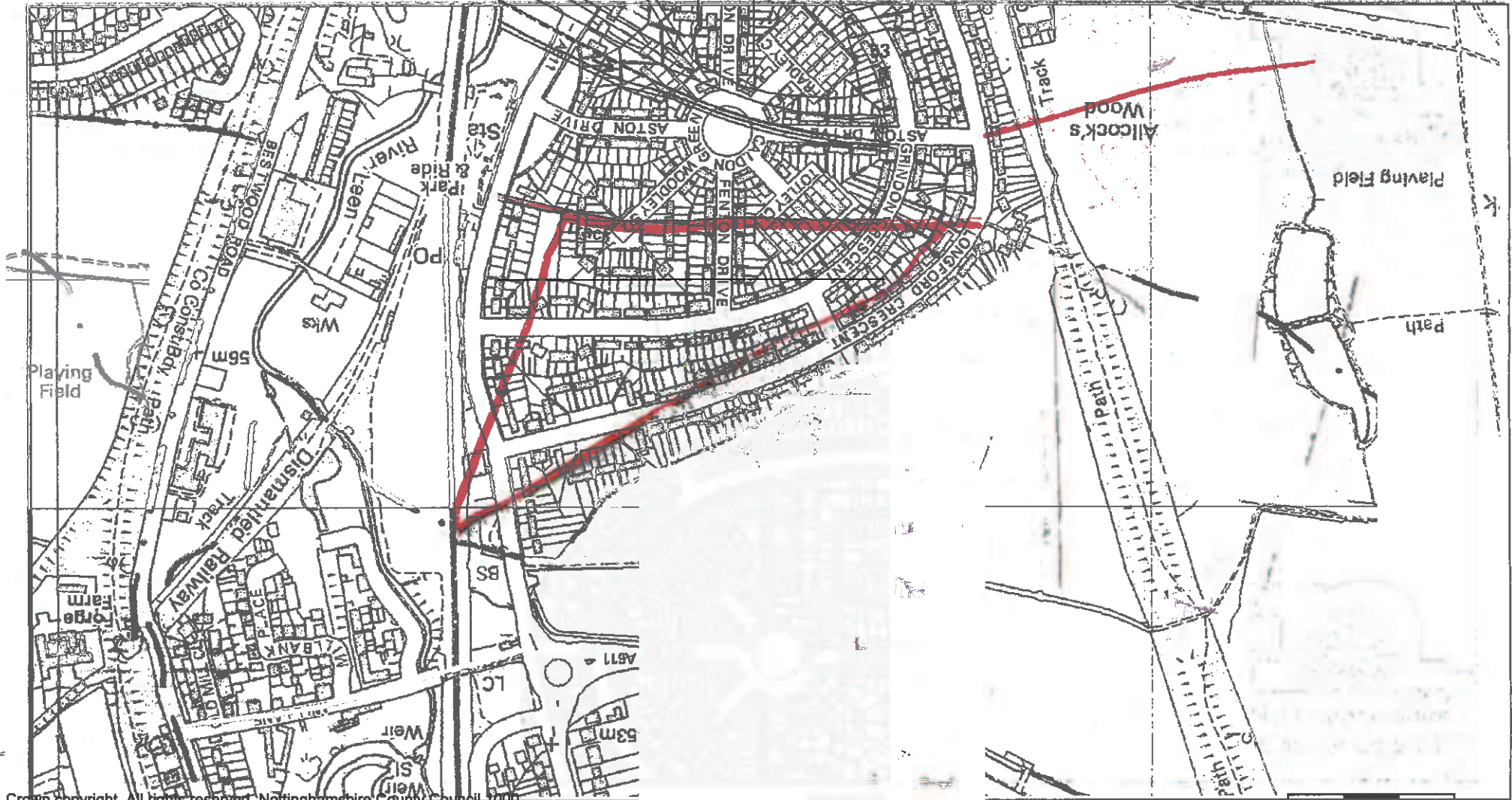

Crown Copyright. All rights reserved. Nottinghamshire County Council 1000

-  Footpath
-  Byway
-  Restricted Byway

NOTTINGHAM ROAD, HUCKNALL (LAND AT)



Nottinghamshire  
County Council

Public rights of way are provided with no guarantee of accuracy. This is not the Definitive Map and should not be used for land search purposes.



Legal Services  
Nottingham County Council  
County Hall  
Loughborough Road  
West Bridgford  
Nottingham  
NG2 7QP

NG

7 June 2012

Dear Sir/Madam

**Re: Deposit of Statement and Map**

Please find enclosed statements and maps for ten parcels of land for deposit in accordance with Section 31(6) of the Highways Act 1980. These include;

1. Land to the West of Low Wood Road, Nuthall.
2. Land off Pinfold Lane, Kinoulton.
3. Land known as Firs Farm, Mansfield.
4. Land at Baulk Lane, Stapleford.
5. Land off Pinxtan Lane, Kirkby in Ashfield.
6. Land at Bourne Avenue, Selston.
7. Land off Nottingham Road, Hucknall.
8. Fields Farm, Stapleford.
9. Whyburn Farm, Hucknall.
10. Land known as Sutton Middle Lane, Kirkby in Ashfield.

Yours faithfully



Property Executive

Westerman Homes is the marketing name covering:

W. Westerman Ltd.  
(Founded in 1933 by W. Westerman)  
Registered in England  
Reg. No. 406312 V.A.T. No. 927 1280 29

Registered Office: 158 Bye Pass Road, Chilwell, Nottingham NG9 5HQ

DEPOSIT OF STATEMENT & MAP  
SECTION 31(6) HIGHWAYS ACT 1980

To Nottingham County Council

1. We W Westerman Ltd are the owners within the meaning of the above Section of the Highways Act 1980 of the Land known as Land off Nottingham Road, Hucknall more particularly delineated on the map accompanying this statement and thereon edged red.
2. The aforementioned land lies in the Parish of Bulwell.
3. Ways colour green on the said map are public bridle ways
4. No other ways have been dedicated as highways.
5. The deposit shall comprise of this statement and accompanying map.

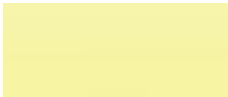
Signed .....  ..... (Director)

For and on behalf of W Westerman Ltd  
158 Bye Pass Road  
Chilwell  
Nottingham  
NG9 5HQ

Dated ..... 1<sup>st</sup> June ..... 2012



# Public rights of way in Nottinghamshire

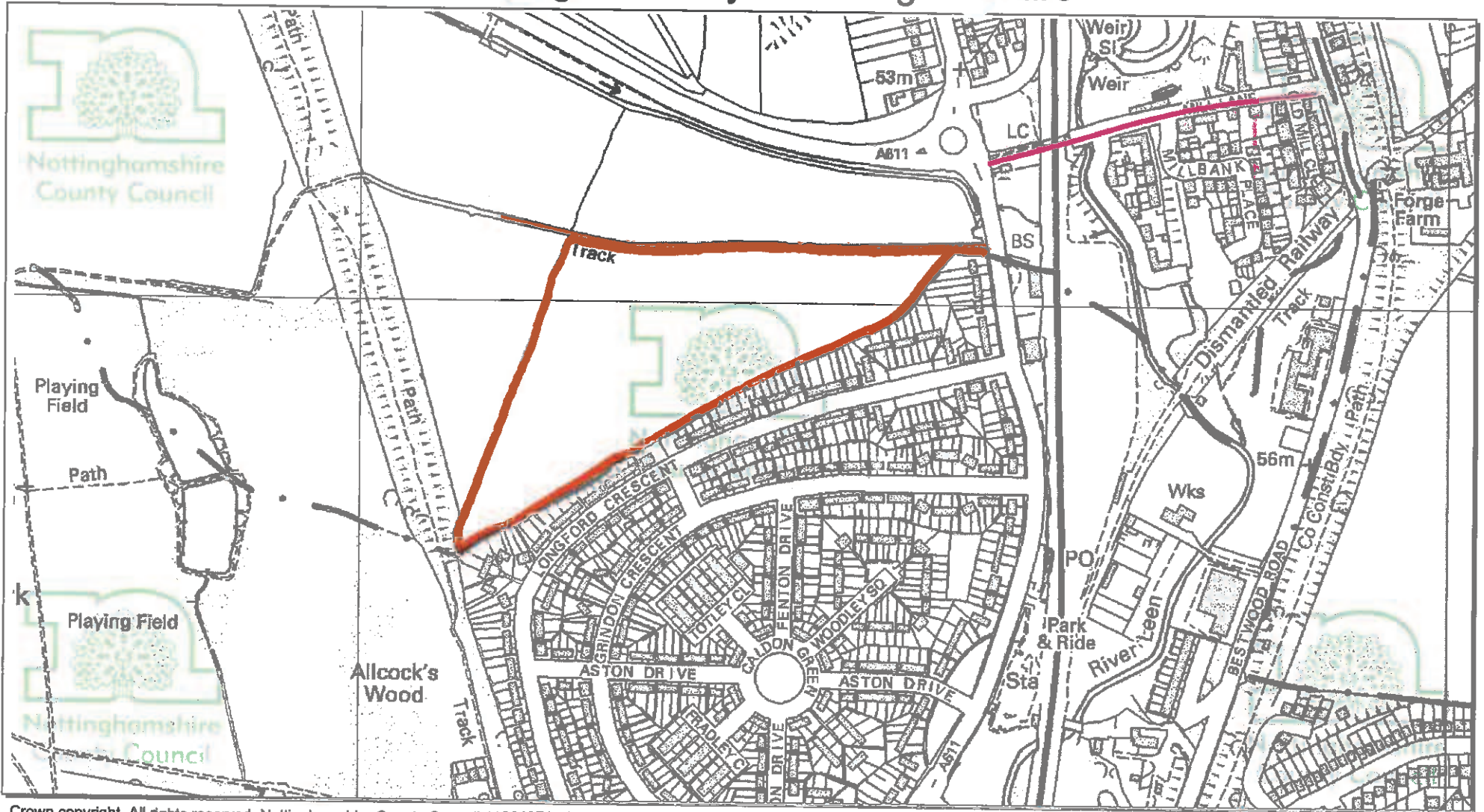

Crown copyright. All rights reserved. Nottinghamshire County Council 100019713 (2012)

Map centre: 454352,346902

- 

Footpath
- 

Bridleway
- 

Byway
- 

Restricted Byway



NOTTINGHAM ROAD, HUCKNALL (LAND AT)



Public rights of way are provided with no guarantee of accuracy. This is not the Definitive Map and should not be used for land search purposes.

