

PTC.TH/ME15
Mr T Hart
(0115) 977 4395
(0115) 977 2414
11 November 1996

Mrs D Peters
Rose Cottage
Main Street
Flintham
NEWARK
Notts NG23 5LA

1st Class

Dear Mrs Peters

**NOTTINGHAMSHIRE COUNTY COUNCIL
DEPOSIT OF STATEMENT AND PLAN AND STATUTORY
DECLARATION - SECTION 31(6) OF THE HIGHWAYS ACT 1980
PARISH : FLINTHAM
NAME OF LANDOWNER: DOREEN PETERS
NAME OF PROPERTY : ROSE COTTAGE**

I wish to acknowledge the receipt of your deposited Statement and Plan and Statutory Declaration on 2 October 1996.

The information contained in the Declaration will be held by this Authority as validation for the contents of the Statement and Plan. It will be necessary for you or your successors to renew the Statutory Declaration every six years, commencing from the date of the initial deposit of the Statement and Plan.

Any changes to your land holding or to the rights of way information in your initial Statement and Plan should be notified to the Rights of Way section, and should also be identified within a new Statutory Declaration covering a modified Statement and Plan.

Yours sincerely



for Group Manager (Countryside)

NOTTINGHAMSHIRE COUNTY COUNCIL

STATUTORY DECLARATION

SECTION 31 (6) OF THE HIGHWAYS ACT 1980

I DOREEN PETERS DO SOLEMNLY AND SINCERELY DECLARE as follows:
[Full Name]

1. I am and have been since 29 OCTOBER 1987 the owner of the land known as ROSE Cottage
[day, month, year]
FLINTHAM more particularly delineated on the plan accompanying this declaration
[name of farm, etc]
and thereon edged red.

2. On the 21st day of OCTOBER 1996 I DOREEN PETERS deposited with
[month][year] [Full Name]
Nottinghamshire County Council, being the appropriate Council, a statement accompanied by
a plan delineating my property by red edging which stated that ~~the ways coloured orange on~~
~~the said plan and on the plan accompanying this declaration are definitive or dedicated~~
~~BYWAYS OPEN TO ALL TRAFFIC (B.O.A.T.s)~~ ~~the ways indicated by brown dashes on the~~
~~said plan and on the plan accompanying this declaration are definitive ROADS USED AS~~
~~PUBLIC PATHS (R.U.P.P.s)~~ ~~the ways coloured green on the said plan and on the plan~~
~~accompanying this declaration are definitive or dedicated as BRIDLEWAYS~~ ~~the ways~~
~~coloured purple on the said plan and on the plan accompanying this declaration are definitive~~
~~or dedicated FOOTPATHS~~ [There are no definitive or dedicated Rights of Way over my
property.]

3. With reference to 2 above, I DOREEN PETERS confirm that there are no additional public
[Full name]
ways over the land edged red on the Plan and in the Statement dated 30/9/96
[day, month, year]
(other than those definitive routes coloured yellow and those dedicated routes coloured by
yellow dashes and marked *(byway) *(bridleway) *(footpath) on the Plan accompanying this
Declaration).

* Delete as appropriate.

AND I MAKE this solemn declaration of the 30 day of September 1996 conscientiously
[Month, Year]
believing it to be true and by virtue of the Statutory Declarations Act 1835.

Declared at [address] [redacted]

[signature of landowner]

3 Middlegate Newark Notts

Before me [redacted]

was F C [redacted]

[Commissioner of Oaths or a Justice of the Peace or Solicitor]



NOTTINGHAMSHIRE COUNTY COUNCIL

DEPOSIT OF STATEMENT AND PLAN

SECTION 31 (6) OF THE HIGHWAYS ACT 1980

To

1. I am and have been since 29 OCTOBER 1987 the owner within the meaning of the [day, month, year] above section of the land known as ROSE COTTAGE, FLINTHAM, more particularly delineated [Name of Farm, etc] on the attached plan accompanying this statement and thereon edged red.
 2. The aforementioned land lies in the Parishes/Communities of [FLINTHAM] and [.....].
 3. ~~The ways coloured orange on the said plan appear on the Definitive Map as BYWAYS OPEN TO ALL TRAFFIC (B.O.A.T.s).~~
 4. ~~The ways coloured by orange dashes on the said plan have been dedicated as BYWAYS OPEN TO ALL TRAFFIC (B.O.A.T.s).~~
 5. ~~The ways coloured by brown dashes on the said plan appear on the Definitive Map as ROADS USED AS PUBLIC PATHS (R.U.P.P.s).~~
 6. ~~The ways coloured green on the said plan appear on the Definitive Map as BRIDLEWAYS.~~
 7. ~~The ways coloured by green dashes on the said plan have been dedicated as BRIDLEWAYS.~~
 8. ~~The ways coloured purple on the said plan appear on the Definitive Map as FOOTPATHS.~~
 9. ~~The ways coloured by purple dashes on the said plan have been dedicated as FOOTPATHS.~~
 10. No ~~other~~ ways over the land have been dedicated as highways.
 11. The deposit shall comprise this statement and accompanying plan.
- * Delete as applicable.

Signed (landowner)

Name (or landowner)

DORCEL PETERS

Address

ROSE COTTAGE
MAIN STREET
FLINTHAM NEWARK NOTTS NG23 5LA

Date

30 Sept 1986

Signed (Witness)

Name (of witness)

MRS. F.C. 2624

Address

3 MIDDLBROOK NEWARK NOTTS

Occupation

SOLICITOR

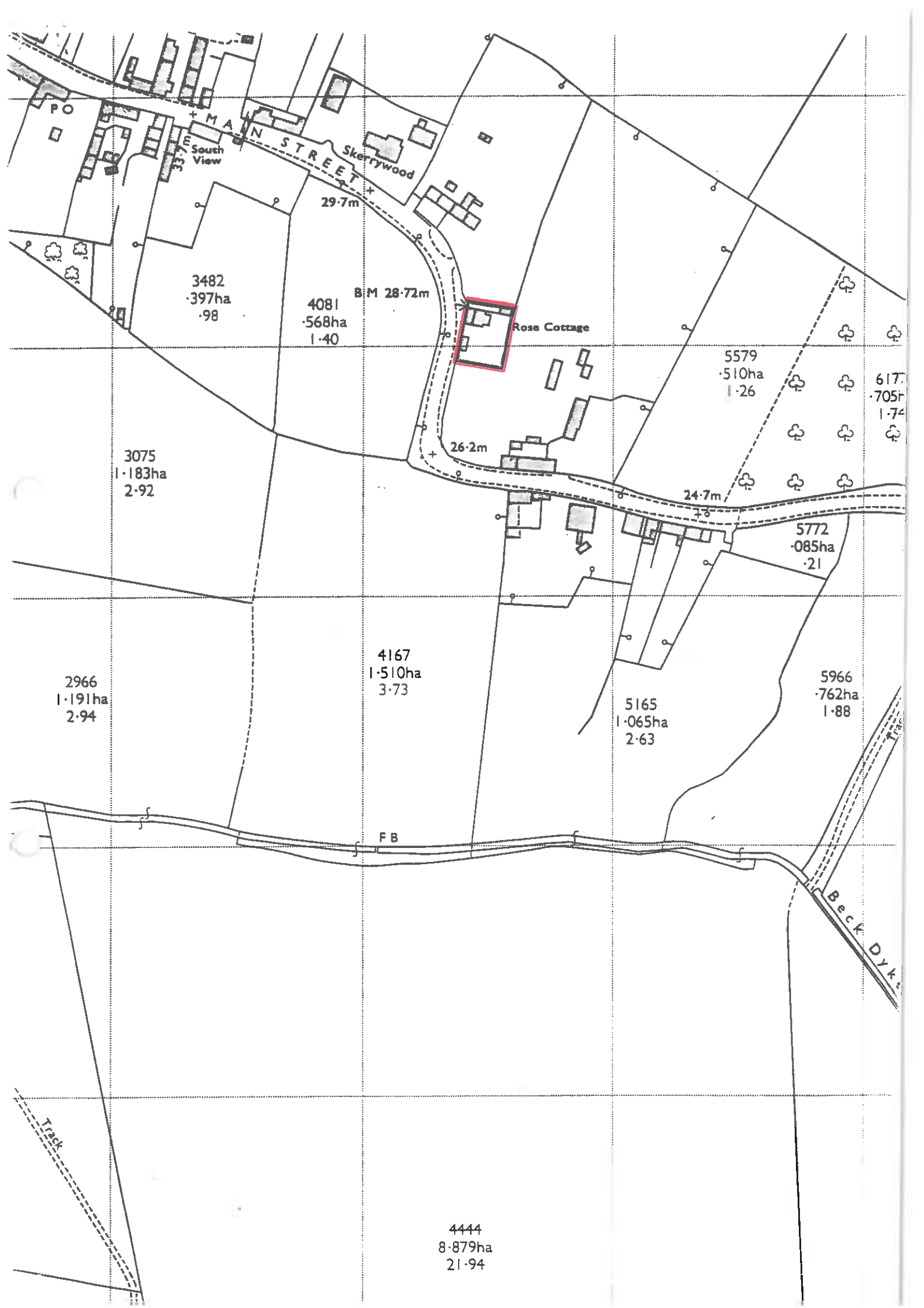

-
PTC.TH/AA13/1477M
Tim Hart
(0115) 977 4395
(0115) 977 2414
26 September 1996

Mr G W Peters
Rose Cottage
Main Street
Flintham
Notts
NG23 5LA

1st Class

Dear Mr Peters

**NOTTINGHAMSHIRE COUNTY COUNCIL
DEPOSIT OF STATEMENT AND PLAN AND STATUTORY
DECLARATION - SECTION 31(6) OF THE HIGHWAYS ACT 1980
PARISH : FLINTHAM
NAME OF LANDOWNER: GEOFFREY WILLIAM PETERS
NAME OF PROPERTY : ROSE COTTAGE, FLINTHAM**

I wish to acknowledge the receipt of your deposited Statement and Plan and Statutory Declaration on 25 September 1996.

The information contained in the Declaration will be held by this Authority as validation for the contents of the Statement and Plan. It will be necessary for you or your successors to renew the Statutory Declaration every six years, commencing from the date of the initial deposit of the Statement and Plan.

Any changes to your land holding or to the rights of way information in your initial Statement and Plan should be notified to the Rights of Way section, and should also be identified within a new Statutory Declaration covering a modified Statement and Plan.

Yours sincerely

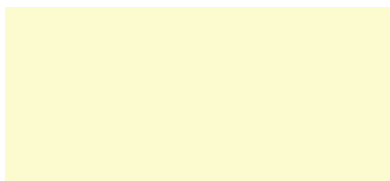

for Group Manager (Countryside)

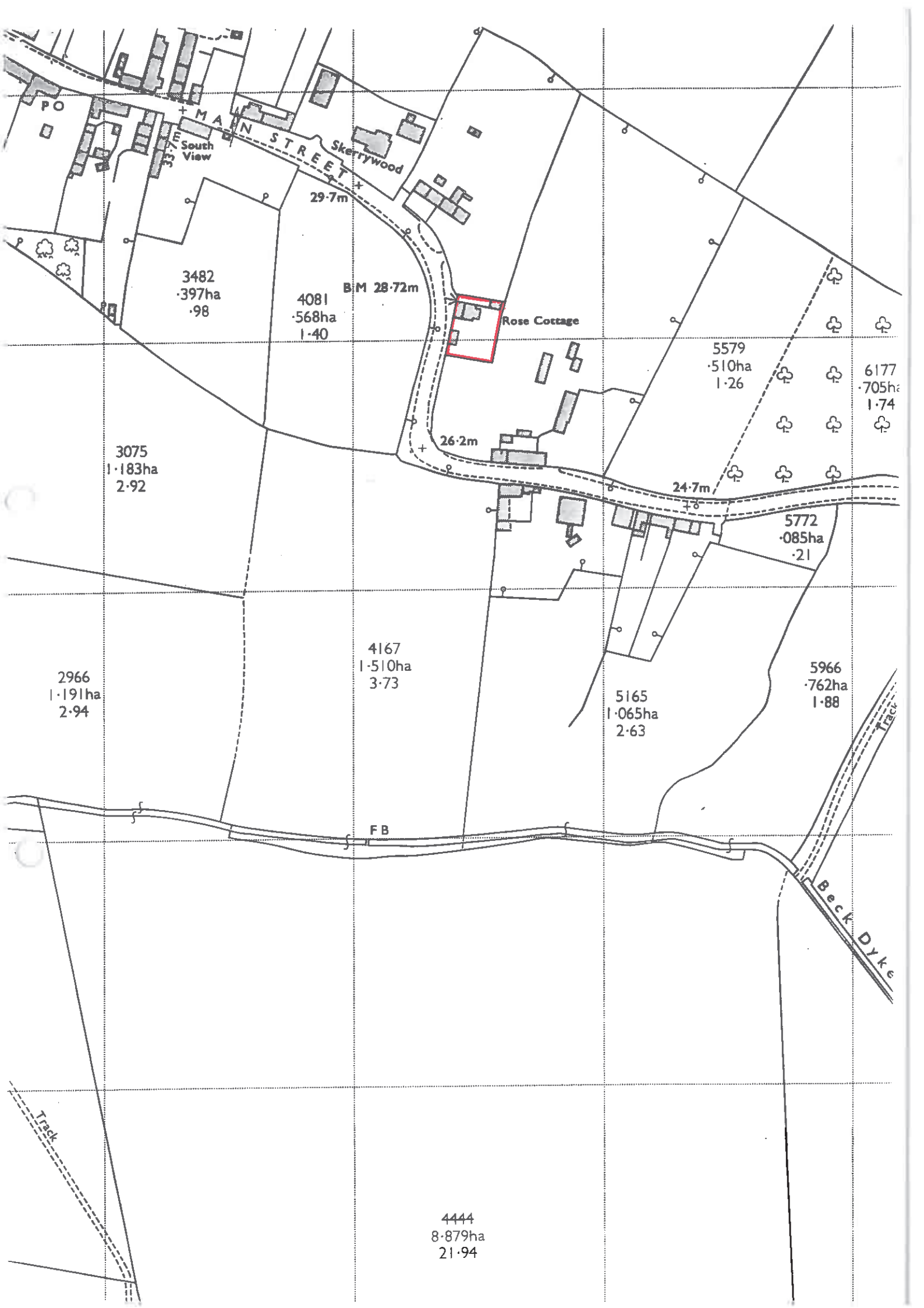

NOTTINGHAMSHIRE COUNTY COUNCIL

DEPOSIT OF STATEMENT AND PLAN

SECTION 31 (6) OF THE HIGHWAYS ACT 1980

To

1. I am and have been since 29 OCTOBER 1987 the owner within the meaning of the [day, month, year] above section of the land known as ROSE COTTAGE, FLINTHAM more particularly delineated [Name of Farm, etc] on the attached plan accompanying this statement and thereon edged red.
2. The aforementioned land lies in the Parishes/Communities of [FLINTHAM] and [.....].
- * 3. ~~The ways coloured orange on the said plan appear on the Definitive Map as BYWAYS OPEN TO ALL TRAFFIC (B.O.A.T.s).~~
- * 4. ~~The ways coloured by orange dashes on the said plan have been dedicated as BYWAYS OPEN TO ALL TRAFFIC (B.O.A.T.s).~~
- * 5. ~~The ways coloured by brown dashes on the said plan appear on the Definitive Map as ROADS USED AS PUBLIC PATHS (R.U.P.P.s).~~
- * 6. ~~The ways coloured green on the said plan appear on the Definitive Map as BRIDLEWAYS.~~
- * 7. ~~The ways coloured by green dashes on the said plan have been dedicated as BRIDLEWAYS.~~
- * 8. ~~The ways coloured purple on the said plan appear on the Definitive Map as FOOTPATHS.~~
- * 9. ~~The ways coloured by purple dashes on the said plan have been dedicated as FOOTPATHS.~~
- * 10. No other ways over the land have been dedicated as highways.
- * 11. The deposit shall comprise this statement and accompanying plan.

* Delete as applicable.

Signed (landowner)

Name (or landowner) GEOFFREY WILLIAM PETERS

Address ROSE COTTAGE,
MAIN STREET,
FLINTHAM, NEWARK, NOTTS NG23 5LA

Date 24-9-96

Signed (Witness)

Name (of witness)

Address

Mrs. F.C. KELLY
3 MIDDLGATE NEWARK NOTTS

Occupation

SOLICITOR

NOTTINGHAMSHIRE COUNTY COUNCIL

STATUTORY DECLARATION

SECTION 31 (6) OF THE HIGHWAYS ACT 1980

GEOFFREY WILLIAM

I PETERS DO SOLEMNLY AND SINCERELY DECLARE as follows:
[Full Name]

1. I am and have been since 29 OCTOBER 1987 the owner of the land known as ROSE COTTAGE,
FLINTHAM more particularly delineated on the plan accompanying this declaration
[name of farm, etc]
and thereon edged red.
2. On the 25th day of SEPTEMBER 1996 I GEOFFREY WILLIAM PETERS deposited with
[month][year] [Full Name]
Nottinghamshire County Council, being the appropriate Council, a statement accompanied by
a plan delineating my property by red edging which stated that ~~*[the ways coloured orange on
the said plan and on the plan accompanying this declaration are definitive or dedicated
BYWAYS OPEN TO ALL TRAFFIC (B.O.A.T.s)]~~ ~~*[the ways indicated by brown dashes on the
said plan and on the plan accompanying this declaration are definitive ROADS USED AS
PUBLIC PATHS (R.U.P.P.s)]~~ ~~*[the ways coloured green on the said plan and on the plan
accompanying this declaration are definitive or dedicated as BRIDLEWAYS]~~ ~~*[the ways
coloured purple on the said plan and on the plan accompanying this declaration are definitive
or dedicated FOOTPATHS]~~ ~~*[There are no definitive or dedicated Rights of Way over my
property.]~~
3. With reference to 2 above, I GEOFFREY WILLIAM PETERS confirm that there are no additional public
[Full name]
ways over the land edged red on the Plan and in the Statement dated 24.9.96
[day, month, year]
(other than those definitive routes coloured yellow and those dedicated routes coloured by
yellow dashes and marked *(byway) *(bridleway) *(footpath) on the Plan accompanying this
Declaration).

* Delete as appropriate.

AND I MAKE this solemn declaration of the 24 day of Sept 1996 conscientiously
[Month, Year]
believing it to be true and by virtue of the Statutory Declarations Act 1835.

Declared at [address] 3 Middleport Way
Nottingham

[signature of landowner]

Before me

[Commissioner of Oaths or a Justice of the Peace or Solicitor]