

Nottinghamshire
County Council



PLANNING AND
TRANSPORTATION DEPT.



7518

Date 23-1-1991

Letter from: -

YOUNG & PEARCE

No. 403398

PSC

Subject: -

ROBIE FARRIS, FISKEZON LGA
417 - THOMAS LONG & SONS LTD.

P. J.R.

Special Instructions: -

Reference: -

43

SEEN/NOT SEEN
BY DIRECTOR
SEEN/NOT SEEN
BY A/DIRECTOR

Original folder to C. White, C.A. 24.1.91.

Action Taken: -

Replied by letter 24.1.91.

NOTE: - This slip is to remain attached to the letter until it is dealt with
F (not merely acknowledged) and passed for filing.
No. B42.

Initials



on passing for filing
NCC/P&T/0333/5.82

V403398

Young & Pearce

Solicitors

P. RCG/SAF/43/FISKERTON

Your Ref:

Our Ref: JG/FJB/L041031

Director of Planning &
Transportation,
Notts. County Council,
Trent Bridge House,
Fox Road,
West Bridgford, Nottingham.

1 Talbot Street, Nottingham NG1 5GQ
Tel: (0602) 417451 MDX 10,025
Fax: (0602) 475572

ALSO AT 9 Main Street, Keyworth, Nottingham
NG12 5AA

John A Pearce Alison Playle U.B.
Paul S King U.B. Tony P Wilkinson U.B.
John J V Gossage U.B., M.Phil.
Associate: Carol A Pritchard B.A.

Regulated by the Law Society in the Conduct of
Investment Business

22 January 1991

Dear Sirs,

PUBLIC FOOTPATHS, FISKERTON 16A AND 17 - THOMAS LONG AND SONS LTD.

Thank you for your letter of 11th December 1990. We now formally lodge with you a Statutory Declaration dated 22nd January 1991 sworn by Mr. R. I. Radford which such Declaration is deposited with you further to the map and statement deposited on 21st August 1990. Would you kindly acknowledge receipt.

Yours faithfully

ENC.

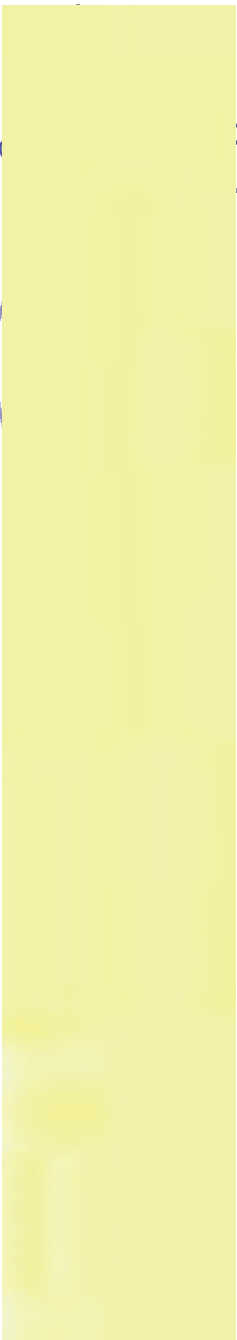

I Roger Inger Radford of The Burrows Cragmoor Road Burton Joyce Nottinghamshire do solemnly and sincerely declare as follows:-

1. I am a director of Thomas Long and Sons Limited ("the Company")

[REDACTED] On the ^{21ST} ^{August} 1990 the Company deposited a map of its [REDACTED] and at Fiskerton Nottinghamshire with Nottinghamshire County Council together with a statement denying that any ways over that land had been dedicated to the public other than as shown thereon

3. Since such deposit and statement no ways have been dedicated by the Company for the use of the public as highways

AND I make this solemn declaration conscientiously believing the same to be true and by virtue of the Statutory Declarations Act 1835

SWORN at *Colwick Rowers Park*

this *22nd* day of *January* 1991, before me,

[Signature]
A Solicitor/Commissioner for ~~Orders~~

V409938

Young & Pearce

Solicitors

1 Talbot Street, Nottingham NG1 5GQ
Tel: (0602) 417451 MDX 10,025
Fax: (0602) 475572

ALSO AT 9 Main Street, Keyworth, Nottingham
Tel: (06077) 4671 NG12 5AA

Fax [redacted]
JA [redacted] 3.
JJ [redacted] 3.
Re [redacted] 3.
of [redacted] it

Your Ref: P. CEL/LB27/FISKERTON/43

Our Ref: JG/FJB/L041031

Notts. County Council,
Dept. Planning & Transportation,
Trent Bridge House,
Fox Road,
West Bridgford, Nottingham.

20 August 1990

Dear Sirs,

PUBLIC FOOTPATHS, FISKERTON 16A AND 17

Thank you for your letter of 15th August.

On behalf of Thomas Long & Sons Ltd., we hereby deposit with you a Notice under Section 31(6) of the Highways Act 1980. Would you be kind enough to acknowledge receipt.

We will deposit a Statutory Declaration shortly under the same sub-section.

Yours faithfully,

[redacted signature block]

ENC



07071:1

Highways Act 1980

Notice Accompanying a Map Deposited under Section 31(6)

Nottinghamshire County Council
County Hall
West Bridgford
Nottingham

Thomas Long and Sons Limited whose registered office is at Colwick Business Park Colwick Industrial Estate Nottingham hereby declares that no ways over the land shown edged orange on the accompanying map deposited by it with the above mentioned Council (other than those shown coloured blue on the said map) are admitted by it as having been dedicated as highways

Dated this 13th July 1990

....
Dire

Young & Pearce

Solicitors

P. CEL/LB27/FISKERTON/43

Your Ref:

Our Ref: JG/FJB/L041031

Notts. County Council,
Dept. Planning & Transportation,
Trent Bridge House,
Fox Road,
West Bridgford, Nottingham.

1 Talbot Street, Nottingham NG1 5GQ
Tel: (0602) 417451 MDX 10,025
Fax: (0602) 475572

ALSO AT 9 Main Street, Keyworth, Nottingham
Tel: (06077) 4671 NG12 5AA
Fax: (06077) 6479

J A Pearce P S King L.B.
J J V Gossage LL.B., M.Phil. A Playle LL.B.
Regulated by the Law Society in the Conduct
of Investment Business.

20 August 1990

Dear Sirs,

PUBLIC FOOTPATHS, FISKERTON 16A AND 17

Thank you for your letter of 15th August.

On behalf of Thomas Long & Sons Ltd., we hereby deposit with you a Notice under Section 31(6) of the Highways Act 1980. Would you be kind enough to acknowledge receipt.

We will deposit a Statutory Declaration shortly under the same sub-section.

Yours faithfully,

ENC.



V409938
⑥

D.07071.1

Highways Act 1980

Notice Accompanying a Map Deposited under Section 31(6)

To: Nottinghamshire County Council
County Hall
West Bridgford
Nottingham

Thomas Long and Sons Limited whose registered office is at Colwick Business Park Colwick Industrial Estate Nottingham hereby declares that no ways over the land shown edged orange on the accompanying map deposited by it with the above mentioned Council (other than those shown coloured blue on the said map) are admitted by it as having been dedicated as highways

Dated this 13th July 1990

.....
Director, for Thomas Long and Sons Limited

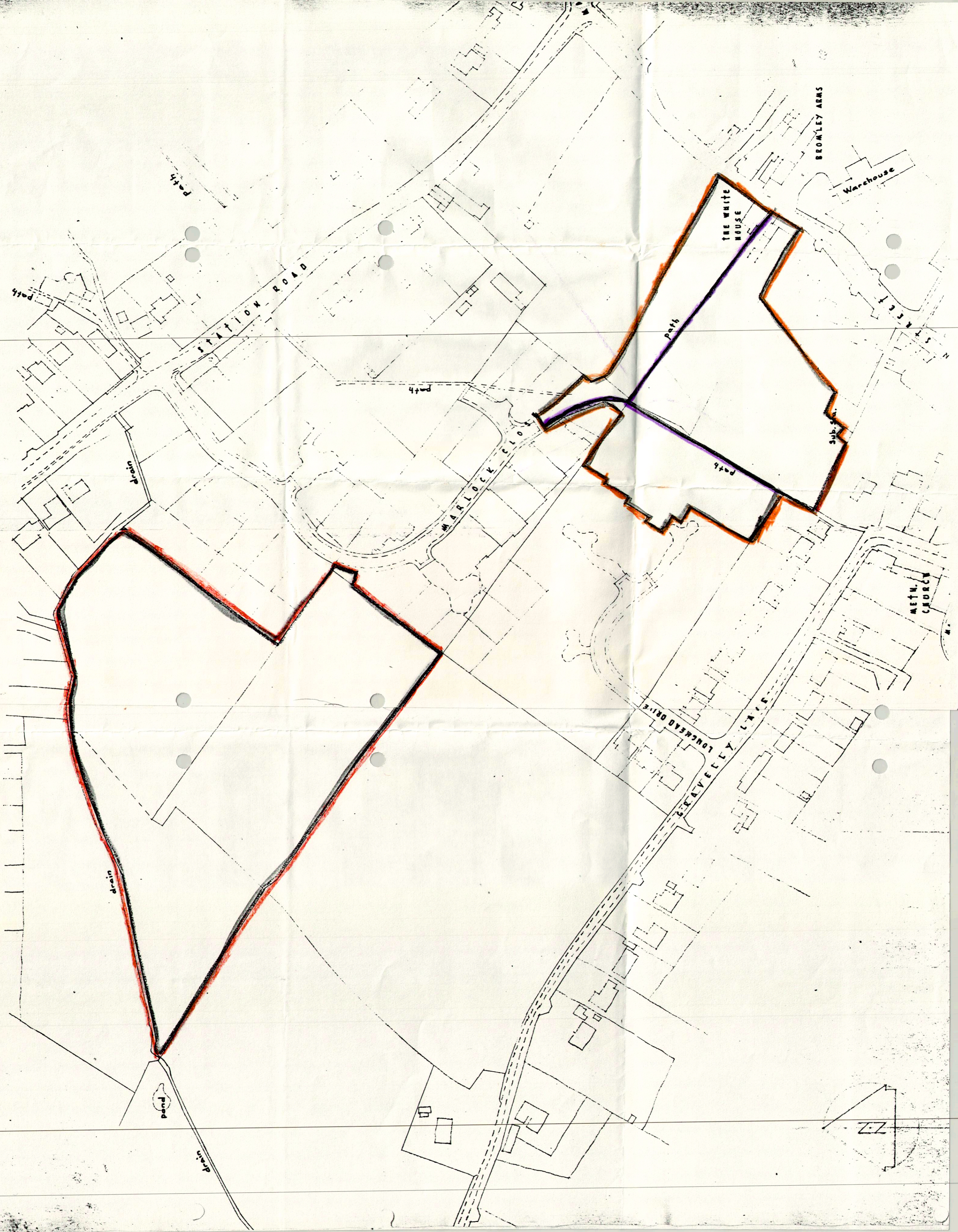



NOTE:
 THIS DRAWING TO BE USED FOR IDENTIFICATION PURPOSES ONLY. ALL SITE BOUNDARY DIMENSIONS SHD TO BE CHECKED ON SITE

THOMAS ESTD 1878
LONG & SONS LTD
 NOTTINGHAM

BUILDERS & CONTRACTORS
 COLWICK BUSINESS PARK
 PRIVATE ROAD No. 2
 COLWICK
 NOTTINGHAM NG4 2JR
 Telephone: (0602) 618888

CLIENT: THOMAS LONG & SONS LTD.

TITLE: LAND AT FISKEPTON

SCALE: 1 : 1250
 DATE: APRIL 90
 REVISIONS: A, MAY 90

THIS DESIGN AND PRINT WAS MADE BY THOMAS LONG & SONS LTD WHO RETAIN THE PROPERTY AND COPYRIGHT IN IT.

DRAWING NUMBER: T1S/FIS/1 (A)