

NOTTINGHAMSHIRE COUNTY COUNCIL

STATUTORY DECLARATION

SECTION 31 (6) OF THE HIGHWAYS ACT 1980

*Peter Frank Olko*... DO SOLEMNLY AND SINCERELY DECLARE as follows:  
[Full Name]

1. I am and have been since *12<sup>th</sup> May, 1983* the owner of the land known as *Fiscallon*  
[day, month, year]  
*car park* more particularly delineated on the plan accompanying this declaration  
[name of farm, etc]  
and thereon edged red.

2. On the *9<sup>th</sup>* day of *September 2002*, *Peter Frank Olko* deposited with  
[month][year] [Full Name]  
Nottinghamshire County Council, being the appropriate Council, a statement accompanied by a  
plan delineating my property by red edging which stated that ~~\*[the ways coloured orange on the  
said plan and on the plan accompanying this declaration are definitive or dedicated BYWAYS  
OPEN TO ALL TRAFFIC (B.O.A.T.s)]~~ ~~\*[the ways indicated by brown dashes on the said plan  
and on the plan accompanying this declaration are definitive ROADS USED AS PUBLIC  
PATHS (R.U.P.P.s)]~~ ~~\*[the ways coloured green on the said plan and on the plan accompanying  
this declaration are definitive or dedicated as BRIDLEWAYS]~~ ~~\*[the ways coloured purple on the  
said plan and on the plan accompanying this declaration are definitive or dedicated  
FOOTPATHS]~~ ~~\*[There are no definitive or dedicated Rights of Way over my property.]~~

3. With reference to 2 above, I *Peter Frank Olko* confirm that there are no additional public  
[Full name]  
ways over the land edged red on the Plan and in the Statement dated *9<sup>th</sup> September 2002*  
[day, month, year]  
(other than those definitive routes coloured yellow and those dedicated routes coloured by  
yellow dashes and marked \*(byway) \*(bridleway) \*(footpath) on the Plan accompanying this  
Declaration).

\* Delete as appropriate.

AND I MAKE this solemn declaration of the *9<sup>th</sup>* day of *September 2002* conscientiously  
[Month, Year]  
believing it to be true and by virtue of the Statutory Declarations Act 1835.

**Masser & Co.**  
Russell House, Tudor Square  
West Bridgford, Nottingham NG2 6BT  
DX 719902 WEST BRIDGFORD  
Telephone: 0115 912 6666

Declared at [address]

[signature of landowner]

Before me

[Commissioner of Oaths or a Justice of the Peace or Solicitor]

**Tim J D Brooke**  
Solicitor  
Nottingham

DEPOSIT OF STATEMENT AND PLAN

SECTION 31 (6) OF THE HIGHWAYS ACT 1980

To

1. I am and have been since 1<sup>st</sup> May 1983 the owner within the meaning of the above section of the land known as ROUSSTON CR PARK more particularly delineated [Name of Farm, etc] on the attached plan accompanying this statement and thereon edged red.
2. The aforementioned land lies in the Parishes/Communities of [ROUSSTON].
- \* 3. ~~The ways coloured orange on the said plan appear on the Definitive Map as BYWAYS OPEN TO ALL TRAFFIC (B.O.A.T.s).~~
- \* 4. ~~The ways coloured by orange dashes on the said plan have been dedicated as BYWAYS OPEN TO ALL TRAFFIC (B.O.A.T.s).~~
- \* 5. ~~The ways coloured by brown dashes on the said plan appear on the Definitive Map as ROADS USED AS PUBLIC PATHS (R.U.P.P.s).~~
- \* 6. ~~The ways coloured green on the said plan appear on the Definitive Map as BRIDLEWAYS.~~
- \* 7. ~~The ways coloured by green dashes on the said plan have been dedicated as BRIDLEWAYS.~~
- \* 8. The ways coloured purple on the said plan appear on the Definitive Map as FOOTPATHS.
- \* 9. ~~The ways coloured by purple dashes on the said plan have been dedicated as FOOTPATHS.~~
- \* 10. No other ways over the land have been dedicated as highways.
- \* 11. The deposit shall comprise this statement and accompanying plan.
- \* ~~Delete as applicable.~~

Signed (landowner) 

Name (or landowner) P. F. OLKO

Address 63, FOREST ROAD  
ANNESLEY WOOD HOUSE, NOTTS, NR17 9HA

Date 9<sup>th</sup> SEPTEMBER 2002

Signed (Witness) 

Name (of witness) 

Address **Masser & Co.**  
Russell House, Tudor Square  
West Bridgford, Nottingham NG2 6BT  
Occupation **DX 719902 WEST BRIDGFORD**  
**Telephone: 0115 912 6666**

**Tim J D Brooke**  
Solicitor  
Nottingham

-  
EPE.AT/JM1/South Muskham  
Mr A Trundle  
(0115) 977 4961  
(0115) 977 2414  
11 September 2002

63 Forest Road  
Annesley Woodhouse  
Nottinghamshire  
NG17 9HA

For the attention of Peter Frank Olko

Dear Sir

**NOTTINGHAMSHIRE COUNTY COUNCIL  
DEPOSIT OF STATEMENT AND PLAN AND STATUTORY DECLARATION  
SECTION 31(6) OF THE HIGHWAYS ACT 1980**

**PARISH:** South Muskham, Rolleston, Fiskerton, Kelham  
**NAME OF LANDOWNER:** Peter Frank Olko (of the Nottingham Piscatorial Society)  
**NAME OF PROPERTY:** South Muskham Lake, Fiskerton Car Park, Teals Wharf,  
FirTree Corner Fishery

I wish to acknowledge the receipt of your deposited Statements and Plans and Statutory Declarations dated 9 September 2002.

The information contained in the Declaration will be held by this Authority as validation for the contents of the Statement and Plan. It will be necessary for you or your successor to renew the Statutory Declaration every six years, commencing from the date of the initial Statutory Declaration.

Any changes to your landholding or to the rights of way information in your initial Statement and Plan should be notified to the Rights of Way Section, and should also be identified with a new Statutory Declaration covering a modified Statement and Plan.

Yours faithfully

A

Angus Trundle  
Definitive Map Officer

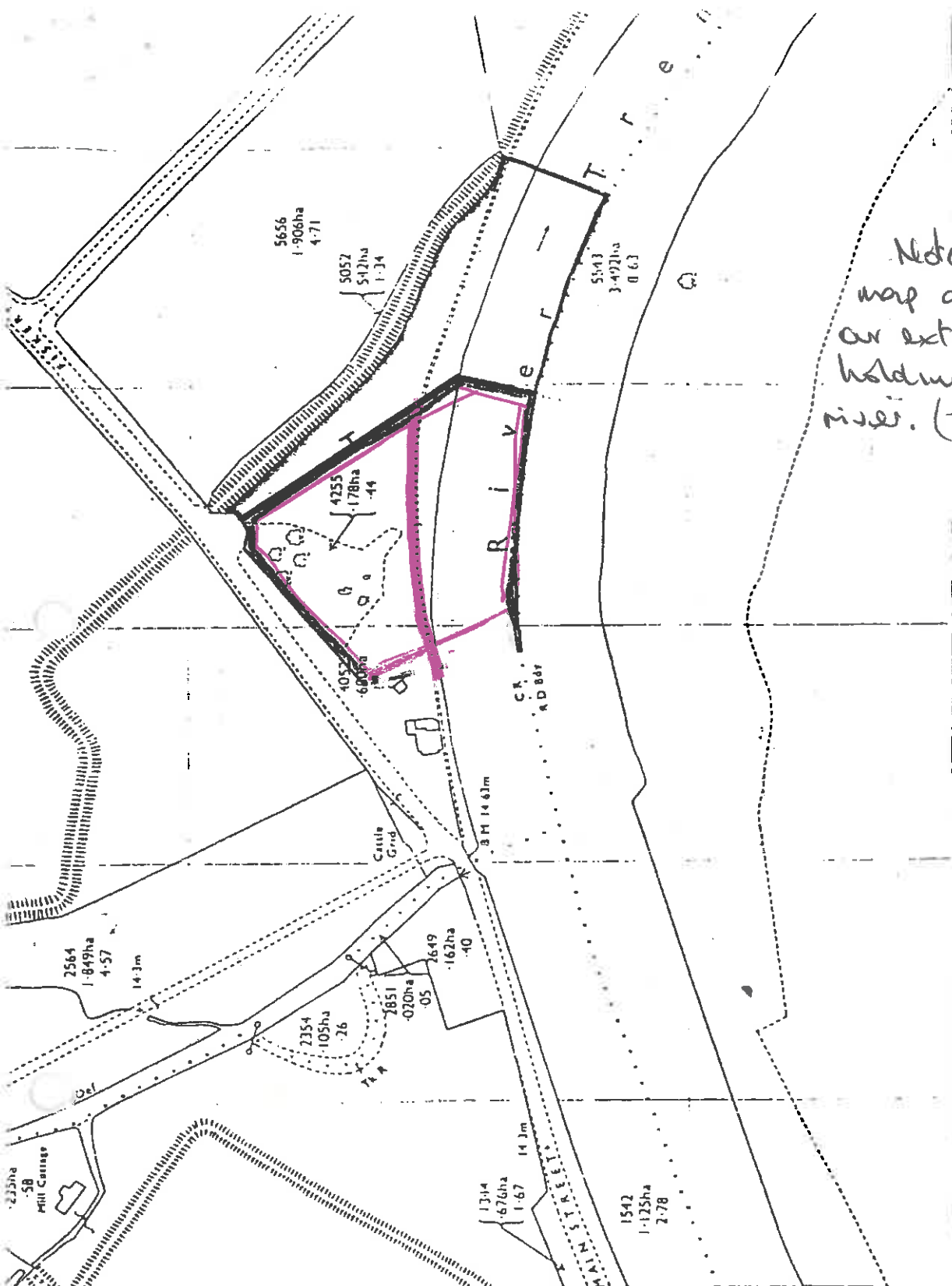

Note, this map also shows our extent of land holding under the river. (up to 1/2 way)

Produced from the Ordnance Survey map with the sanction of the Controller of H.M. Stationery Office. Crown copyright reserved.  
FOR IDENTIFICATION PURPOSES ONLY

Kerton Road,

Scale 1/2500 Approx



NORTH

**WALKER  
WALTON  
HANSON**



5 BAYARD LANE  
BRIDLESMITH GATE  
NOTTINGHAM  
TEL. 10821 1477

CHARTERED SURVEYORS