

This matter is being dealt with by:  
**Eddie Brennan**  
Your Reference: PB/JW/7478  
My Reference: EB/130325/Mossopbowser  
T 0115 977 4709  
E eddie.brennan@nottscc.gov.uk  
W nottinghamshire.gov.uk



**Nottinghamshire  
County Council**

*Everton*

Mossop & Bowser Solicitors  
Abbots Manor  
10 Spalding Road  
Holbeach  
Lincolnshire PE12 7LP

25 March 2013

Dear Sir

**NOTTINGHAMSHIRE COUNTY COUNCIL: DEPOSIT OF STATEMENT PLAN AND  
STATUTORY DECLARATION - SECTION 31(6) HIGHWAYS ACT 1980  
PARISHES: MISSON, EVERTON, MISTERTON, GRINGLEY ON THE HILL  
NAME OF LANDOWNER: LOVEDEN ESTATES  
NAME OF PROPERTY: VARIOUS**

I wish to acknowledge the receipt, on the 18 March 2013, the various Statutory Declarations listed below;

1. Old Bombing Ground and Washland, Misson
2. Woodland at Green Lane, Everton
3. Gibdyke Farm, Misson
4. Norwood House, Misson
5. Parts of Bullhassocks and Charity Farm Westwoodside, Misson
6. Land to the south of the River Idle at Everton, Misterton and Gringley
7. Land lying to the south of the River Idle, Everton (Statement and Statutory Declaration)

The information contained in the Declarations will be held by this Authority as validation for the contents of the statements and plans. It will be necessary for you or your successors to renew the Statutory Declarations every ten years.

Any changes to your land holdings or the rights of way information in your initial Statements and Plans should be notified to the Countryside Access Section, and should also be identified with new Statutory Declarations covering modified Statements and Plans.

Yours sincerely

Eddie Brennan  
Definitive Map Officer  
Nottinghamshire County Council

Nottinghamshire County Council, County Hall, West Bridgford, Nottingham NG2 7QP

Everton

**MOSSOP & BOWSER**  
**SOLICITORS**

Abbots Manor, 10 Spalding Road,  
Holbeach, Lincs. PE12 7LP  
DX 29522 Holbeach

Telephone: (01406) 422651 (Switchboard)  
(01406) 421202 (Direct Line)  
Fax: (01406) 425177

E-Mail: [pbrown@mossops.co.uk](mailto:pbrown@mossops.co.uk)  
Website: [www.mossops.co.uk](http://www.mossops.co.uk)

Our ref: PB/JW/7478

Your ref:

Date: 13 March, 2013

Eddie Brown

The Rights of Way Officer  
Nottinghamshire County Council  
DX 723420  
WEST BRIDGFORD 2

Trent Bridge House

RECEIVED  
18 MAR 2013  
BY:

Dear Sir

**Loveden Estates Limited (formerly Loveden Holdings Limited)**  
**Section 31(6) Highways Act 1980**

We refer to six deposits and supporting Statutory Declarations relating to the following parcels of land:

1. Old Bombing Ground and Washland Misson Nottinghamshire.
2. Woodland at Green Lane Everton Nottinghamshire.
3. Gibdyke Farm Misson Nottinghamshire (the earlier Declaration has been amended in order to refer to the restricted by-way on the Plan NDSB2).
4. Norwood House Misson Nottinghamshire.
5. Parts of Bullhassocks & Charity Farm Westwoodside Nottinghamshire.
6. Land to the south of the River Idle at Everton Misteron and Gringley Nottinghamshire.

As the 10 year period covered by the original Statutory Declarations will soon expire please find enclosed six new Statutory Declarations each dated 4 March 2013.

We shall be grateful if you will acknowledge safe receipt.

Yours faithfully,

[Redacted signature]

LEGAL SERVICES  
CHIEF EXECUTIVE'S DEPARTMENT

15 MAR 2013



And at Long Sutton (01406) 363212  
Authorised and Regulated by the Solicitors Regulation Authority  
SRA Number 52592  
ESTABLISHED IN 1826

Partners: G.J.Wakefield B.A. R.M.Hill M.A. (Oxon) J.P.Veasey LL.B, B.Sc. Consultant: P.F.S.Brown LL.B, TEP

SERVICE OF DOCUMENTS NOT ACCEPTED BY EMAIL OR FAX

2

**STATUTORY DECLARATION HIGHWAYS ACT 1980 S.31(6)**

**I NIGEL DENIS SPENCE BROWN** of The Old Rectory Fulbeck Grantham Lincolnshire NG32 3JS **DO SOLEMNLY AND SINCERELY DECLARE** as follows:

1. Loveden Estates Ltd (CRN: 894965) (formerly Loveden Holdings Ltd) is and has been since 18 July 1994 the owner of the land known as land to the south of the River Idle at Everton Misterton and Gringley Nottinghamshire more particularly delineated on the plan accompanying this declaration and thereon edged red.
2. On 29 January 2004 Loveden Estates Ltd deposited with Nottinghamshire County Council, being the appropriate council, a statement accompanied by a plan delineating its property by red edging which stated that that the ways shown by green line on the plan accompanying this declaration and lettered A-B, C-D, D-E and F-G respectively appear on the definitive map as public paths 1 (part) 4 (part) 7A and 18 (part) respectively and that no other ways over the land had been dedicated as highways
3. On or about 29 January 2004 I deposited with Nottinghamshire County Council, a statutory declaration dated 29 January 2004 stating that no additional ways had been dedicated since the deposit of the statement referred to in 2 above.
4. No additional ways have been dedicated over the land edged red on the plan accompanying this declaration since the date of the statutory declaration referred to in 3 above and at the present time Loveden Estates Ltd has no intention of dedicating any more public rights of way over its property.

**AND I MAKE** this solemn declaration conscientiously believing it to be true and by virtue of the Statutory Declarations Act 1835.

Declared at  
this  
2013

*J. C. Woolley*  
*Hollwell Lincolnshire*  
4<sup>th</sup> day of *MARCH*

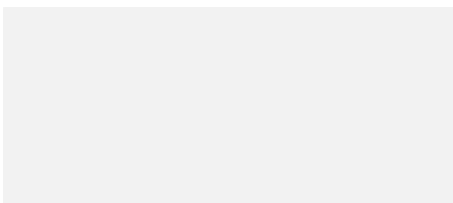

Before me,

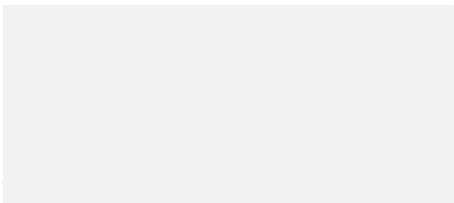

**J. C. Woolley**  
**Solicitor**

.....  
~~Solicitor/Commissioner for Oaths~~

This is the plan referred to in the Statutory Declaration of Nigel Denis Spence Brown declared before me this 14<sup>th</sup> day of MARCH 2013  
Solicitor  
J. C. Woolley  
Solicitor

H.M. LAND REGISTRY  
TITLE NUMBER  
**NT 297 498**  
ORDNANCE SURVEY PLAN REFERENCE  
COUNTY NOTTINGHAMSHIRE DISTRICT BASSETLAW  
Scale 1:6000  
© Crown copyright 1997

This official copy based on 2/12/13, shows the state of this title plan on 1/12/12 at 4/16.57. It is submitted in evidence to the court under the Land Registration Act 2002. This plan shows the general measurements between the same points on the ground. See Land Registry Hand Guide for further information. © Crown Copyright. Produced by Land Registry. Reproduction in whole or part is prohibited without the prior written permission of Ordnance Survey. Licence number 100021612.

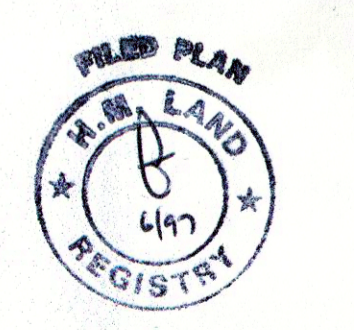
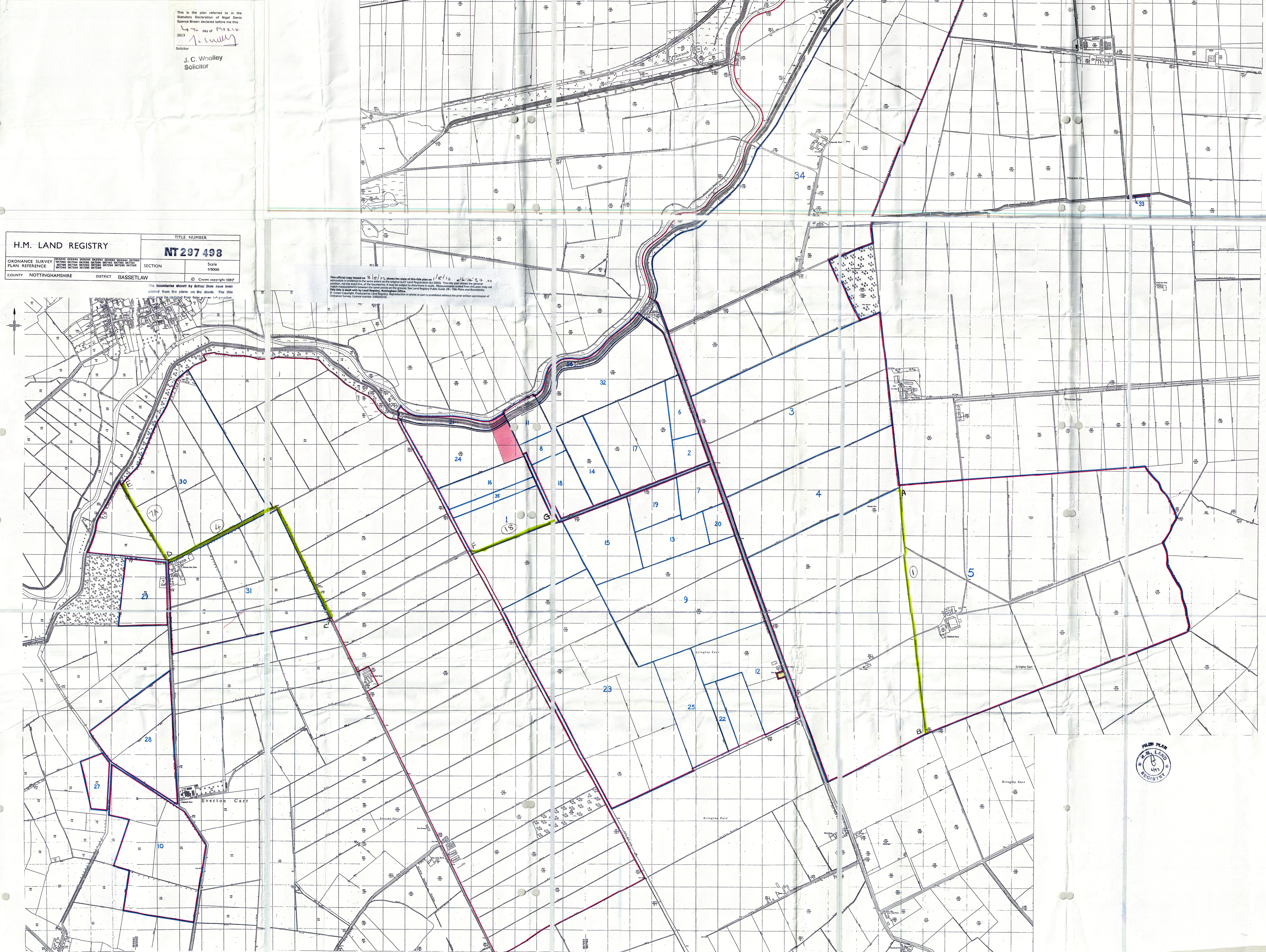

H.M. LAND REGISTRY

This is the exhibit marked "NDSB1" referred to in the Statutory Declaration of Nigel Denis Spence Brown declared before me this day of 20/02/2012

ORDNANCE SURVEY PLAN REFERENCE  
COUNTY NOTTINGHAMSHIRE DISTRICT BASSETLAW

© Crown copyright 1997

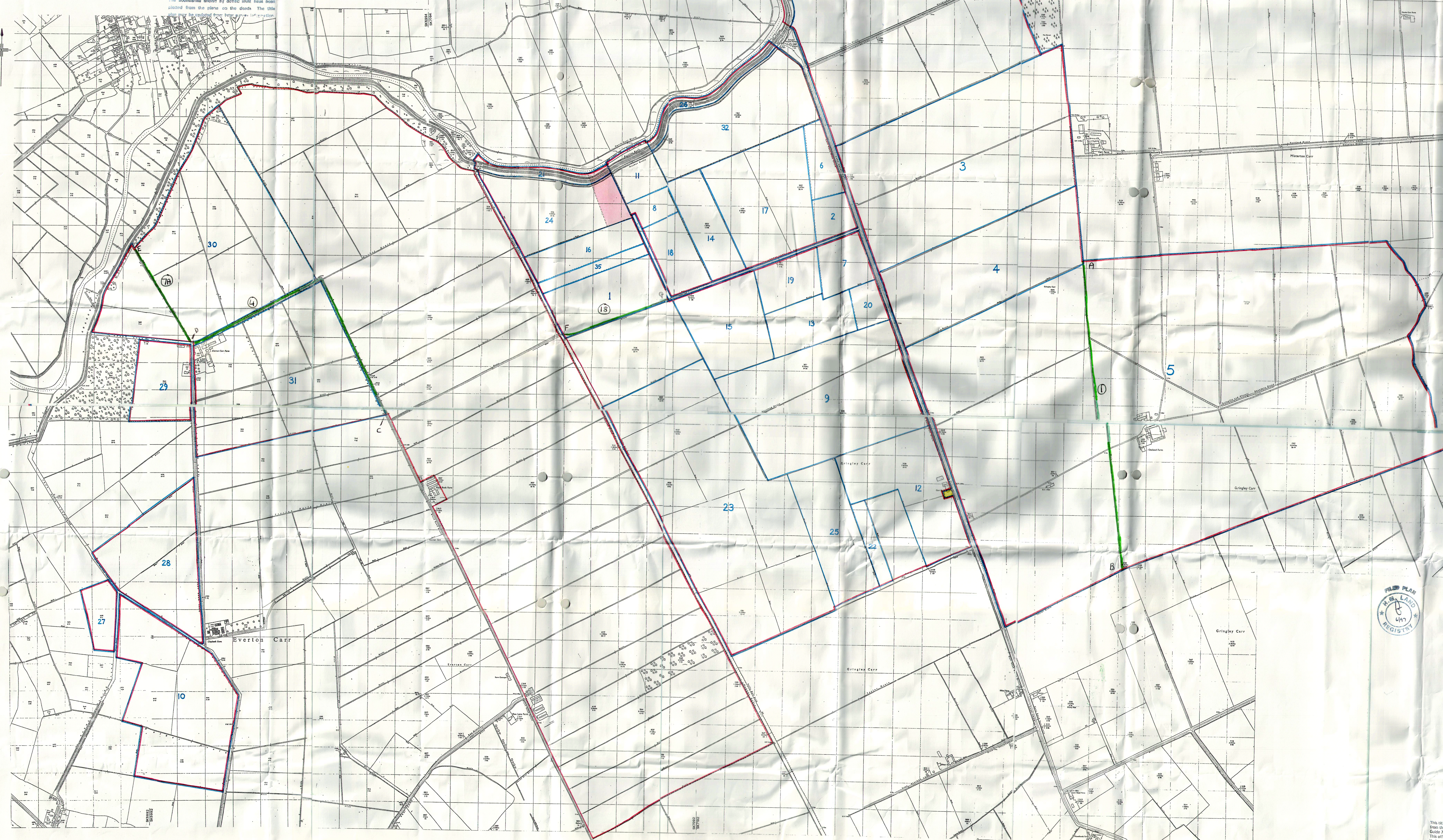
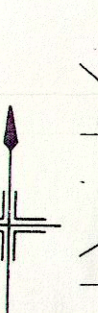

This title plan shows the general position of the boundaries: it does not show the exact line of the boundaries. Measurements scaled from this plan may not match measurements between the same points on the ground. For more information see Land Registry Public Guide 7 - Title Plans.  
This official copy shows the state of the title plan on 27/04/2012 11:00. It may be subject to alterations in scale based on the Land Registration Act 2002. This copy is admissible in evidence to the same extent as the original.  
This title is dealt with by Nottingham City Council.