

PSP.TH/1477M/28lthrh11  
(0115) 977 4395  
tim.hart@nottscc.gov.uk  
28 April 2011

Ms S. Santos  
Eastwood Farm  
Hagg Lane  
Epperstone  
Notts  
NG14 6AX

1st Class

Dear Madam

**NOTTINGHAMSHIRE COUNTY COUNCIL  
DEPOSIT OF STATEMENT AND PLAN AND STATUTORY DECLARATION-  
SECTION 31(6) OF THE HIGHWAYS ACT 1980  
PARISH: EPPERSTONE  
NAME OF LANDOWNER: SUSAN MARY SANTOS  
NAME OF PROPERTY: EASTWOOD FARM**

I wish to acknowledge the receipt of your deposited Statement and Plan and Statutory Declaration on 27 April 2011.

The information contained in the Declaration will be held by this Authority as validation for the contents of the Statement and Plan. It will be necessary for you or your successors to renew the Statutory Declaration every ten years, commencing from the date of the initial Statutory Declaration.

Any changes to your land holding or to the rights of way information in your initial Statement and Plan should be notified to the Rights of Way section, and should also be identified within a new Statutory Declaration covering a modified Statement and Plan.





Yours faithfully



Tim Hart  
Senior Definitive Map Officer

NOTTINGHAMSHIRE COUNTY COUNCIL  
STATUTORY DECLARATION  
SECTION 31 (6) OF THE HIGHWAYS ACT 1980

I SUSAN MARY SANTOS [Full Name] DO SOLEMNLY AND SINCERELY DECLARE as follows:

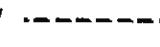
1. I am and have been since 3/4/1969 [day, month, year] the owner of the land known as EASTWOOD FARM [farm name, field no. etc] more particularly delineated on the plan accompanying this declaration and thereon edged red.
  
2. On the 27th day of April 2011 [month][year] I SUSAN MARY SANTOS [full name] deposited with Nottinghamshire County Council, being the appropriate Council, a statement accompanied by a plan delineating my property by red edging which stated that ~~\*[the ways shown coloured orange/  on the said plan and on the plan accompanying this declaration are definitive or dedicated BYWAYS OPEN TO ALL TRAFFIC (B.O.A.T.s)]~~ ~~\*[the ways shown coloured blue/  on the said plan and on the plan accompanying this declaration are definitive or dedicated RESTRICTED BYWAYS]~~ ~~\*[the ways shown by brown dashes/  on the said plan and on the plan accompanying this declaration are definitive ROADS USED AS PUBLIC PATHS (R.U.P.P.s)]~~ ~~\*[the ways shown coloured green/  on the said plan and on the plan accompanying this declaration are definitive or dedicated as BRIDLEWAYS]~~ ~~\*[the ways shown coloured purple/  on the said plan and on the plan accompanying this declaration are definitive or dedicated FOOTPATHS]~~ ~~\*[There are no definitive or dedicated Rights of Way over my property.]~~
  
3. With reference to 2 above, I SUSAN MARY SANTOS [full name] confirm that there are no additional public ways over the land edged red on the Plan and in the Statement dated 27/4/2011 [day, month, year] (other than those definitive routes and dedicated routes marked on the Plan accompanying this Declaration).

\* Delete as appropriate.

AND I MAKE this solemn declaration of the 27th day of April 2011 [month, year] conscientiously believing it to be true and by virtue of the Statutory Declarations Act 1835.



[Signature of landowner]

Declared at [address]

THE PENFOLD, CHOECH LANE, EPPERSTONE, NOTTS NG14 6RD

Before me



NICOLA WHITEHEAD JP

[Commissioner of Oaths or a Justice of the Peace or Solicitor] NOTTINGHAM BENCH

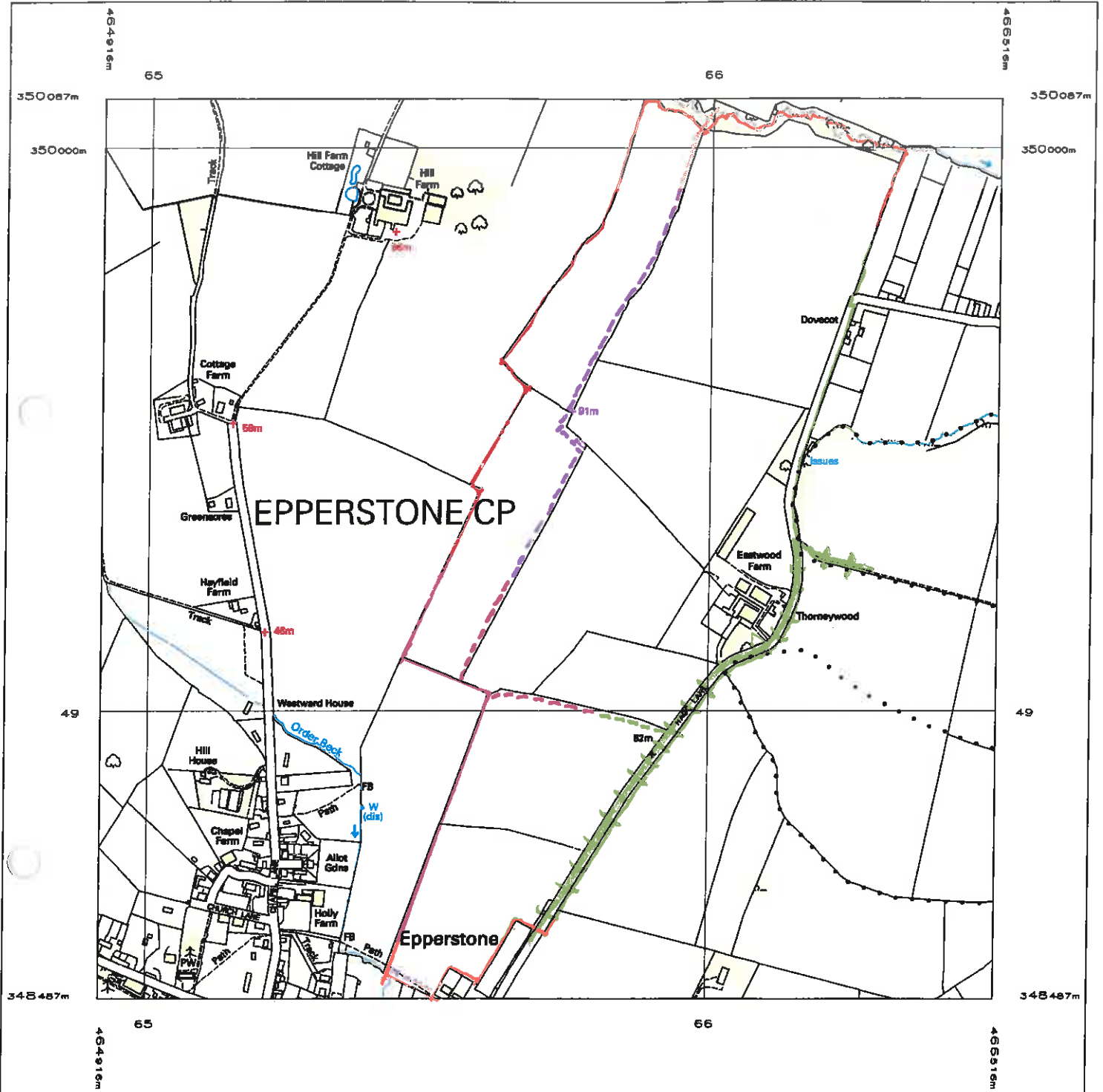

Plotted 28 Jan 2011 from Ordnance Survey digitally derived data.

Produced using significant survey information from Ordnance Survey large scales digital data, and incorporated into OS Landplan Feb 2009 - Aug 2010.

© Crown copyright 2011.

Reproduction in whole or in part is prohibited without the prior written permission of Ordnance Survey.

Administrative boundaries revised to May 2007 - May 2010.

Additional boundaries information:

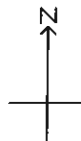

Heights are given in metres above Newlyn Datum. The representation of a road, track or path is no evidence of a right of way.

The alignment of tunnels is approximate.

An OS Landplan symbols leaflet is available on request from Ordnance Survey Mapping and Data Centres.

Ordnance Survey, the OS Symbol and OS Landplan are registered trade marks of Ordnance Survey, the national mapping agency of Great Britain.





Plot centre coordinates: 465716 349287

Supplied by: Maps

Plot serial number: 01176200

Scale 1:10000

**NOTTINGHAMSHIRE COUNTY COUNCIL**  
**DEPOSIT OF STATEMENT AND PLAN**  
**SECTION 31 (6) OF THE HIGHWAYS ACT 1980**

1. I am and have been since 8/4/69 [day, month, year] the owner within the meaning of the above section, of the land known as EASTWOOD FARM [farm name, field no. etc] more particularly delineated ..... on the attached plan accompanying this statement and thereon edged red.
2. The aforementioned land lies in the Parish(es)/Communities of EPPERSTONE and .....
3. ~~The ways coloured orange/ shown with a  line on the said plan appear on the Definitive Map as BYWAYS OPEN TO ALL TRAFFIC (B.O.A.T.s).\*~~
4. ~~The ways coloured by orange dashes on the said plan have been dedicated as BYWAYS OPEN TO ALL TRAFFIC (B.O.A.T.s).\*~~
5. ~~The ways shown coloured blue/  on the said plan have been dedicated as RESTRICTED BYWAYS.\*~~
6. ~~The ways shown coloured by blue dashes on the said plan have been dedicated as RESTRICTED BYWAYS.\*~~
7. ~~The ways shown coloured by brown dashes/  on the said plan appear on the Definitive Map as ROADS USED AS PUBLIC PATHS (R.U.P.P.s).\*~~
8. The ways shown coloured green/  on the said plan appear on the Definitive Map as BRIDLEWAYS. \*
9. ~~The ways shown coloured by green dashes on the said plan have been dedicated as BRIDLEWAYS.\*~~
10. The shown ways coloured purple/  on the said plan appear on the Definitive Map as FOOTPATHS. \*
11. ~~The ways coloured by purple dashes on the said plan have been dedicated as FOOTPATHS.\*~~
12. No other ways over the land have been dedicated as highways.
13. The deposit shall comprise this statement and accompanying plan.

\*Delete as appropriate.

Signed (landowner)

*Susan Mary Santos*

Name (of landowner)

*SUSAN MARY SANTOS*

Address

*Eastwood Farm, Hagg Lane, Epperstone, Nottingham  
NG14 6AX*

Date

*27th April 2011*

Signed (Witness)

*Nicola Whitelaw JP*

Name (of witness)

*NICOLA WHITELAW*

Address

*THE PENFOLD, CHURCH LANE EPPERSTONE NOTTS NG14 6RU*

Occupation

*SALES MANAGER AND JUSTICE OF THE PEACE*

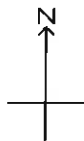
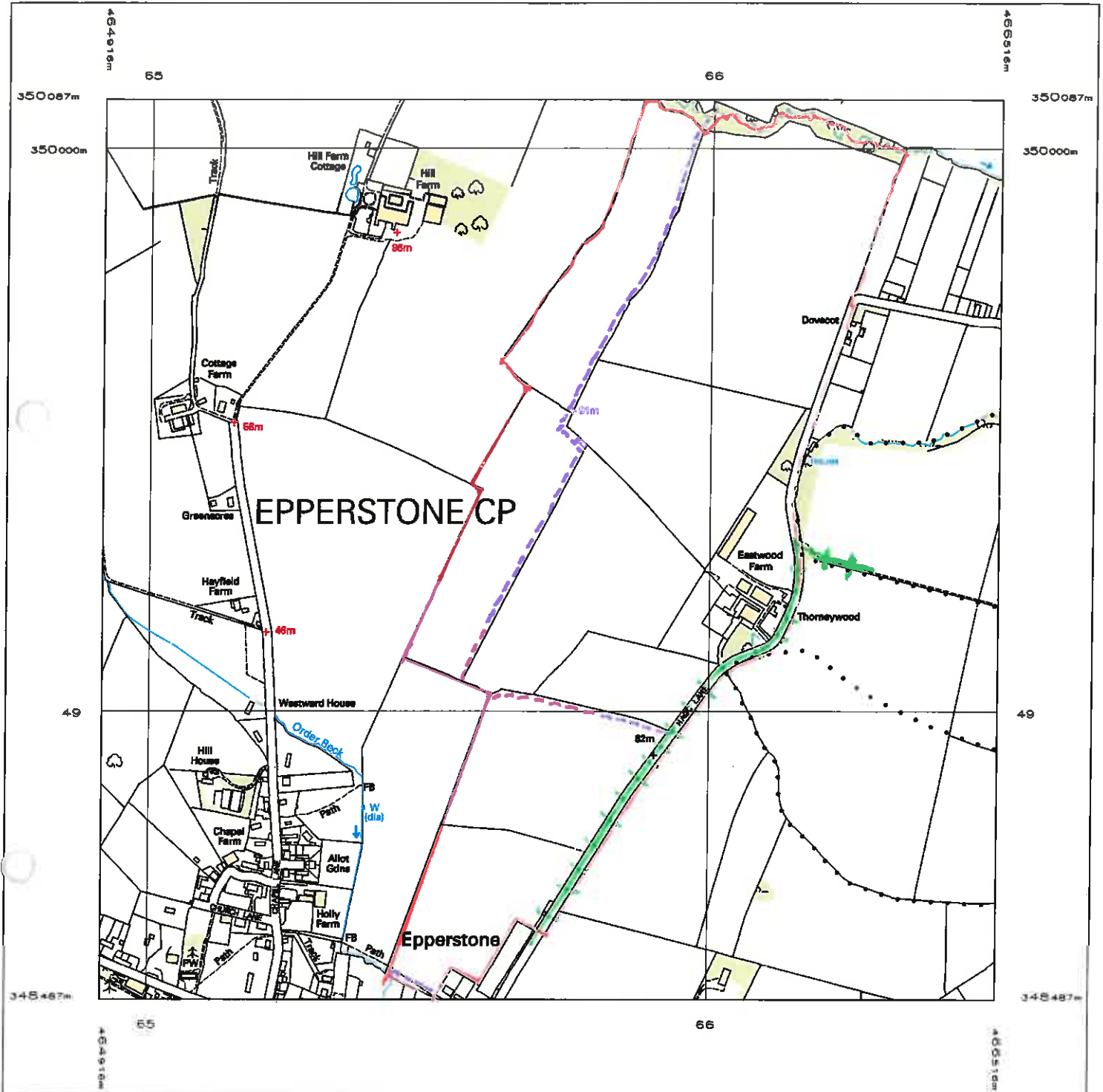

Plotted 28 Jan 2011 from Ordnance Survey digitally derived data.

Produced using significant survey information from Ordnance Survey large scales digital data, and incorporated into OS Landplan Feb 2009 - Aug 2010.

© Crown copyright 2011.

Reproduction in whole or in part is prohibited without the prior written permission of Ordnance Survey.

Administrative boundaries revised to May 2007 - May 2010.

Additional boundaries information:

Heights are given in metres above Newlyn Datum. The representation of a road, track or path is no evidence of a right of way.

The alignment of tunnels is approximate.

An OS Landplan symbols leaflet is available on request from Ordnance Survey Mapping and Data Centres.

Ordnance Survey, the OS Symbol and OS Landplan are registered trade marks of Ordnance Survey, the national mapping agency of Great Britain.

Plot centre coordinates: 465716 349287

Supplied by: Maps

Plot serial number: 01176200

Scale 1:10000