

EPD.TH/AA31
Dr T Hart
(0115) 977 4395
(0115) 977 2414
tim.hart@nottscc.gov.uk
12 January 2007

391
E

Mr/Mrs Dawson
Bracken Lane Farm
Bracken Lane
East Retford
Notts

1st Class

Dear Mr/Mrs Dawson

**NOTTINGHAMSHIRE COUNTY COUNCIL
DEPOSIT OF STATEMENT AND PLAN AND STATUTORY DECLARATION -
SECTION 31(6) OF THE HIGHWAYS ACT 1980
PARISH: EAST RETFORD
NAME OF LANDOWNER: PHILIP ALAN DAWSON & EVELINE DAWSON
NAME OF PROPERTY: BRACKEN LANE FARM**

I wish to acknowledge the receipt of your deposited Statement and Plan and Statutory Declaration on 8 January 2007.

The information contained in the Declaration will be held by this Authority as validation for the contents of the Statement and Plan. It will be necessary for you or your successors to renew the Statutory Declaration every ten years, commencing from the date of the initial Statutory Declaration.

Any changes to your land holding or to the rights of way information in your initial Statement and Plan should be notified to the Rights of Way section, and should also be identified within a new Statutory Declaration covering a modified Statement and Plan.

Yours sincerely

Tim Hart
Senior Definitive Map Officer

NOTTINGHAMSHIRE COUNTY COUNCIL

DEPOSIT OF STATEMENT AND PLAN

SECTION 31 (6) OF THE HIGHWAYS ACT 1980

To

1. I am and have been since 29-8-89 the owner within the meaning of the [day, month, year] above section of the land known as BRACKEN LANE FARM more particularly delineated [Name of Farm, etc] on the attached plan accompanying this statement and thereon edged red.
2. The aforementioned land lies in the Parishes/Communities of [ORDSALL] and [GRAVE].
- * 3. ~~The ways coloured orange on the said plan appear on the Definitive Map as BYWAYS OPEN TO ALL TRAFFIC (B.O.A.T.s).~~
- * 4. ~~The ways coloured by orange dashes on the said plan have been dedicated as BYWAYS OPEN TO ALL TRAFFIC (B.O.A.T.).~~
- * 5. ~~The ways coloured by brown dashes on the said plan appear on the Definitive Map as ROADS USED AS PUBLIC PATHS (R.U.P.P.s).~~
- * 6. ~~The ways coloured green on the said plan appear on the Definitive Map as BRIDLEWAYS.~~
- * 7. ~~The ways coloured by green dashes on the said plan have been dedicated as BRIDLEWAYS.~~
- * 8. ~~The ways coloured purple on the said plan appear on the Definitive Map as FOOTPATHS.~~
- * 9. ~~The ways coloured by purple dashes on the said plan have been dedicated as FOOTPATHS.~~
- * 10. No ~~other~~ ways over the land have been dedicated as highways.
- * 11. The deposit shall comprise this statement and accompanying plan.

* Delete as applicable.

Signed (landowner)

Name (or landowner)

Address

Date

Signed

Name (of witness)

S. Renshem

Address

*16, Cavendish Road,
Ratford, Notts*

Occupation

Financial Investigator

NOTTINGHAMSHIRE COUNTY COUNCIL

STATUTORY DECLARATION

SECTION 31 (6) OF THE HIGHWAYS ACT 1980

EVELINE DAWSON
PHILIP ALAN DAWSON DO SOLEMNLY AND SINCERELY DECLARE as follows:
[Full Name]

1. I am and have been since the owner of the land known as **BRACKEN**
[day, month, year]
LANE FARM more particularly delineated on the plan accompanying this declaration
[name of farm, etc]
and thereon edged red.

2. On the day of I deposited with
[month][year] [Full Name]
Nottinghamshire County Council, being the appropriate Council, a statement accompanied by a
plan delineating my property by red edging which stated that *[the ways coloured orange on the
said plan and on the plan accompanying this declaration are definitive or dedicated BYWAYS
OPEN TO ALL TRAFFIC (B.O.A.T.s)] *[the ways indicated by brown dashes on the said plan
and on the plan accompanying this declaration are definitive ROADS USED AS PUBLIC
PATHS (R.U.P.P.s)] *[the ways coloured green on the said plan and on the plan accompanying
this declaration are definitive or dedicated as BRIDLEWAYS] *[the ways coloured purple on the
said plan and on the plan accompanying this declaration are definitive or dedicated
FOOTPATHS] *[There are no definitive or dedicated Rights of Way over my property.]

3. With reference to 2 above, I confirm that there are no additional public
[Full name]
ways over the land edged red on the Plan and in the Statement dated
[day, month, year]
(other than those definitive routes coloured yellow and those dedicated routes coloured by
yellow dashes and marked *(byway) *(bridleway) *(footpath) on the Plan accompanying this
Declaration).

* Delete as appropriate.

AND I MAKE this solemn declaration of the day of conscientiously
[Month, Year]
believing it to be true and by virtue of the Statutory Declarations Act 1835.

Declared at [address]

[signature of landowner]

Before me

[Commissioner of Oaths or a Justice of the Peace or Solicitor]

OPTIONS MAP

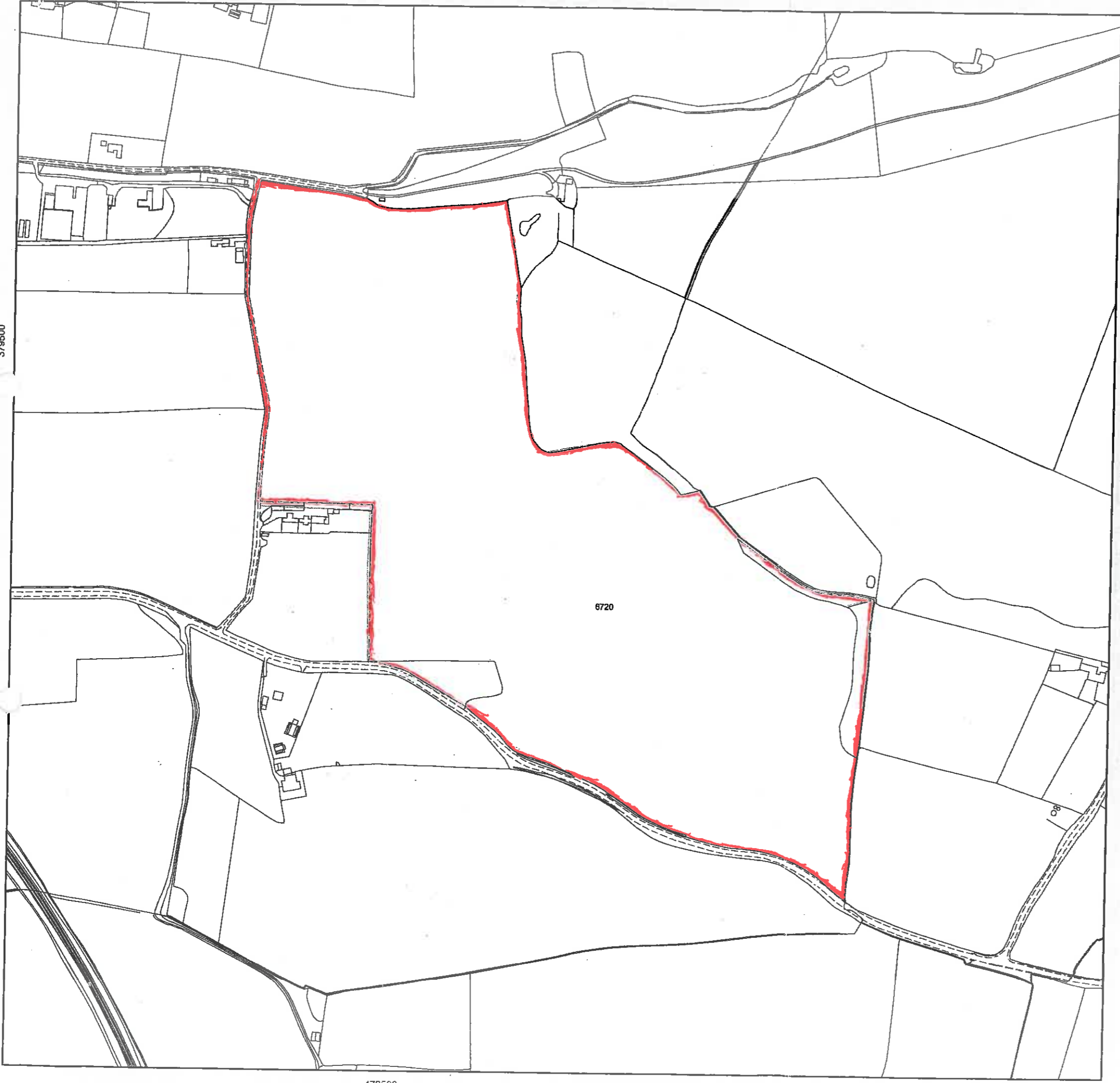

Assigned colour		Applicants colour match
Options		
	Location of other AE scheme options (e.g. CSS, ESA, OFS or ECS)	
EB	Hedgerow management	
EB	Stone faced hedge bank management	
EB	Ditch management	
EB	Stone wall protection and maintenance	
EC	Maintenance of woodland fences/ Management of woodland edges	
EC	Protection of in-field trees <small>*Number within circle represents number of trees in parcel</small>	
ED	Options for historic and landscape features	
EE	Options for buffer strips	
EF	Options for arable Land	
EG	Options to encourage a range of crop type	
EJ	Options to protect soil	
EK	Options for Grassland (outside the LFA)	
EL	Options for the uplands (LFA Land)	
1234	RLR field number	
	Holding parcels (buff coloured parcels are to be marked up on this map. Any grey parcels are covered on other maps)	

You must write the specific option codes you have selected in black on the map, e.g. EB1, EE3, EF9

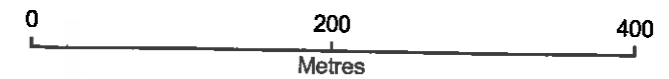

This map has been provided for the sole purpose of supporting ES Scheme Applications and Agreements.
 This map is reproduced from Ordnance Survey material with the permission of Ordnance Survey on behalf of the Controller of Her Majesty's Stationery Office © Crown Copyright.
 Unauthorised reproduction infringes Crown Copyright and may lead to prosecution or civil proceedings.
 Defra Licence No. 10018880, 2005. Map produced by the Rural Development Service.

Application Ref: AG00018098



Printed on recycled paper containing 100% post consumer waste