

NOTTINGHAMSHIRE COUNTY COUNCIL

DEPOSIT OF STATEMENT and PLAN

SECTION 31 (6) OF THE HIGHWAYS ACT 1980

To

1. I am and have been since July 1971 the owner within the meaning of the above section of
[day, month, year]
of the land known as NORWOOD PARK more particularly delineated on the attached
plan
[Name of Farm, etc]
accompanying this statement and thereon edged red.

2. The aforementioned land lies in the Parishes/Communities of [SOUTHWELL] and
[HALAM].

* ~~3. The ways coloured orange on the said plan appear on the Definitive Map as BYWAYS OPEN TO ALL TRAFFIC (B.O.A.T.s).~~

* ~~4. The ways coloured by orange dashes on the said plan have been dedicated as BYWAYS OPEN TO ALL TRAFFIC (B.O.A.T.s).~~

* ~~5. The ways coloured by brown dashes on the said plan appear on the Definitive Map as ROADS USED AS PUBLIC PATHS (R.U.P.P.s).~~

* ~~6. The ways coloured green on the said plan appear on the Definitive Map as BRIDLEWAYS:~~

* ~~7. The ways coloured by green dashes on the said plan have been dedicated as BRIDLEWAYS:~~

* 8. The ways coloured purple on the said plan appear on the Definitive Map as FOOTPATHS.

* ~~9. The ways coloured by purple dashes on the said plan have been dedicated as FOOTPATHS:~~

* 10. No other ways over the land have been dedicated as highways.

* 11. The deposit shall comprise this statement and accompanying plan.

* Delete as applicable

Signed (landowner) -

Name (or landowner)

Address

Date

Signed (witness)

Name (of witness)

Address

Occupation

(TURNER)
Agent acting on behalf of the Trustees of
The Norwood No 1 Settlement
James Turner and Co
12 Moor Street, Retford Notts

C.L. STACEY
37, SOUTHFIELDS RISE
NORTH LEVERTON
RETFORD, NOTTS
DOG GRASOMER

16576

James Turner & Co

Chartered Surveyors, Land Agents and Estate Agents

18 West Street, Retford, Nottinghamshire DN22 6ES

Telephone: 01777 700788 Facsimile: 01777 710323

16 January 1996

Director of Planning and Transportation
Nottinghamshire County Council
Trent Bridge House
Fox Road
West Bridgford
Nottingham
NG2 6BJ

Dear Sir,

DECLARATION OF RIGHTS OF WAY - NORWOOD PARK ESTATE

I refer to my letter dated 10th January and regret to say I have omitted three short lengths of footpaths on this estate. I now enclose a revised plan showing the additional paths and I should be grateful if this could be added to the declaration in my previous letter.

Yours sincerely,



JAMES TURNER



M J S Turner, FRICS

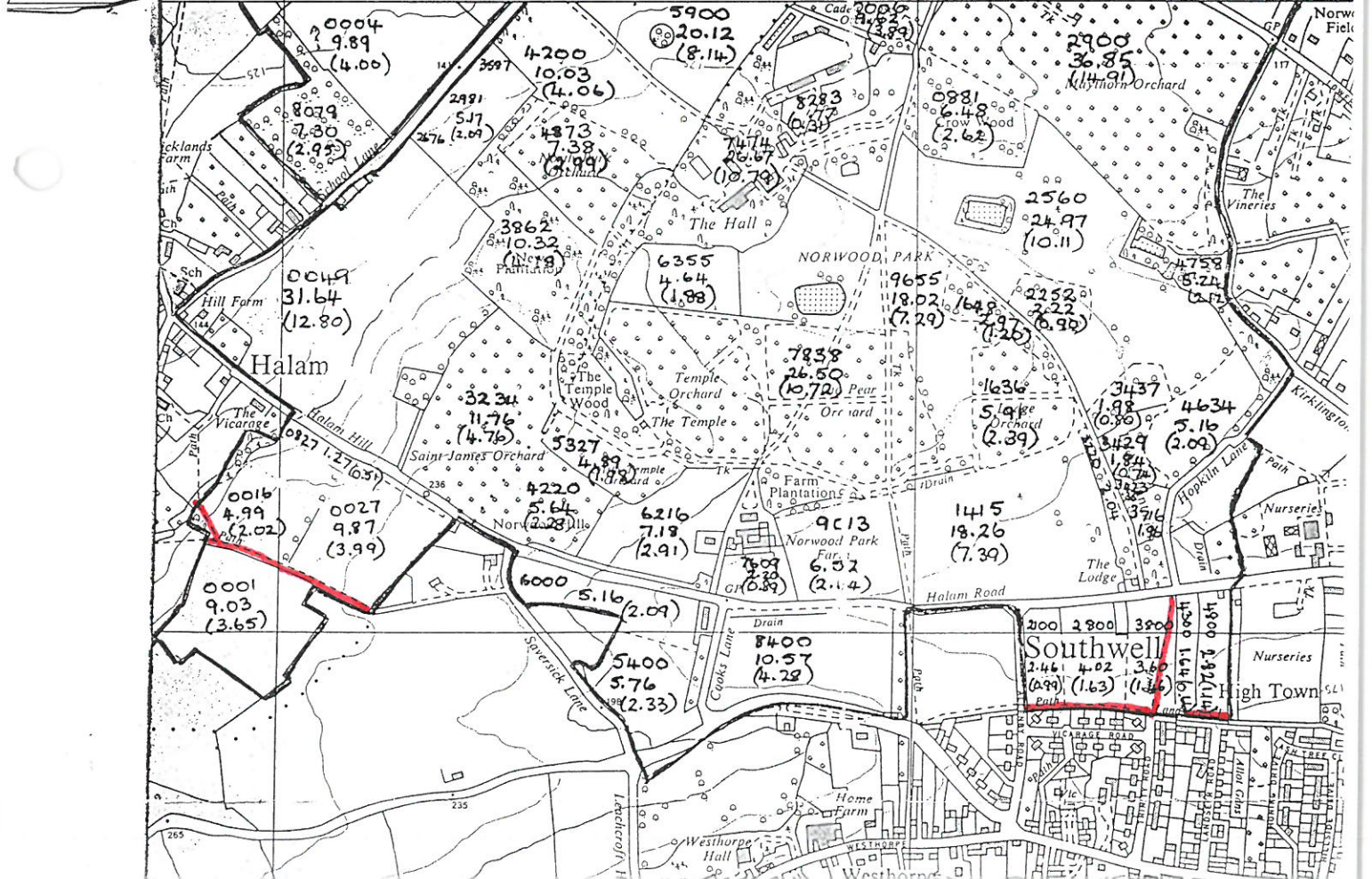
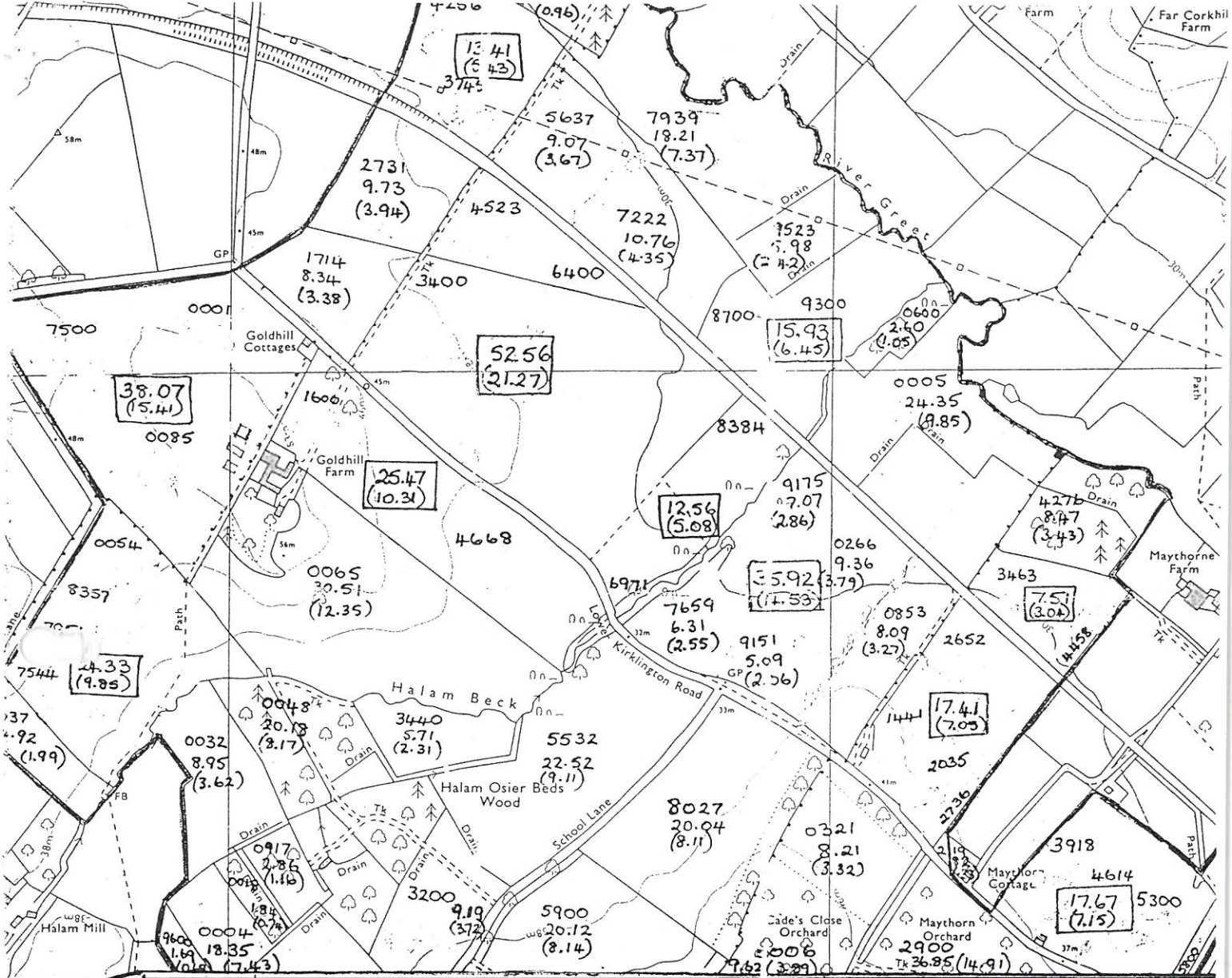

16490

James Turner & Co

Chartered Surveyors, Land Agents and Estate Agents

18 West Street, Retford, Nottinghamshire DN22 6ES

Telephone: 01777 700788 Facsimile: 01777 710323

10 January 1996

Director of Planning & Transport
Nottinghamshire County Council
Trent Bridge House
Fox Road
West Bridgford
Nottingham
NG2 6BJ

Dear Sir

DECLARATION OF RIGHTS OF WAY - NORWOOD PARK ESTATE

I act on behalf of the owners of this estate near Southwell and I am writing to make a declaration under section 31(6) of the Highways Act 1980.

I declare that the only Public Right of Way crossing the above Estate is the Public Footpath shown in red on the plan attached. The property to which this declaration relates is edged green on the plan.

I should be grateful if you would please acknowledge receipt of this letter and enclosures.

Yours sincerely,



JAMES TURNER



M J S Turner, FRICS

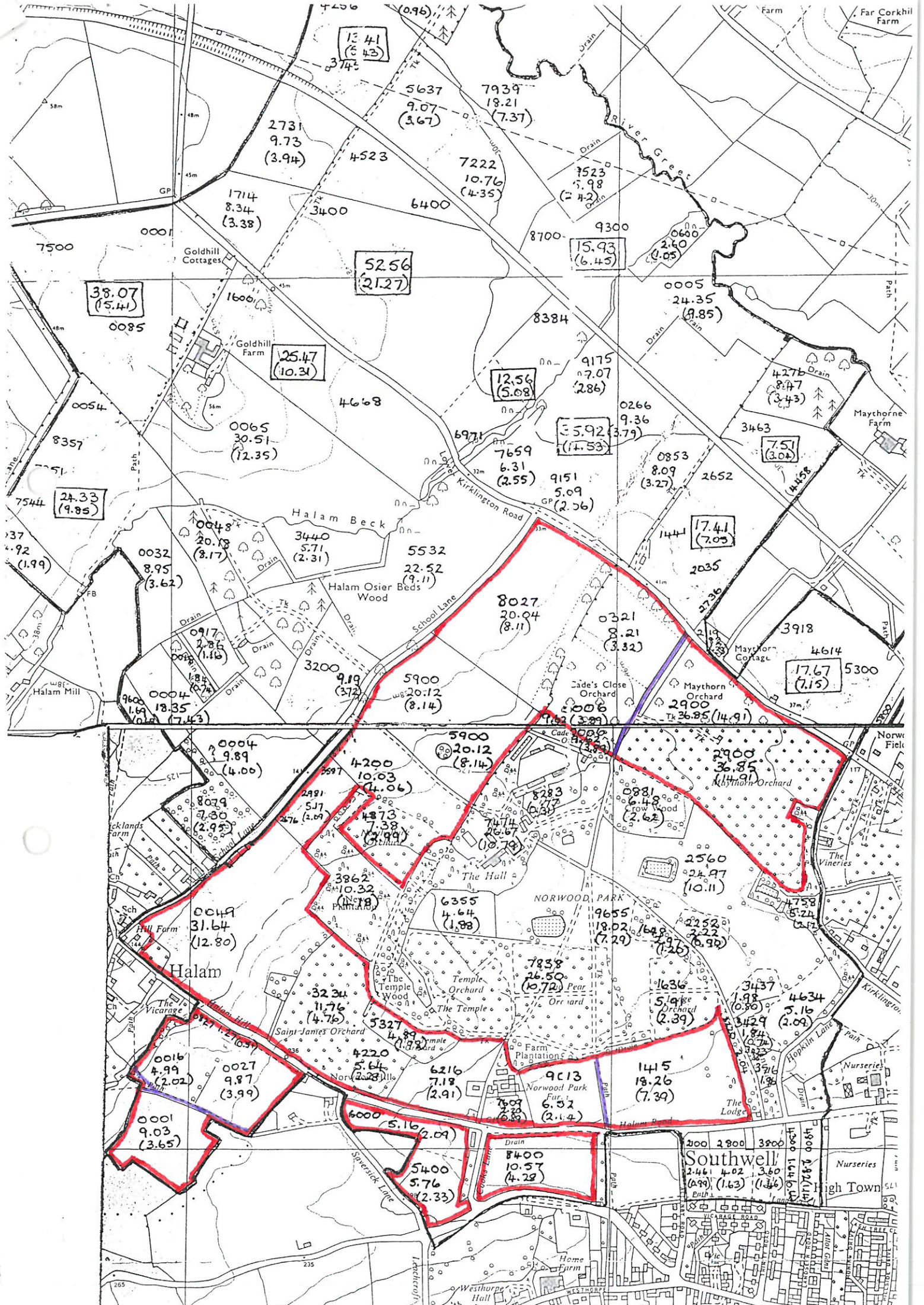

1541
(5.43)

2731
9.73
(3.94)

5256
(21.27)

38.07
(15.41)

25.47
(10.31)

12.56
(5.08)

5.92
(1.53)

7.41
(7.05)

17.67
(7.15)

31.64
(12.80)

4.99
(2.02)

9.03
(3.65)

5.40
(2.33)

10.57
(4.28)

2.46
(1.63)

3.60
(1.66)

