

PSP.EB/RH5
(0115) 977 4709
eddie.brennan@nottscc.gov.uk
10 November 2008

Mrs Jill Atkinson
Torkard Construction Ltd
17-21 Clumber Avenue
Sherwood Rise
Nottingham NG5 1AG

Dear Mrs Atkinson

NOTTINGHAMSHIRE COUNTY COUNCIL
DEPOSIT OF STATEMENT – SECTION 31(6) OF THE HIGHWAYS ACT 1980
PARISH: LAND OFF GRANGE VIEW ROAD, GEDLING 403
LAND OFF MAIN ROAD, COTGRAVE 402
LAND AT HOLLYBUSH FARM, TROWELL 404
LANDOWNER: TORKARD CONSTRUCTION COMPANY LTD

I wish to acknowledge the receipt of your deposited statements for the above named areas on 5 November 2008.

For each landholding, it will be necessary for you or your successors to submit a statutory declaration within ten years. The declaration should also be renewed every ten years commencing from the date of the initial statutory declaration.

As part of the land at Hollybush Farm falls within the Nottingham City Boundary, you should also submit a statement and declaration to that authority.

Any changes to your land holding or to the rights of way information in your initial statement and plan should be notified to the Countryside Access Section.

Yours sincerely

Eddie Brennan
Definitive Map Officer

404
-7

TORKARD CONSTRUCTION

Torkard Construction Co. Ltd.
17 - 21 Clumber Avenue
Sherwood Rise
Nottingham NG5 1AG
TEL: 0115 962 6626
FAX: 0115 969 1340

Our ref JLA/TP02

3 November 2008



Mr E Brennan
Definitive Map Officer
Nottinghamshire County Council
Trent Bridge House
Fox Road
West Bridgford
Nottingham
NG2 6BJ

Dear Mr Brennan

Townell

Land at Hollybush Farm off Bilborough Road, Bilborough, Nottingham

I enclose herewith a Statement and Declaration along with a plan showing details of land that we own at Bilborough.

I would be grateful if you would acknowledge safe receipt of the same.

Yours sincerely
p.p. Torkard Construction Co Ltd

.....
Mrs Jill Atkinson
Director

Statement and declaration of landowner as to admitted and denied highways

Highways Act 1980 section 31(6)

STATEMENT TO ACCOMPANY DEPOSIT OF MAP

To: Mr Eddie Brennan
Definitive Map Officer
Nottinghamshire County Council
Trent Bridge House
Fox House
West Bridgford
Nottingham NG2 6BJ

Land at Hollybush Farm, off Bilborough Road, Bilborough, Nottingham

Torkard Construction Company Limited are registered owners with freehold title of the land shown edged red ("the Land") on the accompanying Map ("the Map").

Torkard Construction Company Limited deny that there are any public rights of way over the Land shown on the accompanying Map deposited by Torkard Construction Company Limited with Nottinghamshire County Council on 3 November 2008.

Date: 3.11.08

.....
Signed on behalf of Torkard Construction Co Limited

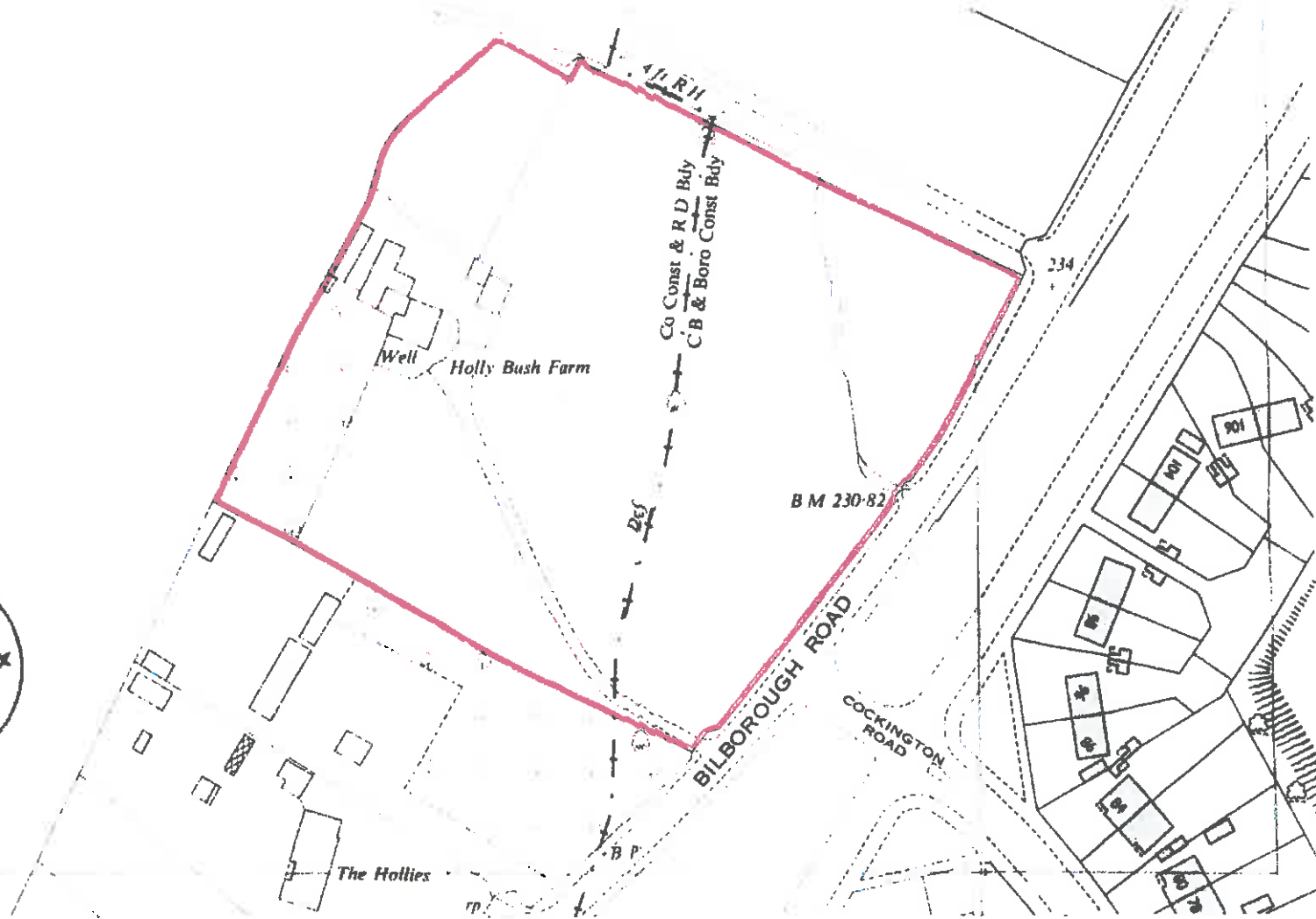

450 020
340 507



This title plan shows the general position of the boundaries: it does not show the exact line of the boundaries. Measurements scaled from this plan may not match measurements between the same points on the ground. For more information see Land Registry Public Guide 7 - Title Plans.
This official copy shows the state of the title plan on 27 October 2005 at 8:43:46. It may be subject to distortions in scale.
Under s.67 of the Land Registration Act 2002, this copy is admissible in evidence to the same extent as the original.
Issued on 27 October 2005.
© Crown copyright. Produced by HMLR. Further reproduction in whole or part is prohibited without the prior written permission of Ordnance Survey. Licence Number GD272728.
This title is dealt with by the Nottingham (East) District Land Registry.