

**NOTTINGHAMSHIRE COUNTY COUNCIL**

5

**DEPOSIT OF STATEMENT AND PLAN**

**SECTION 31 (6) OF THE HIGHWAYS ACT 1980**

To

1. I am and have been since 8-12-1999 the owner within the meaning of the above section of the land known as Cambridge Park more particularly delineated on the attached plan accompanying this statement and thereon edged red.  
(day, month, year)  
(Name of Farm, etc)
2. The aforementioned land lies in the Parishes/Communities of [Alwton] and [Calverton].
3. ~~The ways coloured orange on the said plan appear on the Definitive Map as BYWAYS OPEN TO ALL TRAFFIC (B.O.A.T.s).~~
4. ~~The ways coloured by orange dashes on the said plan have been dedicated as BYWAYS OPEN TO ALL TRAFFIC (B.O.A.T.s).~~
5. ~~The ways coloured by brown dashes on the said plan appear on the Definitive Map as ROADS USED AS PUBLIC PATHS (R.U.P.P.s).~~
6. ~~The ways coloured green on the said plan appear on the Definitive Map as BRIDLEWAYS.~~
7. ~~The ways coloured by green dashes on the said plan have been dedicated as BRIDLEWAYS.~~
8. The ways coloured purple on the said plan appear on the Definitive Map as FOOTPATHS.
9. ~~The ways coloured by purple dashes on the said plan have been dedicated as FOOTPATHS.~~
10. No other ways over the land have been dedicated as highways.
11. The deposit shall comprise this statement and accompanying plan.

Delete as applicable 1

Signed (landowner) [Signature]

Name (or landowner) GARY JOHN DAVIES

Address 18 ELMCADPT, OXTON, SOUTHWELL, NOTTS NG25 0SB

Date 14 September 2000

Signed (Witness) [Signature]

Name (of witness) J H MACLEOD

Address Wynne Hill House,  
Oxton, Notts.

Occupation Self-employed

**NOTTINGHAMSHIRE COUNTY COUNCIL**

**STATUTORY DECLARATION**

**SECTION 31 (6) OF THE HIGHWAYS ACT 1980**

GARY JOHN DAVIES DO SOLEMNLY AND SINCERELY DECLARE as follows:  
[Full Name]

1. I am and have been since 8-12-1999 the owner of the land known as RANSORCE  
[day, month, year]  
PARK more particularly delineated on the plan accompanying this declaration  
[name of farm, etc]  
and thereon edged red.
2. On the 14 day of 09-1999 GARY JOHN DAVIES deposited with  
[month][year] [Full Name]  
Nottinghamshire County Council, being the appropriate Council, a statement accompanied by  
a plan delineating my property by red edging which stated that ~~\*the ways coloured orange on~~  
~~the said plan and on the plan accompanying this declaration are definitive or dedicated~~  
~~BYWAYS OPEN TO ALL TRAFFIC (B.O.A.T.s) [the ways indicated by brown dashes on the~~  
~~said plan and on the plan accompanying this declaration are definitive ROADS USED AS~~  
~~PUBLIC PATHS (R.U.P.P.s) [the ways coloured green on the said plan and on the plan~~  
~~accompanying this declaration are definitive or dedicated as BRIDLEWAYS] \* [the ways~~  
~~coloured purple on the said plan and on the plan accompanying this declaration are definitive~~  
~~or dedicated FOOTPATHS] \* [There are no definitive or dedicated Rights of Way over my~~  
~~property.]~~  
OTHER
3. With reference to 2 above, I ..... confirm that there are no additional public  
[Full name]  
ways over the land edged red on the Plan and in the Statement dated .....  
[day, month, year]  
(other than those definitive routes coloured yellow and those dedicated routes coloured by  
yellow dashes and marked \*(byway) \*(bridleway) \*(footpath) on the Plan accompanying this  
Declaration).

\* Delete as appropriate.

AND I MAKE this solemn declaration of the 14<sup>th</sup> day of September 2000 conscientiously  
[Month, Year]  
believing it to be true and by virtue of the Statutory Declarations Act 1835.

Declared at [address] 18 ELMCROFT,  
OXTON,  
SOUTHWELL,  
NOTTS  
NG25 0SB [signature of landowner]

Before me  
[Commissioner of Oaths or a Justice of the Peace or Solicitor]  
Sullivan

EPE.TH/AA23  
Tim Hart  
(0115) 977 4395  
(0115) 977 2414  
03 October 2000

Mr G Davies  
18 Elmcroft  
Oxton  
Notts  
NG25 0SB

1st Class

Dear Sir

**NOTTINGHAMSHIRE COUNTY COUNCIL  
DEPOSIT OF STATEMENT AND PLAN AND STATUTORY DECLARATION -  
SECTION 31(6) OF THE HIGHWAYS ACT 1980  
PARISH: ARNOLD/CALVERTON  
NAME OF LANDOWNER: GARY JOHN DAVIES  
NAME OF PROPERTY: RAMSDALE PARK**

I wish to acknowledge the receipt of your deposited Statement and Plan and Statutory Declaration on 15 September 2000.

The information contained in the Declaration will be held by this Authority as validation for the contents of the Statement and Plan. It will be necessary for you or your successors to renew the Statutory Declaration every six years, commencing from the date of the initial Statutory Declaration.

Any changes to your land holding or to the rights of way information in your initial Statement and Plan should be notified to the Rights of Way section, and should also be identified within a new Statutory Declaration covering a modified Statement and Plan.

Yours faithfully

  
Tim Hart  
Senior Definitive Map Officer

H.M. LAND REGISTRY		TITLE NUMBER	
ORDNANCE SURVEY PLAN REFERENCE		NT 346059	
COUNTY	NOTTINGHAMSHIRE	SECTION	Scale 1/2500
DISTRICT	GEDLING		© Crown copyright 1999

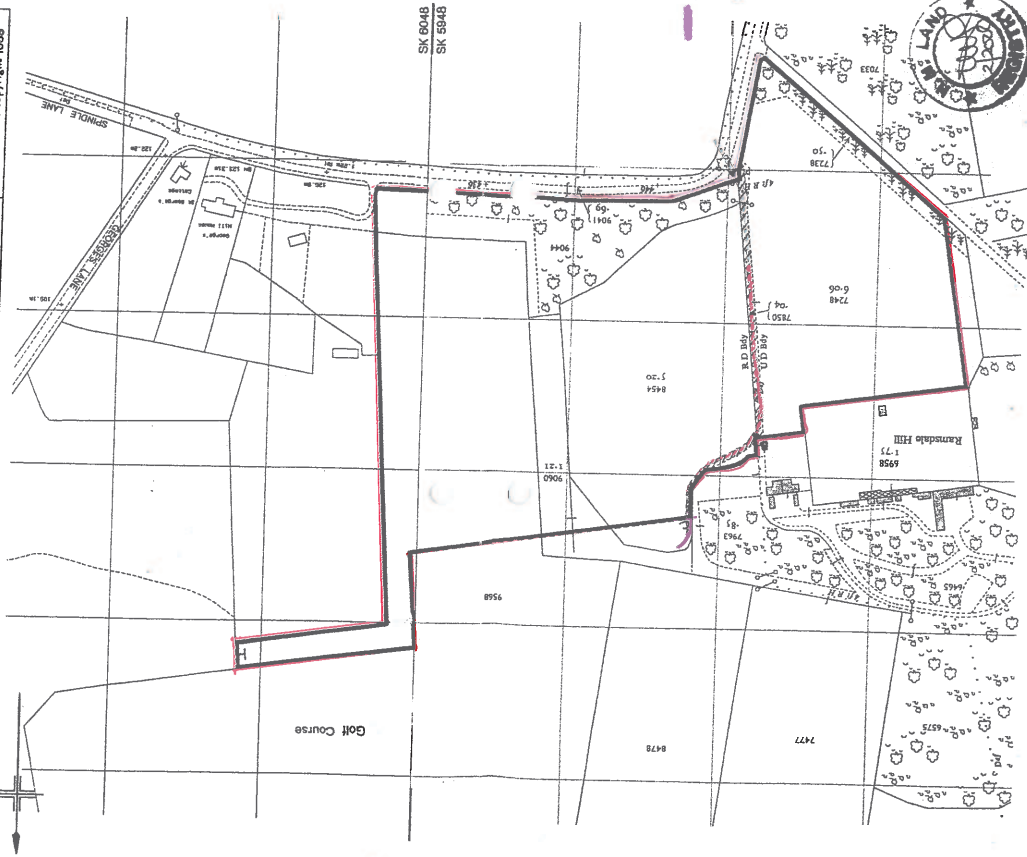

This OFFICE COPY shows the state of the title plan on 5 May 2000 and is admissible in evidence to the same extent as the original. This office copy of the title plan may be subject to minor distortions in scale.  
 Issued on 5 May 2000 by the Nottingham (East) District Land Registry.  
 Crown Copyright. Produced by HMLR. Further reproduction in whole or part is prohibited without the prior written permission of Ordnance Survey. Licence Number GD272726.