

Your Ref -
Our Ref EPD.EB/AA10
Please ask for Eddie Brennan
Tel (0115) 977 4709
Fax (0115) 977 2414
e-mail eddie.brennan@nottsc.gov.uk
Date 9 January 2006



**Nottinghamshire
County Council**
Environment
Director Peter Webster

Trent Bridge House, Fox Road,
West Bridgford, Nottingham NG2 6BJ

Mr J R Oliver
Manor Farm
West Markham
Newark
Notts NG22 0GU

ENVIRONMENT
17 JAN 2006
DEVELOPMENT PLANNING GROUP

Dear Mr Oliver

HIGHWAYS ACT 1980 – SECTION 31 DECLARATION

I refer to our telephone conversation regarding the above and can confirm that the County Council has received your statement, map and statutory declaration in respect of public rights of way over land in your ownership.

There are a couple of things that need to be added/corrected to ensure that the forms have been submitted correctly.

1. Please add the relevant date in the spaces provided on the Statutory Declaration (i.e. section 2 and section 3).
2. Please could you cross-out sections 7 and 9 on the Deposit of Statement form. Footpaths and Bridleways shown on the Definitive Map should be indicated in sections 6 and 8 and shown as solid lines. Rather than completing another form it would be acceptable if you clearly tick and initial sections 6 and 8 to indicate these rights of way accordingly.

I would be grateful if you would then return the forms to me at the above address. Please telephone me if you require any further assistance.

Yours sincerely

Eddie Brennan
Definitive Map Officer

*Hope this is all in order
for you
11/1/06*



INVESTOR IN PEOPLE



NOTTINGHAMSHIRE COUNTY COUNCIL

STATUTORY DECLARATION

SECTION 31 (6) OF THE HIGHWAYS ACT 1980

JOHN ROBERT OLIVER

I DO SOLEMNLY AND SINCERELY DECLARE as follows:
[Full Name]

1. I am and have been since 24.11.85 the owner of the land known as MANOR FARM
[day, month, year]
..... more particularly delineated on the plan accompanying this declaration
[name of farm, etc]
and thereon edged red.

2. On the 18th day of NOVEMBER 2005 I JR OLIVER deposited with
[month][year] [Full Name]
Nottinghamshire County Council, being the appropriate Council, a statement accompanied by a
plan delineating my property by red edging which stated that ~~*[the ways coloured orange on the
said plan and on the plan accompanying this declaration are definitive or dedicated BYWAYS
OPEN TO ALL TRAFFIC (B.O.A.T.s)]~~ ~~*[the ways indicated by brown dashes on the said plan
and on the plan accompanying this declaration are definitive ROADS USED AS PUBLIC
PATHS (R.U.P.P.s)]~~ ~~*[the ways coloured green on the said plan and on the plan accompanying
this declaration are definitive or dedicated as BRIDLEWAYS]~~ ~~*[the ways coloured purple on the
said plan and on the plan accompanying this declaration are definitive or dedicated
FOOTPATHS]~~ ~~*[There are no definitive or dedicated Rights of Way over my property.]~~

3. With reference to 2 above, I JOHN ROBERT OLIVER confirm that there are no additional public
[Full name]
ways over the land edged red on the Plan and in the Statement dated 18/11/05
[day, month, year]
(other than those definitive routes coloured yellow and those dedicated routes coloured by
yellow dashes and marked *(byway) *(bridleway) *(footpath) on the Plan accompanying this
Declaration).

* Delete as appropriate.

AND I MAKE this solemn declaration of the 18 day of November 2005
[Month, Year]
believing it to be true and by virtue of the Statutory Declarations Act 1835.

Declared at [address]

Richmonds
Retford Notts

J R Oliver
[signature of landowner]

Before me

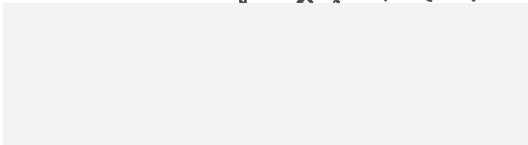

~~[Commissioner of Oaths or a Justice of the Peace or Solicitor]~~

NOTTINGHAMSHIRE COUNTY COUNCIL

DEPOSIT OF STATEMENT AND PLAN

SECTION 31 (6) OF THE HIGHWAYS ACT 1980

To

1. I am and have been since 24-11-85 the owner within the meaning of the [day, month, year] above section of the land known as MANOR FARM more particularly delineated [Name of Farm, etc] on the attached plan accompanying this statement and thereon edged red.

2. The aforementioned land lies in the Parishes/Communities of [TUXFORD] and [EAST & WEST MARKHAM]

~~3. The ways coloured orange on the said plan appear on the Definitive Map as BYWAYS OPEN TO ALL TRAFFIC (B.O.A.T.s).~~

~~4. The ways coloured by orange dashes on the said plan have been dedicated as BYWAYS OPEN TO ALL TRAFFIC (B.O.A.T.).~~

~~5. The ways coloured by brown dashes on the said plan appear on the Definitive Map as ROADS USED AS PUBLIC PATHS (R.U.P.P.s).~~

~~6. The ways coloured green on the said plan appear on the Definitive Map as BRIDLEWAYS.~~

7. The ways coloured by green dashes on the said plan have been dedicated as BRIDLEWAYS.

~~8. The ways coloured purple on the said plan appear on the Definitive Map as FOOTPATHS.~~

9. The ways coloured by purple dashes on the said plan have been dedicated as FOOTPATHS.

~~10. No other ways over the land have been dedicated as highways.~~

11. The deposit shall comprise this statement and accompanying plan.

Delete as applicable.

Signed (landowner)

Name (or landowner) J R OLIVER

Address MANOR FARM WEST MARKHAM
NEWARK NOTT NG220QU

Date 18 November 2005

Signed (Witness)

Name (of witness) T D SORBY

Address Richmonds Retreat Notts

Occupation Solvent

ENVIRONMENT
21 NOV 2005

DEVELOPMENT PLANNING GROUP

J. R. OLIVER.
Manor Farm
West Markham
Newark Notts
NG22 0PN
Tel: 01777 870467



Holding Number: 32/224/0092

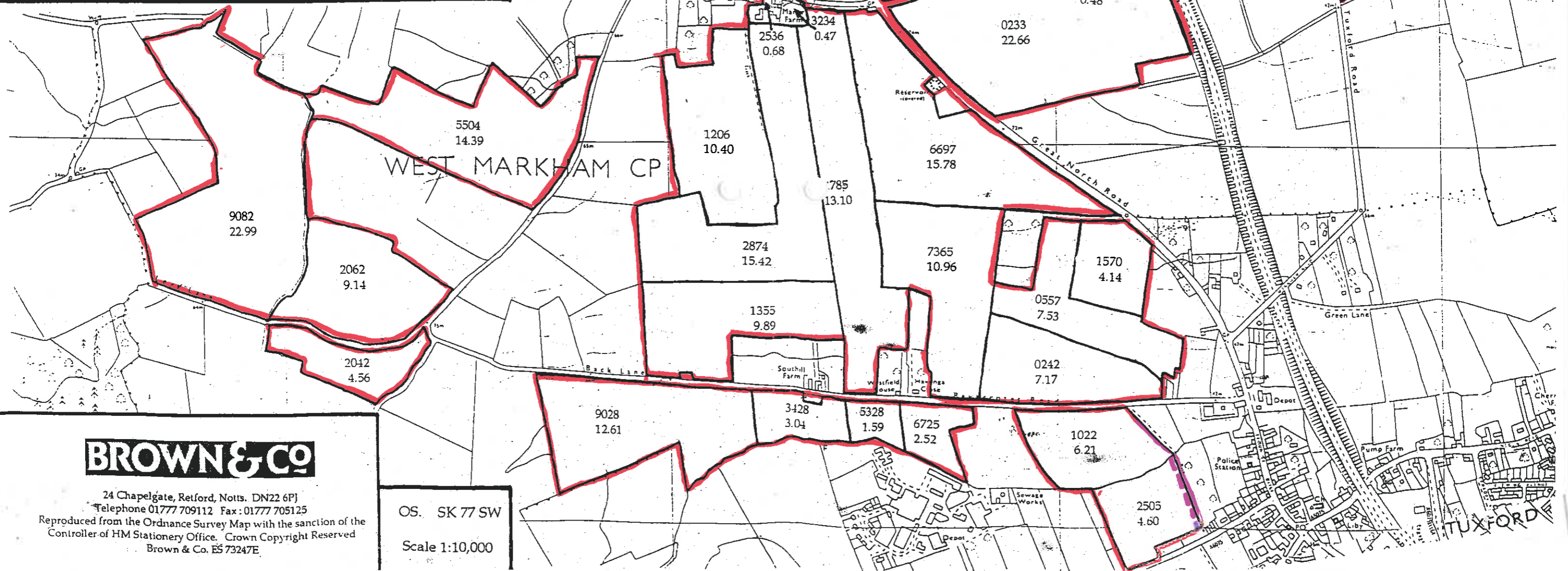
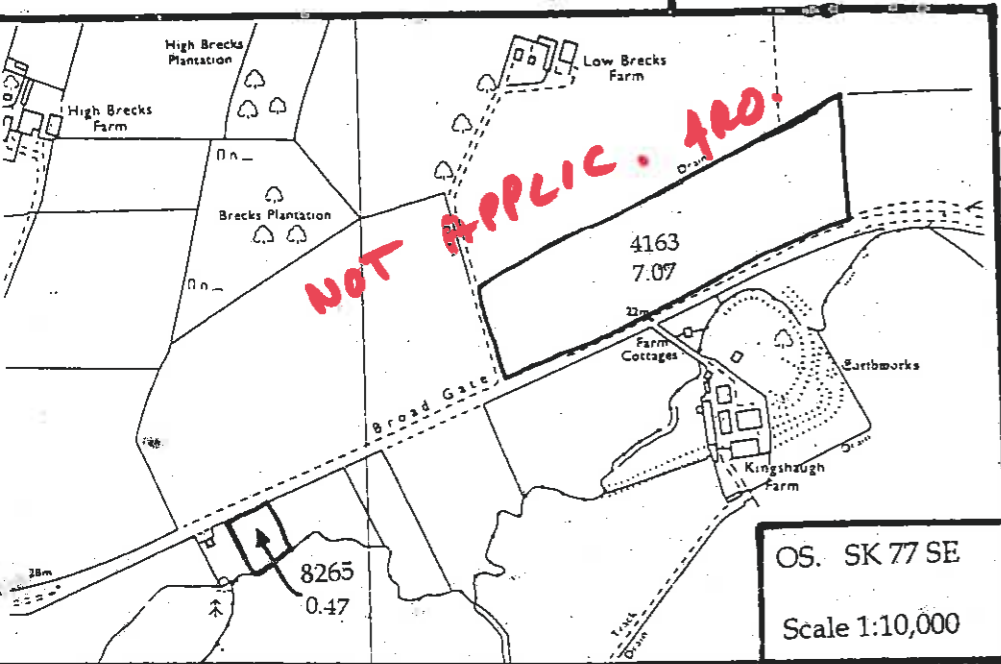

BROWN & CO

24 Chapelgate, Retford, Notts. DN22 6PJ
Telephone 01777 709112 Fax: 01777 705125
Reproduced from the Ordnance Survey Map with the sanction of the
Controller of HM Stationery Office. Crown Copyright Reserved
Brown & Co. E5 73247E

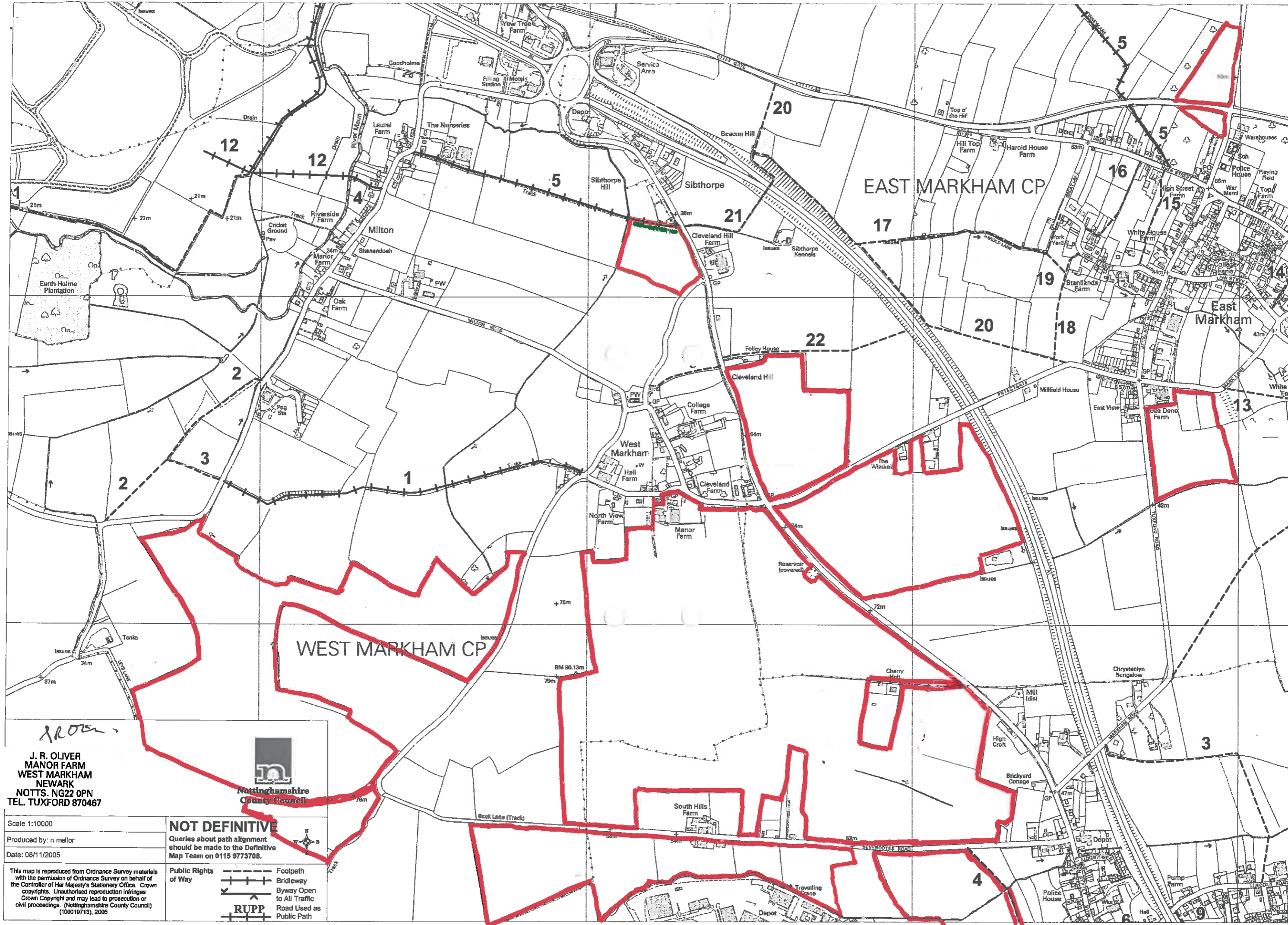

1205

J. R. OLIVER
MANOR FARM
WEST MARKHAM
NEWARK
NOTTS. NG22 0PN
TEL. TUXFORD 870467



Scale 1:10000
 Produced by: n mellor
 Date: 08/11/2005

NOT DEFINITIVE
 Queries about path alignment
 should be made to the Definitive
 Map Team on 0115 9773708.

This map is reproduced from Ordnance Survey materials
 with the permission of Ordnance Survey on behalf of
 the Controller of Her Majesty's Stationery Office. Crown
 copyrights. Unauthorised reproduction infringes
 Crown Copyright and may lead to prosecution or
 civil proceedings. (Nottinghamshire County Council)
 (100019713), 2005

Public Rights
 of Way

- Footpath
- - - Bridleway
- - - Byway Open to All Traffic
- Road Used as Public Path

RUPP