

EPE.TH/ME18
Dr T Hart
(0115) 977 4395
(0115) 977 2414
13 September 2002

Young & Pearce
58 Talbot Street
Nottingham
NG1 5GL

1st Class

Dear Sirs

**NOTTINGHAMSHIRE COUNTY COUNCIL
DEPOSIT OF STATEMENT AND PLAN AND STATUTORY DECLARATION -
SECTION 31(6) OF THE HIGHWAYS ACT 1980
PARISH: WEST BRIDGFORD
NAME OF LANDOWNER: HAVENWOOD CONSTRUCTION
NAME OF PROPERTY: LODGE FARM, EDWALTON**

I wish to acknowledge the receipt of your deposited Statement and Plan and Statutory Declaration on 10 September 2002.

The information contained in the Declaration will be held by this Authority as validation for the contents of the Statement and Plan. It will be necessary for you or your successors to renew the Statutory Declaration every ten years, commencing from the date of the initial Statutory Declaration.

Any changes to your land holding or to the rights of way information in your initial Statement and Plan should be notified to the Rights of Way section, and should also be identified within a new Statutory Declaration covering a modified Statement and Plan.

Yours faithfully

Tim Hart
Senior Definitive Map Officer

Tim Hart Rights of Way

Young & Pearce

With Cecil Godfrey
and Gillespie & Co

Solicitors

58 Talbot Street, Nottingham NG1 5GL
Tel: (0115) 959 8888 MDX 10,025
Fax: (0115) 947 5572
E-mail: reception@youngandpearce.com
Web site: www.youngandpearce.com

Your Ref: EPE.TH/ME15

Our Ref JG/KB / H0025113

Nottinghamshire County Council
Environment
Trent Bridge House
Fox Road West Bridgford
Nottingham
NG1 5GL

013060



September 6, 2002

Dear Sirs

Highways Act 1980, Section 31(6) Lodge Farm Edwalton

We refer to our letter dated 23rd August depositing a map with you under Section 31(6)(a) and a Statement accompanying the map. So far we have not received any response to that letter. However we now enclose a Statutory Declaration of Allison Hancock dated 6th September 2002 and should be grateful if you will also treat this as deposited with you and acknowledge receipt of it. Would you also please acknowledge our earlier letter.

Yours faithfully

Young & Pearce



D.H0025113.007



Highways Act 1980, section 31(6)

Statutory Declaration

I Allison Hancock of 10 Dorchester Gardens West Bridgford Nottingham NG2 7AW do solemnly and sincerely declare as follows:-

- 1 I am a director of Havenwood Construction Limited ("the Company").
- 2 On 23 August 2002 pursuant to section 31(6)(a) of the Highways Act 1980 the Company deposited with Nottinghamshire County Council a map of its land at Lodge Farm Nottingham together with a statement under section 31(6)(b) of the said Act indicating what ways (if any) it admits to have been dedicated as highways.
- 3 Since such deposit and statement no ways have been dedicated as highways over the land delineated on the said map.

AND I make this solemn declaration conscientiously believing the same to be true and by virtue of the Statutory Declarations Act 1835

DECLARED at *office of Hawley Ridges*
2 Clarendon St Nottingham
this *6th* day of *September* 2002, before me,

[Redacted Signature Area]

[Redacted Signature Area]

A ~~Solicitor~~/Commissioner for Oaths

315
EPE.TH/AA26
Mr T Hart
(0115) 977 4395
(0115) 977 2414
05 September 2002

Young & Pearce
58 Talbot Street
NOTTINGHAM
NG1 5GL

1st Class

Dear Sirs

**NOTTINGHAMSHIRE COUNTY COUNCIL
DEPOSIT OF STATEMENT AND PLAN AND STATUTORY DECLARATION -
SECTION 31(6) OF THE HIGHWAYS ACT 1980
PARISH: WEST BRIDGFORD
NAME OF LANDOWNER: HAVENWOOD CONSTRUCTION
NAME OF PROPERTY: LODGE FARM**

I wish to acknowledge the receipt of your deposited Statement and Plan and ~~Statutory Declaration~~ on 27 August 2002.

~~The information contained in the Declaration will be held by this Authority as validation for the contents of the Statement and Plan.~~ It will be necessary for you or your successors to renew the Statutory Declaration every ten years, commencing from the date of the initial Statutory Declaration (*not yet received*).

Any changes to your land holding or to the rights of way information in your initial Statement and Plan should be notified to the Rights of Way section, and should also be identified within a new Statutory Declaration covering a modified Statement and Plan.

You may wish to note that part of the land shown on your plan has already been the subject of a Statutory Declaration lodged by Mr and Mrs Poole of Foxleigh House, Highgrove Gardens, Edwalton.

Yours faithfully

Tim Hart
Senior Definitive Map Officer

Solicitors

Your Ref: EPE.TH/ME15
Our Ref: JG/KB / H0025113

58 Talbot Street, Nottingham NG1 5GL
Tel: (0115) 959 8888 MDX 10,025
Fax: (0115) 947 5572
E-mail: reception@youngandpearce.com
Web site: www.youngandpearce.com

Nottinghamshire County Council
Environment
Trent Bridge House
Fox Road West Bridgford
Nottingham
NG1 5GL

012978

August 23, 2002

Dear Sirs

Highways Act 1980, Section 31(6) Lodge Farm Edwalton

We enclose herewith:-

1. Map for deposit with the Council under Section 31(6)(a) by Havenwood Construction Ltd for whom we act.
2. Statement accompanying deposited map under Section 31(6)(b).

Would you be kind enough to acknowledge receipt.

Yours faithfully

Young & Pearce

D.H0025113.005



1

U.6



FS 27128

John A Pearce Robert B White Roger Calvert John J V Gossage M.Phil LL.B
Tony Wilkinson LL.B (Solicitor Advocate) Duncan J V Godfrey B.A. John W Garner
Richard Bates LL.B. Consultant Geoffrey C Treadgold

Associates

Alison Playle LL.B Vicky A Clarkson Julie McCrery LL.B

Regulated by the Law Society



A QUALITY SERVICE
Approved by The Legal Aid Board

Notice accompanying the deposit of a map under section 31(6)(a)

Re Lodge Farm Edwalton Nottingham

To Nottinghamshire County Council

I/we Havenwood Construction Limited pursuant to section 31(6)(b) of the Highways Act 1980 state that I/we admit that the ways (if any) specified in the Schedule below over the land shown edged pink on the accompanying map deposited with you by me/us pursuant to section 31(6)(a) of the said Act have been dedicated as highways and deny that any other ways over the said land have been so dedicated.

Schedule - Ways (if any) admitted to have been dedicated as highways

None

Dated this 23 AUGUST 2001

Director, for Havenwood Construction Limited

Highways Act 1980

Map deposited under section 31(6)(a) by
Havenwood Construction Limited

Lodge Farm Edwalton Nottingham

OS Ordnance
Survey®
Superplan®

Option 1
Site-centred

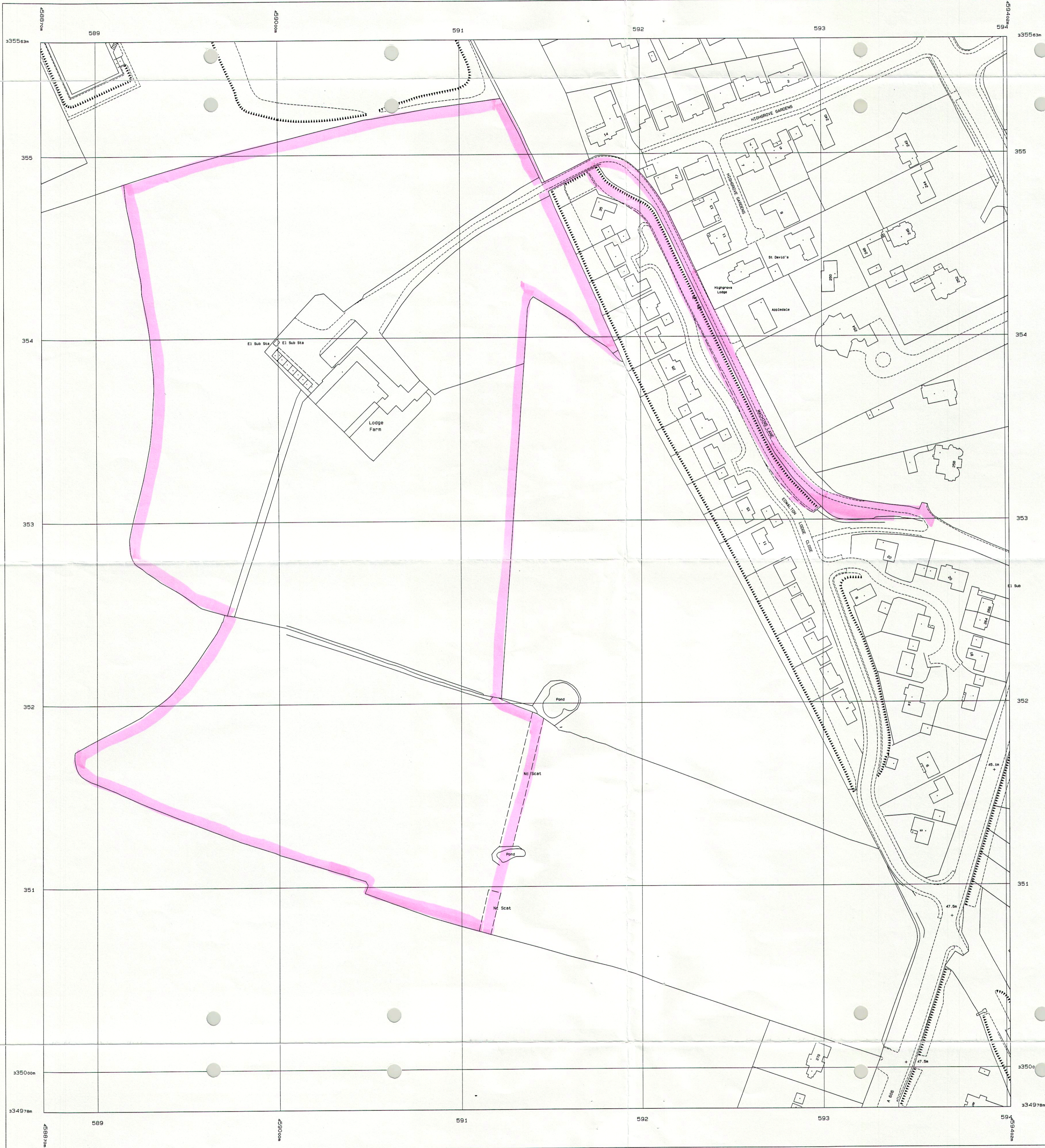

Produced 05 Sep 2001 from Ordnance Survey digital data and incorporating surveyed revision available at this date. © Crown Copyright 2001.

Reproduction in whole or in part is prohibited without the prior permission of Ordnance Survey.

Ordnance Survey, the OS symbol and Superplan are registered trade marks of Ordnance Survey, the national mapping agency of Great Britain.

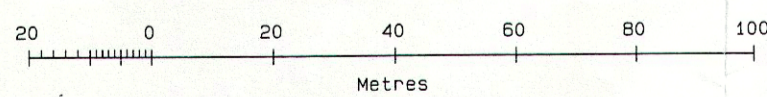

Scale 1: 1250

Part or all of this Superplan is enlarged from mapping produced at one or more of the following scales: 1:1250, 1:2500 & 1:10000

National Grid sheet reference at centre of this Superplan: SK5925SW
The representation of a road, track or path is no evidence of a right of way.
Heights are given in metres above Datum.
The alignment of tunnels is approximate.

Centre Coordinates: 459136 335271
Supplied by: Waterstones, Nottingham
Serial Number: 14200