

This matter is being dealt with by:
Eddie Brennan
Reference: EB/140512/Shouler
T 0115 977 4709
E eddie.brennan@nottscc.gov.uk
W nottinghamshire.gov.uk



Mr Charles Hutchinson
Shouler and Son
County Chambers
Kings Road
Melton Mowbray
Leicestershire LE13 1QF

12 May 2014

Dear Mr Hutchinson

Your Ref: CGKH/AJD

LANDOWNER DEPOSIT UNDER SECTION 31(6) OF THE HIGHWAYS ACT 1980
PARISH: WEST BRIDGFORD
NAME OF LANDOWNER: MRS P MYLES
NAME OF PROPERTY: WOODLAND AT WILFORD HILL, NOTTINGHAM

Thank you for the above landowner declaration which has now been processed. I also acknowledge safe receipt of Mrs Myles' cheque to the sum of £150 for our administration charge.

Accordingly, I attach a copy of the formal notice (Form CA17) which will be affixed on site on 14 May 2014. The declaration will be retained this authority as evidence in the event that a dispute should arise.

Thank you for your help in this matter.

Yours sincerely

Eddie Brennan
Definitive Map Officer
Nottinghamshire County Council

Land & Estate Agents, Valuers & Auctioneers

Your Ref:
Our Ref: CGKH/AJD



County Chambers
Kings Road
Melton Mowbray
Leicestershire
LE13 1QF
01664 560181

Mr E Brennan
Countryside Access
Nottinghamshire County Council
Trent Bridge House
Fox Road
West Bridgford
Nottingham NG2 6PJ

'Part B' Statement.

3rd April 2014

Dear Mr Brennan

Woodland at Wilford Hill, Nottingham, 8.87 acres or thereabouts

I refer to your email to me dated the 26th March relating to fees for statements and declarations in connection with the Commons Act 2006 and the Highways Act 1980. Please now find enclosed a cheque in the sum of £150.00 in connection with the application by Mrs Myles dated the 21st November 2013 and sent to yourselves with a covering letter dated the 22nd of November 2013 under the heading "Woodland at Wilford Hill, Nottingham, 8.87 acres or thereabouts".

Perhaps you would be kind enough to confirm receipt of this cheque so that the process can be commenced.

Yours sincerely

Charles Hutchinson BSc MRICS Registered Valuer
Partner
c.hutchinson@shoulers.co.uk
Direct Dial 01664 502954

Enc.

Land & Estate Agents, Valuers & Auctioneers

Your Ref:
Our Ref: CGKH/AJD

Countryside Access
Nottinghamshire County Council
Trent Bridge House
Fox Road
West Bridgford
Nottingham NG2 6PJ



County Chambers
Kings Road
Melton Mowbray
Leicestershire
LE13 1QF
01664 560181

22nd November 2013

Dear Sirs

Woodland at Wilford Hill, Nottingham, 8.87 acres or thereabouts

Please find enclosed a Notice under Section 31(6) of the Highways Act 1980 in relation to Wilford Hill wood which is owned by our client. It is noted that the Dedicated Highways (Landowners Statements and Declarations) (England) Regulations 2013 came into effect on the 1st of October 2013. Accordingly the application has been completed on that basis and we did request confirmation from yourselves as to whether there is a charge for the application but we are advise that you do not know whether or not a charge is relevant and accordingly therefore no fee is attached hereto. If it is subsequently found that a fee is appropriate could you please advise so that we can send the necessary fee. Could you please acknowledge receipt of this application so that we can advise our client that the matter is in hand.

Yours faithfully

Charles Hutchinson BSc MRICS Registered Valuer
Partner
c.hutchinson@shoulers.co.uk
Direct Dial 01664 502954

Enc.

SCHEDULE 1

Regulation 2(2)(a)

Application Form

Form CA16

Application Form for deposits under section 31(6) of the Highways Act 1980 and section 15A(1) of the Commons Act 2006

Please read the following guidance carefully before completing this form

1. *Guidance relating to completion of this form is available from <https://www.gov.uk/town-and-village-greens-how-to-register>. Please refer to these separate notes when completing this form.*
2. *Parts A and F must be completed in all cases.*
3. *The form must be signed and dated by, or by a duly authorised representative of, every owner of land to which the application relates who is an individual, and by the secretary or some other duly authorised officer of every owner of land to which the application relates which is a body corporate or an unincorporated association.*
4. *In the case of land in joint ownership all the joint owners must complete paragraphs 2 and 3 of Part A and complete and sign the application in Part F, unless a duly authorised representative completes and signs the form on behalf of all of the owners of the land. Paragraph 3 should be completed in full to clearly explain the capacity of each applicant e.g. trustee, landowner's managing agent, executor.*
5. *'Owner' is defined in section 61(3) of the Commons Act 2006 and section 31(7) of the Highways Act 1980 and means, broadly, a legal owner of the freehold interest in the land.*
6. *Where the application relates to more than one parcel of land, a description of each parcel should be included in Paragraph 4 of Part A and the remainder of the form should be completed to clearly identify which statement and/or declaration relates to which parcel of land. This may require the insertion of additional wording. See separate notes for further guidance. Multiple parcels of land should be clearly identified by coloured edging on any accompanying map.*
7. *Where a statement or declaration requires reference to colouring shown on an accompanying map or previously lodged map, the colouring must be clearly specified and must match that shown on the relevant map. For example, if a footpath is specified in a Part C declaration as shown coloured brown, the accompanying map or previously deposited map referred to must reflect that colouring.*
8. *An application must be accompanied by an ordnance map, or (in respect of declarations under Part C or statements under Part D of this form) refer to a map previously deposited in accordance with the Commons (Registration of Town or Village Greens) and Dedicated Highways (Landowner Statements and Declaration) (England) Regulations 2013 or (if deposited before 1st October 2013) in accordance with section 31(6) of the Highways Act 1980. Any accompanying map must be an ordnance map at a scale of not less than 1:10,560 showing the boundary of the land to which the application relates in coloured edging.*
9. *An application must be accompanied by the requisite fee – please ask the appropriate authority for details.*

10. *'Appropriate authority' means (a) in relation to a map or statement deposited or declaration lodged under section 31(6) of that Act, an appropriate council (as defined in section 31(7) of the Highways Act 1980); and (b) in relation to a statement and map deposited under section 15A(1) of*

the 2006 Act, a commons registration authority (defined in section 4 of the Commons Act 2006 and section 2 of the Commons Registration Act 1965). In practice, the appropriate council and commons registration authority will usually be the same body.

PART A: Information relating to the applicant and land to which the application relates

(all applicants must complete this Part)

1. Name of appropriate authority to which the application is addressed: **Countryside Access, Nottinghamshire County Council, Trent Bridge House, Fox Road, West Bridgford, Nottingham, NG2 6BJ**

2. Name and full address (including postcode) of applicant: **Mrs P Myles, Woodroofes, Marchington Woodland, Staffordshire, ST14 8PE**

3. Status of applicant (tick relevant box or boxes):

I am

- (a) the owner of the land(s) described in paragraph 4.
- (b) making this application and the statements/declarations it contains on behalf of (*insert name of owner*) who is the owner of the land(s) described in paragraph 4 and in my capacity as (*insert details*).

4. Insert description of the land(s) to which the application relates (including full address and postcode): **Woodland at Wilford Hill, Nottingham 8.87 acres or thereabouts as shown on the attached plan.**

5. Ordnance Survey six-figure grid reference(s) of a point within the area of land(s) to which the application relates (if known): **576351**

6. This deposit comprises the following statement(s) and/or declarations (*delete Parts B, C, or D where not applicable*):

PART B: Statement under section 31(6) of the Highways Act 1980

(I am Mrs P Myles the owner of the land described in paragraph 4 of Part A of this form and shown red on the map accompanying this statement.

No ways over the land shown red on the accompanying map have been dedicated as highways.

PART C: Declaration under section 31(6) of the Highways Act 1980

1. (I am/*insert name of owner*) is the owner of the land described in paragraph 4 of Part A of this form and shown (*insert colouring*) on the map (accompanying this declaration/lodged with (*insert name*) Council on (*insert day, month, year*)).

(delete wording in brackets as appropriate and/or insert information as required)

2. On the (*insert day*) day of (*insert month, year*) (I/my/*insert name of owner's*) predecessor in title (*insert name*) deposited with (*insert name*) Council, being the appropriate council, a statement accompanied by a map showing (my/*insert name of owner's*) property (*insert colouring*) which stated that:

(the ways shown (*insert colouring*) on that map (and on the map accompanying this declaration) had been dedicated as byways open to all traffic)

(the ways shown (*insert colouring*) on that map (and on the map accompanying this declaration) had been dedicated as restricted byways)

(the ways shown (*insert colouring*) on that map (and on the map accompanying this declaration) had been dedicated as bridleways)

(the ways shown (*insert colouring*) on that map (and on the map accompanying this declaration) had been dedicated as footpaths)

(no (other) ways had been dedicated as highways over (my/*insert name of owner's*) property).

(delete wording in brackets as appropriate and/or insert information as required)

(3. On the (*insert day*) day of (*insert month, year*) (I/my/*insert name of owner's*) predecessor in title (*insert name*) deposited with (*insert name*) Council, being the appropriate council, a declaration dated (*insert day, month, year*), stating that no additional ways (other than those marked in the appropriate colour on the map accompanying that declaration) had been dedicated as (byways open to all traffic) (restricted byways) (bridleways) (footpaths) since the deposit of the statement referred to in paragraph 2 above.)

(delete if not applicable and delete wording in brackets as appropriate and/or insert information as required)

4. No additional ways have been dedicated over the land (*insert colouring*) on the map (accompanying this declaration/referenced in paragraph 1 above) since the statement dated (*insert day, month, year*) referred to in paragraph 2 above (since the date of the declaration referred to in paragraph 3 above) (other than those (byways open to all traffic) (restricted byways) (bridleways) (footpaths) marked in the appropriate colour on the map accompanying this declaration) and at the present time (I/*insert name of owner*) (have/has) no intention of dedicating any more public rights of way over (my/the) property.

(delete wording in brackets as appropriate and/or insert information as required)

PART D: Statement under section 15A(1) of the Commons Act 2006

(I am/*insert name of owner*) is the owner of the land described in paragraph 4 of Part A of this form and shown (*insert colouring*) on the map (accompanying this statement/deposited with (*insert name*) Council on (*insert day, month, year*)).

(I/*insert name of owner*) (wish/wishes) to bring to an end any period during which persons may have indulged as of right in lawful sports and pastimes on the whole or any part of the land shown (*insert colouring*) on the (accompanying map/map referenced above).

(delete wording in brackets as appropriate and/or insert information as required)

PART E: Additional information relevant to the application
(insert any additional information relevant to the application)

PART F: Statement of Truth
(all applicants must complete this Part)

WARNING: If you dishonestly enter information or make a statement that you know is, or might be, untrue or misleading, and intend by doing so to make a gain for yourself or another person, or to cause loss or the risk of loss to another person, you may commit the offence of fraud under section 1 of the Fraud Act 2006, the maximum penalty for which is 10 years' imprisonment or an unlimited fine, or both.

I BELIEVE THAT THE FACTS AND MATTERS CONTAINED IN THIS FORM ARE TRUE

Signature (of the person making the statement of truth):

Print full name: **PENELOPE K MYLES**

Date: **21 NOVEMBER 2013**

You should keep a copy of the completed form

Data Protection Act 1998 - Fair Processing Notice

The purpose of this Fair Processing Notice is to inform you of the use that will be made of your personal data, as required by the Data Protection Act 1998.

The appropriate authority (see explanation of definition in above guidance notes) in England is the data controller in respect of any personal data that you provide when you complete this form.

The information that you provide will be used by the appropriate authority in its duties to process applications to deposit statements, maps and declarations under section 31(6) the Highways Act 1980 and statements under section 15A(1) of the Commons Act 2006. The information you provide will also be used by the appropriate authority in its duty to update the registers in which details of such deposits are recorded under the Dedicated Highways (Registers under Section 31A of the Highways Act 1980) (England) Regulations 2007 and the Commons (Registration of Town or Village Greens) and Dedicated Highways (Landowner Statements and Declarations) (England) Regulations 2013.

The appropriate authority is required by the legislation above to maintain a register which holds information provided in this form, which can be inspected online or in person by members of the public on request. It may also be required to release information, including personal data and commercial information, on request under the Environmental Information Regulations 2004 or the Freedom of Information Act 2000. However, the appropriate authority will not permit any unwarranted breach of confidentiality nor will they act in contravention of their obligations under the Data Protection Act 1998.

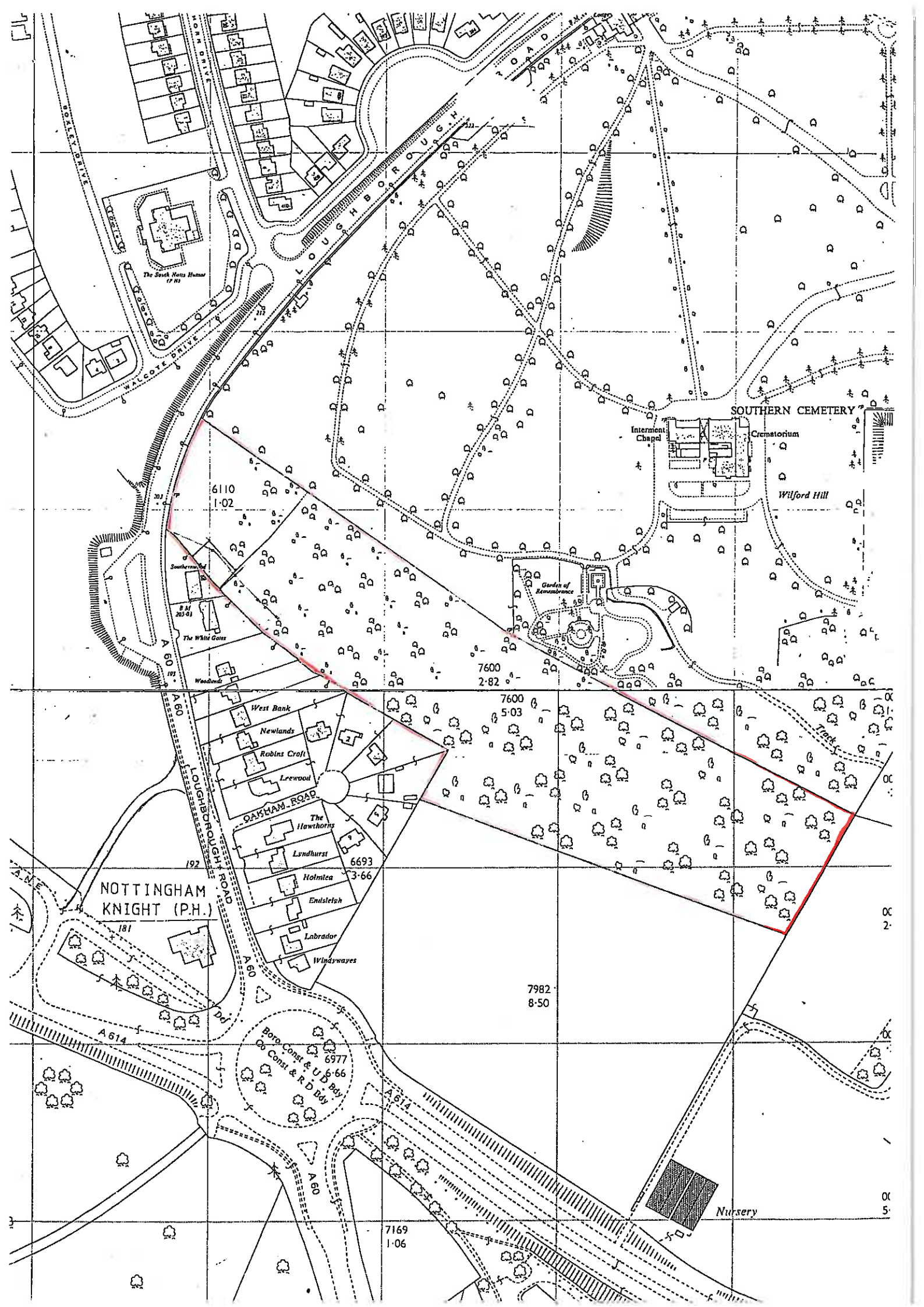



**Nottinghamshire
County Council**

**FORM CA17: NOTICE OF LANDOWNER DEPOSITS UNDER SECTION 31(6) OF
THE HIGHWAYS ACT 1980 AND SECTION 15(1) OF THE COMMONS ACT 2006**

Nottinghamshire County Council

An application to deposit a map and statement under section 31(6) of the Highways Act 1980 has been made in relation to the land (or lands) described below and shown edged in red on the accompanying map.

PLEASE NOTE:

This deposit may affect rights over the land described below. Deposits made under section 31(6) of the Highways Act 1980 may prevent deemed dedication of public rights of way over such land under section 31(1) of that Act. Deposits made under section 15A(1) of the Commons Act 2006 may affect the ability to register such land as a town or village green under section 15 of that Act. For further information, please see guidance at; www.defra.gov.uk/rural/protected/greens.

Description of the land(s): Woodland at Wilford Hill

Name of the Parish in which the land(s) is situated: West Bridgford

The deposit was submitted by Mrs P Myles, Woodroofes Marchington Woodland, Staffordshire ST14 8PE

The authority maintains a register of maps, statements and declarations deposited under section 31A of the Highways Act 1980 and section 15B of the Commons Act 2006. This register can be accessed online at; www.nottinghamshire.gov.uk/enjoying/countryside or can be inspected free of charge by appointment at the Countryside Access Team, Trent Bridge House, Fox Road, West Bridgford, Nottingham. Telephone 0115 9774915 (Office opening hours: Mon. to Fri. 9:00am to 4:30pm).

Signed on behalf of Nottinghamshire County Council

Gary Wood: Group Manager, Highway Planning Access & Commissioning
Date: 14 May 2014