

JLA/LP03; JLA/LP04b; JLA/LP09a
PSP.EB.50I.IY.4
(0115) 977 4709
eddie.brennan@nottscc.gov.uk
09 December 2008

Mr John Fletcher
Langridge Homes Ltd
17-21 Clumber Avenue
Sherwood Rise
Nottingham NG5 1AG

Dear Mr Fletcher

NOTTINGHAMSHIRE COUNTY COUNCIL
DEPOSIT OF STATEMENT – SECTION 31(6) OF THE HIGHWAYS ACT 1980
PARISH: LAND OFF WOODSIDE ROAD, BURTON JOYCE
LAND OFF GEORGES LANE, CALVERTON
LAND OFF LEAPOOL ISLAND, ARNOLD

LANDOWNER: LANGRIDGE HOMES LIMITED

I wish to acknowledge receipt of your deposited statements for the above named areas.

For each landholding, it will be necessary for you or your successors to submit a statutory declaration within ten years. The declaration should also be renewed every ten years commencing from the date of the initial statutory declaration.

Any changes to your land holding or to the rights of way information in your initial statement and plan should be notified to the Countryside Access Section.

Yours sincerely

Eddie Brennan
Definitive Map Officer

Acknowledged
9-12-2008



Langridge Homes Limited
17 - 21 Clumber Avenue
Sherwood Rise
Nottingham NG5 1AG
TEL: 0115 962 6626
FAX: 0115 969 1340
E-MAIL Enquiries@Langridgehomes.com
www.Langridgehomes.com

Our ref JLA/LP03

25 November 2008

408

Mr E Brennan
Definitive Map Officer
Nottinghamshire County Council
Trent Bridge House
Fox Road
West Bridgford
Nottingham
NG2 6BJ

Dear Mr Brennan

Land off Woodside Road, Burton Joyce, Nottingham

I enclose herewith a Statement and Declaration along with a plan showing details of land that we own at Burton Joyce.

I would be grateful if you would acknowledge safe receipt of the same.

Yours sincerely
p.p. Langridge Homes limited

Mr John Fletcher
Director

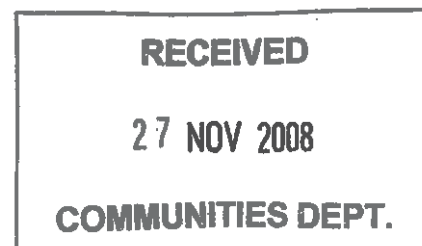

Statement and declaration of landowner as to admitted and denied highways

Highways Act 1980 section 31(6)

STATEMENT TO ACCOMPANY DEPOSIT OF MAP

To: Mr Eddie Brennan
Definitive Map Officer
Nottinghamshire County Council
Trent Bridge House
Fox House
West Bridgford
Nottingham NG2 6BJ

Land off Woodside Road, Burton Joyce, Nottingham

Langridge Homes Limited are registered owners with freehold title of the land shown edged red ("the Land") on the accompanying Map ("the Map").

Langridge Homes Limited deny that there are any public rights of way over the Land shown on the accompanying Map deposited by Langridge Homes Limited with Nottinghamshire County Council on 25 November 2008.

Date:

25/11/08

Signed on behalf of Langridge Homes Limited

-
PSP.EB.47I.IY.33
(0115) 977 4709
eddie.brennan@nottsc.gov.uk
20 November 2008

Mrs Jill Atkinson
Langridge Homes Ltd
17-21 Clumber Avenue
Sherwood Rise
Nottingham NG5 1AG

Dear Mrs Atkinson

LAND OFF WOODSIDE ROAD, BURTON JOYCE, NOTTINGHAM

I refer to your letter dated 17 November 2008, in respect of public rights of way over the above land.

I can confirm that there are no definitive public rights of way over the land shown outlined in red on your plan.

I would also point out that it is always possible that public rights could exist which have not yet been registered.

Yours sincerely

Eddie Brennan
Definitive Map Officer



Langridge Homes Limited
17 - 21 Clumber Avenue
Sherwood Rise
Nottingham NG5 1AG
TEL: 0115 962 6626
FAX: 0115 969 1340
E-MAIL Enquiries@Langridgehomes.com
www.Langridgehomes.com

Our ref JLA/LP03

17 November 2008

Mr E Brennan
Definitive Map Officer
Nottinghamshire County Council
Trent Bridge House
Fox Road
West Bridgford
Nottingham
NG2 6BJ



Dear Mr Brennan

Land off Woodside Road, Burton Joyce, Nottingham

I enclose herewith a plan of land which we own at Burton Joyce.

Would you please mark the plan with any public footpaths and bridleways which run through our land and return it to me.

If you have any queries please do not hesitate to contact me.

Yours sincerely
p.p. Langridge Homes Limited

.....
Mrs Jill Atkinson

The boundaries shown by dotted lines have been plotted from the plans on the deeds. The title plan may be updated from later survey information

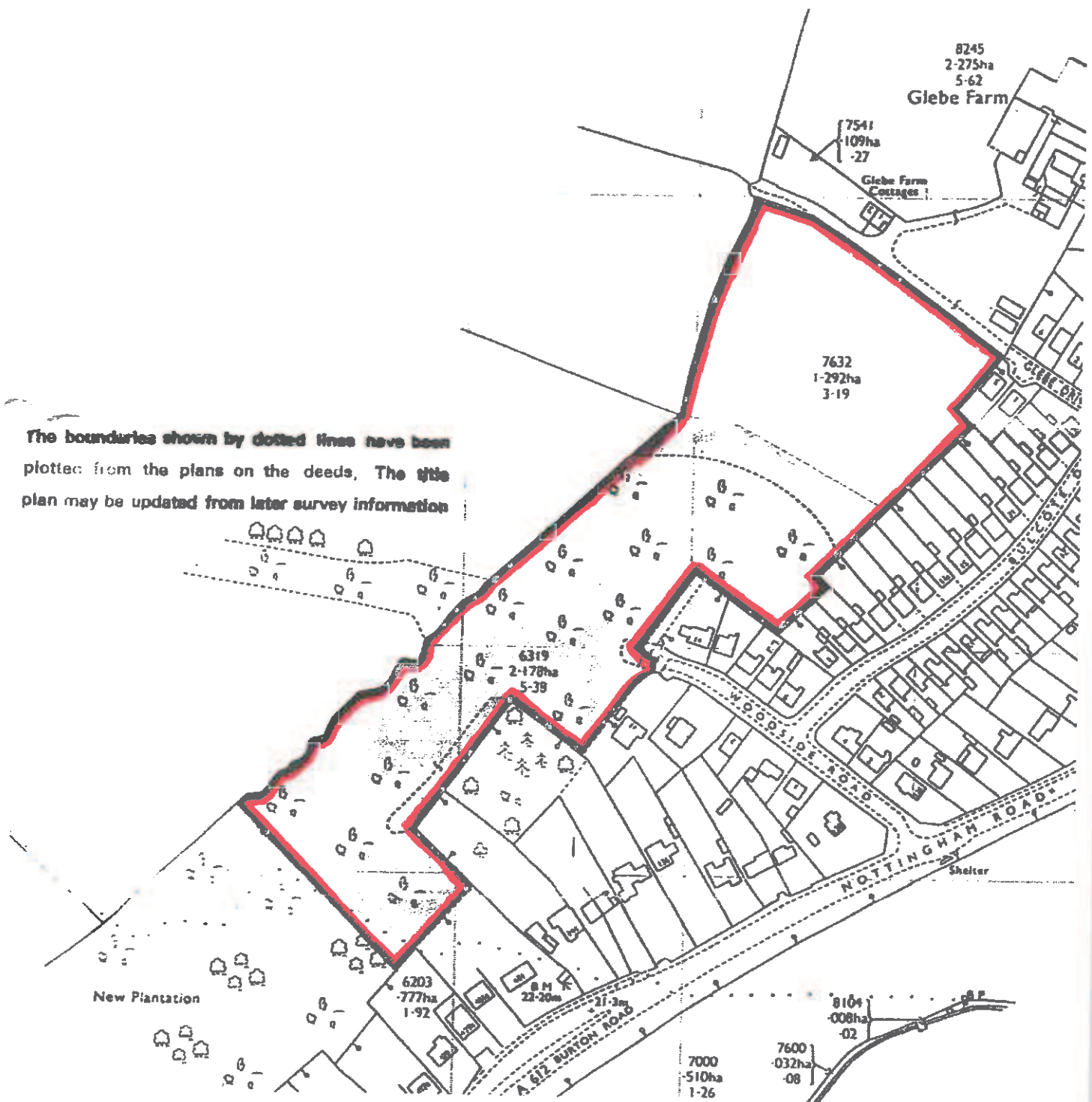

This OFFICE COPY shows the state of the title plan on 2 July 1999 and is admissible in evidence to the same extent as the original. This office copy of the title plan may be subject to minor distortions in scale.
Issued on 5 July 1999 by the Nottingham (East) District Land Registry
Crown copyright. Produced by HMLR. Further reproduction in whole or part is prohibited without the prior written permission of Ordnance Survey. Licence number GD272728.