

PSP.EB/RH5
(0115) 977 4709
eddie.brennan@nottscc.gov.uk
10 November 2008

405

Mrs Jill Atkinson
Torkard Construction Ltd
17-21 Clumber Avenue
Sherwood Rise
Nottingham NG5 1AG

Dear Mrs Atkinson

**NOTTINGHAMSHIRE COUNTY COUNCIL
DEPOSIT OF STATEMENT – SECTION 31(6) OF THE HIGHWAYS ACT 1980
PARISH: LAND AT WESTHOUSE FARM, BESTWOOD
LANDOWNER: TORKARD CONSTRUCTION COMPANY LTD**

I wish to acknowledge the receipt of your deposited statement for the above named area on 7 November 2008.

It will be necessary for you or your successors to submit a statutory declaration within ten years. The declaration should also be renewed every ten years commencing from the date of the initial statutory declaration.

Any changes to your land holding or to the rights of way information in your initial statement and plan should be notified to the Countryside Access Section.

Yours sincerely

Eddie Brennan
Definitive Map Officer

405

TORKARD CONSTRUCTION

Torkard Construction Co. Ltd.

17 - 21 Clumber Avenue

Sherwood Rise

Nottingham NG5 1AG

TEL: 0115 962 6626

FAX: 0115 969 1340

Our ref JLA/TP01

4 November 2008

Mr E Brennan
Definitive Map Officer
Nottinghamshire County Council
Trent Bridge House
Fox Road
West Bridgford
Nottingham
NG2 6BJ



Dear Mr Brennan

Land at Westhouse Farm, off Moor Road, Bestwood, Nottingham

I enclose herewith a Statement and Declaration along with a plan showing details of land that we own at Bestwood.

I would be grateful if you would acknowledge safe receipt of the same.

Yours sincerely
p.p. Torkard Construction Co Ltd

.....
Mrs Jill Atkinson
Director

Statement and declaration of landowner as to admitted and denied highways

Highways Act 1980 section 31(6)

STATEMENT TO ACCOMPANY DEPOSIT OF MAP

To: Mr Eddie Brennan
Definitive Map Officer
Nottinghamshire County Council
Trent Bridge House
Fox Road
West Bridgford
Nottingham NG2 6BJ

Land at Westhouse Farm, off Moor Road, Bestwood, Nottingham

Torkard Construction Company Limited are registered owners with freehold title of the land shown edged red ("the Land") on the accompanying Map ("the Map").

Torkard Construction Company Limited admit that the ways described below and shown on the accompanying Map deposited by Torkard Construction Company Limited with Nottinghamshire County Council on 4 November 2008 and coloured brown have been dedicated as highways.

A way for persons on foot only, beginning at Moor Road and Cobblers Hill Farm and ending at the north eastern boundary near Crimea Plantation.

Torkard Construction Company Limited deny that there are any other Public Rights of Way over the Land.

Date: 4-11-08

[Redacted signature area]

.....
Signed on behalf of Torkard Construction Company Limited

H.M. LAND REGISTRY		TITLE NUMBER NT 320750	
ORDNANCE SURVEY PLAN REFERENCE	SK5547 SK5548 SK5647 SK5648	SECTION	Scale 1:2500
COUNTY	NOTTINGHAMSHIRE	DISTRICT	GEDLING

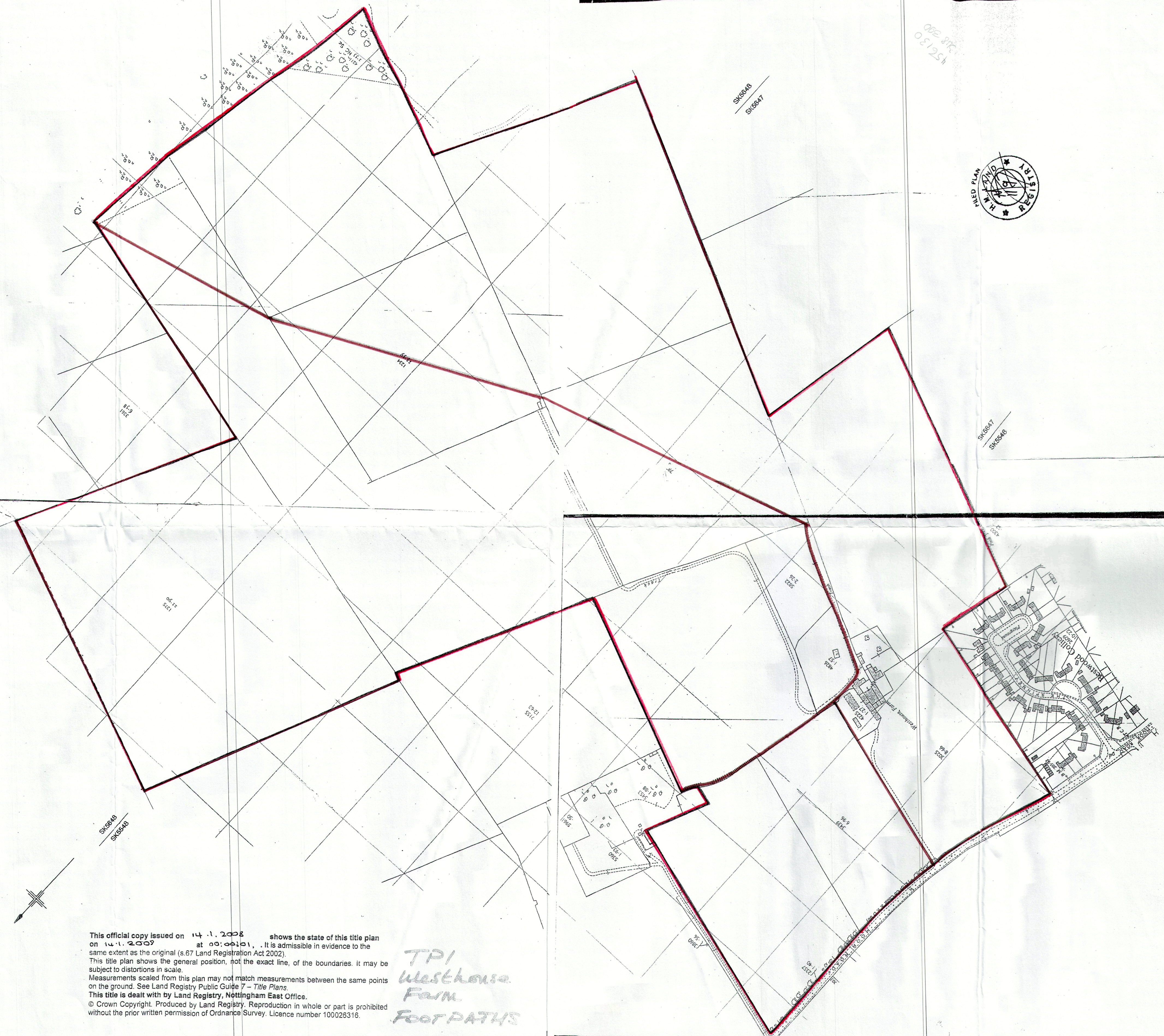

This official copy issued on 14.1.2008 shows the state of this title plan on 14.1.2007 at 00:00:01. It is admissible in evidence to the same extent as the original (s.67 Land Registration Act 2002). This title plan shows the general position, not the exact line, of the boundaries. It may be subject to distortions in scale. Measurements scaled from this plan may not match measurements between the same points on the ground. See Land Registry Public Guide 7 - Title Plans. This title is dealt with by Land Registry, Nottingham East Office.

*TPI
Westhouse
Farm
FOOTPATHS*

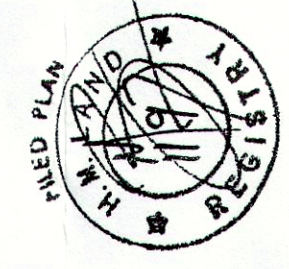

NT 320750

SK5548
SK5547

SK5547
SK5648

SK5548
SK5648

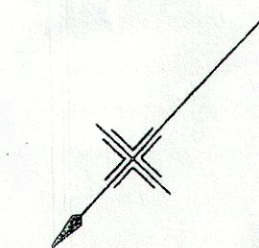

NT 320750