

-
H.0011L
0115 977 4709
eddie.brennan@nottscc.gov.uk
23 March 2012

Mr Robert Knowles
Mellish Rugby Club
Mapperley Plains
Nottingham
NG3 5RX

Dear Sir

**NOTTINGHAMSHIRE COUNTY COUNCIL: DEPOSIT OF STATEMENT PLAN
AND STATUTORY DECLARATION - SECTION 31(6) HIGHWAYS ACT 1980
PARISH: ARNOLD
NAME OF PROPERTY: MELLISH RUGBY CLUB**

I wish to acknowledge the receipt of your Statutory Declaration on 16 March 2012.

The information contained in the Declaration will be held by this Authority as validation for the contents of the relevant Statement and Plan. It will be necessary for you or your successors to renew the Statutory Declaration every ten years

Any changes to your land holding or the rights of way information in your initial Statement and Plan should be notified to the Countryside Access Section, and should also be identified with a new Statutory Declaration covering a modified Statement and Plan.

Yours faithfully

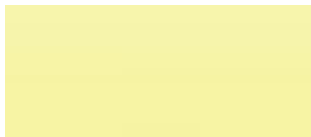
A rectangular area of the document is redacted with a solid yellow color, obscuring the signature of Eddie Brennan.

Eddie Brennan
Definitive Map Officer

NOTTINGHAMSHIRE COUNTY COUNCIL

STATUTORY DECLARATION

SECTION 31 (6) OF THE HIGHWAYS ACT 1980

TJDB { I ROBERT KNOWLES [Full Name] DO SOLEMNLY AND SINCERELY DECLARE as follows:

1. I am and have been since 7 DEC 1984 [day, month, year] the owner of the land known as MELUSH RUGBY CLUB, ANNOVA [farm name, field no. etc] more particularly delineated on the plan accompanying this declaration and thereon edged red.

2. On the 28 day of APRIL [month][year] I 2000 [ROBERT KNOWLES full name] deposited with Nottinghamshire County Council, being the appropriate Council, a statement accompanied by a plan delineating my property by red edging which stated that

~~*[the ways shown coloured orange or marked with a  on the said plan and on the plan accompanying this declaration are definitive or dedicated BYWAYS OPEN TO ALL TRAFFIC (B.O.A.T.S.)]~~

~~*[the ways shown coloured blue or marked with a  on the said plan and on the plan accompanying this declaration are definitive or dedicated RESTRICTED BYWAYS]~~

~~*[the ways shown coloured green or marked with a  on the said plan and on the plan accompanying this declaration are definitive or dedicated as BRIDLEWAYS]~~

~~*[the ways shown coloured purple or marked with a  on the said plan and on the plan accompanying this declaration are definitive or dedicated FOOTPATHS]~~

*[There are no definitive or dedicated Rights of Way over my property.]

TJDB { 3. With reference to 2 above, I ROBERT KNOWLES [full name] confirm that there are no additional public ways over the land edged red on the Plan and in the Statement dated 28 APRIL 00 [day, month, year] ~~(other than those definitive routes and dedicated routes marked on the Plan accompanying this Declaration).~~

* Delete as appropriate.

AND I MAKE this solemn declaration of the 16th day of March 2012 [month, year] conscientiously believing it to be true and by virtue of the Statutory Declarations Act 1835.

Robert Knowles
[Signature of landowner]

Declared at [address] Rowell House
Tudor Square
West Bridgford
Nottingham

Before me Schuster

[Commissioner of the Peace or Solicitor] Schuster
Team JD Brodie



MELLISH RFC
MAPPERLEY PLAINS
NG3 5RX



EPE.TH/SM3
Mr T Hart
(0115) 977 4395
(0115) 977 2414
5 June 2000

Bob Knowles
Rights of Way

Dear Sir/Madam

**NOTTINGHAMSHIRE COUNTY COUNCIL
DEPOSIT OF STATEMENT AND PLAN AND STATUTORY DECLARATION -
SECTION 31(6) OF THE HIGHWAYS ACT 1980**

**PARISH: ARNOLD
NAME OF LANDOWNER: MELLISH RFC
NAME OF PROPERTY: MELLISH RFC GROUND**

I wish to acknowledge the receipt of your deposited Statement and Plan and Statutory Declaration on 28 April 2000.

The information contained in the Declaration will be held by this Authority as validation for the contents of the Statement and Plan. It will be necessary for you or your successors to renew the Statutory Declaration every six years, commencing from the date of the initial Statutory Declaration.

Any changes to your land holding or to the rights of way information in your initial Statement and Plan should be notified to the Rights of Way section, and should also be identified within a new Statutory Declaration covering a modified Statement and Plan.

Yours sincerely

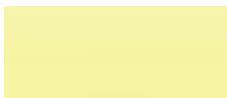

Tim Hart
Senior Definitive Map Officer

NOTTINGHAMSHIRE COUNTY COUNCIL

STATUTORY DECLARATION

SECTION 31 (6) OF THE HIGHWAYS ACT 1980

ROBERT KNOWLES

I DO SOLEMNLY AND SINCERELY DECLARE as follows:
[Full Name]

1. I am and have been since 7 DEC 1984 the owner of the land known as MELLISH
RFC [day, month, year]
..... more particularly delineated on the plan accompanying this declaration
[name of farm, etc]
and thereon edged red. APRIL

2. On the 28 day of MAY 2000, ROBERT KNOWLES
[month][year] [Full Name] deposited with
Nottinghamshire County Council, being the appropriate Council, a statement accompanied by
a plan delineating my property by red edging which stated that ~~*[the ways coloured orange on
the said plan and on the plan accompanying this declaration are definitive or dedicated
BYWAYS OPEN TO ALL TRAFFIC (B.O.A.T.s)]~~ ~~*[the ways indicated by brown dashes on the
said plan and on the plan accompanying this declaration are definitive ROADS USED AS
PUBLIC PATHS (R.U.P.P.s)]~~ ~~*[the ways coloured green on the said plan and on the plan
accompanying this declaration are definitive or dedicated as BRIDLEWAYS]~~ ~~*[the ways
coloured purple on the said plan and on the plan accompanying this declaration are definitive
or dedicated FOOTPATHS]~~ * [There are no definitive or dedicated Rights of Way over my
property.]

3. With reference to 2 above, I ROBERT KNOWLES
[Full name] confirm that there are no additional public
ways over the land edged red on the Plan and in the Statement dated 28 APRIL 2000
[day, month, year]
~~(other than these definitive routes coloured yellow and those dedicated routes coloured by
yellow dashes and marked *(byway) *(bridleway) *(footpath) on the Plan accompanying this
Declaration).~~

* Delete as appropriate.

AND I MAKE this solemn declaration of the 28 day of APRIL 2000 conscientiously
[Month, Year]
believing it to be true and by virtue of the Statutory Declarations Act 1835.

Declared at [address] 21, Parkdale Rd. [signature of landowner]
Bakerfield, Nottm.

Before me

[Redacted signature area] J.P.)

[Commissioner of Oaths or a Justice of the Peace or Solicitor]

NOTTINGHAMSHIRE COUNTY COUNCIL

DEPOSIT OF STATEMENT AND PLAN

SECTION 31 (6) OF THE HIGHWAYS ACT 1980

To

1. I am and have been since 7 DEC 1984 the owner within the meaning of the [day, month, year] above section of the land known as MELLISH REC more particularly delineated [Name of Farm, etc] on the attached plan accompanying this statement and thereon edged red.
2. The aforementioned land lies in the Parishes/Communities of [ARNOLD] and [REDUNG BORO].
- ~~3. The ways coloured orange on the said plan appear on the Definitive Map as BYWAYS OPEN TO ALL TRAFFIC (B.O.A.T.s).~~
- ~~4. The ways coloured by orange dashes on the said plan have been dedicated as BYWAYS OPEN TO ALL TRAFFIC (B.O.A.T.).~~
- ~~5. The ways coloured by brown dashes on the said plan appear on the Definitive Map as ROADS USED AS PUBLIC PATHS (R.U.P.P.s).~~
- ~~6. The ways coloured green on the said plan appear on the Definitive Map as BRIDLEWAYS.~~
- ~~7. The ways coloured by green dashes on the said plan have been dedicated as BRIDLEWAYS.~~
- ~~8. The ways coloured purple on the said plan appear on the Definitive Map as FOOTPATHS.~~
- ~~9. The ways coloured by purple dashes on the said plan have been dedicated as FOOTPATHS.~~
10. No other ways over the land have been dedicated as highways.
11. The deposit shall comprise this statement and accompanying plan.

Delete as applicable.

Signed (landowner)

Name (or landowner)

R. KNOWLES CLUB SECRETARY

Address

20 SPRING LANE, LAMBLEY, NOTTS NG4 4PH

Date

28/4/2000

Signed (Witness)

Name (of witness)

CHARLES ROBINSON CLUB CHAIRMAN

Address

97 CANTON ROAD, GEDDINGTON, NOTTS NG4 6EN

Occupation

MANAGER OF DISTRICT

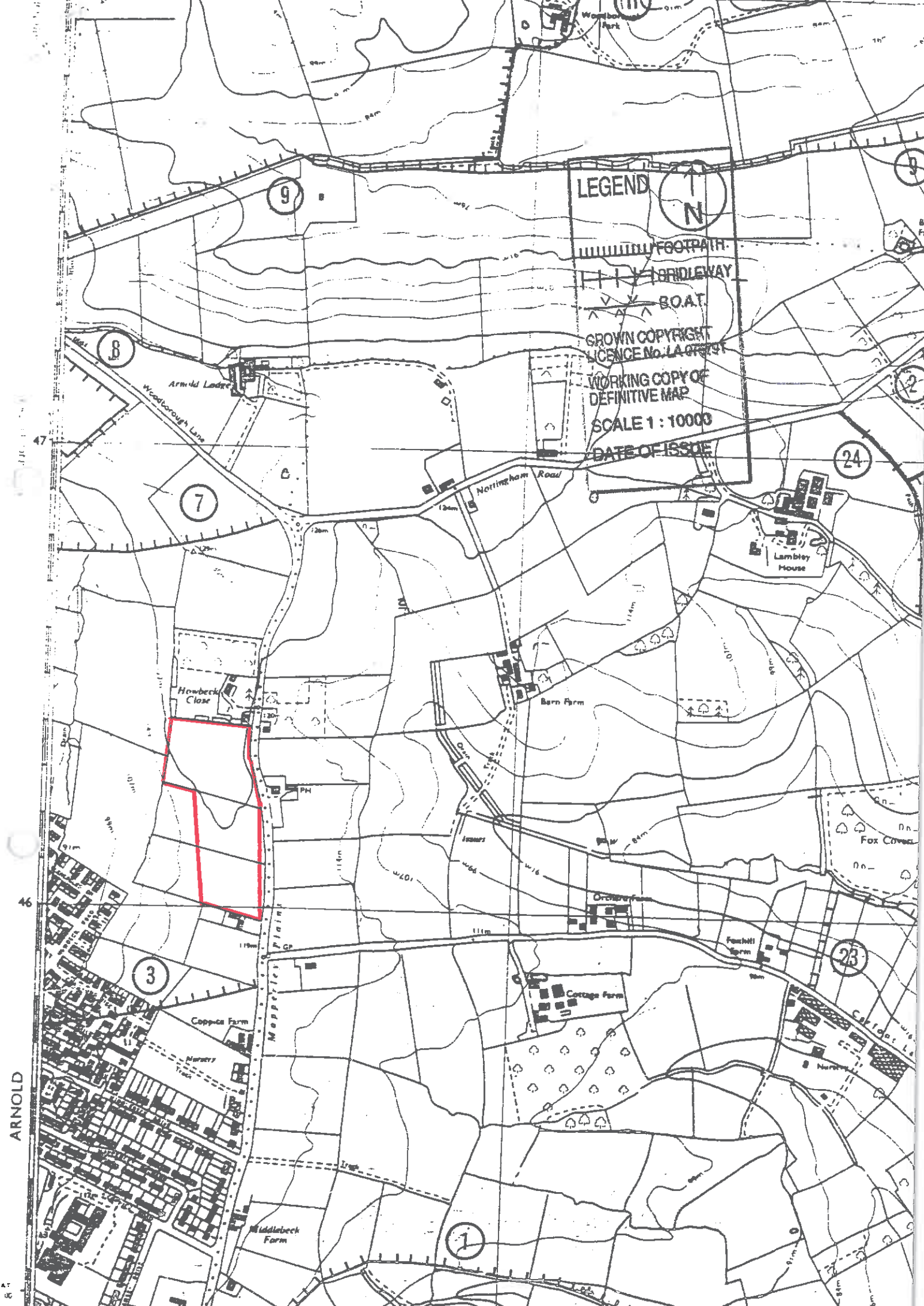

LEGEND



FOOTPATH

BRIDLEWAY

BOAT

CROWN COPYRIGHT

LICENCE No. LA 078751

WORKING COPY OF

DEFINITIVE MAP

SCALE 1 : 10000

DATE OF ISSUE

ARNOLD

46

47

1

3

7

9

1

23

24

2

3

10