

- 1. Do not under the drawing. For any details see the drawing.
- 2. The drawings to be used in connection with all construction works shall be approved by the Council.
- 3. All drawings to be used in connection with all construction works shall be approved by the Council.
- 4. All drawings are shown in reference unless otherwise noted, all work shall be done in accordance with the approved drawings.
- 5. All work shall be done in accordance with the approved drawings.
- 6. All work shall be done in accordance with the approved drawings.
- 7. All work shall be done in accordance with the approved drawings.
- 8. All work shall be done in accordance with the approved drawings.
- 9. All work shall be done in accordance with the approved drawings.
- 10. All work shall be done in accordance with the approved drawings.
- 11. All work shall be done in accordance with the approved drawings.
- 12. All work shall be done in accordance with the approved drawings.
- 13. All work shall be done in accordance with the approved drawings.
- 14. All work shall be done in accordance with the approved drawings.
- 15. All work shall be done in accordance with the approved drawings.



Specialist performance data to be included in the tender documents and submitted with the tender.

Land shall be reworked along side edge of proposed playing pitch area to ensure drainage to work.

DIRECTION OF UNDERLYING PITCH DRAINS

SHEEPWASH BROOK

MW Ref	Cover Level	Pipe Invert Level	MW Depth	MW Material	MW Size	MW Cover	Pipe Ref	Upstream I.L.	Downstream I.L.	Pipe Dia	Distance	Pipe Gradient 1:X	Pipe Material
31	54.000	52.200	0.800	Plastic (S)	400 N/C	D400	S1-S2	52.000	52.370	150	14.500	11.5	Perforated Plastic
32	53.800	52.370	1.430	Plastic (S)	400 N/C	D400	S2-S4	52.370	52.250	150	18.074	100.6	Perforated Plastic
33	53.800	52.329	1.356	Plastic (S)	400 N/C	D400	S3-S4	52.329	52.325	150	30.671	100.3	Perforated Plastic
34	53.000	52.250	0.750	Plastic (S)	400 N/C	D400	S4-S5	52.250	52.008	150	26.000	132.1	Perforated Plastic
35	52.800	52.058	0.742	Plastic (S)	400 N/C	D400	S5-Enveloping Culch	52.058	52.000	150	3.777	100.2	Perforated Plastic

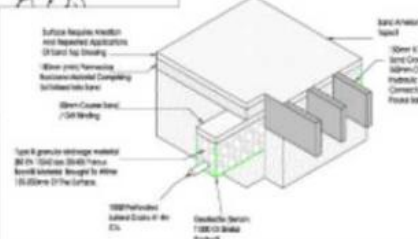
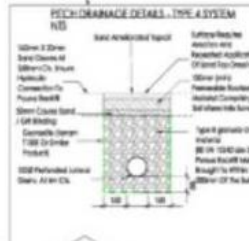
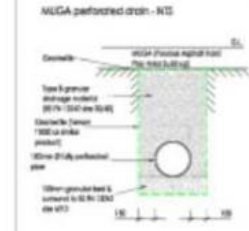
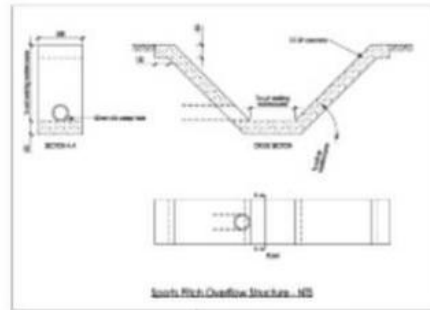

Notwithstanding to the above, the contractor shall be responsible for the construction of the drainage system in accordance with the approved drawings.

Key

- 300mm x 60mm x 15mm gullies
- 100mm x 60mm x 15mm gullies
- 100mm x 60mm x 15mm gullies
- 100mm x 60mm x 15mm gullies
- 100mm x 60mm x 15mm gullies

Item	Description	QTY	UNIT	DATE
1	Perforated drain (NUGA)	15	M	2024/02/22
2	Perforated drain (NUGA)	15	M	2024/02/22
3	Perforated drain (NUGA)	15	M	2024/02/22
4	Perforated drain (NUGA)	15	M	2024/02/22
5	Perforated drain (NUGA)	15	M	2024/02/22
6	Perforated drain (NUGA)	15	M	2024/02/22
7	Perforated drain (NUGA)	15	M	2024/02/22
8	Perforated drain (NUGA)	15	M	2024/02/22
9	Perforated drain (NUGA)	15	M	2024/02/22
10	Perforated drain (NUGA)	15	M	2024/02/22

Design and Construction Details

Design and Construction Details

Design and Construction Details

Design and Construction Details

Design and Construction Details

Design and Construction Details

Design and Construction Details

