

Primary	Client	Design	Drawn	Checked	Auth'd	Date
Client Approval	Fire Precautions	Health and Safety	Author	Rev	Rev	Rev
Planning	Pre-Text	Contract				

This drawing should be read in conjunction with all other design information, drawings and documents including all other design consultants requirements including structural, mechanical, electrical.

All dimensions to be verified on site. Figure dimensions to take preference to those scaled. This drawing is Copyright. The drawing is issued on the condition that it is not copied, reproduced, released or disclosed to any unauthorised person, either wholly or in part, without consent in writing.

This map is a drawing based on Ordnance Survey material with the permission of Ordnance Survey on behalf of the Controller of Her Majesty's Stationery Office. © Crown copyright. Unauthorised reproduction of this map is prohibited and may lead to prosecution or civil proceedings. (Nottinghamshire County Council) Licence No. 100019713

Health and Safety Information

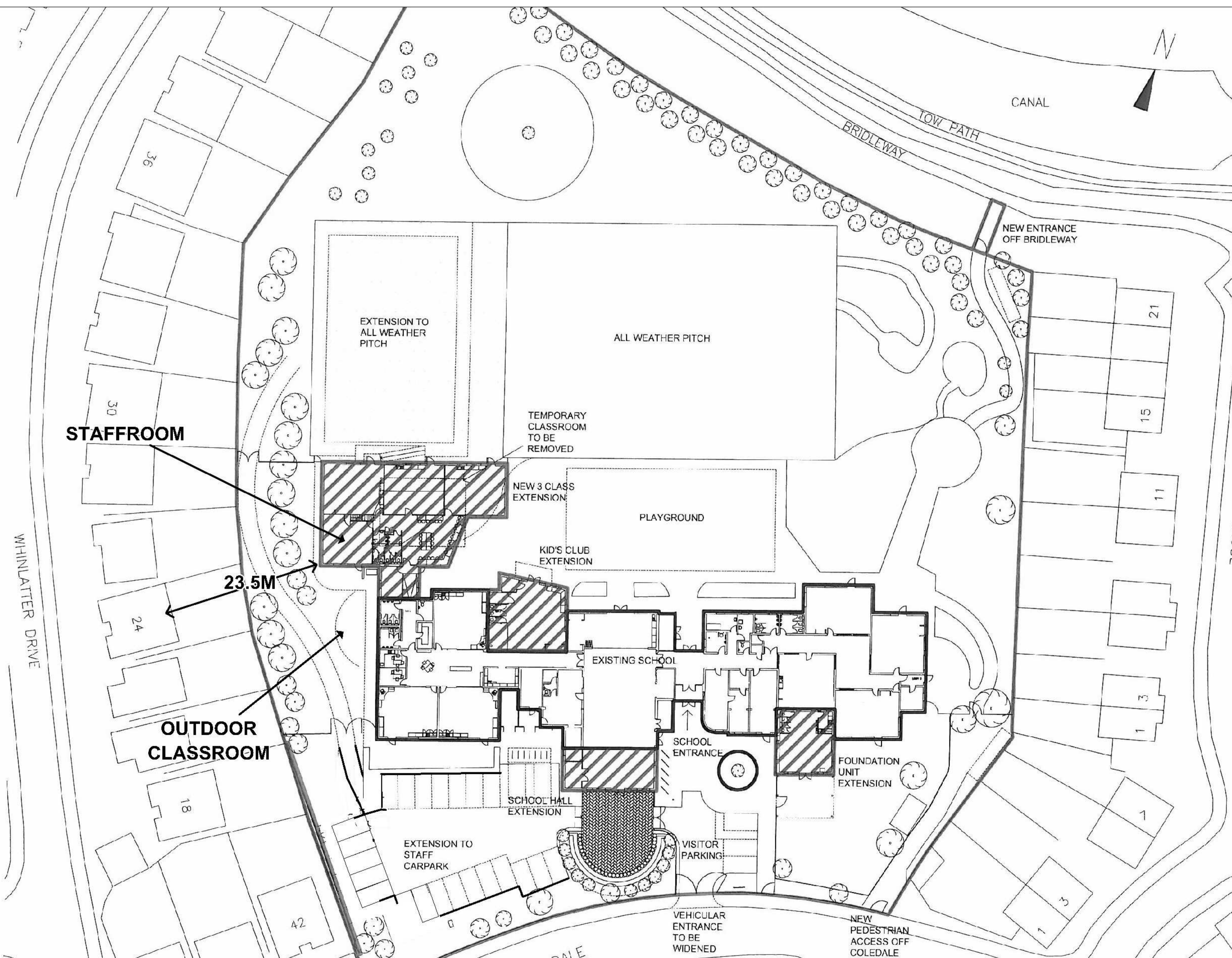

RECEIVED  
- 6 SEP 2013  
P.P. & C.S.

Rev	Description	Drawn	Ch'kd	Auth'd	Date
Project: GAMSTON PIERREPONT PRIMARY SCHOOL 3 CLASS EXTENSION					
Property No.	Project No. 27184				
Title: SITE OVERVIEW					
Scale for A1 drawing	Drawn	RP	Date 4-9-13		
1:250 @ A1	Ch'kd		Date		
1:500 @ A3	Auth		Trace		
Drawing No.	Rev.				
SK20					
FileName					

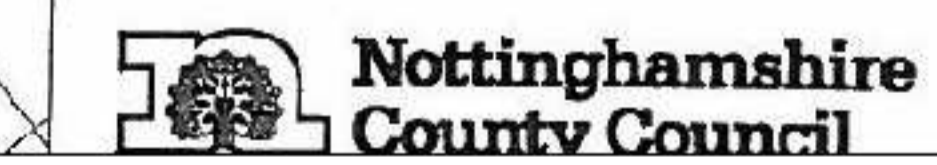

ERECTION OF 3-CLASSROOM, STAFFROOM AND LIBRARY EXTENSION. KIDS CLUB EXTENSION, HALL EXTENSION AND FOUNDATION 2 EXTENSION; EXTENSION TO CAR PARK AND WIDENING OF EXISTING VEHICULAR ACCESS, NEW PEDESTRIAN ACCESS FROM COLEDALE AND (CANAL) BRIDLEWAY; EXTENSION TO ALL WEATHER PITCH; NEW EXTERNAL METAL STORE AND NEW CYCLE SHELTERS; ASSOCIATED LANDSCAPE WORKS AND FENCING. PIERREPONT GAMSTON PRIMARY SCHOOL, COLEDALE, WEST BRIDGFORD. PLANNING APPLICATION NO. 8/13/01821/CTY

This map is reproduced from Ordnance Survey material with the permission of Ordnance Survey on behalf of the Controller of Her Majesty's Stationery Office © Crown copyright. Unauthorised reproduction infringes Crown copyright and may lead to prosecution or civil proceedings. (100019713) (2013)

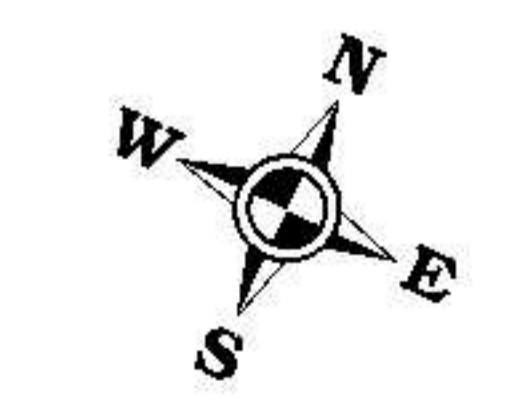

Not to Scale  
Produced by: JW  
Date: DEC 2013

PLAN 3