

Based upon the Ordnance Survey mapping with the permission of the Controller of Her Majesty's Stationery Office © Crown copyright. Unauthorized reproduction infringes Crown copyright and may lead to prosecution or civil proceedings. Licence No.: 100019713

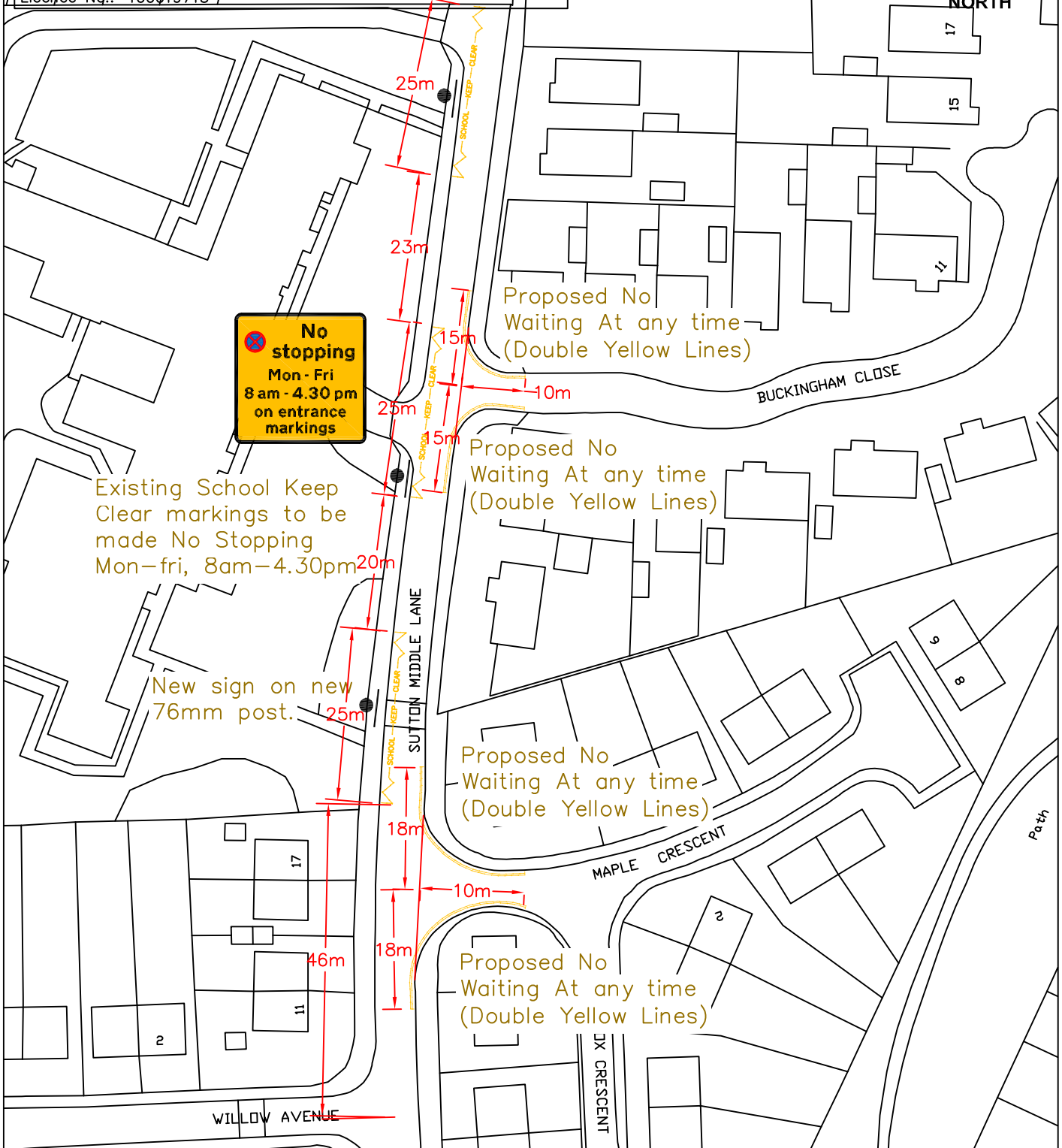
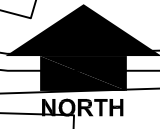

<p>Nottinghamshire County Council Trent Bridge House, Fox Road, West Bridgford, Nottingham, NG2 6BJ Tel: 0300 500 80 80</p>	Project		SCHOOL KEEP CLEARS Kirkby & Selston Area	Drawn	DAS	Date	29/07/14	
	Property No.	Project No.	REV102395	Chkd		Date		
	Title		Sutton Middle Lane Kirkby in Ashfield	Auth		Traced		
	Drawing No.		H/DAS/TRO4145/1	Scale		NTS		Rev