

**Tank Schedule**

#	Description	Dimensions
1	Stream One Coarse Screen Receiving Unit & Pump	w5m x l3m x h3m
2	Stream Two Coarse Screen Receiving Unit & Pump	w5m x l3m x h3m
3	Stream One Sludge Transfer Pump	
4	Stream One Oil/Water Separator	w2.5m x l2.1m x h3.1m
5	Stream One Oil IBC	w1m x l1m x h1m
6	Stream Two Lamella Clarifier	w2.5m x l2.1m x h3.1m
7	Sludge Transfer Pump	
8	Combined Sludge Tank	3m dia (conical bottom)
9	Tanker Filler Pump	
10	Pumps from Balance Tanks	
11	Stream One Balance Tank w/dedicated mixer	4.1m dia x h8m
12	Stream Two Balance Tank w/dedicated mixer	4.1m dia x h8m
13	Treated Water Balance Tank w/dedicated mixer	4.1m dia x h8m

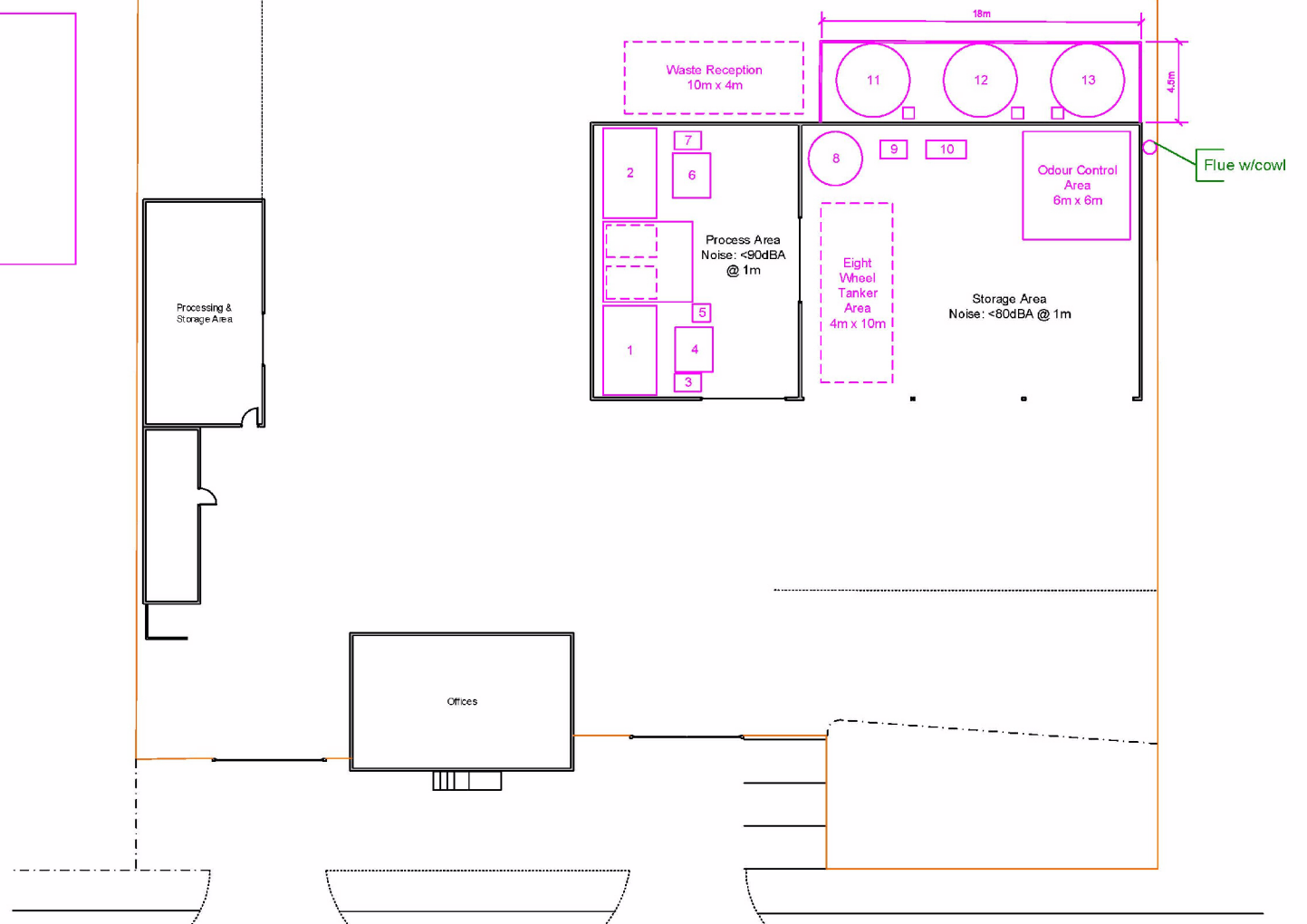

Erection of 3 external bunded storage tanks; new roller shutter doors; installation of internal plant/equipment including odour control unit with external flue; and variation of conditions 4, 5 (waste storage and treatment operations); 6 (to allow 24/7 access for vehicles); and removal of conditions 12 and 13 (permitted development restrictions) of planning permission 3/97/0654 to enable the site to treat domestic and commercial liquid wastes.  
 Eurotech Environmental Limited, Northern Road, Newark, Nottinghamshire.  
 Planning Application No. 17/00187/CMW

This map is reproduced from Ordnance Survey material with the permission of Ordnance Survey on behalf of the Controller of Her Majesty's Stationery Office © Crown copyright.  
 Unauthorised reproduction infringes Crown copyright and may lead to prosecution or civil proceedings. (1000019713) (2017)

