



D2N2: Plans for Growth

Mick Burrows

What's been achieved

- **Enterprise Zones**
 - NEZ and Markham Vale
- **Key sites**
 - Global Technology Cluster
- **Regional Growth Fund**
 - Grant scheme for business
- **Growing Places Fund**
 - £25m loan fund
- **Lobbying for investment**
 - Midland Mainline
- **Visitor Economy**
 - Elemental Force





D2N2 (draft) Growth Plan

- Plans for growth 2013-16
- Series of Business Breakfasts
- www.d2n2lep.org.uk
- Conference June 2013 at Pride Park

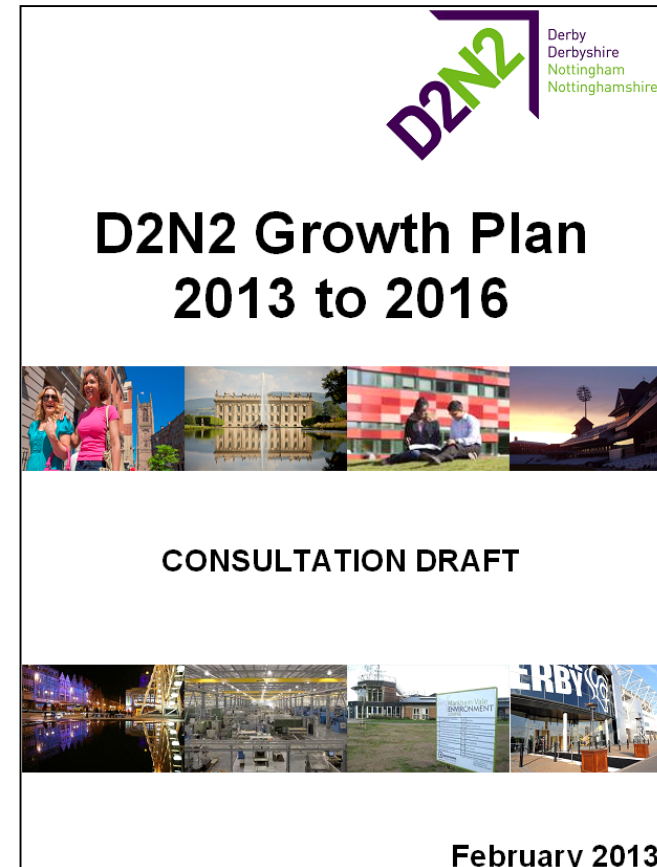

Strategic Framework

LEP Board

Our Purpose: To *enable* economic growth within the D2N2 area

Our Vision: Making the D2N2 area one of the *strongest and most resilient economic regions* in the UK

Our Ambition: To be one of the most respected LEP's, known for our *professionalism and effectiveness*.

Strategic Priorities – Supporting Enterprise

Business
Skills

Innovation

Finance

Infrastructure

Low
Carbon
Goods &
Services

Areas of Economic Focus

Transport
Equipment
Manufacturing

Medical/Bio-
Science

Food & Drink
Manufacturing

Construction

Visitor
Economy

Actions for Growth: Skills

- Skills Commission

- **Skills Plan**

- Skills for Growth
- Focus on Youth
- Low skills and unemployment

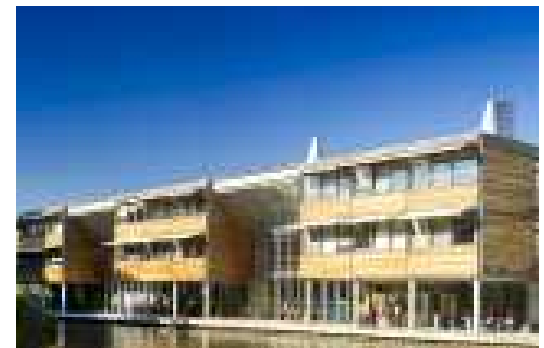
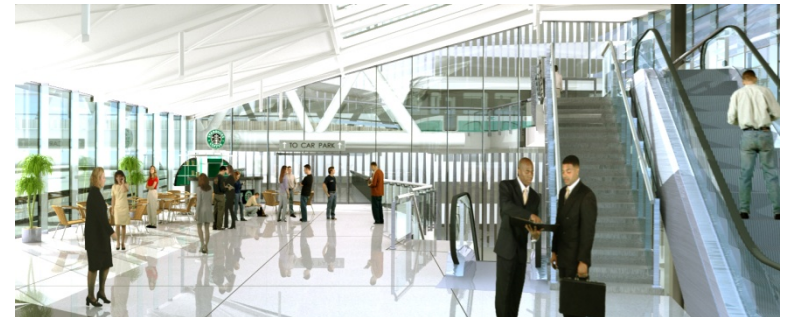

Actions for Growth: Innovation

- Innovation infrastructure
- Global Technology Cluster / Derby Innovation Campus
- Skills for Innovation
- R&D for Innovation
- Graduate talent
- Grants and Finance
- Innovation networks
- Innovation Observatory





Actions for Growth: Finance

- D2N2 Growing Places Fund - £25 million
 - Lindhurst
 - Rolls Royce Hucknall
- Unlocking Investment for Growth - £7 million grant pot
(*Regional Growth Fund*)
- EU Funding – 2014-20
- PWLB facility of up to £60 million
- Single Pot from 2015 onwards



Regional Growth Fund

Actions for Growth: Infrastructure

- Strategic Transport Priorities
- Enterprise Zones
- Local Major Transport Schemes
- Digital Connectivity





Actions for Growth: Areas of Focus

- Transport Equipment Manufacturing
 - Global Technology Cluster
- Medical Bioscience
 - Developing and attracting talent
- Food and Drink Manufacturing
 - Food grade workspace
- Construction
 - Procurement
- Visitor Economy
 - 'Anchor' attractions
- Low Carbon Goods and Services
 - Raise awareness of business and investment opportunities

Why is this important?

EU COMMON STRATEGIC FRAMEWORK FUNDS IN ENGLAND 2014-2020





County Council - implications

- Support and commitment to LEP
- Ensuring County interests represented
- County Growth Plan
- Clarifying Council remit – economic development - holistic approach
- Unified approach with Districts
- Resources – capacity and finance
- Dynamic - surrounding LEP areas