



DERBYSHIRE County Council  
 Corporate Resources Department  
 Corporate Property  
 Chatsworth Hall  
 Chesterfield Road  
 Matlock  
 Derbyshire DE4 3FW  
 Tel: 01629 560000  
 Fax: 01629 536296  
 e-mail: connect.connect@derbyshire.gov.uk  
 www.derbyshire.gov.uk



No.	Description	Date

Carnarvon Primary School,  
 Bingham, Notts.  
 2 Classroom CONNECT  
 block KS2  
 56 m2

Existing Site Survey  
 including proposed  
 2 classroom block

Project number: 1201402

Date: December 2012

Drawn by: \*\*\*

Checked by: \*\*

LS03

1st Drawing Sheet

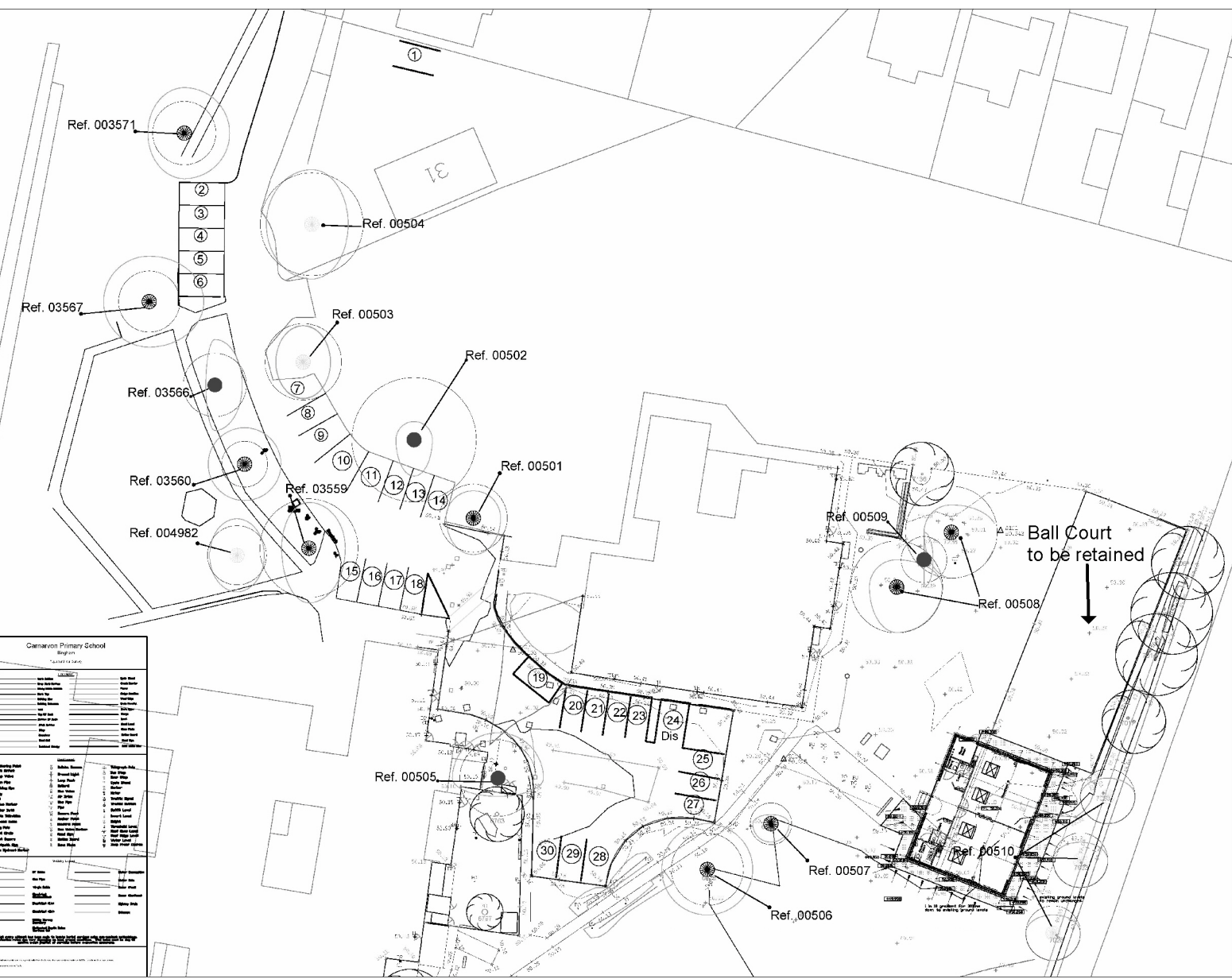

Carnarvon Primary School  
 Bingham

Category	Item	Status
Existing	Classroom Block	Existing
	Ball Court	Existing
	Play Area	Existing
	Site Boundary	Existing
	Access Points	Existing
	Public Footpath	Existing
	Water Features	Existing
	Electricity Mains	Existing
	Water Mains	Existing
	Gas Mains	Existing
Telephone Mains	Existing	
Proposed	Classroom Block (KS2)	Proposed
	Ball Court (Retention)	Proposed
	Play Area (Retention)	Proposed
	Site Boundary (New)	Proposed
	Access Points (New)	Proposed
	Public Footpath (New)	Proposed
	Water Features (New)	Proposed
	Electricity Mains (New)	Proposed
	Water Mains (New)	Proposed
	Gas Mains (New)	Proposed

Trent Bridge House, Fox Road  
 West Bridgford, Nottingham, NG2 6BJ  
**Nottinghamshire County Council**  
 Tel: 0115 982 3823

**Proposed erection of a two classroom stand alone building and the retention of the adjacent fenced ball court hard play area.**  
 Carnarvon Primary School, Nursery Road, Bingham, Notts.  
 Planning Application No. 8/13/00337/CTY

This map is reproduced from Ordnance Survey material with the permission of Ordnance Survey on behalf of the Controller of Her Majesty's Stationery Office © Crown copyright.  
 Unauthorised reproduction infringes Crown copyright and may lead to prosecution or civil proceedings. (1000019713) (2013)



Not to Scale  
 Produced by: JW  
 Date: APRIL 2013