

Information within this drawing is not necessarily produced to scale. Always use figured dimensions and co-ordinates - if in doubt, ask.

NOTES

New hedge to comprise

Hawthorn quicks approximately 600 mm tall-planted 7, minimum in a staggered row. (The best time to plant a hedge of this nature is in the bare root season, which starts approximately the end of November to mid April).

Rabbit guards and a cane for support will be provided to protect the plants.

Long-term maintenance would include a visit after the first growing season in the winter months to replace any quick's which may die, followed by a second visit after 4 years to lay the hedge which will then thicken and make on going maintenance easier.

The hedge would be allowed to grow through the existing picket fence, which will eliminate the need to replace the fence in the future.

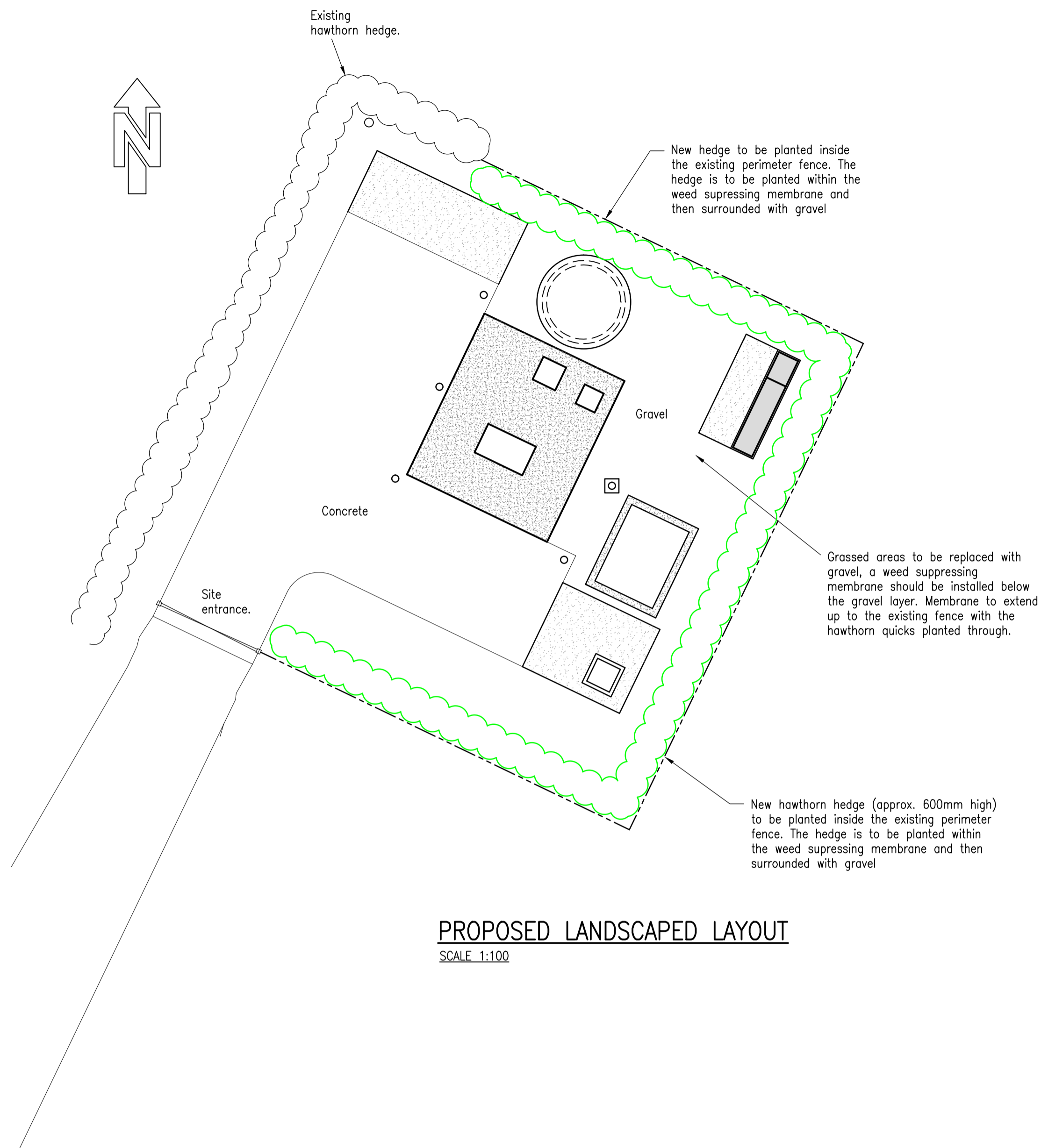

**PROPOSED LANDSCAPED LAYOUT**  
SCALE 1:100

A	First Issue.			
REV	DESCRIPTION	SIG	CHK	DATE

NMCNomenca

BOUGHTON, TUXFORD ROAD SPS

PROPOSED LANDSCAPED LAYOUT

**Eastwood & Partners**  
CONSULTING ENGINEERS

St. Andrew's House  
23 Kingfield Road  
Sheffield  
S11 9AS

Tel 0114 255 4554  
Fax 0114 255 4330

mail@eastwoodandpartners.com  
www.eastwoodandpartners.com



SCALE WHEN PLOTTED AT A1 1:100	DRAWING STATUS APPROVAL
-----------------------------------	----------------------------

DRAWN	CHECKED	DATE	DRAWING NUMBER	REV
CD	SRE	22-05-13	35221/104	A

SEVERN TRENT WATER DRAWING NUMBER

A5S/01233-CE-00104