

THE COMMON SEAL of THE  
NOTTINGHAMSHIRE COUNTY  
COUNCIL

Affix Seal:

was hereunto affixed this    day of  
September 2022 in the presence of: -

SEAL REGISTER NO:

Sign:

Authorised Signatory

LOWDHAM  
CRICKET  
CLUB

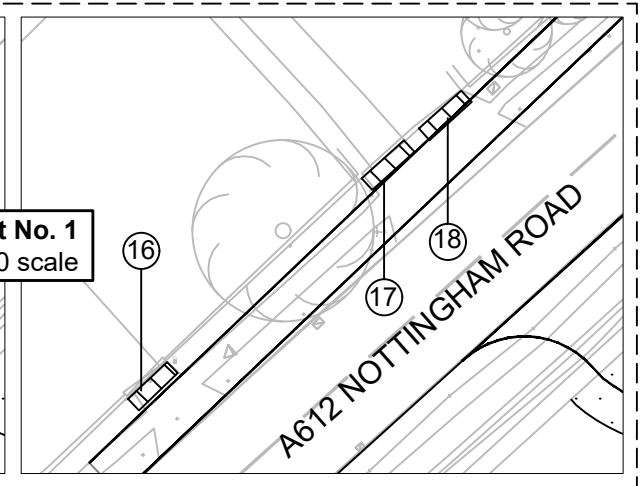
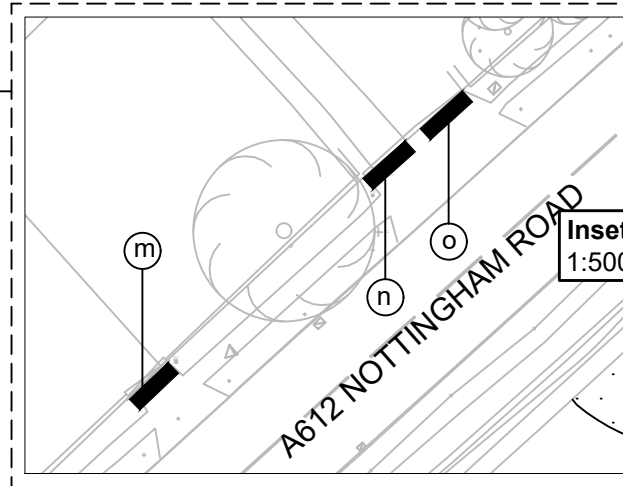
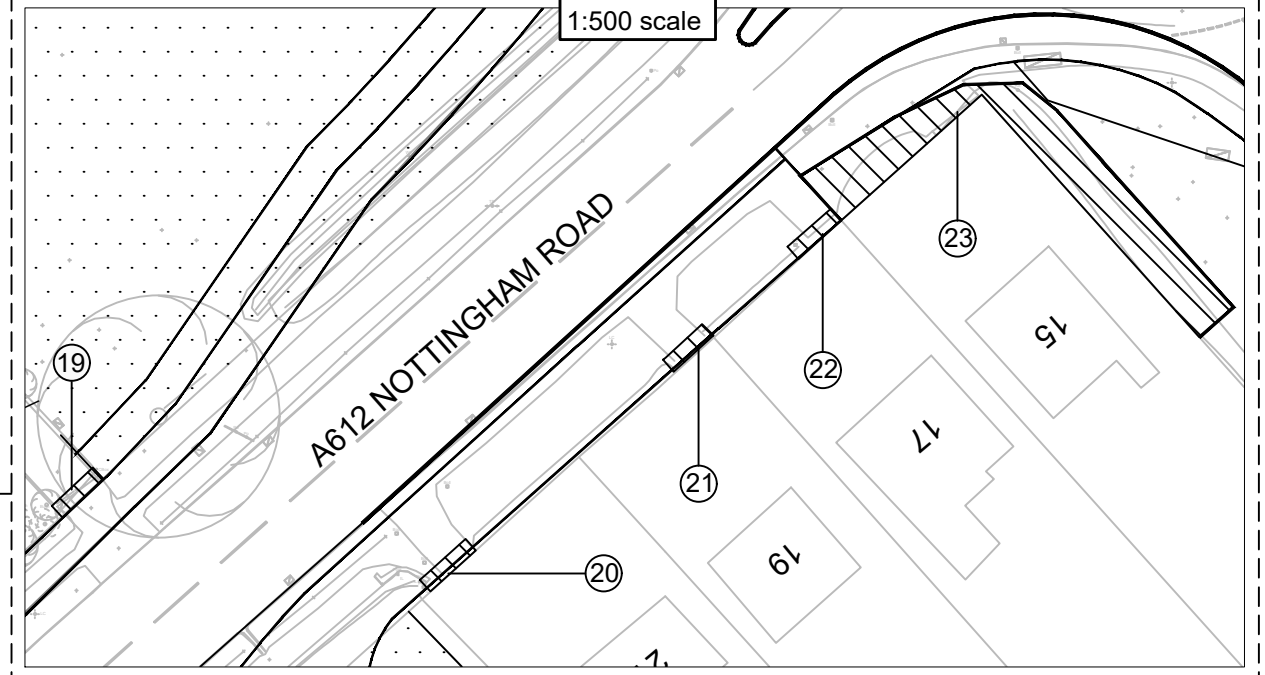
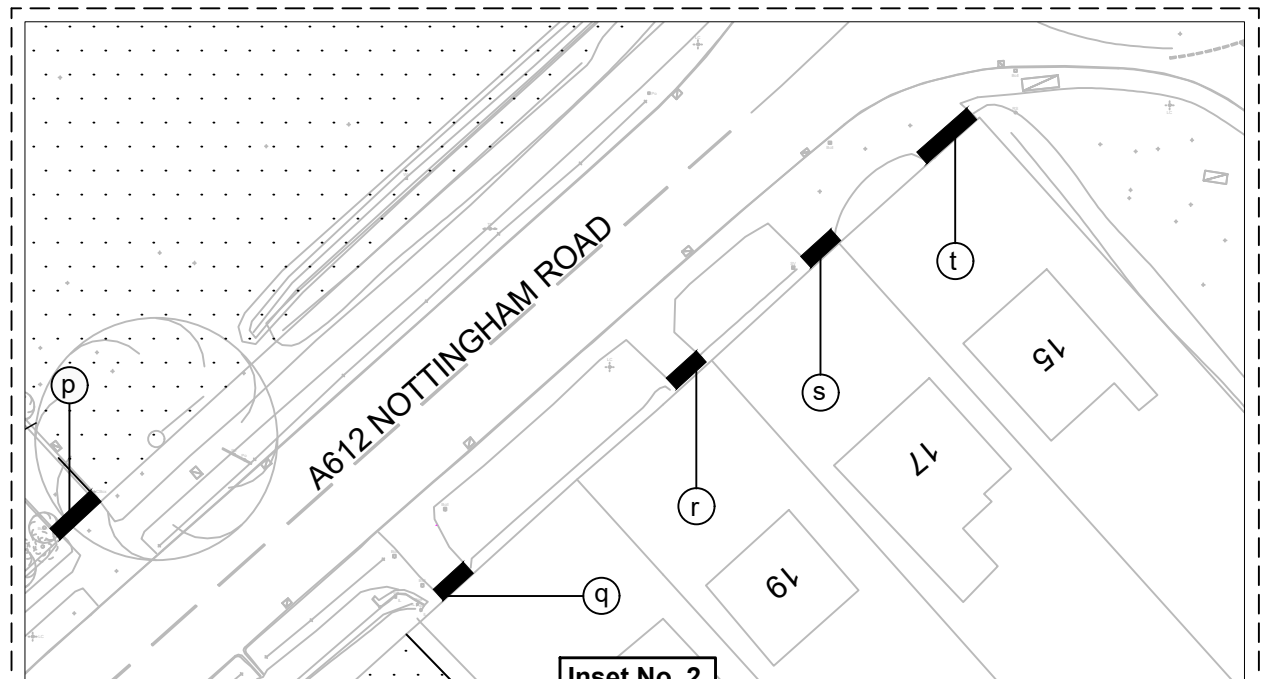
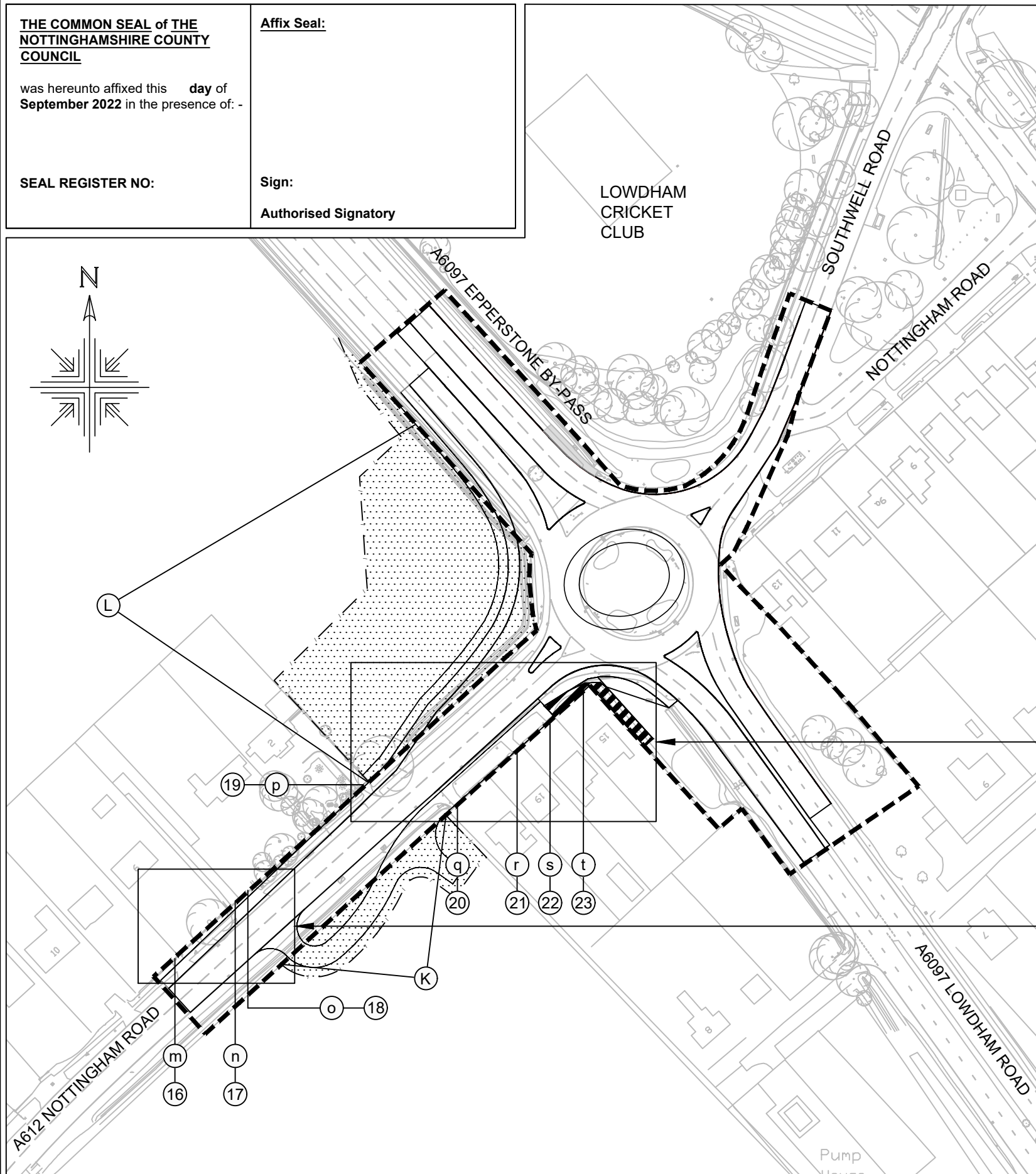
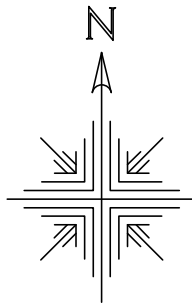

© Nottinghamshire County Council

This map is based upon Ordnance Survey material with the permission of Ordnance Survey on behalf of the Controller of Her Majesty's Stationary Office, © Crown copyright. Unauthorised reproduction infringes Crown copyright and may lead to prosecution or civil proceedings. Nottinghamshire County Council, License Number: 100019713, 2022

THE NOTTINGHAMSHIRE COUNTY COUNCIL  
(A614/A6097 JUNCTIONS IMPROVEMENT SCHEME)  
(SIDE ROADS) ORDER 2022

DRAWING REFERENCE:  
SITE PLAN 5 OF 6

LOWDHAM ROUNDABOUT IMPROVEMENTS  
SCALE 1:1,250 @ A3 UOS  
REV. A