

Map referred to in The Nottinghamshire County Council (Gedling Access Road) Compulsory Purchase Order 2018 - General Vesting Declaration 2

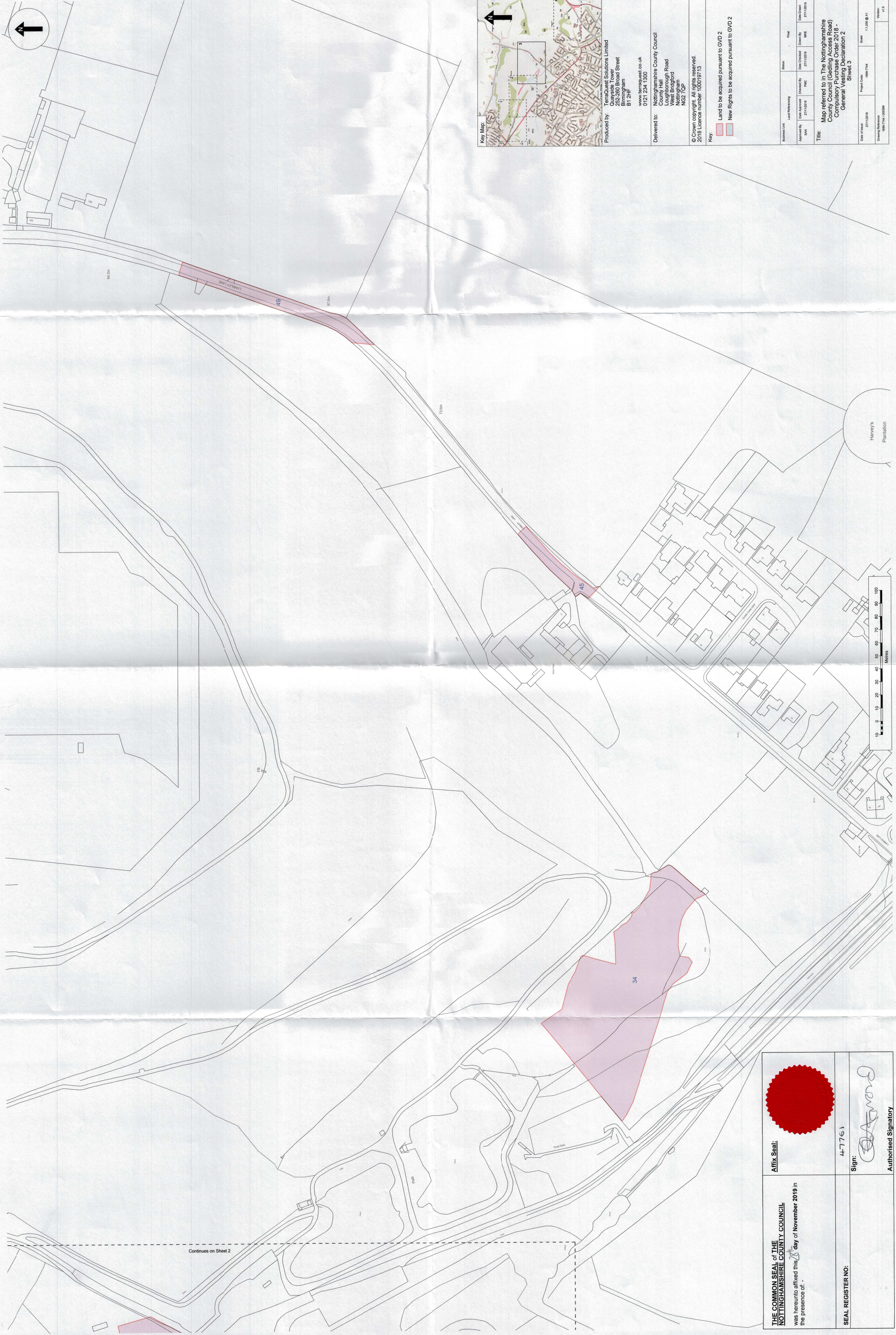

Key Map:

Produced by: TerraQuest Solutions Limited
 Quay West Tower
 100, Canal Street
 Birmingham
 B1 2HF
 www.terraquest.co.uk
 0121 234 1300

Delivered to: Nottinghamshire County Council
 County Hall
 Loughborough Road
 West Bridgford
 Nottingham
 NG2 7BP

© Crown copyright. All rights reserved.
 2018 Licence number 100018715

Key:

- Land to be acquired pursuant to GVD 2
- New Rights to be acquired pursuant to GVD 2

Business Unit:	Land Information	Map	Final
Approved By:	Date Approved:	Checked By:	Date Drawn:
SM	21/11/2018	PMC	21/11/2018
Title:		Map referred to in The Nottinghamshire County Council (Gedling Access Road) Compulsory Purchase Order 2018 - General Vesting Declaration 2 - Sheet 3	
Date of Issue:	Project Code:	Scale:	Version:
21/11/2018	8897314	1:1,250 @ A1	V1.0
Drawn Reference:	100018715/0008		

THE COMMON SEAL OF THE NOTTINGHAMSHIRE COUNTY COUNCIL
 was hereunto affixed this 28th day of November 2018 in the presence of: -

SEAL REGISTER NO: 4-7761

Affix Seal:

Sign:

Authorised Signatory

Continues on Sheet 2