



Nottinghamshire County Council
Environment Department

1093

7

APPLICATION FOR A MODIFICATION ORDER

WILDLIFE AND COUNTRYSIDE ACT 1981
NOTTINGHAMSHIRE DEFINITIVE MAP AND STATEMENT

To: NOTTINGHAMSHIRE COUNTY COUNCIL
RIGHTS OF WAY SECTION
ENVIRONMENT DEPARTMENT
TRENT BRIDGE HOUSE
FOX ROAD
WEST BRIDGFORD
NOTTINGHAM NG2 6BJ

I/We, Chris Thompson of Rumblers Assoc (Notts Area)
21 spindle View Calverton Notts NG14 6HF hereby apply for an order
under Section 53(2) of the Wildlife and Countryside Act 1981 modifying the Nottinghamshire Definitive Map and
Statement for the District of Passenham by

*1. deleting the route known as _____
_____ and running from

to _____

*2. Adding the (footpath) (~~bridleway~~) (~~byway open to all traffic~~) situated in the Parish/Town of Marnham
and running from Fledborough Sp 780779
to Marnham Road Sk 77705

*3. (upgrading) (downgrading) to a (footpath) (~~bridleway~~) (~~byway open to all traffic~~) the route known as _____
and running from _____ to _____

*4. (varying) (adding to) the particulars relating to the route known as _____
and running from _____

to _____

by _____

and shown on the map annexed hereto.

Please complete the appropriate section.

I/We attach copies and list below the following documentary evidence (including statements of witness(es)) in support of this application.

DOCUMENTS

0.5 6" map 20NW (1887)

Deposited documents, Lincs, Derby E coast railway (1891)

Finance Act map 20.6 (1900)

Dated 10th August 2012

Signed _____

DARLTON



**Nottinghamshire
County Council**



**Nottinghamshire
County Council**



**Nottinghamshire
County Council**



**Nottinghamshire
County Council**



**Nottinghamshire
County Council**



**Nottinghamshire
County Council**



**Nottinghamshire
County Council**



**Nottinghamshire
County Council**

Scale - Six Inches to One Mile

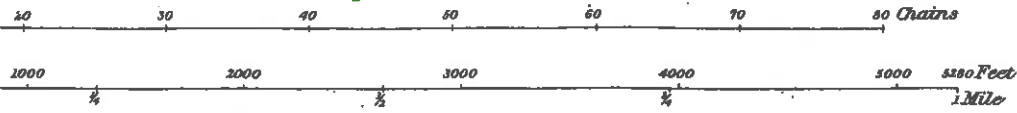

N.B. - The representation on this map of a Road, Track, or Footpath is no evidence of the existence of a right of way.

Levels.

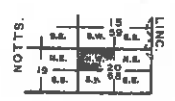

30"

XX.N.E.

FLEDBOROUGH PH.

LAT. 53° 14'

30"

