

PROPOSED

- INTERNAL HALLS PROVISION 284M²
- SOFT GAMES PITCHES 3962M²
- INFORMAL HARD PLAY 852M² EXCL REMOVE TR
HARD PITCHES
- HARD SURFACE GAMES COURTS 863M²
- NURSERY & EARLY YEARS PLAY (184M² -
50M² ADDITIONAL ADDED IN 2015)

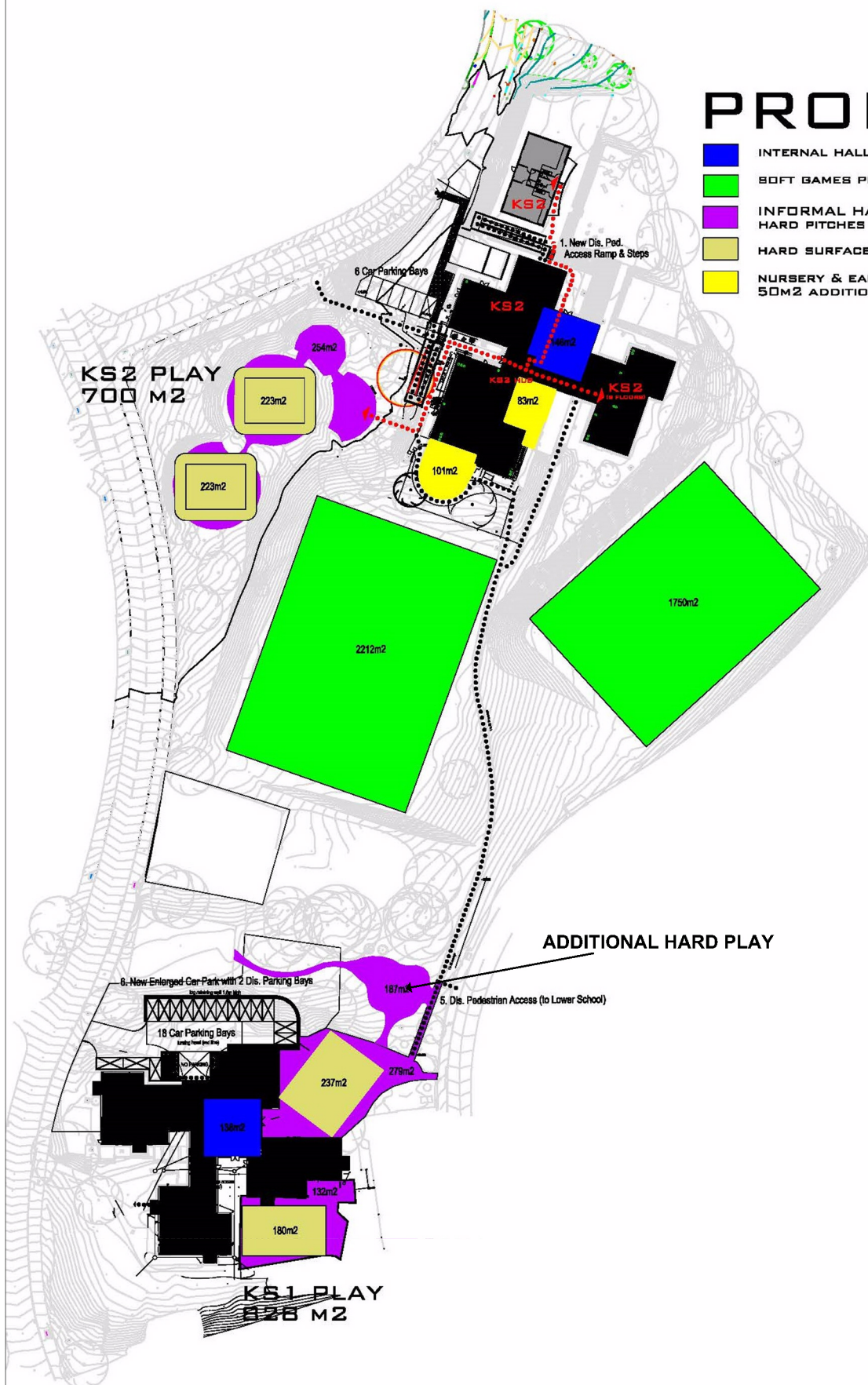

ADDITIONAL HARD PLAY



**Nottinghamshire
County Council**

Upper School: Erection of single storey 60 place freestanding double classroom with associated steps and ramp access. Lower School: demolition of No.1 boiler shed and excavation to enlarge existing staff car park, and provision of new hard play area Stanhope Primary and Nursery School, Keyworth Road, Gedling Planning Application No. 7/2015/1450NCC

This map is reproduced from Ordnance Survey material with the permission of Ordnance Survey on behalf of the Controller of Her Majesty's Stationery Office © Crown copyright. Unauthorised reproduction infringes Crown copyright and may lead to prosecution or civil proceedings. (1000019713) (2016)

Not to Scale

Produced by: JW

Date: MARCH 2016