

**PLAN 1**

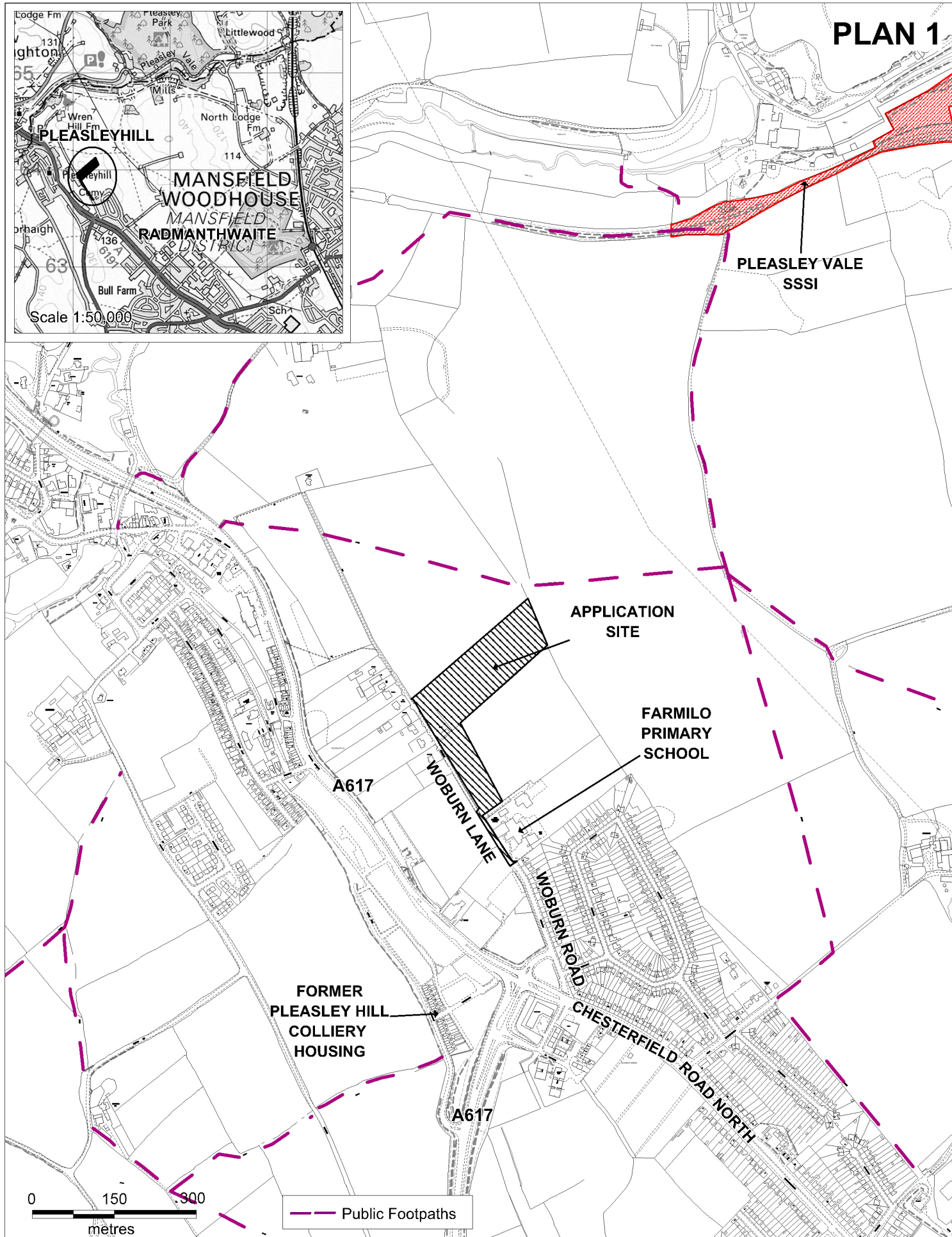

**Nottinghamshire  
County Council**

Proposed Levelling of Land to Create Football/Training Pitches involving the Extraction of and Processing of Sandstone/Limestone (for a temporary period of 3 months). Land North of Woburn Lane, Pleasley, Mansfield, Nottinghamshire.  
Planning Application No. 2/2015/0188/NT

This map is reproduced from Ordnance Survey material with the permission of Ordnance Survey on behalf of the Controller of Her Majesty's Stationery Office © Crown copyright.  
Unauthorised reproduction infringes Crown copyright and may lead to prosecution or civil proceedings. (1000019713) (2015)



Scale 1:8,000  
Produced by: JW  
Date: OCT 2015