

PROPOSED

 CAR PARKING PROVISION

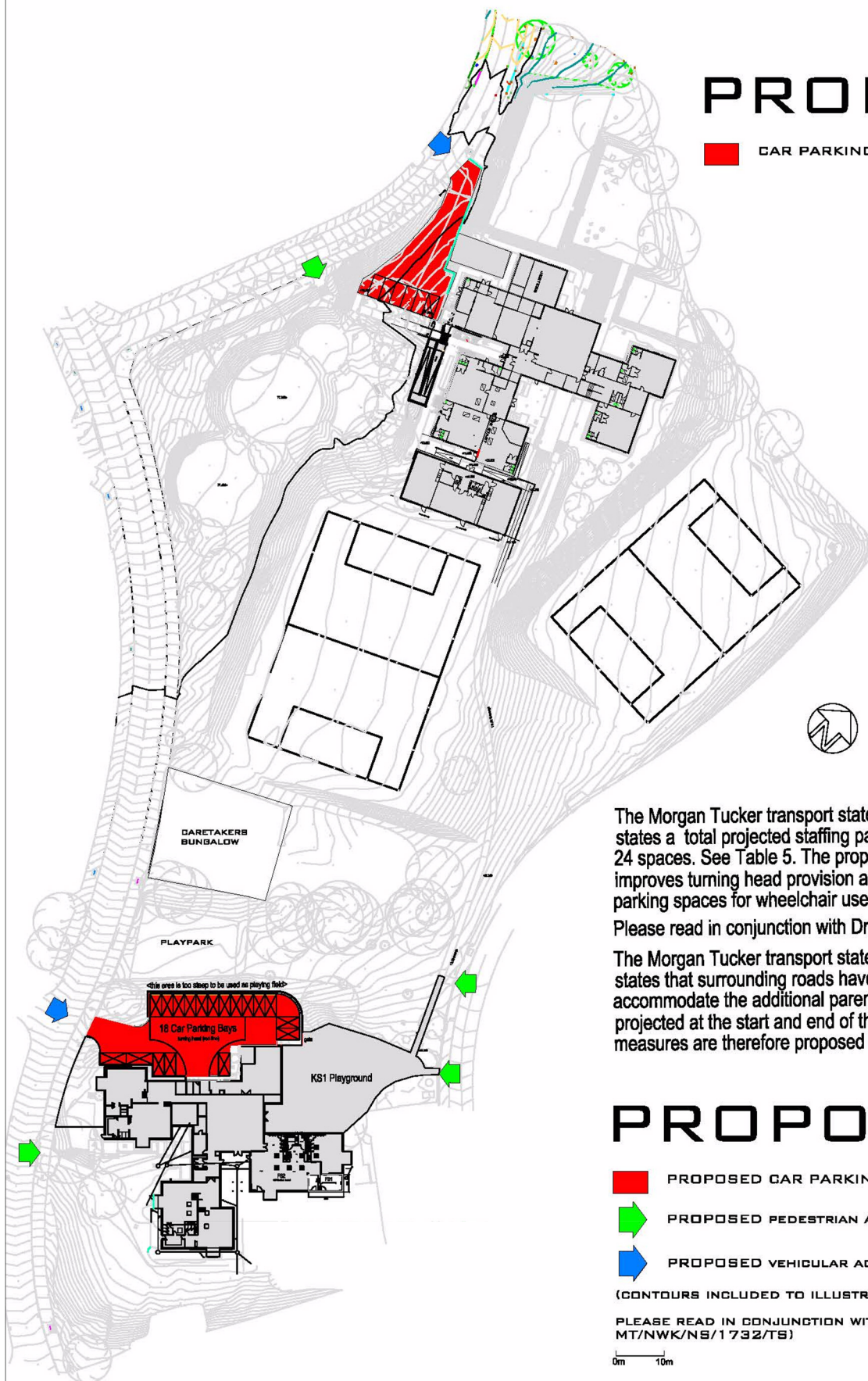

The Morgan Tucker transport statement (4.1.4) states a total projected staffing parking requirement of 24 spaces. See Table 5. The proposed scheme also improves turning head provision and includes 3 no. parking spaces for wheelchair users.

Please read in conjunction with Drawing 41/42/43

The Morgan Tucker transport statement (6.5 and 6.6) states that surrounding roads have sufficient capacity to accommodate the additional parental pick-up and drop-off projected at the start and end of the school day. No further measures are therefore proposed in this regard.

PROPOSED

 PROPOSED CAR PARKING PROVISION

 PROPOSED PEDESTRIAN ACCESS

 PROPOSED VEHICULAR ACCESS

(CONTOURS INCLUDED TO ILLUSTRATE SITE CONSTRAINTS.)

PLEASE READ IN CONJUNCTION WITH TRANSPORT STATEMENT MT/NWK/NS/1732/TS)

0m 10m



**Nottinghamshire
County Council**

Upper School: Erection of single storey 60 place freestanding double classroom with associated steps and ramp access. Lower School: demolition of No.1 boiler shed and excavation to enlarge existing staff car park, and provision of new hard play area. Stanhope Primary and Nursery School, Keyworth Road, Gedling
Planning Application No. 7/2015/1450NCC

This map is reproduced from Ordnance Survey material with the permission of Ordnance Survey on behalf of the Controller of Her Majesty's Stationery Office © Crown copyright.
Unauthorised reproduction infringes Crown copyright
and may lead to prosecution or civil proceedings. (1000019713) (2016)

Not to Scale

Produced by: JW

Date: MARCH 2016

